

Inskam 451

Inskam 451 Handheld Endoscope Instruction Manual

Model: 451 | Brand: Inskam

1. INTRODUCTION

Thank you for choosing the Inskam 451 Handheld Endoscope. This device is designed for visual inspection in hard-to-reach areas, offering clear imaging and ease of use. Please read this manual carefully before operating the device to ensure proper usage and to maximize its lifespan.

Key Features:

- **4.5-inch IPS Screen:** Provides instant, high-definition viewing of images and videos.
- **720p Camera:** Captures clear visuals for detailed inspection.
- **5-meter Rigid Cable:** Allows access to deep or distant areas.
- **IP67 Waterproof Camera:** Suitable for use in wet or submerged environments.
- **6 Adjustable LED Lights:** Illuminates dark inspection areas.
- **2000mAh Battery:** Offers extended operating time.
- **Integrated Stand:** Frees your hands for easier operation.

2. PRODUCT OVERVIEW AND PACKAGE CONTENTS

Familiarize yourself with the components of your Inskam 451 Endoscope.



Figure 2.1: The Inskam 451 Handheld Endoscope, showing the main display unit and the attached flexible camera cable with its LED-equipped lens.

Package Contents:

- 1 x Inskam 451 Handheld Endoscope Unit
- 1 x Lens Cable (5-meter rigid cable)
- 1 x USB Type-C Charging Cable

3. SETUP

3.1 Charging the Device

Before first use, fully charge the endoscope. Connect the provided USB Type-C charging cable to the device's charging port and a suitable USB power adapter (not included).

2000 mAh



2000 mAh large capacity

Built-in high-performance polymer battery,
low energy consumption, durable

A central image of a handheld electronic device with a screen displaying a mechanical engine. A coiled black cable is connected to the top. The device sits on a dark, octagonal base with teal-colored tick marks. In front of the device, the text '2000mAh' is rendered in large, 3D blue block letters. At the bottom of the advertisement, there are three teal icons: a clipboard, a clock, and a lightning bolt, each with corresponding text below it.

2000mAh

3H use time

2H charge

Figure 3.1: The endoscope features a 2000mAh battery, providing approximately 3 hours of use on a full charge, with a charging time of about 2 hours.

3.2 Inserting TF Card (Optional)

To save images and videos, insert a Micro SD (TF) card (up to 32GB, not included) into the designated TF card slot on the side of the device. Ensure the device is powered off before inserting or removing the card.

Product details

01

Bracket

Back bracket, easy to stand on the desktop



02

Type-c lens cable

Both sides can be inserted



03

Detachable lens cable

Disassembly for easy storage



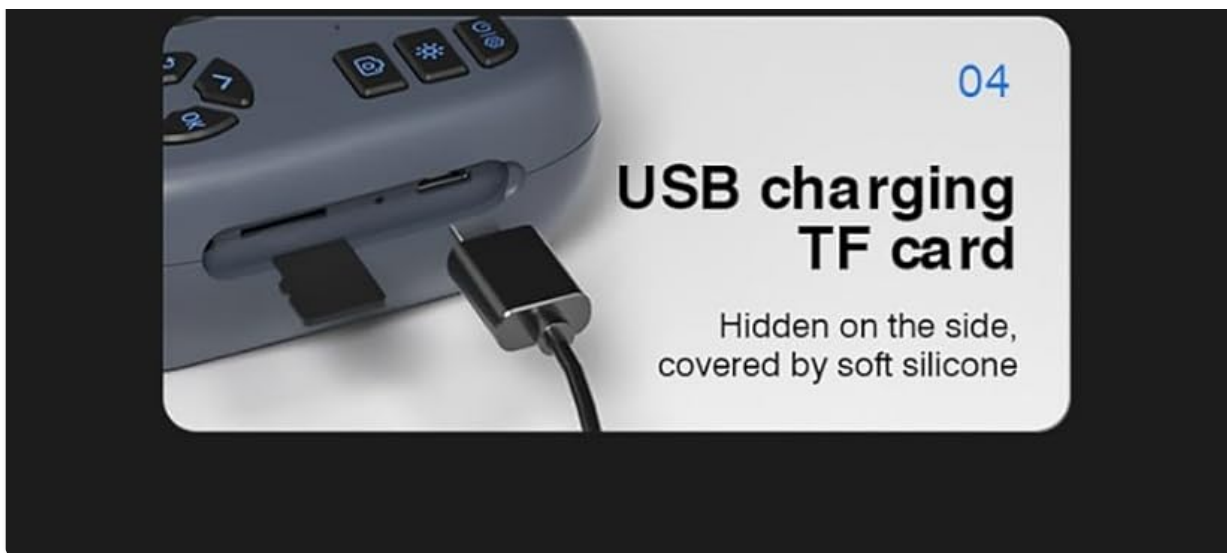

Figure 3.2: Detail showing the USB Type-C charging port and the hidden TF card slot, covered by a silicone flap for protection.

3.3 Attaching the Lens Cable

Connect the rigid lens cable to the main unit. Ensure it clicks securely into place. The cable is detachable for easy storage and replacement.



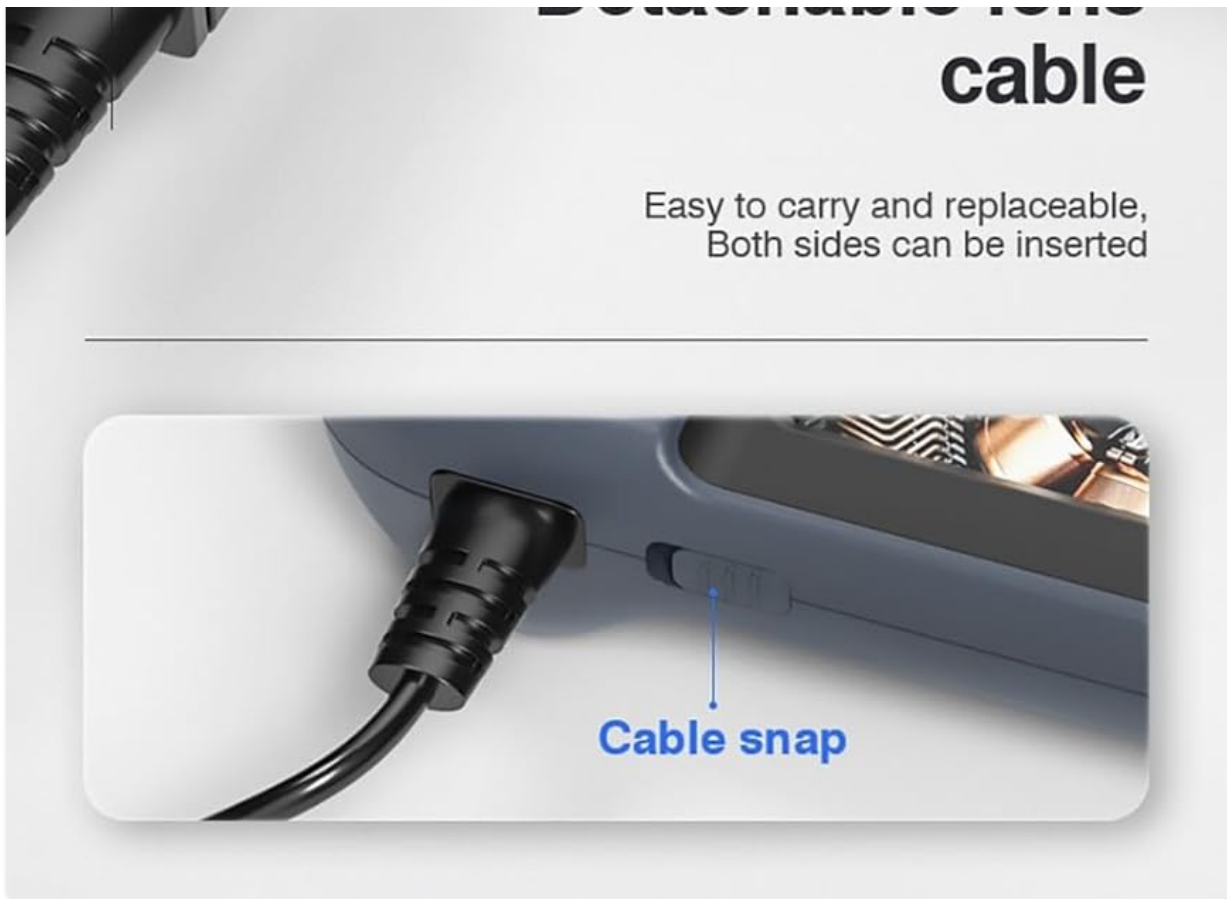

Figure 3.3: The detachable lens cable, designed for easy connection and removal. Both sides of the connector can be inserted.

3.4 Using the Integrated Stand

The Inskam 451 features a built-in bracket on the back, allowing it to stand upright on a flat surface. This frees your hands during inspection tasks.

Bracket on the back

Comes with stand, easy to stand on the desktop



Figure 3.4: The integrated bracket on the back of the device, which can be extended to allow the endoscope to stand on a desktop.

4. OPERATING INSTRUCTIONS

4.1 Powering On/Off

Press and hold the power button (usually marked with ) to turn the device on or off. The IPS screen will illuminate upon startup.

IPS HD screen display

More vivid colors, no color difference
when viewed from 180°



Figure 4.1: The 4.5-inch IPS HD screen provides vivid colors and a wide viewing angle for clear inspection.

4.2 Adjusting LED Brightness

The camera head is equipped with 6 adjustable LED lights. Use the dedicated brightness control button (often marked with an asterisk or light icon) to cycle through different brightness levels or turn the lights off.

IP67 waterproof 6 LED

Applicable to harsh environments such as
rainy/dark night/sewer, etc.
Adjustable lighting

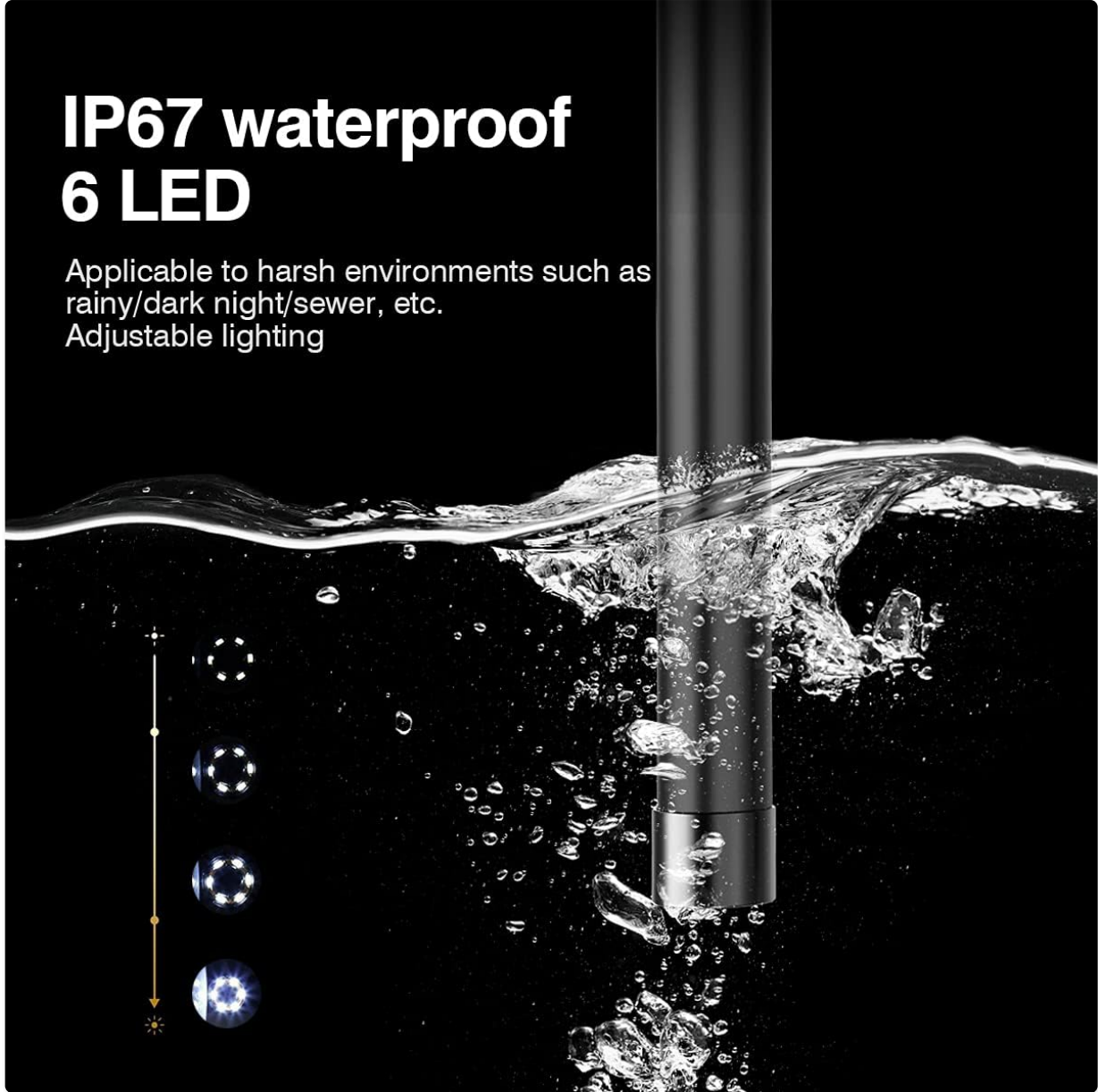

Figure 4.2: The IP67 waterproof camera head with 6 adjustable LED lights, suitable for harsh environments including submerged conditions.

4.3 Capturing Images and Recording Videos

Once the device is powered on and the camera is positioned, use the dedicated buttons to capture still images or start/stop video recording. Refer to the on-screen icons for current mode (photo/video).

4.4 Viewing Media

Navigate to the playback mode using the menu buttons to review captured images and videos stored on the TF card. You can scroll through files and play videos directly on the screen.

5. MAINTENANCE

5.1 Cleaning the Lens and Screen

Gently wipe the camera lens and the IPS screen with a soft, lint-free cloth. For stubborn smudges, a small amount of lens cleaning solution can be applied to the cloth (not directly to the lens/screen).

5.2 Battery Care

To prolong battery life, avoid fully discharging the battery frequently. Charge the device regularly, even if not in use for extended periods (e.g., once every 3 months).

5.3 Storage

Store the endoscope in a cool, dry place, away from direct sunlight and extreme temperatures. Ensure the lens cable is neatly coiled without sharp bends.

5.4 Water Resistance Precautions

While the camera head is IP67 waterproof, the main unit is not. Do not submerge the main unit in water or expose it to heavy rain. Ensure the USB and TF card ports are properly sealed with their silicone covers when not in use, especially in damp environments.

6. TROUBLESHOOTING

Problem	Possible Cause	Solution
Device won't turn on	Low battery; Power button not pressed long enough	Charge the device; Press and hold the power button for 3-5 seconds
No image on screen	Lens cable not connected properly; Camera lens obstructed	Ensure lens cable is securely connected; Clean the camera lens
Cannot save images/videos	No TF card inserted; TF card full or corrupted; TF card not supported	Insert a TF card; Delete old files or use a new card; Use a TF card up to 32GB, formatted to FAT32
LED lights not working	Brightness set to minimum; Malfunction	Press the LED brightness button to increase illumination; Contact support if issue persists

7. SPECIFICATIONS

Feature	Specification
Model	451
Screen Size	4.5 inches IPS
Screen Resolution	480 x 854 pixels
Image Resolution	1920 x 1080 (JPG)
Video Recording Resolution	1280 x 720 (AVI)
Camera Waterproof Rating	IP67
Cable Length	5 meters (Rigid)

Feature	Specification
Depth of Field	4-10 cm
Viewing Angle	70 degrees
Light Source	6 Adjustable LED lights
Battery Capacity	2000 mAh
Operating Temperature	-10 °C to 50 °C
Connectivity	USB Type-C
Storage Support	TF Card (up to 32GB)
Certifications	CE/RoHS/ISO9001
Product Weight	488 grams
Product Dimensions (L x W x H)	18 x 11 x 7 cm

8. WARRANTY AND SUPPORT

The Inskam 451 Handheld Endoscope comes with a standard manufacturer's warranty. Please refer to your purchase documentation for specific warranty terms and duration. For technical support, troubleshooting assistance, or warranty claims, please contact the retailer or manufacturer directly.



Manufacturer: Inskam





ASIN: B0DNFSDNXC

For further assistance, please visit the official Inskam website or contact their customer service.

© 2024 Inskam. All rights reserved.

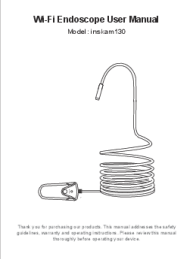
Related Documents - 451

	<p>HD Industrial Endoscope C30-M - User Guide and Specifications</p> <p>Comprehensive user guide for the INSKAM C30-M HD Industrial Endoscope. This document details product features, safety precautions, maintenance, operational functions, charging instructions, troubleshooting FAQs, included accessories, and technical specifications for this 4.3-inch display inspection camera.</p>
	<p>Inskam 401-B WiFi Oral Endoscope User Manual</p> <p>User manual for the Inskam 401-B WiFi oral endoscope, providing instructions for setup, operation, specifications, and troubleshooting. Features include HD video, adjustable LEDs, and mobile/PC connectivity.</p>

 <p>Wi-Fi Endoscope User Manual Model: Inskam130</p> <p>Thank you for purchasing our products. This manual addresses the safety guidelines, warranty and operating instructions. Please carefully read the rights before operating our device.</p>	<p>Inskam130 Wi-Fi Endoscope User Manual: Setup, Operation, and Troubleshooting</p> <p>Comprehensive user manual for the Inskam130 Wi-Fi Endoscope. Includes safety guidelines, package contents, setup instructions, app connection, operation, specifications, and troubleshooting tips.</p>
 <p>Inskam C30-M endoskop bez záznamu s 4,3" displejem</p> <p>Návod k použití</p>	<p>Inskam C30-M Industrial Endoscope Camera User Manual</p> <p>Comprehensive user manual for the Inskam C30-M industrial endoscope camera, detailing features, specifications, operation, maintenance, and troubleshooting for effective use in inspection tasks.</p>
 <p>Inskam C30-M Endoscop fără înregistrare cu ecran de 4,3"</p> <p>Instructiuni de utilizare</p>	<p>Inskam C30-M 4.3" Endoscope: User Manual, Specifications, and Features</p> <p>Comprehensive user guide for the Inskam C30-M endoscope, detailing its 4.3-inch screen, 1920x1080 resolution, 8mm camera, LED lights, battery, functions, safety precautions, and accessory installation. Includes technical parameters and troubleshooting tips.</p>
 <p>Inskam C30-M endoskop bez záznamu s 4,3" displejem</p> <p>Návod k použití</p>	<p>Inskam C30-M Endoscope User Manual</p> <p>User manual for the Inskam C30-M recorderless endoscope featuring a 4.3-inch display, 8mm camera, and 1920x1080 resolution. Includes specifications, safety information, functions, charging details, FAQs, and accessory installation.</p>