



[Manuals.plus](#) /

› [HOSTACK](#) /

› HOSTACK 71-inch Tall Kitchen Pantry Storage Cabinet User Manual

HOSTACK 71" Kitchen Pantry

HOSTACK 71-inch Tall Kitchen Pantry Storage Cabinet User Manual

Model: 71" Kitchen Pantry

1. IMPORTANT SAFETY INFORMATION

Please read and understand all instructions before assembly and use. Keep this manual for future reference.

- Ensure the cabinet is assembled correctly and securely to the wall to prevent tipping. An anti-tip device is provided for additional safety.
- Do not exceed the weight limit of 350 lbs for the entire unit. Distribute weight evenly across shelves.
- Always use appropriate safety gear during assembly.
- Keep the area around the cabinet clear of obstacles to prevent accidents.
- This product is designed for indoor use only.

2. PACKAGE CONTENTS

Verify all components are present before beginning assembly. Refer to the included hardware and instructions for a complete list of parts.



Image: Exploded view diagram illustrating all individual components, hardware, and overall dimensions of the cabinet.

Included components: Hardware, Instructions, Tall Kitchen Pantry parts.

3. SETUP AND ASSEMBLY

Assembly is required for this cabinet. Follow the straightforward instructions and use the labeled pieces for a hassle-free setup, typically within 2 hours. It is recommended to have two people for the final step of lifting the top half onto the base due to its weight.

Assembly Steps:

1. Unpack all components and verify against the parts list in the included manual.
2. Assemble the base unit according to the step-by-step diagrams.
3. Assemble the upper unit, including shelves and doors.
4. Attach the anti-tip device to the cabinet and secure it to a wall stud.

5. Carefully lift and place the upper unit onto the assembled base.
6. Install the drawer and adjust door hinges as needed (refer to Troubleshooting for door adjustment).

For a visual guide on assembly and features, please refer to the product video below:

Your browser does not support the video tag.

Video: A demonstration of the 71-inch Pantry Cabinet, showcasing its features and providing a visual overview of the assembly process.

4. OPERATING INSTRUCTIONS

The HOSTACK 71-inch Tall Kitchen Pantry Storage Cabinet is designed for versatile storage in various rooms. Utilize its features to organize your items efficiently.

Storage Features:

- **Large Countertop:** Ideal for placing frequently used appliances such as microwaves, coffee makers, air fryers, blenders, ovens, or electric cookers. A cable management hole is provided for convenience.
- **Easy-Glide Drawer:** A spacious drawer offers hidden storage for smaller items like cutlery, plates, cups, or bowls.
- **Open Shelves:** Three tiers of open shelves provide accessible storage and display space for cookbooks, decorative items, or frequently accessed pantry staples.
- **Enclosed Cabinets:** Three enclosed cabinets, each with one adjustable shelf, offer discreet storage for various kitchen or dining room essentials. The adjustable shelves allow for customized storage heights.



10 Storage & Display Compartments

Large Smooth Drawer

Adjustable Shelves

Image: The pantry cabinet with its doors open, showcasing the spacious interior, including the microwave stand area, open shelves, and enclosed cabinets filled with various kitchen items.

Large Open Compartments

Open spaces for easy access



Image: A detailed view of the cabinet's wide, easy-glide drawer, demonstrating its capacity for organizing cutlery and small dishes.

5. MAINTENANCE

Proper care and maintenance will ensure the longevity and appearance of your HOSTACK pantry cabinet.

- **Cleaning:** Wipe surfaces with a soft, damp cloth. Avoid harsh chemicals or abrasive cleaners, which can damage the finish.
- **Spills:** Clean up spills immediately to prevent staining or damage to the engineered wood.
- **Hardware:** Periodically check all screws and fasteners to ensure they are tight. Retighten if necessary.
- **Sunlight Exposure:** Avoid prolonged direct sunlight exposure to prevent fading or discoloration of the finish.

6. TROUBLESHOOTING

If you encounter any issues with your cabinet, refer to the following common solutions:

Door Alignment Issues:

Cabinet doors may become misaligned over time or during assembly. Modern hinges allow for easy adjustment to correct gaps, overlaps, or tilting.



Image: Visual examples of common cabinet door alignment problems, including excessive gaps between doors, uneven gaps, and doors that overlap or protrude.

Adjusting Hinges:

- **Side-to-Side Adjustment:** Turn screw 'C' clockwise or counter-clockwise to move the door horizontally.
- **Height Adjustment:** Loosen screws 'A' and 'B', adjust the door to the desired height, then re-tighten.
- **Depth Adjustment:** Loosen screw 'D' and push the door in or pull it out to ensure it is flush with the cabinet frame, then re-tighten.

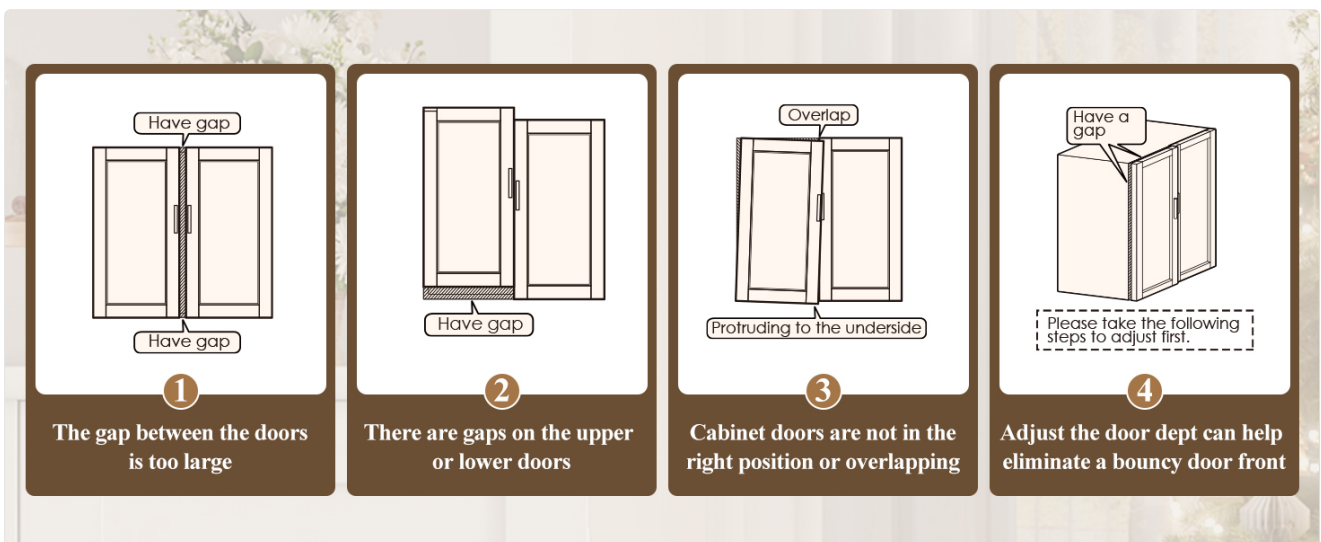

Image: Detailed instructions on how to adjust cabinet door hinges using specific screws for horizontal, vertical, and depth positioning to achieve proper door alignment.

Stability Issues:

If the cabinet feels unstable, ensure it is placed on a level surface. Verify that all assembly screws are securely tightened. Confirm the anti-tip device is properly installed and anchored to a wall stud.

7. SPECIFICATIONS

Feature	Detail
Brand	HOSTACK
Model Name	Farmhouse Food Pantry Cabinet
Item Model Number	71" Kitchen Pantry
Color	Ash Grey
Product Dimensions	14.6"D x 41.73"W x 71"H
Item Weight	130 Pounds
Weight Limit	350 Pounds
Material	Engineered Wood (Top Material Type), Well-designed Structure (Frame Material)
Mounting Type	Freestanding
Number of Shelves	7 (including fixed and adjustable)
Special Features	Adjustable Shelf, Barn Doors, Large Drawer
Assembly Required	Yes
Recommended Uses	Kitchen Storage, Microwave Stand, Pantry Storage

8. WARRANTY AND SUPPORT

Warranty Information: Specific warranty details are not provided in this manual. Please refer to your purchase documentation or contact customer support for warranty terms and conditions.

Customer Support: For any questions, concerns, or assistance with your HOSTACK pantry cabinet, please contact the seller directly via the "Contact Seller" option on Amazon. Our customer support team is available to provide assistance.