

HANLIM HL-616

HANLIM HL-616 Home Stereo System User Manual

Model: HL-616

Brand: HANLIM

1. PRODUCT OVERVIEW

The HANLIM HL-616 is a versatile home stereo system designed to provide high-quality audio from multiple sources. It features a CD player, FM radio, Bluetooth connectivity, AUX input, USB input, and an earphone jack. The system delivers 30W of audio output through two speakers, offering a balanced sound experience with customizable equalizer settings.



Image 1.1: The HANLIM HL-616 Home Stereo System, showcasing the main unit, two speakers, and the included remote control.

30W Compact CD Stereo System



CD



Bluetooth



USB



FM radio
(NO AM)



Aux in

- Equalizer: Flat/Jazz/Rock/Pop/Classic
- Repeat: One/Random/All
- Memory: Play the song from where it left off



Image 1.2: An overview of the HL-616's primary functions, including CD playback, Bluetooth, USB, FM radio, AUX input, equalizer settings, repeat functions, and resume play memory.

2. PACKAGE CONTENTS

Please check the box for the following items:

- 1 x HANLIM HL-616 CD Stereo System (Main Unit + 2 Speakers)
- 1 x Remote Control (AAA Batteries, not included)
- 1 x Power Cord (1.2m)
- 1 x Instruction Manual (this document)



Image 2.1: Visual representation of the items included in the HANLIM HL-616 package: the stereo system, remote control, power cord, and user manual.

3. SETUP

Follow these steps to set up your HANLIM HL-616 Home Stereo System:

1. **Speaker Connection:** Connect the two speakers to the main unit. Ensure the red wire from each speaker is connected to the red terminal on the main unit, and the black wire to the black terminal. The speaker cables are approximately 1 meter long.
2. **Power Connection:** Connect the power cord to the AC IN port on the back of the main unit, then plug it into a standard wall outlet.
3. **FM Antenna:** For optimal FM radio reception, ensure the FM antenna cable on the back of the unit is extended and positioned correctly.
4. **Initial Power On:** Press the 'STANDBY' button on the front panel or the remote control to turn on the system.



Image 3.1: The rear panel of the HL-616, illustrating the speaker output terminals, FM antenna connection, and AC power input for proper setup.

Setup and Connection Video Guide

Your browser does not support the video tag.

Video 3.1: This video demonstrates the physical assembly of the HANLIM HL-616, including connecting the speakers, plugging in the power, and inserting a CD. It also shows connecting USB and AUX devices.

4. OPERATING INSTRUCTIONS

This section details how to use the various functions of your stereo system.

4.1 Power On/Off

Press the **STANDBY** button on the main unit or the remote control to turn the system on or off.

4.2 Mode Selection

Press the **MODE** button on the main unit or remote control to cycle through available input sources: CD, FM Radio, Bluetooth, USB, and AUX In.

4.3 CD Playback

1. Press the **OPEN** button to open the CD tray.
2. Place a CD (CD/CD-R/CD-RW/MP3 compatible) onto the tray with the label side facing up.
3. Press the **OPEN** button again to close the tray. The system will automatically switch to CD mode and begin playback.
4. Use the **PLAY/PAUSE**, **STOP**, **SKIP FORWARD**, and **SKIP BACKWARD** buttons for control.

4.4 FM Radio

1. Switch to FM Radio mode using the **MODE** button.
2. Press the **SCAN** button to automatically scan and save available FM stations (87.5MHz to 108MHz).
3. Use the **CH-** and **CH+** buttons to navigate through saved stations.

4.5 Bluetooth Connectivity

1. Switch to Bluetooth mode using the **MODE** button. The display will show 'BT'.
2. On your mobile device (phone, tablet, computer), enable Bluetooth and search for available devices.
3. Select 'HL-616' from the list to pair. Once connected, you can stream audio from your device to the stereo system.
4. **Note:** This system does not support Bluetooth headphones.

4.6 AUX Input

1. Connect an external audio device (e.g., phone, computer) to the **AUX IN** port on the front of the main unit using a 3.5mm audio cable.
2. Switch to AUX mode using the **MODE** button. The display will show 'LINE IN'.
3. Play audio from your connected device.

4.7 USB Input

1. Insert a USB flash drive (up to 32GB, MP3/WMA compatible) into the **USB** port on the front of the main unit.
2. Switch to USB mode using the **MODE** button. The system will automatically detect and begin playing audio files.
3. Use the **PLAY/PAUSE**, **STOP**, **SKIP FORWARD**, and **SKIP BACKWARD** buttons for control.

4.8 Earphone Jack

Connect 3.5mm headphones to the **EARPHONE JACK** on the front of the main unit for private listening.

4.9 Equalizer (EQ) Settings

Press the **EQ** button on the main unit or remote control to cycle through preset sound modes: Pop, Jazz, Rock, Classic, Flat, and Bass. Select the mode that best suits your audio preference.

4.10 Repeat and Resume Playback

- **Repeat:** Press the **REPEAT** button to select playback options: repeat one track, shuffle play, or repeat all tracks.
- **Resume Play:** The system features a memory function that allows playback to resume from the last played point after pausing or turning off the disc playback.



Image 4.1: Visual guide to Bluetooth, CD Playback, and USB input functions on the HL-616.

Multi Functions Easy to Use



Bluetooth

do not support bluetooth earphone



CD Playback

support CD/CD-R/CD-RW/MP3 discs



USB input

support MP3/WMA formats

Image 4.2: Visual guide to AUX input, FM Radio, and Remote Control functions on the HL-616.



AUX in

3.5mm jack



FM Radio

87.5-108MHz, no AM



Remote Control

AAA battery, not included

Image 4.3: An illustration of the practical features of the HL-616, including DSP sound effects, repeat functions, and resume play capability.

Operating Mode Selection Video Guide

Your browser does not support the video tag.

Video 4.4: This video demonstrates how to switch between different operating modes (CD, Radio, Line In) on the HANLIM HL-616 stereo system.

5. MAINTENANCE

Proper care and maintenance will ensure the longevity and optimal performance of your stereo system.

- **Cleaning:** Use a soft, dry cloth to clean the exterior surfaces of the main unit and speakers. Do not use liquid cleaners or abrasive materials.
- **CD Care:** Handle CDs by their edges. Keep them clean and free of scratches. Store them in their cases when not in use.
- **Ventilation:** Ensure the main unit has adequate ventilation. Do not block the ventilation openings on the sides or back of the unit.
- **Environment:** Avoid exposing the system to extreme temperatures, humidity, dust, or direct sunlight.

6. TROUBLESHOOTING

If you encounter issues with your HANLIM HL-616, refer to the following common problems and solutions:

Problem	Possible Cause	Solution
No power	Power cord not securely connected; Power outlet not active.	Check power cord connection to unit and wall outlet. Try a different outlet.

Problem	Possible Cause	Solution
No sound	Volume too low; Incorrect input mode selected; Speaker wires disconnected.	Increase volume. Select the correct input mode (CD, BT, AUX, USB, FM). Ensure speaker wires are securely connected to the correct terminals.
CD not playing	CD inserted incorrectly; CD is dirty or scratched; Disc format not supported.	Ensure CD is inserted label-side up. Clean the CD with a soft cloth. Try a different CD. Ensure it's a supported format (CD/CD-R/CD-RW/MP3).
Poor FM reception	FM antenna not extended or positioned correctly; Weak signal.	Extend and adjust the FM antenna for better reception. Try repositioning the unit.
Bluetooth not connecting	Bluetooth mode not selected; Device too far; Device already paired with another unit.	Ensure the stereo is in Bluetooth mode. Move your device closer. Disconnect from other Bluetooth devices.
USB not recognized	USB drive not formatted correctly; USB drive capacity too large; Unsupported file format.	Ensure USB drive is formatted to FAT32. Use a USB drive up to 32GB. Ensure files are MP3/WMA.
Remote control not working	Batteries are dead or inserted incorrectly; Obstruction between remote and unit.	Replace AAA batteries, ensuring correct polarity. Remove any obstructions. Point remote directly at the unit.

7. SPECIFICATIONS

Feature	Detail
Model Number	HL-616
Product Dimensions (Main Unit)	6.3 x 8.5 x 7 inches (16 x 21.5 x 18 cm)
Product Dimensions (Single Speaker)	5.2 x 7.2 x 6.3 inches (13.3 x 18.4 x 16 cm)
Total Product Weight	8.5 pounds (3.9 kg)
Audio Output Power	30W (15W + 15W)
Speaker Type	Stereo with Silk Tweeter (1") and Woofer (4")
Connectivity Technology	Bluetooth, USB In, AUX In, 3.5mm Earphone Jack
CD Compatibility	CD, CD-R, CD-RW, MP3
FM Radio Frequency	87.5MHz to 108MHz (No AM)
USB Compatibility	Up to 32GB, MP3/WMA formats
Equalizer Presets	Pop, Jazz, Rock, Classic, Flat, Bass
Color	Black+Silver

Silk Tweeter



Image 7.1: An exploded view illustrating the internal speaker components, highlighting the 1-inch silk tweeter for clear highs and the 4-inch woofer for dynamic bass.

DSP Technology

Sound more clear and dynamic

30W RMS







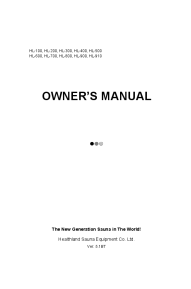

Image 7.2: Highlighting the DSP Technology and 30W RMS power output of the HL-616 for enhanced sound quality.

8. WARRANTY AND SUPPORT

For warranty information and customer support, please refer to the documentation included with your purchase or visit the official HANLIM website. Keep your purchase receipt as proof of purchase for any warranty claims.

© 2025 HANLIM. All rights reserved.

Related Documents - HL-616

	<p>HANLIM HL-616 CD Micro System User Manual</p> <p>User manual for the HANLIM HL-616 CD Micro System, detailing its features, setup, operation for radio, CD, USB, and Bluetooth, troubleshooting, maintenance, and warranty information.</p>
	<p>HANLIM HL-616 CD Micro System User Manual</p> <p>User manual for the HANLIM HL-616 CD Micro System, detailing its features, setup, operation for radio, CD, USB, and Bluetooth, troubleshooting, maintenance, and warranty information.</p>
	<p>HydroLogic StealthRO150 User Manual: Customized Reverse Osmosis Filter</p> <p>This user manual provides comprehensive instructions for the HydroLogic StealthRO150 Customized Reverse Osmosis Filter, covering setup, filter replacement, maintenance, troubleshooting, and technical specifications. Designed for hydroponic and horticultural applications, it details how to achieve optimal water purification.</p>
	<p>Toner Bank Instructions for Toner Cartridge</p> <p>Comprehensive instructions for Toner Bank toner cartridges, including storage guidelines, compatible printer models, and essential security steps for installation.</p>
	<p>Healthland Sauna Owner's Manual: HL-100 to HL-910 Models</p> <p>Comprehensive owner's manual for Healthland Sauna Equipment Co. Ltd. HL-100, HL-200, HL-300, HL-400, HL-500, HL-600, HL-700, HL-800, HL-900, and HL-910 models. Includes operating instructions, safety warnings, technical specifications, and control panel guide.</p>
	<p>Brother Color Laser Printer Parts Reference List</p> <p>Comprehensive parts reference list for Brother Color Laser Printers, including models HL-L8250CDN, HL-L8350CDW, HL-L8350CDWT, HL-L9200CDW, HL-L9200CDWT, HL-L9300CDW, and HL-L9300CDWT. This document details various components with their respective part numbers, descriptions, and model compatibility.</p>



[HANLIM HL-616 CD Micro System User Manual](#)

User manual for the HANLIM HL-616 CD Micro System, detailing its features, setup, operation for radio, CD, USB, and Bluetooth, troubleshooting, maintenance, and warranty information.

lang: **score:30** filesize: 6.23 M page_count: 17 document date: 2021-12-30

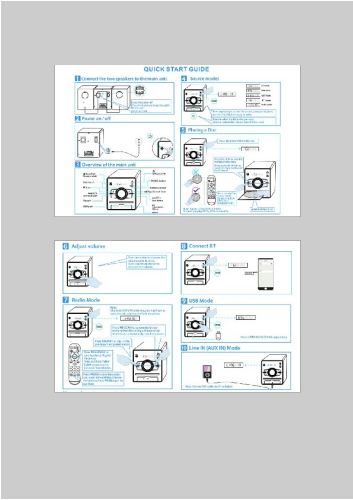

[\[pdf\] Guide](#)

Home Stereo System with CD Player FM Radio Bluetooth AUX in USB Earphone Jack Remote Control 30W HiFi Shelf HL 616 User Guide HANLIM 71QkSmniTL m media amazon images I |||

...

lang: **score:26** filesize: 186.6 K page_count: 1 document date: 2022-03-10

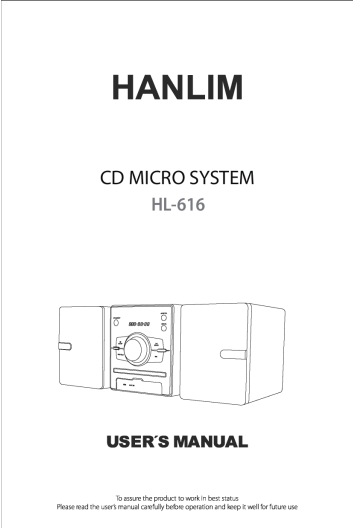

[\[pdf\] User Manual Troubleshooting Guide Warranty](#)

HL 616 C1DZlhx4lpL 1manual internal 2022 09 1 |||

HANLIM USER S MANUAL To assure the product to work in best status Please read the user .s manual carefully before operation and keep it well for future use English

..... . Franc;;ais

.....

lang:en **score:19** filesize: 6.37 M page_count: 17 document date: 2022-09-10

TCB

GRANT OF EQUIPMENT
AUTHORIZATION

Issued Under the Authority of the
Federal Communications Commission

By: **WCDM Loh**
370 Boulder Court
Pleasanton, CA 94566

Date of Grant: 03/11/2022
Application Dated: 03/11/2022

SHENZHEN LONGPING TECHNOLOGY CO., LTD
2nd Floor, Build 3, Futai Industrial Zone,
Fuyang, Beian,
Shenzhen,
China

Attention: Daisy Tang

NOT TRANSFERABLE

EQUIPMENT AUTHORIZATION is hereby issued to the named GRANTEE, and is
VALID ONLY for the equipment identified herein for use under the Commission's
Rules and Regulations listed below.

FCC IDENTIFIER: **2A5A6-LP-D01**
Name of Grantee: **SHENZHEN LONGPING TECHNOLOGY
CO., LTD**

Equipment Class: **Part 15 Subpart C Stereophonic Transmitter**
Name: **CD PLAYER**

Grant Date: **FCC Rule Parts** **15C** **Frequency** **88MHz** **Output** **500mW** **Frequency** **100MHz** **Emission** **Unlimited**

Output power listed in conducted power:



[pdf]

FCC OET TCB Form 731 Grant of Equipment Authorization Calina LONPOO Portable CD Player
Boombox Bluetooth FM Radio with Stereo Sound USB AUX Input Headphone Jack LCD Display AC
Battery Operated for Kids Learning Home System in Earphone Remote Control 30W HiFi Shelf Safety
Information HL 616 Certificate Compliance HANLIM 61mBs87XZ L m media amazon images I |||

...

lang:en score:11 filesize: 121.29 K page_count: 1 document date: 2022-03-11

Project No.: ZKT-2022031141
Page 1 of 59

FCC TEST REPORT
FCC ID:2A5A6-LP-D01

Report Number: ZKT-2022031141
Date of Test: Feb. 22, 2022 – Mar. 08, 2022
Date of Issue: Mar. 08, 2022
Total number of pages: 59
Test Result: PASS

Testing Laboratory: Shenzhen ZKT Technology Co., Ltd.
Address: 1F, No. 101, Building B, No. 6, Tiegong Community Industrial
Park, Futai Street, Beian District, Shenzhen, China

Applicant's name: SHENZHEN LONGPING TECHNOLOGY CO., LTD
Address: 2nd Floor, Build 3, Futai Industrial Zone, Fuyang, Beian,
Shenzhen, China

Manufacturer's name: SHENZHEN LONGPING TECHNOLOGY CO., LTD
Address: 2nd Floor, Build 3, Futai Industrial Zone, Fuyang, Beian,
Shenzhen, China

Test specification: FCC CFR Title 47 Part 15 Subpart C Section 15.247
Standard: ANSI C63.10-2013
Test procedure: FCC 47 CFR 15.247 Mass Guidance v.0502

Nonstandard test method: N/A

Test Report Form No.: TRF-EL-112_V0
Test Report Form's Originator: ZKT Testing

Master TSP: Shen 2020-01-02

This report and/or data has been tested by ZKT and the results show that the equipment under
test (EUT) is in compliance with the FCC requirements. And it is applicable only to the tested sample
identified in this report.

The report shall not be reproduced except in full, without the written approval of ZKT. This document may
be altered or revised by ZKT, without notice, and shall be revised in the edition of the document.

Product name: CD PLAYER

Test item: LONGPING, MANUL, TIANBOY

Model type reference: LP-D01, LP-D02, LP-D03, LP-D07, LP-B06, LP-B08, LP-B10,
HL-616, TB-610, TB-F10, HL-F10, LP-D06, LP-100, LP-D77, LP-D88

Rating: AC 100V/50Hz or 50-240V battery

[FCC Test Report for LONPOO CD Player LP-D01](#)

Official FCC test report for the LONPOO CD Player (Model LP-D01) by SHENZHEN
LONGPING TECHNOLOGY CO., LTD, tested by Shenzhen ZKT Technology Co., Ltd.
Details compliance with FCC Part 15 Subpart C.

lang:en score:9 filesize: 3.06 M page_count: 59 document date: 2022-03-10