

Onforu BDBL120WF-5

Onforu 5-Head 120W Smart LED Security Light User Manual

Model: BDBL120WF-5

1. INTRODUCTION

This manual provides detailed instructions for the installation, operation, and maintenance of your Onforu 5-Head 120W Smart LED Security Light. This outdoor flood light features motion sensing, adjustable brightness and color temperature, and smart control via the Onforu app, Alexa, or Google Assistant. Please read this manual thoroughly before installation and use to ensure proper function and safety.

Key Features:

- **WiFi & Voice Control:** Connects to 2.4GHz WiFi for control via the Onforu app, Alexa, or Google Assistant.
- **Tunable Color Temperature & Brightness:** Stepless dimming from 2700K (warm white) to 6500K (cold white) and 5-level brightness adjustment. Includes memory function and Micro-Bright Mode.
- **Enhanced Motion Detection:** Up to 180° sensing angle and 72.7ft detection distance with adjustable sensitivity.
- **Smart Timing:** Schedule automatic on/off times with customizable color temperatures or brightness levels.
- **Durable & Weatherproof:** IP65 waterproof rating, suitable for various outdoor environments.

2. SAFETY INFORMATION

WARNING: Risk of electric shock. Disconnect power at the fuse or circuit breaker before installation or servicing.

- Ensure the power supply is turned off before beginning installation.
- Installation should be performed by a qualified electrician or a person with sufficient electrical knowledge.
- This product is designed for outdoor use and is IP65 rated for water resistance. However, the adapter is not waterproof and must be protected from moisture.
- Do not attempt to modify or disassemble the light fixture. This will void the warranty and may cause electrical hazards.

- Ensure all connections are secure and properly insulated.
- Mount the fixture securely to prevent it from falling.

3. PRODUCT OVERVIEW

The Onforu 5-Head Smart LED Security Light features five adjustable light heads and an integrated motion sensor. The robust design ensures durability in outdoor conditions.



Image 3.1: Front view of the Onforu 5-Head Smart LED Security Light with a smartphone displaying the control app.

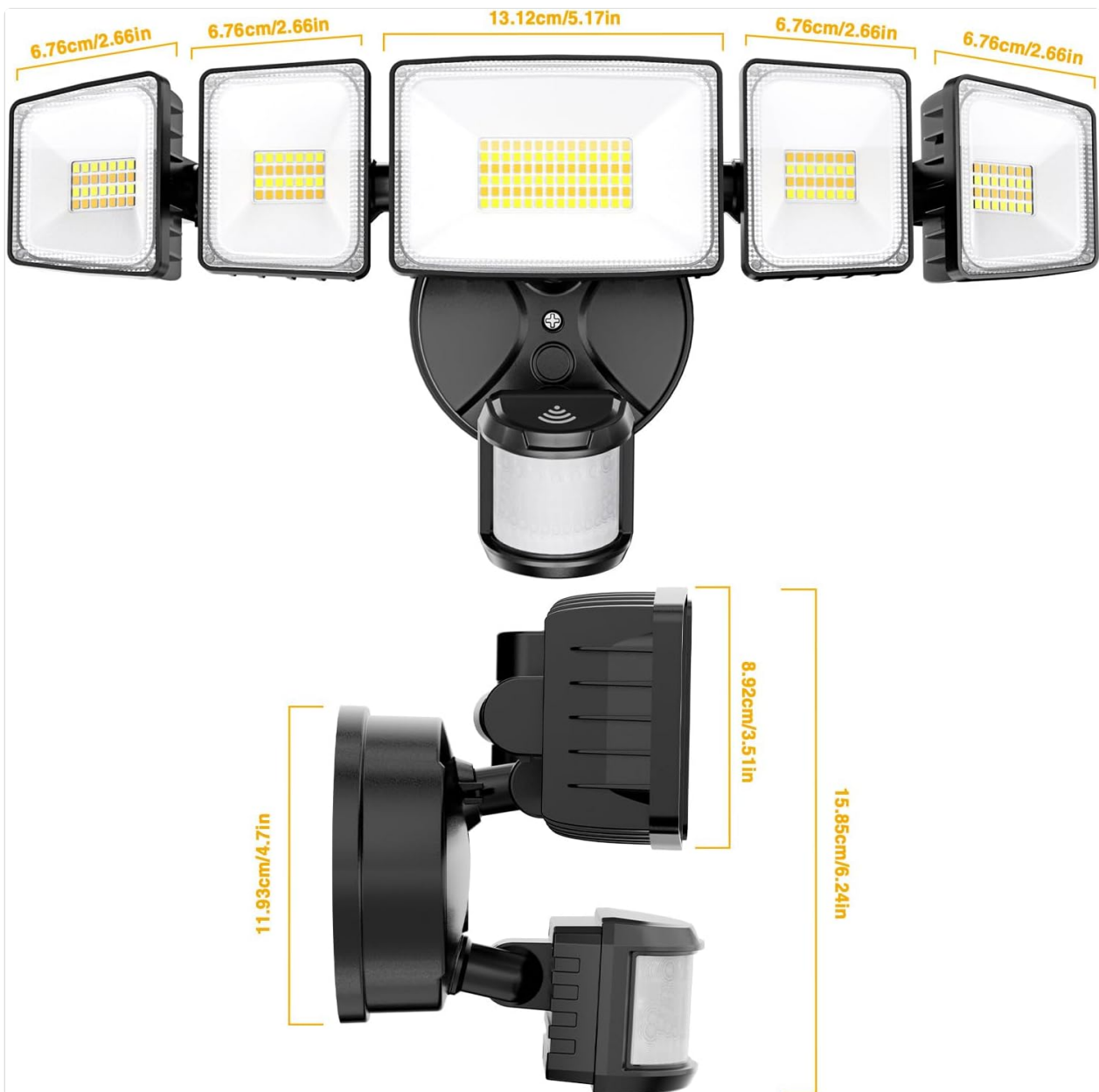

Image 3.2: Detailed dimensions of the Onforu 5-Head Smart LED Security Light, showing length, width, and height measurements.

4. INSTALLATION

4.1 Pre-Installation Checklist

- Ensure you have the necessary tools: screwdriver, wire strippers, drill, mounting hardware (included).
- Verify the installation location is suitable for a wall-mounted fixture and has access to a 120V AC power source.
- Turn off power at the circuit breaker before starting.

4.2 Wiring Instructions

Connect the light fixture to your household wiring as follows:

1. Identify the Neutral (N), Ground (G), and Live (L) wires from your junction box.
2. Connect the light fixture's wires to the corresponding household wires using wire nuts or appropriate connectors.

- Black wire (Live) to Live wire.
 - White wire (Neutral) to Neutral wire.
 - Green/Yellow wire (Ground) to Ground wire.
3. Ensure all connections are secure and insulated.



Image 4.1: Wiring diagram showing connections for Neutral, Ground, and Live wires.

4.3 Mounting Options

The light fixture can be mounted in various configurations:

- **Wall Mount:** Standard installation on a vertical wall surface.
- **Soffit Mount:** Installation under an overhang or soffit.
- **Pillar Mount:** Installation on a vertical pole or pillar.

Secure the mounting bracket to the desired surface using appropriate screws and anchors. Then, attach the light fixture to the mounting bracket.



Image 4.2: Illustrations of soffit mount, wall mount, and pillar mount installations.

5. APP SETUP & PAIRING

To unlock the full smart features of your Onforu LED Security Light, you must connect it to the Onforu app.

1. **Download the App:** Search for "Onforu" in your smartphone's app store (iOS or Android) and download the application.
2. **Register/Log In:** Open the Onforu app and create an account or log in if you already have one.
3. **Prepare for Pairing:** Ensure your Wi-Fi network is 2.4GHz. This device does not support 5GHz Wi-Fi.
4. **Enter Pairing Mode:** Turn the light fixture's power ON, then OFF, then ON, then OFF, then ON (three times total). The light heads should begin flashing rapidly, indicating it is in pairing mode. If not, repeat the power cycle.

5. **Add Device in App:** In the Onforu app, tap the "+" icon to add a new device. Follow the on-screen prompts to select your device type and connect to your 2.4GHz Wi-Fi network.
6. **Confirm Flashing:** Confirm in the app that the light is flashing rapidly. The app will then attempt to connect to the light.
7. **Completion:** Once connected, you can rename your device and begin controlling it through the app.



Image 5.1: Smartphone displaying the Onforu app interface for controlling the light, with icons for WiFi, Alexa, and Google Home compatibility.

6. OPERATING INSTRUCTIONS

6.1 Brightness and Color Temperature Adjustment

Using the Onforu app, you can precisely control the light output:

- **Stepless Dimming:** Adjust brightness from 1% to 100%.
- **Color Temperature:** Change the light color from 2700K (warm white) to 6500K (cool white).
- **Memory Function:** The light will retain its last brightness and color temperature settings when turned off and on again.

- **Micro-Bright Mode:** Maintain a low-energy illumination when the motion sensor is not activated, saving power.



Image 6.1: The Onforu app displaying controls for adjusting light brightness and color temperature from 2700K to 6500K.

6.2 Motion Sensor Settings

Customize the motion detection behavior via the app:

- **Sensing Angle:** The sensor provides up to 180° detection.
- **Detection Distance:** Max detection distance is 72.7ft.
- **Sensitivity Levels:** Choose from 3-level sensing distances (Low, Medium, High) and 5 surrounding brightness modes to optimize detection.
- **Motion Off Delay:** Set the duration the light stays on after motion is detected, from 6 seconds to 60 minutes.
- **Group Linkage:** Link multiple Onforu lights to trigger simultaneously upon motion detection.



Image 6.2: Diagram illustrating the motion detection range and sensing distances (L, M, H) for the security light.



Image 6.3: Screenshot of the Onforu app showing options for adjusting motion detection sensitivity (Low, Middle, High).

6.3 Timing Settings

Program your light to operate according to a schedule:

- **Daily Schedule:** Set specific times for the light to turn on and off automatically (e.g., 6 PM on, 5 AM off).
- **Customized Periods:** Configure different color temperatures or brightness levels for specific hours within your schedule.

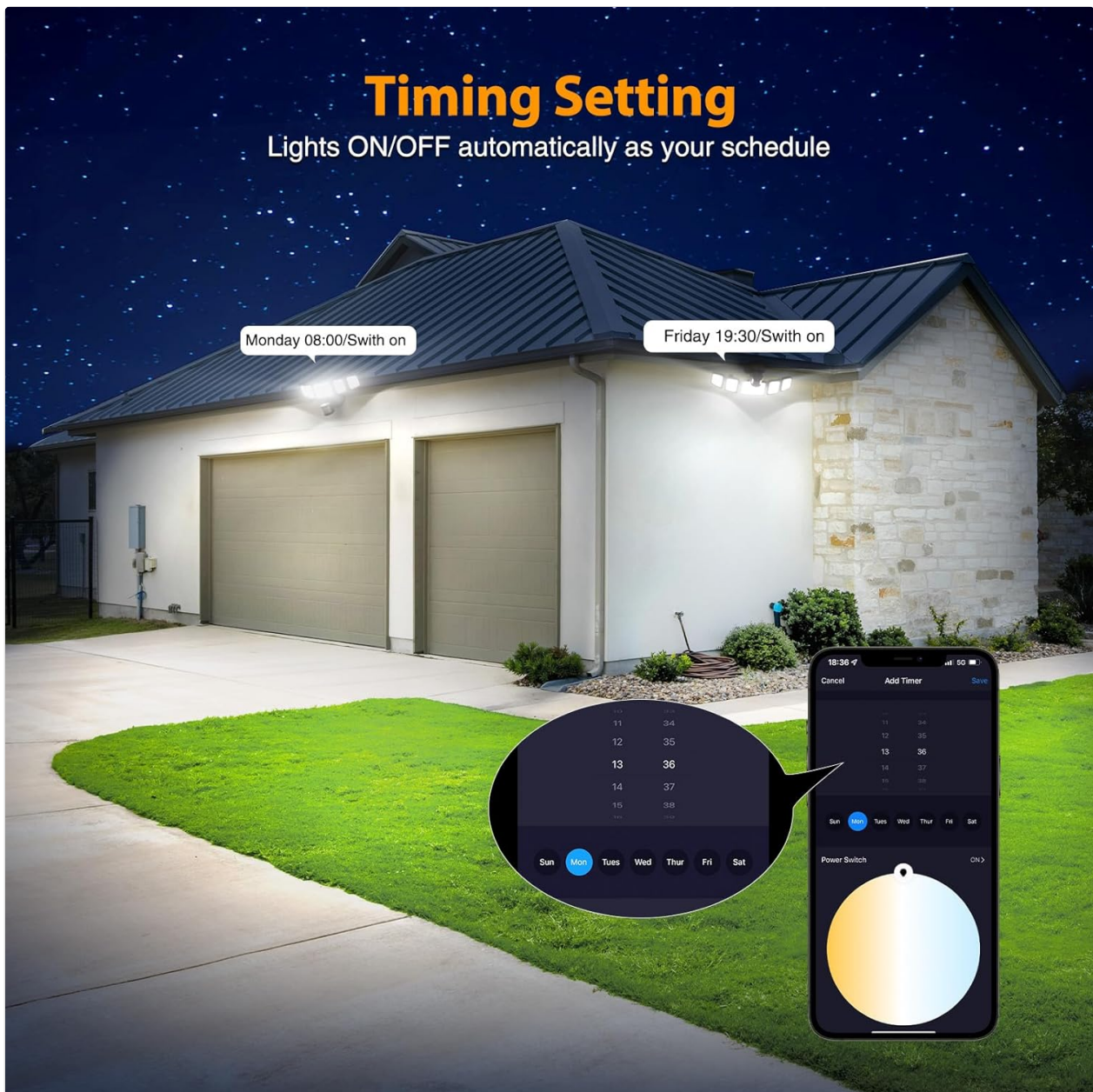

Image 6.4: The Onforu app displaying timing schedule options, allowing users to set specific on/off times for the light.

6.4 Voice Control Integration

Integrate your Onforu light with smart home assistants:

- **Alexa:** Link your Onforu account to Alexa through the Alexa app to control the light with voice commands (e.g., "Alexa, turn on the security light").
- **Google Assistant:** Link your Onforu account to Google Assistant through the Google Home app for voice control (e.g., "Hey Google, set the flood light to warm white").

7. MAINTENANCE

The Onforu 5-Head Smart LED Security Light is designed for minimal maintenance.

- **Cleaning:** Periodically clean the light heads and motion sensor lens with a soft, damp cloth to remove dust and debris. Do not use abrasive cleaners or solvents.
- **Weather Resistance:** The IP65 rating ensures protection against dust and water jets. However, avoid submerging the unit or exposing the non-waterproof adapter to moisture.
- **Inspection:** Regularly inspect the wiring and mounting for any signs of damage or loosening.



Image 7.1: Illustration highlighting the IP65 waterproof, snowproof, heat resistance, and anti-dust features of the light.

8. TROUBLESHOOTING

If you encounter issues with your Onforu Smart LED Security Light, refer to the following common problems and solutions:

Problem	Possible Cause	Solution
Light does not turn on.	No power, faulty wiring, or light sensor active.	Check circuit breaker. Verify wiring connections. Ensure light sensor is not detecting sufficient ambient light (e.g., during daytime).
Light does not enter pairing mode (not flashing).	Incorrect power cycling.	Ensure you cycle power ON-OFF-ON-OFF-ON (three times total) within a few seconds. Try reversing the initial ON/OFF state if necessary.

Problem	Possible Cause	Solution
Cannot connect to the Onforu app.	Incorrect Wi-Fi band, weak signal, or incorrect pairing steps.	Confirm your router is broadcasting a 2.4GHz Wi-Fi signal. Move the light closer to the router. Ensure the light is flashing rapidly before attempting to connect in the app. Reset router if necessary.
Motion sensor is not detecting or is too sensitive.	Incorrect sensitivity settings or obstructions.	Adjust motion sensor sensitivity and detection distance in the Onforu app. Ensure there are no obstructions blocking the sensor's view.
Light heads feel hot.	Normal operation or potential issue.	While LEDs generally run cooler than traditional bulbs, some heat is normal. If the fixture feels excessively hot to the touch or you notice any burning smell, immediately disconnect power and contact customer support.

9. SPECIFICATIONS

Feature	Specification
Model Name	Smart Motion Sensor Light
Part Number	BDBL120WF-5
Wattage	120 Watts
Brightness	12000 Lumens
Color Temperature	2700K - 6500K
Voltage	120 Volts (AC)
Light Source Type	LED
Number of Light Sources	5
Control Method	App, Voice (Alexa, Google Assistant)
Connectivity Protocol	Wi-Fi (2.4GHz)
Special Feature	Motion Sensor
Motion Sensor Angle	Max 180°
Motion Sensor Distance	Max 72.7 ft
Water Resistance Level	IP65 Waterproof
Material	Metal
Product Dimensions	16.33"L x 7.63"W x 5.51"H
Item Weight	3.08 pounds
Installation Type	Wall Mount





Feature	Specification
Indoor/Outdoor Usage	Outdoor

10. WARRANTY AND SUPPORT

Onforu products are designed for quality and reliability. For specific warranty details, please refer to the warranty card included with your product or visit the official Onforu website. If you require technical assistance or have questions not covered in this manual, please contact Onforu customer support through their official channels.

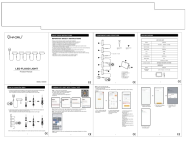
Online Support: [Visit the Onforu Store on Amazon](#)

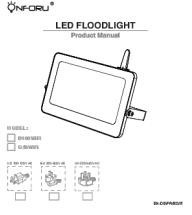
Related Documents - BDBL120WF-5

	<p>Onforu PIR LED Wall Lights with Motion Sensor User Manual</p> <p>This manual provides detailed instructions for the installation, operation, and troubleshooting of Onforu PIR LED Wall Lights with Motion Sensor, models BDBS55WF-5 and BDBL120WF-5. It covers app pairing, smart features, and safety precautions.</p>
	<p>Onforu H05HCW LED Flood Light: Product Manual and Smart Control Guide</p> <p>Detailed product manual for the Onforu H05HCW LED Flood Light. Includes safety instructions, component identification, specifications, connection guide, smart app pairing and operation (Onforu Home app, Alexa, Google Assistant), installation steps, and FCC compliance information.</p>
	<p>Onforu PIR LED Wall Lights with Motion Sensor - BDBS55WF-5 & BDBL120WF-5 User Manual</p> <p>This user manual provides detailed information for the Onforu BDBS55WF-5 and BDBL120WF-5 PIR LED Wall Lights with Motion Sensor. It covers product specifications, app pairing and operation, installation instructions, troubleshooting, and FCC compliance.</p>
	<p>Onforu 5 Heads Motion Sensor Light BD76 Installation and Troubleshooting Guide</p> <p>Comprehensive installation guide and troubleshooting solutions for the Onforu 5 Heads Motion Sensor Light (Model BD76). Includes safety precautions, step-by-step installation instructions, and common issue resolution.</p>
	<p>ONFORU LED Floodlight D100WIFI G50WIFI Product Manual</p> <p>Comprehensive product manual for ONFORU D100WIFI and G50WIFI LED Floodlights, covering safety, specifications, app pairing, Alexa and Google Assistant integration, installation, maintenance, and disposal. Includes detailed instructions and warnings.</p>
	<p>Onforu D100/G50 WIFI Smart Floodlight User Manual</p> <p>Comprehensive user manual for the Onforu D100/G50 WIFI Smart Floodlight. Includes installation instructions, safety precautions, Smart Life app setup, and integration guides for Amazon Alexa and Google Assistant.</p>

[Onforu PIR LED Wall Lights with Motion Sensor - BDBS55WF-5 & BDBL120WF-5 User Manual](#)

This user manual provides detailed information for the Onforu BDBS55WF-5 and BDBL120WF-5 PIR LED Wall Lights with Motion Sensor. It covers product specifications, app pairing and operation, installation instructions, troubleshooting, and FCC compliance.

lang:en score:36 filesize: 1.24 M page_count: 2 document date: 2025-04-01

[\[pdf\] User Manual Parts List Specifications Dimension Guide](#)

Download NowOnforu 5 Heads 120W Smart LED Motion Detector Outdoor Security Lights for SaleON BL120 BD101 DW US HScdn shopify s files 1 0121 9123 6158 ON HS v 1743577924 |||

COMPONENTS AND STRUCTURE BDBS55WF-5 **BDBL120WF-5** PIR LED WALL LIGHTS WITH MOTION SENSOR Product Manual MODEL: BDBS55WF-5

BDBL120WF-5 1 2 4 PARTS LIST 1. Cover 3 2. LED Light Source 3. Lamp Base 4. Motion Sensor Machine Screw QTY: 3 Expansion Rubber Plug QTY: 3 EVA Gasket QTY: 1 Mounting ...

lang:en score:26 filesize: 1.21 M page_count: 2 document date: 2025-04-02

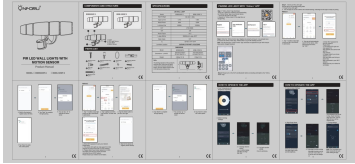

[\[pdf\] Test Report](#)

FCC PART 15 news Test Report BT LE ShenZhen Shi Jun Hui Huang Ke Ji You Xian Gong Si BDBL120WF 5 Smart wifi Led 2BM4TBDBL120WF 2BM4TBDBL120WF5 bdb120wf

Page 1 of 34 FCC ID: 2BM4T**BDBL120WF-5** Report No.: LCSA02185101EA FCC TEST REPORT For ShenZhen Shi Jun Hui Huang Ke Ji You Xian Gong Si Smart wifi Led Test Model: **BDBL120WF-5** Additional Model No.: Please Refer to Page 6

Prepared for Address : ShenZhen Shi Jun Hui Huang Ke Ji You Xian Gong Si : Lon...

lang:en score:21 filesize: 1.72 M page_count: 34 document date: 2025-04-01

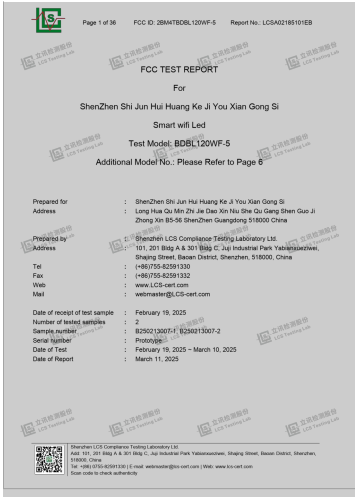

[\[pdf\] Test Report](#)

FCC PART 15 news Test Report 2G4WLAN ShenZhen Shi Jun Hui Huang Ke Ji You Xian Gong Si BDBL120WF 5 Smart wifi Led 2BM4TBDBL120WF 2BM4TBDBL120WF5 bdb120wf

Page 1 of 36 FCC ID: 2BM4T**BDBL120WF-5** Report No.: LCSA02185101EB FCC TEST REPORT For ShenZhen Shi Jun Hui Huang Ke Ji You Xian Gong Si Smart wifi Led Test Model: **BDBL120WF-5** Additional Model No.: Please Refer to Page 6

Prepared for Address : ShenZhen Shi Jun Hui Huang Ke Ji You Xian Gong Si : Lo...

lang:en score:21 filesize: 1.77 M page_count: 36 document date: 2025-04-01