

## Manuals+

[Q & A](#) | [Deep Search](#) | [Upload](#)

[manuals.plus](#) /

› [ACEZUK](#) /

› [ACEZUK M06 Jump Starter with Air Compressor User Manual](#)

## ACEZUK M06-US

# ACEZUK M06 Jump Starter with Air Compressor User Manual

Model: M06-US

Brand: ACEZUK

### PRODUCT OVERVIEW

The ACEZUK M06 is a versatile and powerful portable device designed to provide emergency jump-starting capabilities for vehicles, inflate tires, and serve as a portable power bank. It combines an 8000A peak current jump starter with a 150PSI air compressor, ensuring you are prepared for various roadside emergencies.



Image: Overview of the ACEZUK M06 unit highlighting its multi-functional capabilities including jump starting, air inflation, and power bank features.

- **Powerful Jump Starter:** Features an 8000A peak current, capable of starting all gas engines and up to 12.0L diesel engines, even in extreme temperatures.
- **Integrated Air Compressor:** Built-in 150PSI air compressor with a digital pressure gauge, auto-shutoff, and 4 customizable modes (Car, Motorcycle, Bike, Ball) for precise tire inflation.
- **Portable Power Bank:** Equipped with dual 5V/3.0A USB ports to charge smartphones, tablets, and other electronic devices.
- **Multi-mode LED Light:** Includes an ultra-bright LED flashlight with three modes: steady, strobe, and SOS for emergencies or nighttime use.

- **Advanced Safety Features:** Incorporates spark-proof technology, reverse polarity protection, and overcharge prevention for safe operation.
- **Durable Design:** Rugged and weather-resistant construction designed to withstand drops, dust, and varying temperatures.

## PACKAGE CONTENTS

Upon opening your ACEZUK M06 package, please verify that all the following items are included:

- 1x ACEZUK M06 Jump Starter with Air Compressor
- 1x Smart Jumper Cables
- 1x Air Pump Hose
- 4x Gas Nozzles (various adapters for different inflatables)
- 1x Type-C Charging Cable
- 1x User Manual
- 1x Portable EVA Carrying Case



Image: The ACEZUK M06 unit, smart jumper cables, air hose, various nozzles, charging cable, and carrying case.

## SETUP AND CHARGING

Before first use, it is recommended to fully charge your ACEZUK M06 unit. A full charge ensures optimal performance and readiness for emergencies.

### Charging the Unit

1. Locate the Type-C input port on the ACEZUK M06 unit.
2. Connect the provided Type-C charging cable to the unit.
3. Connect the other end of the Type-C cable to a suitable USB power adapter (not included) or a powered USB port.
4. The LCD screen will display the charging status and battery level. Charge until the battery indicator shows full.

*Note: For best results, charge the unit every 3-6 months even if not in use to maintain battery health.*

## OPERATING INSTRUCTIONS

### Understanding the Control Panel

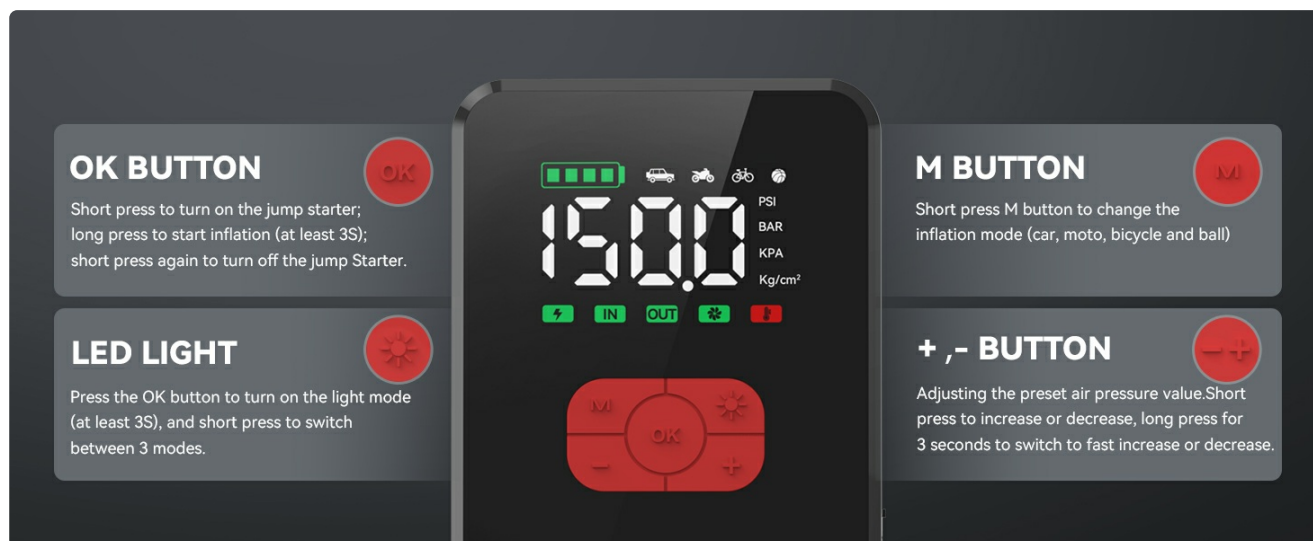

Image: Detailed view of the ACEZUK M06 control panel, showing the OK button, M button, LED light button, and +/- buttons with their respective functions.

- **OK Button:** Short press to turn on the jump starter; long press (at least 3 seconds) to start inflation; short press again to turn off the jump starter.
- **M Button:** Short press to change the inflation mode (Car, Motorcycle, Bike, and Ball).
- **LED Light Button:** Press the OK button to turn on the light mode (at least 3 seconds), and short press to switch between 3 modes (Steady, Strobe, SOS).
- **+, - Buttons:** Adjust the preset air pressure value. Short press to increase or decrease; long press for 3 seconds to switch to fast increase or decrease.

### Jump Starting Your Vehicle

Follow these steps carefully to safely jump start your vehicle:

1. Ensure the ACEZUK M06 unit is sufficiently charged.

2. Insert the smart jump cable connector fully into the jump starter's output port.
3. Connect the **red (+) clamp** to the positive (+) terminal of your vehicle's battery.
4. Connect the **black (-) clamp** to the negative (-) terminal of your vehicle's battery.
5. Once connected, the smart cable indicator light will turn green, indicating it's ready to start.
6. Start your car engine.
7. Once the engine starts, immediately remove the black (-) clamp, then the red (+) clamp from the car battery.
8. Disconnect the smart jump cable from the jump starter unit.



Image: Visual guide demonstrating the four steps to jump start a car: insert cable, connect clamps, start engine, remove clamps.

*Safety Note: Do not touch the red and black clamps together. Do not attempt to jump start if the smart cable indicator light is red or flashing.*

### Using the Air Compressor (Tire Inflator)

The built-in air compressor can inflate tires and other inflatables up to 150 PSI.

1. Assemble the air pump hose by screwing it into the inflation port on the ACEZUK M06 unit.
2. Attach the appropriate nozzle to the air pump hose if inflating items other than standard car/bike tires.
3. Connect the air pump hose securely to the tire valve or inflatable item.
4. Short press the 'M' button to select the desired inflation mode (Car, Motorcycle, Bike, Ball) or Manual mode. The display will show the recommended pressure range for the selected mode.
5. Use the '+' and '-' buttons to set your desired target pressure (PSI, BAR, KPA, or Kg/cm<sup>2</sup>).
6. Long press the 'OK' button (at least 3 seconds) to start the inflation. The compressor will automatically stop once the preset pressure is reached.
7. Disconnect the air pump hose from the tire valve/item and then from the unit.



## EASY TO INFLATE

Assemble the tube



1

Connect the tube to the car tire



2

Adjust the inflation mode and press the "+" or "-" keys to modify the inflation amount



3

Press the power button to start work



4

DETACH & GO

Image: Visual steps for inflating: assemble tube, connect to tire, adjust mode/pressure, press power button.

## 150PSI FAST TIRE INFLATOR

All Inflation Needs Can Be Met



29~36 PSI  
Car Mode



0~36 PSI  
Motorcycle



0~36 PSI  
Bike Mode



0~8 PSI  
Ball Mode



0~150 PSI  
Manual Mode

Image: Diagram showing various inflation modes (Car, Motorcycle, Bike, Ball, Manual) and their typical PSI ranges.

### Using as a Portable Power Bank

The ACEZUK M06 can charge your electronic devices via its USB output ports.

1. Connect your device's USB charging cable to one of the 5V/3.0A USB output ports on the ACEZUK M06.
2. The unit will automatically begin charging your device.
3. Monitor your device's charging status. Disconnect when charging is complete.

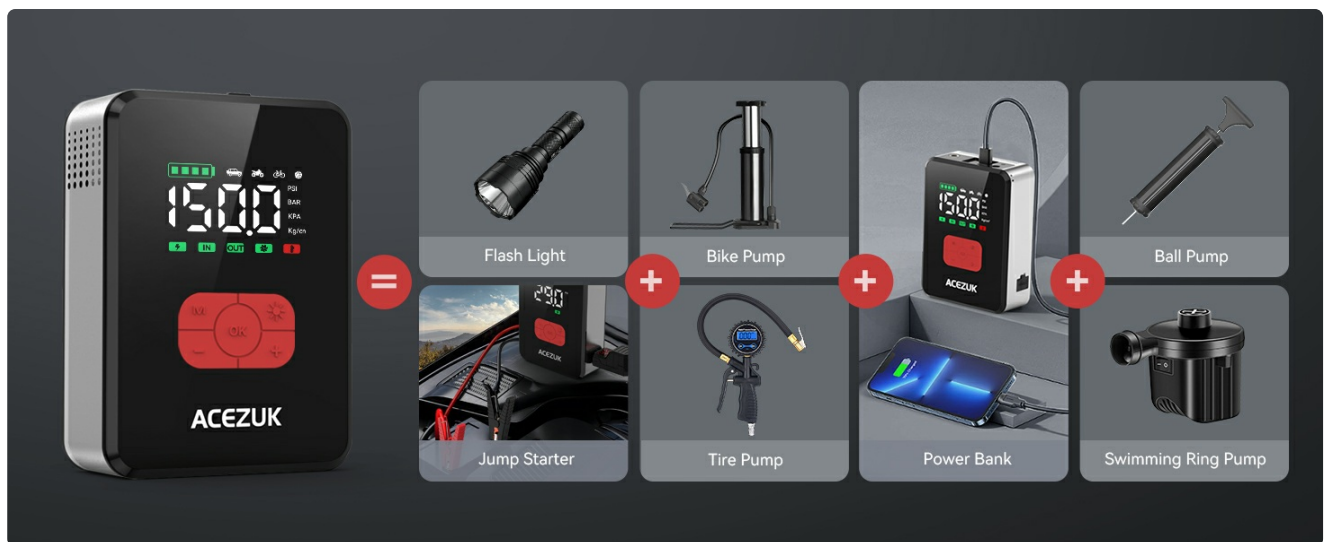

Image: A person using the ACEZUK M06 to charge a mobile phone in an outdoor setting, demonstrating its power bank functionality.

## Using the LED Light

The integrated LED light provides illumination for various situations.

1. Long press the 'OK' button (at least 3 seconds) to turn on the LED light.
2. Short press the 'OK' button to cycle through the light modes: Steady, Strobe, and SOS.
3. Long press the 'OK' button again to turn off the LED light.



Image: Examples of LED light usage, including for night repairs, outdoor emergencies, reading, and camping.

## MAINTENANCE

Proper maintenance ensures the longevity and reliable performance of your ACEZUK M06 unit.

- **Regular Charging:** To maintain battery health, fully charge the unit at least once every 3-6 months, even if it has not been used.
- **Storage:** Store the unit in a cool, dry place, away from direct sunlight and extreme temperatures. Keep it in its portable EVA carrying case to protect it from dust and physical damage.
- **Cleaning:** Use a soft, dry cloth to clean the exterior of the unit. Do not use harsh chemicals or abrasive

cleaners. Ensure all ports are free of dust and debris.

- **Cable Inspection:** Periodically inspect the smart jumper cables and air pump hose for any signs of wear, damage, or corrosion. Replace if necessary.

### TROUBLESHOOTING

If you encounter issues with your ACEZUK M06, refer to the following common problems and solutions:

Problem	Possible Cause	Solution
Unit does not turn on.	Battery is completely discharged.	Charge the unit fully using the provided Type-C cable.
Vehicle does not jump start.	Incorrect clamp connection; vehicle battery too low; smart cable error.	Ensure clamps are connected correctly (red to +, black to -). Check smart cable indicator light (should be green). If red/flashing, refer to smart cable manual or contact support. Ensure unit is fully charged.
Air compressor not inflating or stops prematurely.	Hose not securely connected; incorrect pressure setting; unit overheated.	Ensure air pump hose is tightly screwed in. Verify the nozzle is properly attached to the tire valve. Check preset pressure. Allow unit to cool down if used continuously for a long period.
USB charging not working.	Unit battery low; incorrect cable; device not compatible.	Ensure the unit has sufficient charge. Try a different USB cable. Verify your device is compatible with 5V/3.0A USB charging.

If the problem persists after trying these solutions, please contact ACEZUK customer service for further assistance.

### SPECIFICATIONS

Feature	Detail
Brand	ACEZUK
Model	M06-US
Peak Current	8000 Amps
Engine Compatibility	All Gas / 12.0L Diesel
Air Compressor Pressure	Up to 150 PSI
Battery Type	Lithium Polymer (1 included)
Product Dimensions	6.65 x 5.59 x 8.15 inches
Item Weight	3.36 pounds

Feature	Detail
USB Output	5V/3.0A (Dual Ports)
LED Light Modes	Steady, Strobe, SOS



### WARRANTY AND SUPPORT

ACEZUK is committed to providing high-quality products and excellent customer service.



- **Warranty:** Your ACEZUK M06 unit comes with a 2-YEAR FREE Warranty from the date of purchase. This warranty covers manufacturing defects and ensures reliable operation under normal use.
- **Technical Support:** We offer Lifetime Technical Support for all our products. If you have any questions regarding setup, operation, or troubleshooting, our technical team is available to assist you.
- **Customer Service:** For any inquiries, concerns, or warranty claims, please contact our 7/24 Customer Service team.

Please refer to the contact information provided on the product packaging or the official ACEZUK website for direct support channels.

### Related Documents - M06-US

<div><div>ACEZUK</div><div></div><div><div>M06</div><div>User Manual</div><div>ACEZUK@acezook.com</div></div></div>	<div><a href="#">ACEZUK M06 Portable Jump Starter and Air Compressor User Manual</a></div> <div>Comprehensive user manual for the ACEZUK M06 portable jump starter and air compressor. Learn how to jump start your car, inflate tires, charge devices, and troubleshoot common errors. Includes technical specifications and safety guidelines.</div>
<div><div>ACEZUK</div><div><div>Car Jump Starter</div><div>User Manual</div></div><div></div><div><div>ACEZUK M01 Jump Starter</div><div>ACEZUK@acezook.com</div></div></div>	<div><a href="#">ACEZUK M01 Car Jump Starter User Manual</a></div> <div>Comprehensive user manual for the ACEZUK M01 Car Jump Starter, detailing its features, technical specifications, operation, troubleshooting, and safety precautions. Learn how to use the jump starter to power your vehicle and other electronic devices.</div>



	<p><a href="#">ACEZUK M07 User Manual - Car Jump Starter and Air Compressor</a></p> <p>Comprehensive user manual for the ACEZUK M07, a 12V car jump starter and air compressor. Learn about its features, specifications, operation, and safety precautions.</p>																								
<div><div>Introduction</div><p>Thank you for purchasing ACEZUK M07 car jump starter kit. Please read the user manual carefully before you start to use the product.</p><p><b>⚠ Charge &amp; Test</b></p><p>When charging through the manual, you can start to charge your M07 with your computer or battery.</p><p><b>⚠ Warning</b></p><p>This unit is for vehicle with 12V battery. It may be dangerous if to used with other types of battery. Please read and understand the safety information before using the jump starter and may you read it electric shock, explosion, fire, property damage and personal injury.</p><div>Technical Details</div><table><tr><td>Model</td><td>M07</td></tr><tr><td>Capacity</td><td>20000mAh 90 100Ah</td></tr><tr><td>Type &amp; Input/Output</td><td>5V - 1A, 100W Input/Output</td></tr><tr><td>USB 100W Input</td><td>5V - 1A</td></tr><tr><td>Air Compressor</td><td>15PSI</td></tr><tr><td>Dimensions (L x W x H)</td><td>2.2 x 1.2 x 0.8in</td></tr><tr><td>Weight</td><td>2.2lb/1.0kg</td></tr><tr><td>Start Motor Output</td><td>1.5A</td></tr><tr><td>Working Temperature</td><td>-20°C - 60°C / 4°F - 140°F</td></tr><tr><td>LED Flashlight</td><td>400 Lumens</td></tr><tr><td>Internal Battery</td><td>Lithium polymer</td></tr><tr><td>Screen size</td><td>4.0" 2.5in</td></tr></table><div>EN 3</div></div>	Model	M07	Capacity	20000mAh 90 100Ah	Type & Input/Output	5V - 1A, 100W Input/Output	USB 100W Input	5V - 1A	Air Compressor	15PSI	Dimensions (L x W x H)	2.2 x 1.2 x 0.8in	Weight	2.2lb/1.0kg	Start Motor Output	1.5A	Working Temperature	-20°C - 60°C / 4°F - 140°F	LED Flashlight	400 Lumens	Internal Battery	Lithium polymer	Screen size	4.0" 2.5in	<p><a href="#">ACEZUK M03 Car Jump Starter User Manual &amp; Technical Guide</a></p> <p>Comprehensive guide to the ACEZUK M03 car jump starter kit, covering technical specifications, operation for jump starting vehicles, inflating tires, charging devices, and safety precautions.</p>
Model	M07																								
Capacity	20000mAh 90 100Ah																								
Type & Input/Output	5V - 1A, 100W Input/Output																								
USB 100W Input	5V - 1A																								
Air Compressor	15PSI																								
Dimensions (L x W x H)	2.2 x 1.2 x 0.8in																								
Weight	2.2lb/1.0kg																								
Start Motor Output	1.5A																								
Working Temperature	-20°C - 60°C / 4°F - 140°F																								
LED Flashlight	400 Lumens																								
Internal Battery	Lithium polymer																								
Screen size	4.0" 2.5in																								
<div><div>ACEZUK</div><div></div><div>M03</div><div>User Manual</div><div>ACEZUK@bubook.com</div></div>	<p><a href="#">ACEZUK M03 Jump Starter &amp; Tire Inflator User Manual</a></p> <p>Comprehensive user manual for the ACEZUK M03 portable jump starter and air compressor. Learn how to jump-start your car, inflate tires, use the LED light, and troubleshoot errors.</p>																								
<div><div>ACEZUK</div><div></div><div>M05</div><div>User Manual</div><div>ACEZUK@bubook.com</div></div>	<p><a href="#">ACEZUK M05: Manual de Usuario para Arranque de Batería y Compresor de Aire</a></p> <p>Guía completa del manual de usuario ACEZUK M05. Aprenda a usar el arrancador de batería de coche, compresor de aire, e inflador para vehículos, bicicletas y más. Incluye especificaciones y seguridad.</p>																								