

## Monster E52

# Monster Open Ear AC317 Headphones User Manual

Model: E52

## 1. INTRODUCTION

Thank you for choosing Monster Open Ear AC317 Headphones. These wireless headphones are designed to provide a comfortable listening experience while keeping you aware of your surroundings. Featuring Bluetooth 5.4 connectivity, crystal clear calls with AI noise reduction, and long-lasting battery life, the AC317 is ideal for daily use, workouts, and travel.

## Package Contents

Please verify that all items listed below are included in your package:

- Monster Open Ear AC317 Headphones (1 pair)
- Type-C Charging Cable (1)
- Charging Case (1)
- User Manual (1)

## What's in The Box?

Monster Open Ear AC317 Headphones × 2  
Type C- Charging Cable × 1  
Charging Case × 1  
User Manual × 1



Image: Contents of the Monster Open Ear AC317 Headphones package.

## 2. SETUP

### Initial Charging

Before first use, fully charge the charging case and earbuds. Connect the provided Type-C charging cable to the charging case and a power source. The charging case can be fully charged in approximately 1 hour. The earbuds provide up to 7 hours of playback on a single charge, and the charging case extends total listening time to up to 24 hours.

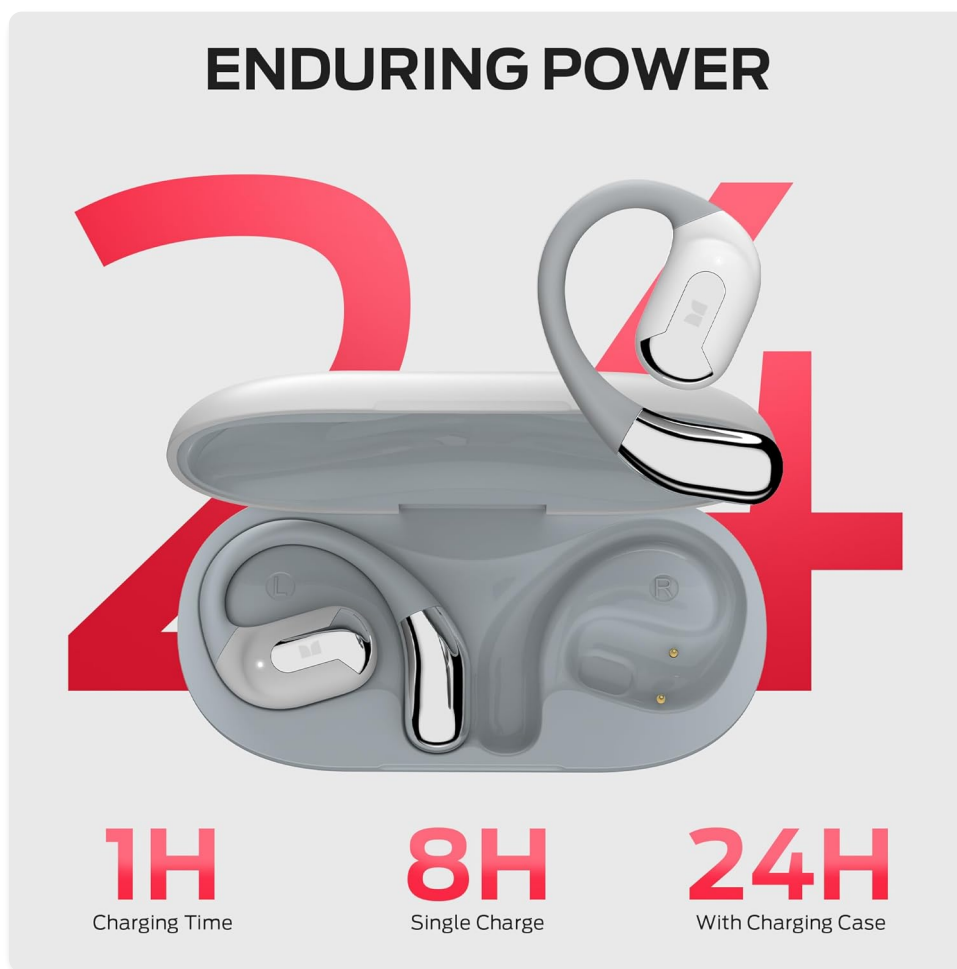

Image: Charging and battery life overview.

### Bluetooth Pairing

Follow these steps to pair your Monster Open Ear AC317 Headphones with your device:

1. **Step 1:** Pick up the earbuds from the charging case. They will automatically power on and enter pairing mode.
2. **Step 2:** On your smartphone or Bluetooth-enabled device, go to the Bluetooth settings and search for "Monster Open Ear AC317" in the list of available devices.
3. **Step 3:** Select "Monster Open Ear AC317" to connect. You will hear a system voice prompt stating "Connected" once pairing is successful.



Image: Bluetooth pairing instructions.

### 3. OPERATING INSTRUCTIONS

#### Wearing the Headphones

For optimal comfort and sound quality, ensure the headphones are worn correctly:

1. **Step 1:** Take out the earbuds from the case.
2. **Step 2:** From top to bottom, place the ear hook behind your ear.
3. **Step 3:** Adjust the earbud by gently twisting it until it sits comfortably and securely in your ear, without entering the ear canal.

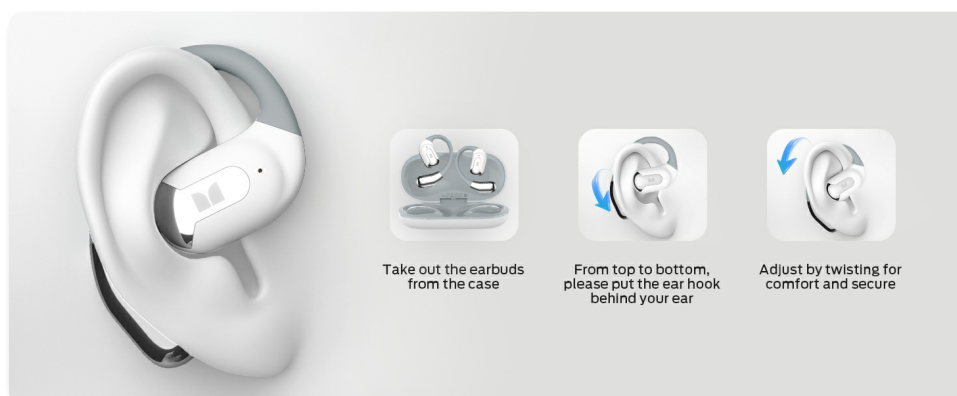

Image: Instructions for wearing the headphones.

#### Touch Controls

The Monster Open Ear AC317 Headphones feature intuitive touch controls on each earbud:

Function	Action (L/R Earbud)
Play/Pause	Click × 2
Voice Assistant	Hold × 2s
Previous Song	Click × 3 (Left Earbud)
Next Song	Click × 3 (Right Earbud)

Function	Action (L/R Earbud)
Answer Call	Click × 2
Reject Call	Hold × 2s
Volume Down	Click × 1 (Left Earbud)
Volume Up	Click × 1 (Right Earbud)



Image: Touch control guide.

## 4. MAINTENANCE

Proper maintenance ensures the longevity and optimal performance of your headphones.

### Cleaning

- Gently wipe the earbuds and charging case with a soft, dry, lint-free cloth.
- Do not use abrasive cleaners, alcohol, or chemical solvents.
- Keep charging contacts clean and free of debris.

### Water Resistance

The Monster Open Ear AC317 Headphones are IPX6 water resistant, meaning they can withstand strong jets of water. This makes them suitable for workouts and light rain. However, they are not designed for submersion in water. Avoid exposing them to saltwater, chlorinated water, or other liquids.

# IPX6 WATER RESISTANT

Rain, Humidity, Moisture Proof



Image: IPX6 Water Resistance feature.

## Storage

When not in use, store the headphones in their charging case to protect them from dust and damage.

## 5. TROUBLESHOOTING

If you encounter issues with your headphones, refer to the following common problems and solutions:

### No Sound or Intermittent Connection

- Ensure the headphones are fully charged.
- Verify that Bluetooth is enabled on your device and the headphones are connected.
- Move the headphones closer to your device to ensure they are within the 10-meter Bluetooth range.
- Try unpairing and re-pairing the headphones with your device.
- Restart both your device and the headphones.

### Headphones Not Charging

- Check if the charging cable is securely connected to both the case and the power source.
- Ensure the charging contacts on the earbuds and inside the case are clean and free of debris.
- Try using a different Type-C charging cable or power adapter.

Poor Call Quality

- Ensure the microphone is not obstructed.
- Move to a quieter environment, as AI noise reduction works best on consistent background noise.
- Check your device's call volume settings.



Image: AI Noise Reduction for clear calls.

6. SPECIFICATIONS

Feature	Detail
Model Name	E52 (AC317)
Brand	Monster
Connectivity Technology	Wireless (Bluetooth)
Bluetooth Version	5.4
Bluetooth Range	10 Meters
Battery Life (Earbuds)	Up to 7 hours (single charge)
Total Playtime (with Case)	Up to 24 hours

Feature	Detail
Charging Time (Case)	Approx. 1 hour
Control Type	Touch Control
Water Resistance Level	IPX6 (Water Resistant)
Material	Plastic
Item Weight	5.9 ounces
Ear Placement	Open Ear

# UPGRADED BLUETOOTH 5.4



More Stable Connection



Lower Power Consumption



Lower Latency



Longer Transmission Range

Image: Upgraded Bluetooth 5.4 technology.







## 7. WARRANTY AND SUPPORT

For warranty information and customer support, please refer to the warranty card included in your product packaging or visit the official Monster website. Keep your purchase receipt as proof of purchase for any warranty claims.

If you require further assistance, please contact Monster customer service through their official channels.



## Related Documents - E52

	<p><a href="#">Monster Open Ear AC317 Bluetooth Headphones Quick Start Guide</a></p> <p>A comprehensive guide to setting up and using your Monster Open Ear AC317 Bluetooth Headphones, including pairing, controls, and app integration.</p>
	<p><a href="#">Monster Open Ear AC225 Bluetooth Headphones Quick Start Guide</a></p> <p>A concise guide to setting up and using your Monster Open Ear AC225 Bluetooth Headphones, covering charging, pairing, wearing, and basic operations.</p>
	<p><a href="#">Monster Aria Free Quick Start Guide - Wireless Open Ear Headphones</a></p> <p>Get started quickly with the Monster Aria Free open-ear wireless headphones. This guide covers charging, pairing, controls, and wearing instructions for model MH22134.</p>
	<p><a href="#">Monster MH22241 Bluetooth Headphones Quick Start Guide</a></p> <p>Quick start guide for Monster MH22241 Bluetooth Headphones, covering setup, pairing, operation, and indicator lights. Learn how to use your Monster Open Ear AC390 earbuds.</p>
	<p><a href="#">Monster Open Ear AC210 Bluetooth Headphones Quick Start Guide</a></p> <p>User guide for Monster Open Ear AC210 Bluetooth headphones, covering setup, pairing, controls, and troubleshooting. Features include touch controls, voice assistant, and single-earphone mode.</p>
	<p><a href="#">Monster Open Ear AC600 Bluetooth Headphones Quick Start Guide</a></p> <p>A concise guide to setting up and using your Monster Open Ear AC600 Bluetooth headphones, including pairing, controls, and charging.</p>