

Prunarbo PR-E40

Prunarbo PR-E40 Electric Pruning Shears User Manual

MODEL: PR-E40

Compatible with Makita 18V Batteries

1. Introduction

Thank you for choosing the Prunarbo PR-E40 Electric Pruning Shears. This manual provides essential information for the safe and efficient operation, maintenance, and troubleshooting of your new tool. Please read it thoroughly before first use and keep it for future reference.



The Prunarbo Electric Pruning Shear offers enhanced efficiency and reduced effort compared to traditional manual pruners.

2. Safety Information

WARNING: Read and understand all safety precautions before operating this tool. Failure to do so may result in serious injury.

- Always wear appropriate personal protective equipment (PPE), including safety glasses, gloves, and sturdy footwear.
- Keep hands and body parts clear of the blades at all times. The blades are extremely sharp and powerful.
- Ensure the tool is switched off and the battery is removed before performing any maintenance, cleaning, or when not in use.
- Store the tool and batteries in a dry, secure location, away from children and unauthorized users.
- **Battery Safety:** Use only genuine Makita 18V batteries (BL1820, BL1830B, BL1840B, BL1850B, BL1860B) or Prunarbo original batteries. Use the original charger that matches your battery model. Charge new batteries for more than five hours before first use. Charge batteries every three months to prolong service life. Do not store batteries in humid environments or near high heat sources.

3. Product Overview

The Prunarbo PR-E40 Electric Pruning Shears are designed for efficient and precise cutting in gardening tasks. Key features include:

- **Brushless Motor:** Provides higher efficiency, longer runtime, more power, and increased durability.
- **SK5 High-Carbon Steel Blades:** Ensures exceptional sharpness, durability, and clean cuts. Features a Teflon coating for smooth, non-stick operation.
- **LCD Display:** Shows remaining battery level and cut count for better visibility.
- **Adjustable Cutting Diameter:** Easily switch between 25mm and 40mm cutting diameters.
- **Safety Switch:** Requires a quick double-press of the trigger to activate, preventing accidental operation. The tool enters standby mode after 60 seconds without cutting and auto-turns off after 15 minutes of inactivity.



Prunarbo PR-E40 Electric Pruning Shears with included accessories.

Prunarbo

PR-E40

Adjustable 25-40MM Electric Pruning Shear

- ✓ 21V Brushless Motor – Powerful & Long-lasting
- ✓ SK5 Blade with Teflon Coating
- ✓ Compatible with Makita 18V Batteries



Key features of the Prunarbo PR-E40, highlighting the brushless motor, SK5 blade, and LCD display.

4. Setup

4.1. Battery Installation

1. Ensure the pruning shears are switched off.
2. Align the battery with the battery slot at the base of the shears.
3. Slide the battery firmly into place until it clicks, indicating it is securely locked.

Compatible with Makita 18V Battery

Note: Please use the original charger that matches your battery model to ensure safe and efficient charging.

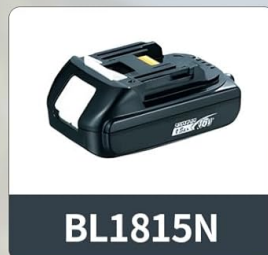

The Prunarbo PR-E40 is compatible with Makita 18V batteries such as BL1860B, BL1850B, BL1840B, BL1830B, and BL1820B.

4.2. Initial Activation

For safety, the shears require activation before use:

1. Press and hold the power switch for a few seconds until the LCD screen illuminates.
2. Quickly pull the trigger twice to activate the blades. The blades will open to their maximum setting.



Step-by-step guide for initial setup and activation of the pruning shears.

5. Operating Instructions

5.1. Making a Cut

Once activated, simply position the open blades around the branch you wish to cut and pull the trigger. The blades will close to make a clean cut and then reopen automatically.

5.2. Adjustable Cutting Diameter

The Prunarbo PR-E40 allows you to adjust the cutting diameter between 25mm and 40mm. Refer to the product's specific instructions for changing this setting, usually involving a combination of trigger presses while the tool is active.



The shears offer an adjustable cutting diameter from 25mm to 40mm for various branch sizes.

5.3. Using with an Extension Pole (Sold Separately)

For pruning high branches, the PR-E40 is compatible with a long telescopic rod (not included). This allows for extended reach without the need for ladders, enhancing safety and convenience.



Compatible with Extension Pole

Easy to Prune High Branches

Note: The extension pole is sold separately.

The shears can be attached to an extension pole for pruning high branches.

5.4. Operational Video

Your browser does not support the video tag.

This video demonstrates the power and precision of the Prunarbo E40 Electric Pruning Shears in action.

6. Maintenance

Regular maintenance ensures the longevity and optimal performance of your pruning shears.

6.1. Blade Lubrication

Apply a few drops of lubricating oil to the blade pivot point and cutting edges regularly, especially after prolonged use or exposure to moisture. This helps maintain smooth operation and prevents rust.

Your browser does not support the video tag.

Watch this video for a step-by-step guide on how to properly lubricate the blades of your PR-E40 shears.

6.2. Blade Replacement

If the blades become dull or damaged beyond sharpening, they can be replaced. Always use genuine Prunarbo replacement blades. Follow the instructions in the video below carefully.

Your browser does not support the video tag.

This video provides detailed instructions on how to safely replace the blade on your Prunarbo PR-E40 electric pruning shears.

6.3. Blade Sharpening

Use the provided sharpening stone to maintain the sharpness of your blades. Sharpening should be done with the battery removed and blades closed for safety.

6.4. Cleaning

After each use, clean the blades and housing to remove sap, debris, and dirt. Use a damp cloth and mild detergent if necessary. Ensure the tool is completely dry before storage.

7. Troubleshooting

Problem	Possible Cause	Solution
Shears do not turn on	Battery not installed correctly or discharged; Power switch off; Safety activation not performed.	Ensure battery is fully charged and properly inserted. Press power switch. Perform double-trigger press for activation.
Blades not cutting effectively	Dull blades; Debris obstructing blades; Insufficient lubrication.	Sharpen or replace blades. Clean any debris from the blade area. Lubricate blades as per maintenance section.
Tool stops during operation	Battery low; Overload protection activated; Auto-standby/off engaged.	Recharge or replace battery. Reduce cutting load. Reactivate the tool if it entered standby/auto-off mode.

8. Specifications





- **Brand:** Prunarbo
- **Model:** PR-E40
- **Item Weight:** 2.2 Pounds
- **Blade Material:** High Carbon Steel
- **Handle Material:** Plastic, Rubber
- **Blade Type:** Bypass
- **Cutting Width:** 40 Millimeters (Adjustable)
- **Power Source:** Battery Powered (Compatible with Makita 18V)
- **Product Dimensions:** 13.78 x 3.15 x 0.04 inches

9. Warranty and Support

Prunarbo offers a one-year warranty on the power tool machine, battery, and charger. If you encounter any problems or have questions regarding your Prunarbo PR-E40 Electric Pruning Shears, please feel free to contact us. We are committed to providing satisfactory solutions and support.

For further assistance, please visit the [Prunarbo Store on Amazon](#).

Related Documents - PR-E40

	<p>Prunarbo Electric Pruning Shears PR-E40/PR-E50 - Instruction Manual</p> <p>Comprehensive instruction manual for Prunarbo PR-E40 and PR-E50 electric pruning shears. Includes operating instructions, maintenance, safety, troubleshooting, and parts lists.</p>
	<p>Prunarbo Telescopic Extension Pole for Electric Tools - User Guide</p> <p>Detailed information and operating instructions for the Prunarbo Telescopic Extension Pole (Model PR-001-Pole), designed for use with electric pruning shears and chainsaws. Includes safety warnings, adjustment guides, and product specifications.</p>
	<p>Prunarbo PR-E8 User Manual - Operation and Maintenance Guide</p> <p>Comprehensive user manual for the Prunarbo PR-E8, providing detailed instructions on operation, maintenance, safety, and specifications. Learn how to use your PR-E8 effectively.</p>
	<p>Prunarbo Electric Pruning Shears PR-E40/PR-E50 - Instruction Manual</p> <p>Comprehensive instruction manual for Prunarbo PR-E40 and PR-E50 electric pruning shears. Includes operating instructions, maintenance, safety, troubleshooting, and parts lists.</p>

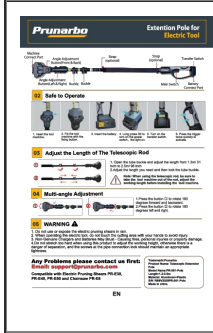

[Prunarbo Telescopic Extension Pole for Electric Tools - User Guide](#)

Detailed information and operating instructions for the Prunarbo Telescopic Extension Pole (Model PR-001-Pole), designed for use with electric pruning shears and chainsaws. Includes safety warnings, adjustment guides, and product specifications.

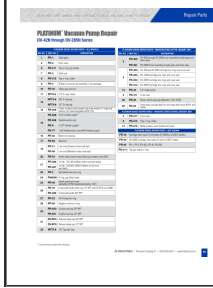

[JB Industries Vacuum Pump Repair Parts Catalog: Platinum & Eliminator Series](#)

JB Industries offers a comprehensive repair parts catalog for their Platinum (models DV-42N through DV-285N) and Eliminator (models DV-3E, DV-4E, DV-6E) vacuum pumps. This guide details part numbers, descriptions, and model compatibility for essential replacement components, including seals, valves, motors, and more. Essential for maintenance and repair of HVAC tools and equipment.