



Manuals.plus /

› XINJISHIMIN /

› XINJISHIMIN Replacement Remote Control for Carolina Electric Fireplace ldbl2000a-dd5r User Manual

XINJISHIMIN C124110901D08

XINJISHIMIN Replacement Remote Control User Manual

For Carolina Electric Fireplace Model ldbl2000a-dd5r

INTRODUCTION

This manual provides instructions for the XINJISHIMIN replacement remote control, designed for the Carolina Electric Fireplace model ldbl2000a-dd5r. This remote features oversized buttons for ease of use and requires no programming.

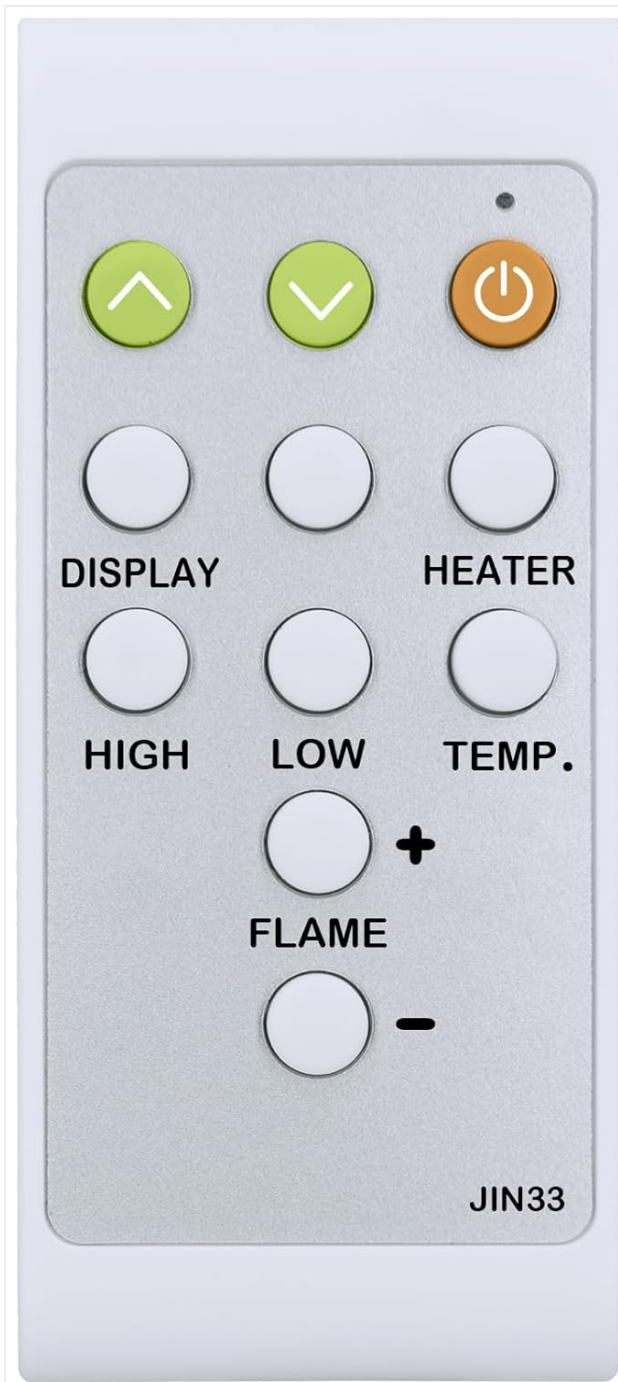

We sell

You will get 1 pc of the left remote.

- ✓ **No programming needed!**
- ✓ **Oversized buttons!**
- ✓ **Cheap Battery (AAA 1.5V)**
- ✓ **Great for Seniors!**
- ✓ **Not Easy Broken**
- ✓ **Easy Operating**
- ✓ **Easy Hold**
- ✓ **Not Easy Lost**
- ✓ **Reliable Quality**
- ✓ **Long Life**

Image: The XINJISHIMIN replacement remote control, highlighting its key features such as no programming required, oversized buttons, and suitability for seniors.

The remote control is designed with durable silicone buttons, offering reliable quality and a long lifespan, in contrast to older designs with PVC surface buttons that were prone to damage and wear.

New good design



Silicone button

- * Easy Operating
- * Reliable quality
- * Long Life (Over 5 years)
- * Big buttons

Old bad design

PVC surface button



- * Easy to damage
- * Easy to press wrong buttons
- * Easy to lose
- * Short life (1~2 years)
- * Thin and small buttons

Image: A visual comparison illustrating the improved design of the new remote with silicone buttons for enhanced durability and ease of operation, compared to older PVC button designs.

SETUP: BATTERY INSTALLATION

The remote control requires two AAA 1.5V batteries (not included). Follow these steps to install them:

1. Locate the battery compartment cover on the back of the remote control.
2. Slide the cover downwards or press the latch and lift to open the compartment.
3. Insert two AAA 1.5V batteries, ensuring the positive (+) and negative (-) terminals align correctly with the markings inside the compartment.
4. Replace the battery compartment cover by sliding it back into place until it clicks securely.

Battery type:

AAA 1.5V



Image: The open battery compartment of the remote control, illustrating where to insert two AAA 1.5V batteries.

Note: This remote control is designed for AAA 1.5V batteries, offering a longer lifespan compared to older coin cell battery designs.

An Industry Secret You Probably Don't Know
Two AAA batteries = 9 Coin Cell batteries.

NEW

**Good design
with AAA 1.5V
high-capacity battery**

Long life: 3-5 years.



OLD

**Bad design
with Coin Cell
low-capacity battery**

Short life: 0.5-1 year.



Image: A visual comparison showing the new design utilizing AAA 1.5V batteries for extended life (3-5 years) versus an older design using coin cell batteries with a shorter lifespan (0.5-1 year).

OPERATING INSTRUCTIONS

This remote control is pre-programmed and ready for use with your Carolina Electric Fireplace model Idb12000a-dd5r. Point the remote control directly at the fireplace receiver and press the desired button.

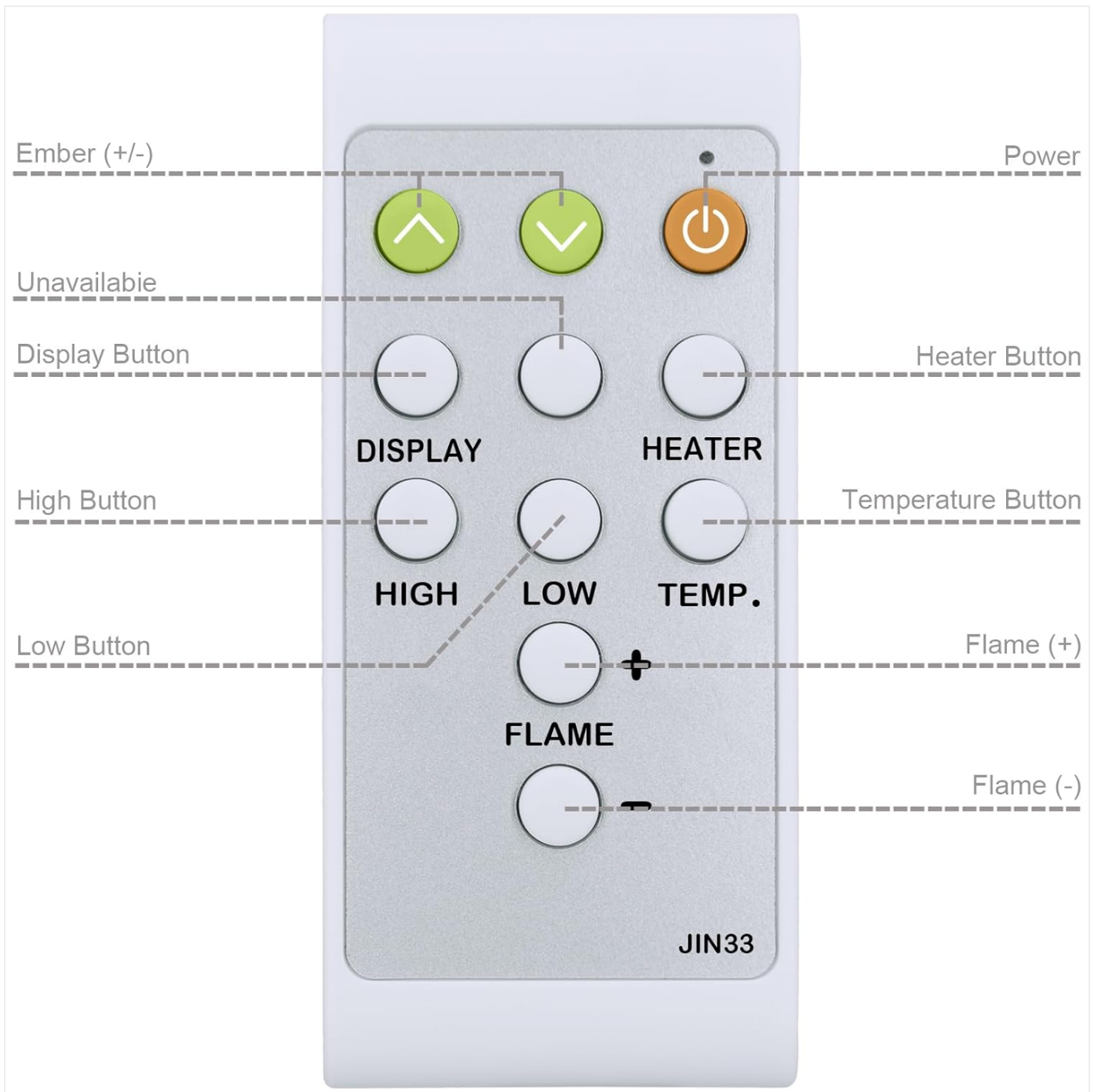

Image: A detailed diagram illustrating each button on the remote control and its corresponding function for operating the electric fireplace.

- **Power Button (Orange):** Turns the fireplace ON or OFF.
- **Ember (+/-) Buttons (Green Arrows):** Adjusts the ember bed brightness or effect.
- **Display Button:** Controls the fireplace display settings.
- **Heater Button:** Activates or deactivates the heating function.
- **High Button:** Sets the heater to high power.
- **Low Button:** Sets the heater to low power.
- **Temp. Button:** Adjusts the temperature setting.
- **Flame (+/-) Buttons:** Increases or decreases the flame brightness or effect.

MAINTENANCE

- **Battery Replacement:** Replace batteries when the remote's range decreases or it stops responding. Always use two new AAA 1.5V batteries.

- **Cleaning:** Wipe the remote control with a soft, dry cloth. Do not use liquid cleaners or abrasive materials.
- **Storage:** Store the remote in a dry place, away from direct sunlight and extreme temperatures. If storing for extended periods, remove the batteries to prevent leakage.

TROUBLESHOOTING

- **Remote not responding:**
 - Check if the batteries are inserted correctly with the correct polarity.
 - Replace old batteries with new AAA 1.5V batteries.
 - Ensure there are no obstructions between the remote control and the fireplace receiver.
 - Make sure you are within the effective range of the fireplace receiver.
- **Intermittent operation:**
 - This may indicate low battery power. Replace the batteries.
 - Ensure the remote's infrared emitter is clean and unobstructed.

SPECIFICATIONS

Model Number	C124110901D08
Compatible Fireplace	Carolina Electric Fireplace ldbl2000a-dd5r
Battery Type	2 x AAA 1.5V (not included)
Special Features	Oversized Buttons, No Programming Needed
Dimensions	Approximately 0.39 x 0.2 x 0.08 inches (Package Dimensions)
Item Weight	1.06 ounces

WARRANTY AND SUPPORT

For any questions or support regarding your XINJISHIMIN replacement remote control, please refer to the seller's contact information on your purchase platform. Keep your purchase receipt for warranty claims, if applicable.

