

manuals.plus /

› [AMPAI](#) /

› [AMPAI WiFi Mini Smart Switch + 433MHz Remote User Manual](#)

## AMPAI MNS-RF

# AMPAI WiFi Mini Smart Switch + 433MHz Remote User Manual

Model: MNS-RF

## PRODUCT OVERVIEW

The AMPAI WiFi Mini Smart Switch with 433MHz Remote is designed to integrate seamlessly into your home automation system, offering both wireless app control and traditional remote functionality. This compact device allows you to control lights, fans, or other appliances with ease, enhancing convenience and energy efficiency.

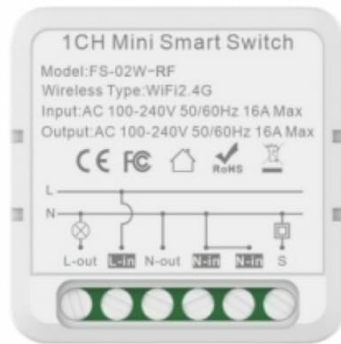

Figure 1: The AMPAI WiFi Mini Smart Switch (left) and its accompanying 433MHz remote control (right).



Figure 2: Overview of the Mini Smart Switch highlighting its compatibility with Smart Life App, Google Assistant, and Amazon Alexa, along with the included remote control.

SPECIFICATIONS

Feature	Detail
Model Number	MNS-RF
Product Dimensions	1.63 x 1.63 x 0.84 inches
Weight	3.2 ounces
Operation Mode	Wireless
Current Rating	16 Amps
Operating Voltage	AC 100V-240V 50/60Hz (120 Volts nominal)
Contact Type	Normally Open

Connector Type	Clamp
Terminal	Wifi
Circuit Type	1/2 Way
Actuator Type	Electronic
WIFI Frequency	2.4GHz
Working Temperature	-10~45°C

## Product Parameters

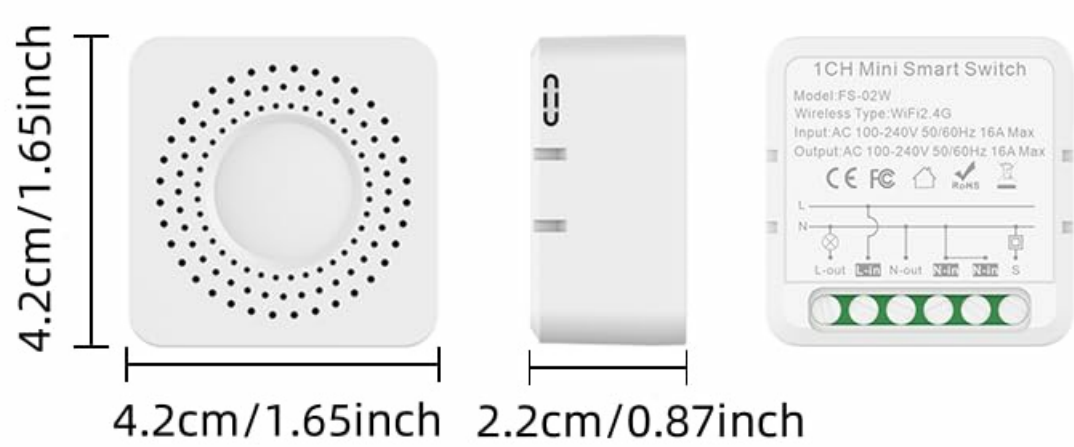

Color	White
Rated Voltage	AC 100V-240V 50/60Hz
Working Temperature	-10~45°C
WIFI Frequency	2.4GHz
Communication Mode	WiFi
Load Current	16A

Figure 3: Detailed product parameters including dimensions, voltage, and operating temperature.

## SETUP AND INSTALLATION

### What's in the Box

- 1 x AMPAI WiFi Mini Smart Switch
- 1 x 433MHz Remote Control

## Installation Guidelines

The Mini Smart Switch is designed for compact installation, fitting discreetly into standard wall switch boxes. It allows you to smart-enable your existing switches without needing to replace them.

# Compact and easy to install

The latest generation of space-saving, ultra-compact units are easy to install in existing junction boxes.

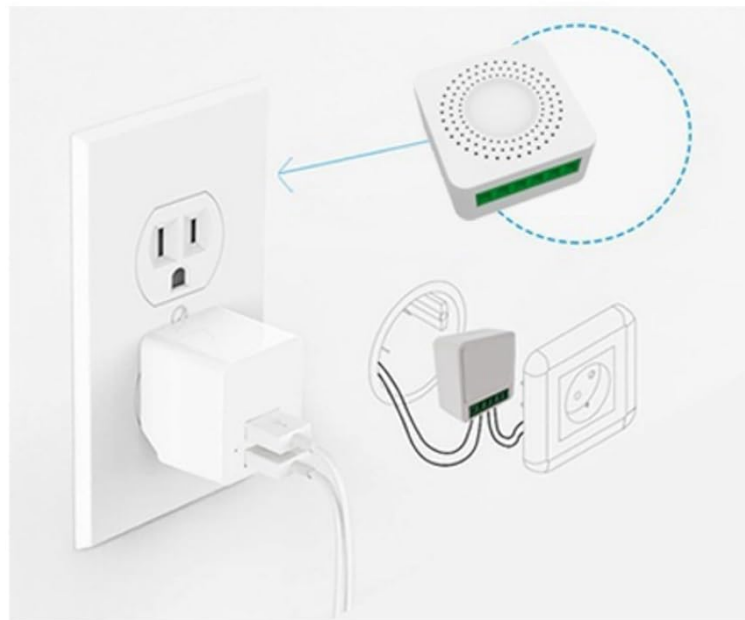

Figure 4: The compact design of the Mini Smart Switch allows for easy installation within existing junction boxes, preserving your original decor.

## Wiring Connection

Ensure power is disconnected before attempting any wiring. The switch supports both connecting directly to a lamp or integrating with an existing wall switch.

# Connection mode

## 1 Route wiring diagram:

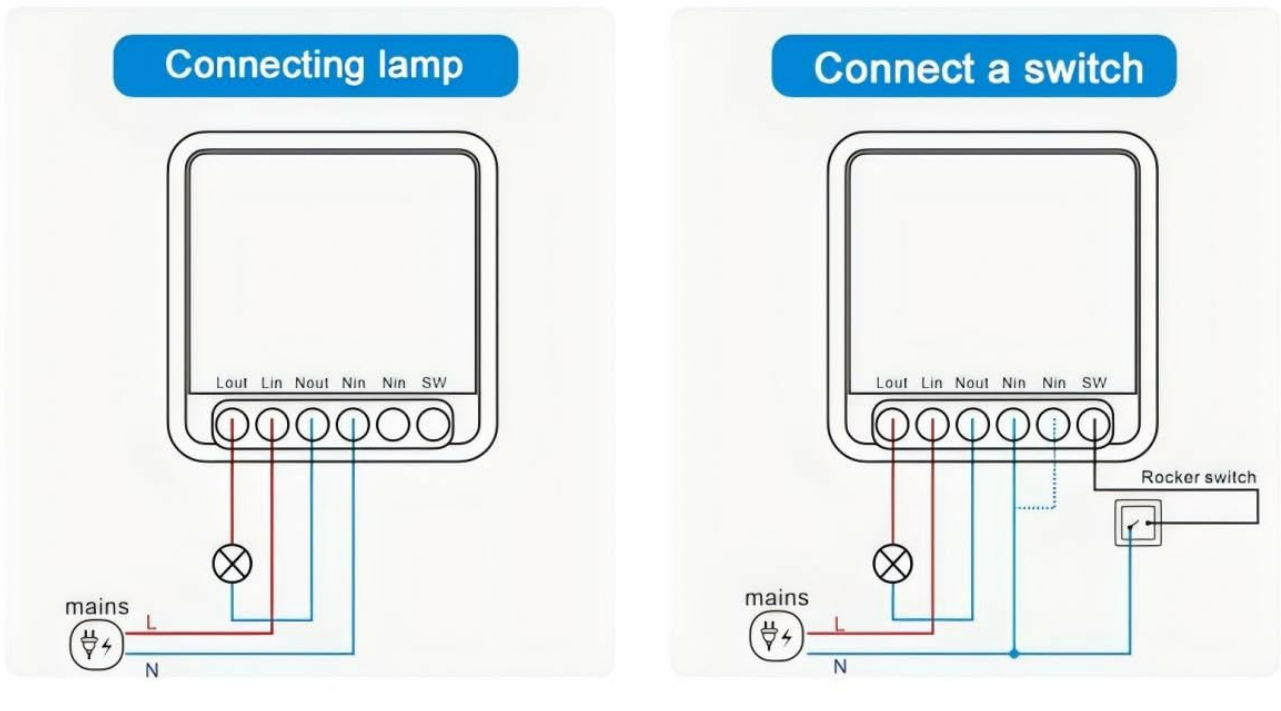

Figure 5: Wiring diagrams for connecting the smart switch. Left: Connecting directly to a lamp. Right: Connecting with an existing rocker switch.

For detailed visual instructions on wiring and initial setup, please refer to the product video below.

### App Setup (Tuya Smart Life App)

The Mini Smart Switch connects directly to your 2.4GHz Wi-Fi network, eliminating the need for an additional hub. Download the "Smart Life" app from your device's app store (iOS or Android).

1. Ensure the smart switch is powered on.
2. Open the Smart Life app and tap "Add Device".
3. Long press the button on the smart switch until its indicator light blinks rapidly, indicating it's in pairing mode.
4. Follow the in-app instructions to connect the switch to your Wi-Fi network.

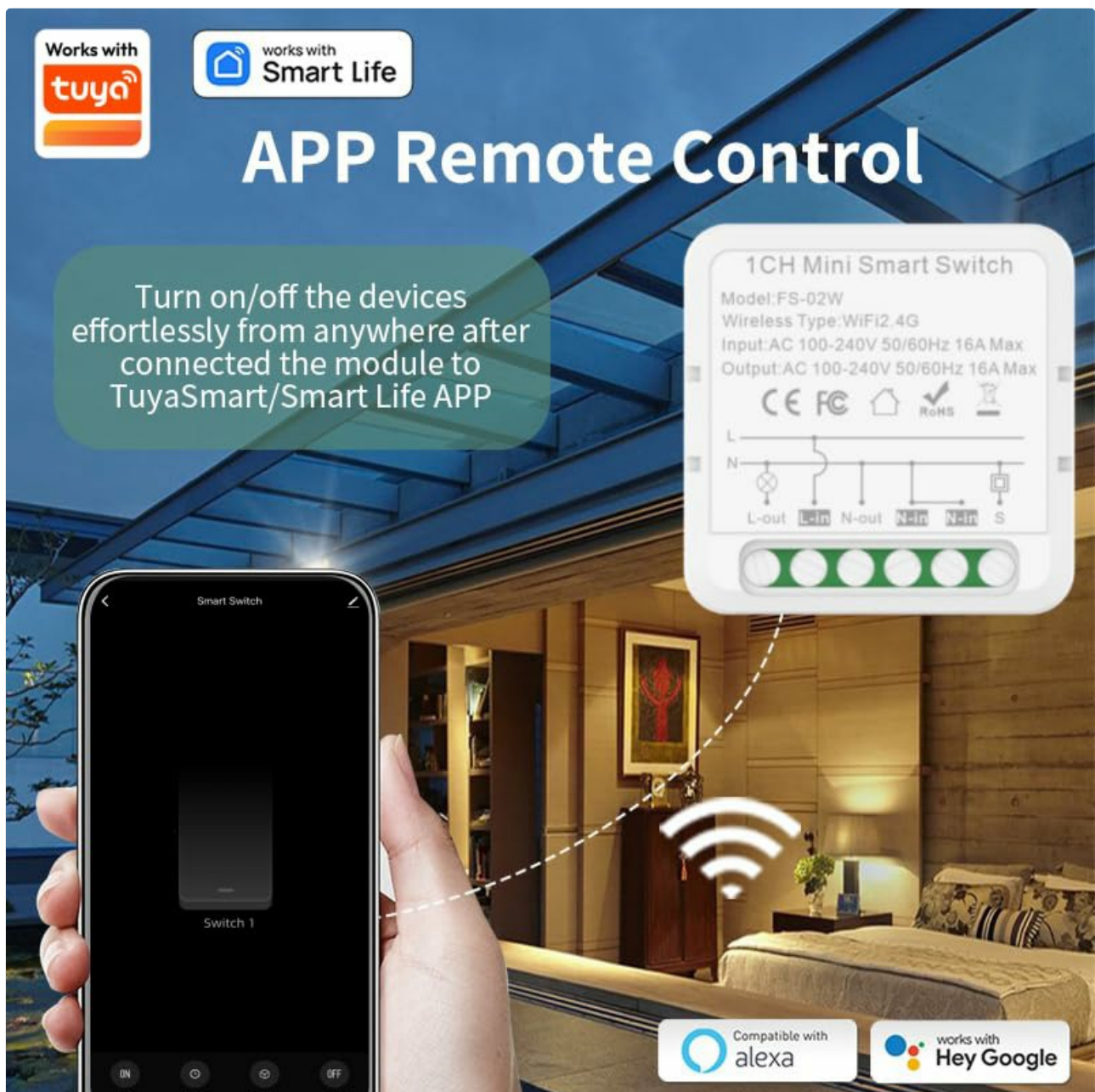

Figure 6: The Smart Life app interface, demonstrating how to turn devices on/off remotely after connecting the module.

## OPERATING INSTRUCTIONS

### Remote Control Operation

The included 433MHz remote control provides convenient wireless operation with a range of up to 100ft. It can control up to three mini smart switches.



# Remote Control

You can control the switch by remote control without having to walk to the switch and release your feet.



Figure 7: The 433MHz remote control allows you to control the switch from a distance of up to 12 meters (approximately 40 feet) without needing to be near the switch.

To configure the remote control with the smart switch, follow the instructions within the Smart Life app under "RF remote control setup".

## Voice Control (Alexa & Google Home)

Once connected to the Smart Life app, you can link your Mini Smart Switch to Amazon Alexa or Google Home for seamless voice control.

- Enable the "Smart Life" skill in your Alexa or Google Home app.
- Discover devices.
- Use voice commands such as "Alexa, turn on the living room light" or "Hey Google, turn off the fan."



Figure 8: Control your smart switch using voice commands through Amazon Alexa or Google Home devices.

## Scheduling and Automation

The Smart Life app allows you to set schedules, timers, and create scenes for automated control of your devices.

- **Schedules:** Program devices to turn on or off at specific times (e.g., turn on lights at 6:00 PM).
- **Timers:** Set countdown timers for devices to switch off after a set duration.
- **Scenes:** Create custom scenes to control multiple devices with a single command or tap (e.g., "Good Morning" scene turns on bedroom lights and coffee maker).



# Timer Schedule

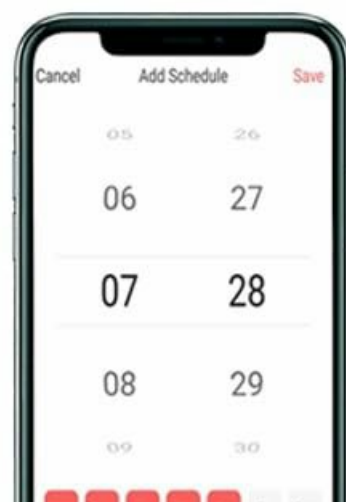
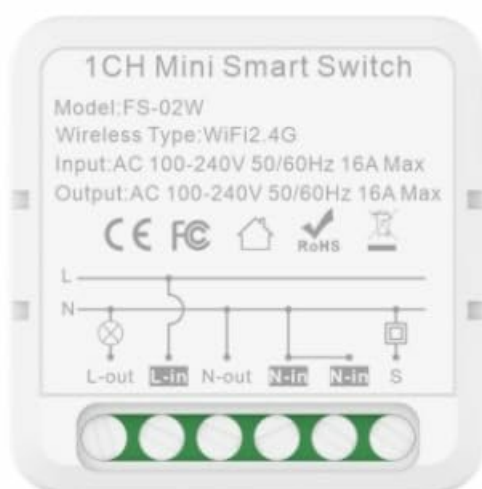

Figure 9: Examples of setting timer schedules within the Smart Life app to automate device operation.

## MAINTENANCE

The AMPAI Mini Smart Switch is designed for durability and low maintenance. Its flame-retardant PC material and built-in overload protection (16A/1800W) ensure safe operation.

- **Cleaning:** Wipe the exterior of the switch with a soft, dry cloth. Do not use abrasive cleaners or liquids.
- **Firmware Updates:** Periodically check the Smart Life app for available firmware updates to ensure optimal performance and security.
- **Memory Function:** The switch features a built-in memory function, ensuring your devices return to their previous state after a power outage, eliminating the need for manual adjustments.

## TROUBLESHOOTING

### Common Issues and Solutions

- **Device not connecting to Wi-Fi:**

- Ensure your Wi-Fi network is 2.4GHz. The switch does not support 5GHz networks.
  - Verify your Wi-Fi password is correct.
  - Move the switch closer to your Wi-Fi router.
  - Reset the switch by long-pressing its button until it blinks rapidly, then try pairing again.
- **Remote control not working:**
    - Ensure the remote's battery is not depleted.
    - Re-pair the remote control with the smart switch via the Smart Life app's "RF remote control setup" section.
    - Check for obstructions between the remote and the switch.
- **Voice control not responding:**
    - Confirm the Smart Life skill is enabled in your Alexa or Google Home app.
    - Ensure the smart switch is properly linked and named in the voice assistant app.
    - Check your internet connection.
- **Switch is unresponsive:**
    - Check the power supply to the switch.
    - Perform a power cycle by turning off the power to the switch for a few seconds, then turning it back on.

## PRODUCT VIDEO TUTORIAL

---

Watch this official video for a comprehensive guide on wiring connections, product distribution, and remote control configuration.

Your browser does not support the video tag.

Video 1: A detailed tutorial demonstrating the wiring connection method, product distribution (pairing with app), and remote control configuration for the AMPAI Mini Smart Switch.

## WARRANTY AND SUPPORT

---

For information regarding warranty coverage, technical support, or to access additional resources, please refer to the official AMPAI website or contact their customer service directly. Contact details are typically provided on the product packaging or the manufacturer's official online channels.

You can visit the [AMPAI Store on Amazon](#) for more product information and support.