



Manuals.plus /

› Mericonia /

› Mericonia Rattan Buffet Cabinet Instruction Manual

## Mericonia RA-4D-01

# Mericonia Rattan Buffet Cabinet Instruction Manual

Model: RA-4D-01 | Brand: Mericonia

## INTRODUCTION

---

Thank you for choosing the Mericonia Rattan Buffet Cabinet. This manual provides detailed instructions for the safe assembly, proper operation, and effective maintenance of your new furniture. Please read all instructions carefully before beginning assembly and retain this manual for future reference.



Image: The Mericonia Rattan Buffet Cabinet, showcasing its natural wood finish and woven rattan doors, suitable for various room settings.

## SAFETY INFORMATION

---

### Important Safety Precautions:

- Always secure the cabinet to the wall using the provided wall-mounted mounting to prevent tipping. This is crucial for child and pet safety.
- Ensure the cabinet is assembled on a stable, level surface to prevent wobbling or instability.
- Keep the area around the cabinet clear of heavy objects that could fall and cause damage or injury.
- Avoid placing excessively heavy items on the top shelf or within the cabinet to prevent structural strain or tipping.
- Always unplug and turn off any electrical appliances placed on or inside the cabinet before cleaning or moving the unit.

# Living room Rattan TV stand



Image: Illustration highlighting the anti-tip device and the cabinet's sturdy construction, emphasizing safety and stability.

## PACKAGE CONTENTS

Before assembly, verify that all parts and hardware are present. If any items are missing or damaged, please contact customer service immediately.

- Wooden Panels (Top, Bottom, Sides, Back)
- Rattan Doors (4 units)
- Adjustable Shelves (1 unit)
- Metal Door Handles (4 pairs)
- Hinges and Mounting Hardware
- Adjustable Feet
- Anti-Tip Device
- Assembly Hardware (screws, dowels, cam locks, etc.)
- Instruction Manual (this document)

## ASSEMBLY INSTRUCTIONS

Follow these step-by-step instructions carefully. It is recommended to have two people for assembly.

### Step 1: Prepare Components

Unpack all components and lay them out on a clean, soft surface (e.g., a blanket or carpet) to prevent scratches. Identify each part using the labels provided.

### Step 2: Assemble Main Frame

Connect the side panels to the bottom and top panels using the designated hardware (e.g., cam locks and dowels). Ensure all connections are secure and flush.

### Step 3: Install Back Panels

Slide the back panels into the grooves of the cabinet frame. Secure them using the back panel connectors. Ensure the clips are fully inserted into the gap for a firm fit.

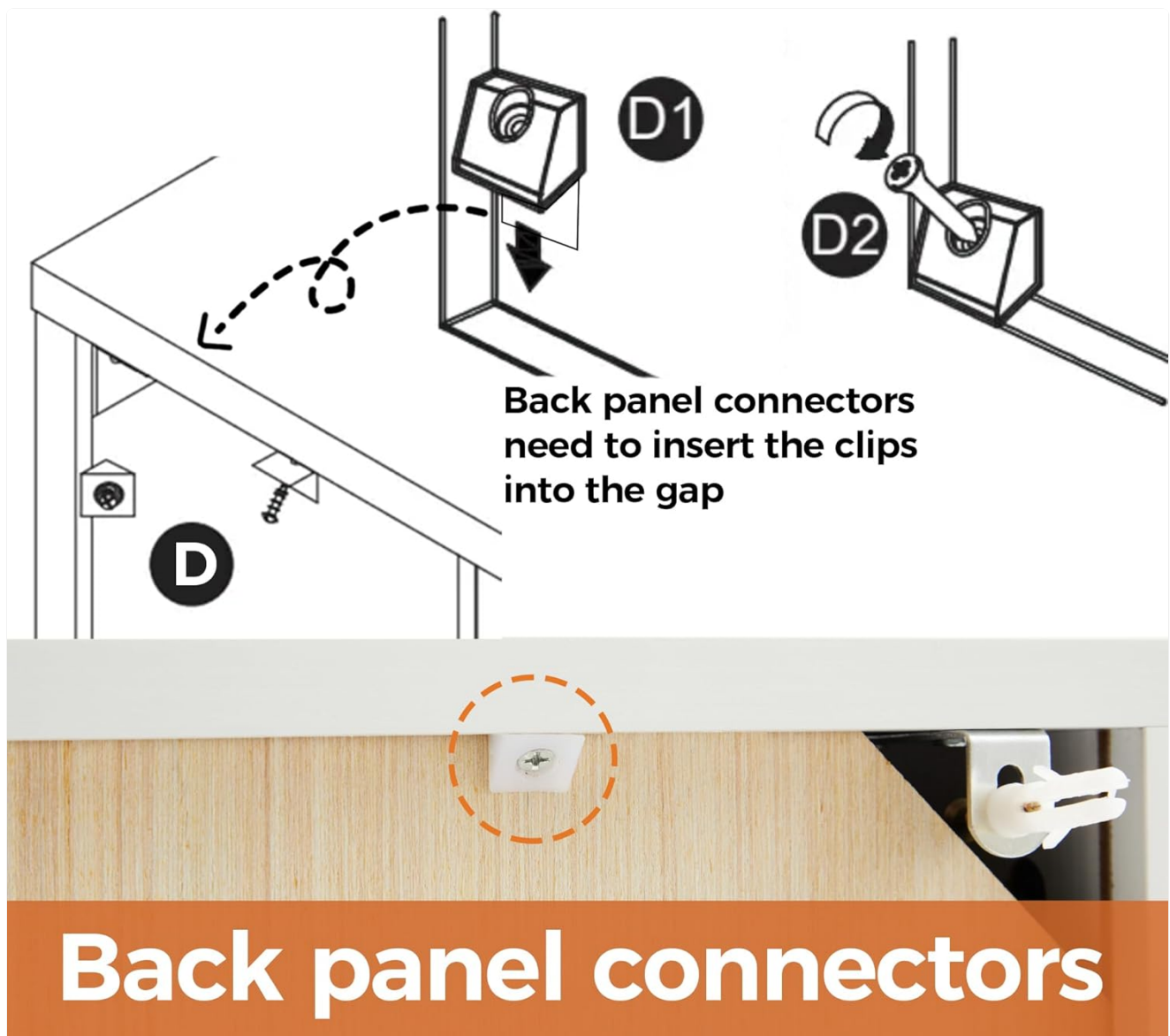

Image: Detailed diagram illustrating the correct method for inserting back panel connectors into the cabinet's frame.

### Step 4: Attach Doors and Adjust Hinges

Attach the hinges to the doors and then to the cabinet frame. Once the doors are installed, adjust them for proper alignment and gap. Use a screwdriver to fine-tune the hinge screws:

**A:** Adjust screw A to control the up and down position of the door.

**B:** Adjust screw B to control the gap between the door and the cabinet.

**C:** Adjust screw C to control the gap between adjacent doors.

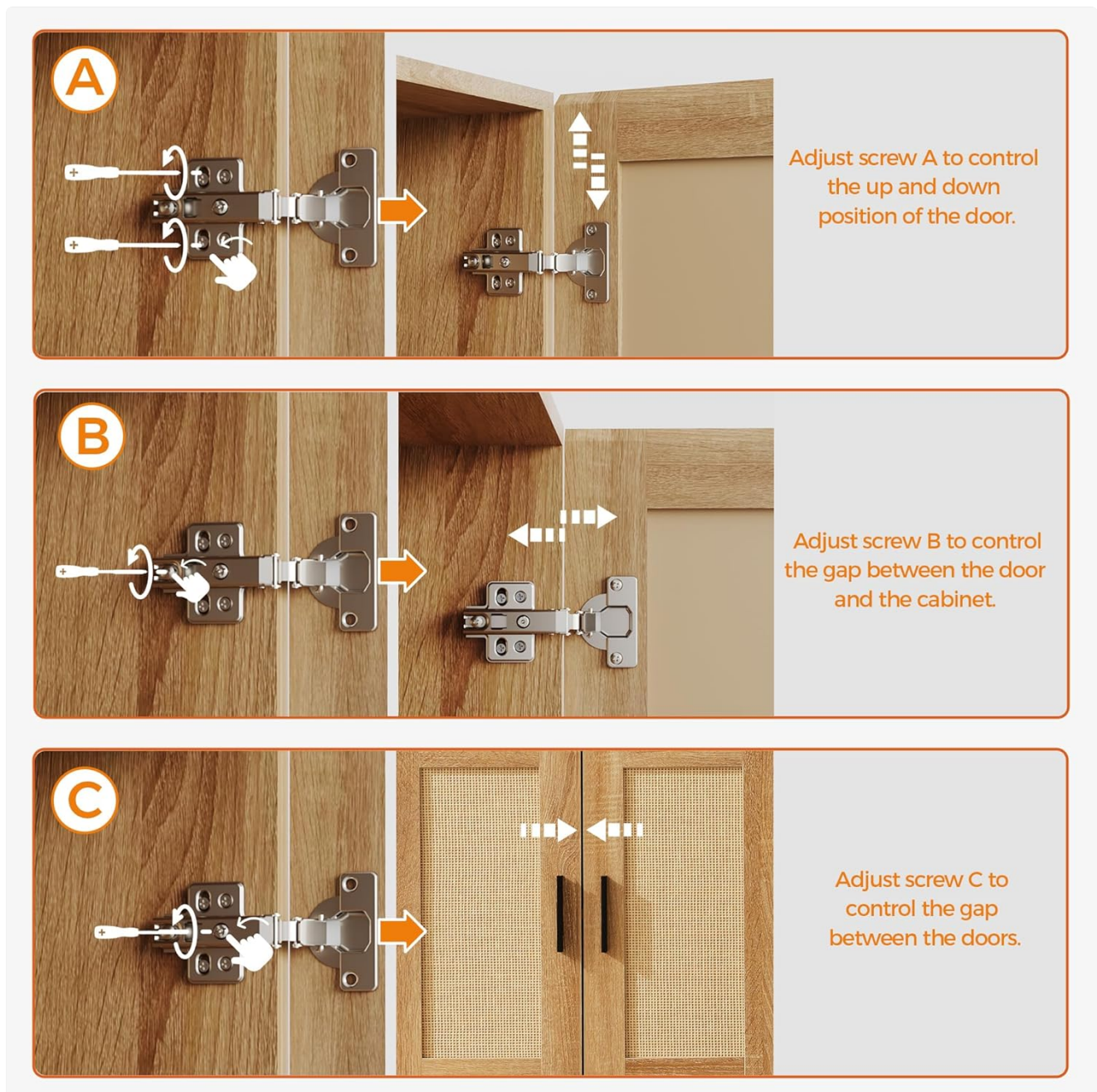

Image: Visual guide demonstrating how to adjust the cabinet door hinges using screws A, B, and C for precise alignment.

## Step 5: Install Adjustable Shelves

Insert the shelf pins into the desired holes inside the cabinet. Place the adjustable shelf on top of the pins. The shelves can be moved to different heights to accommodate items of various sizes.

# Product Dimensions

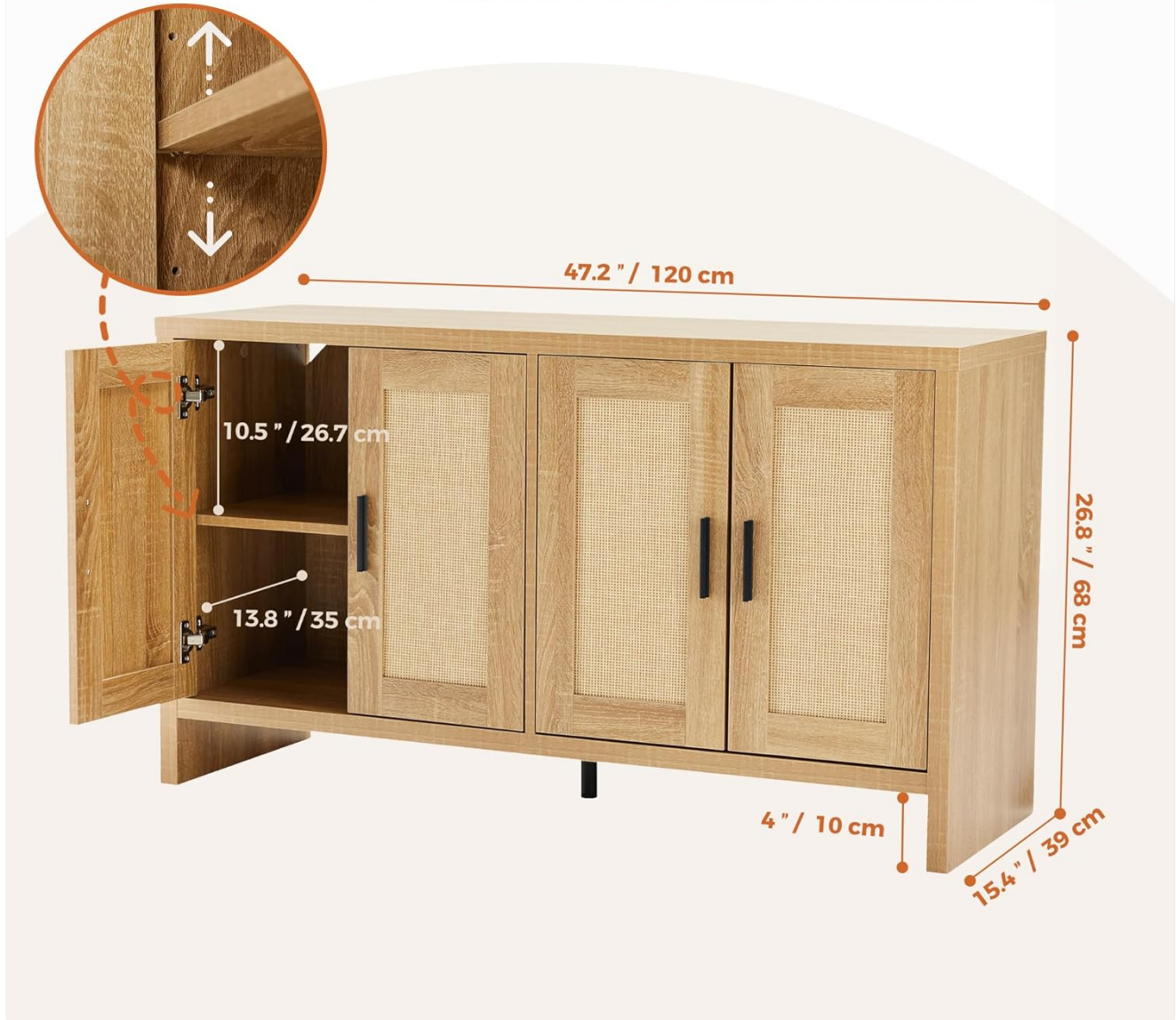

Image: An illustration detailing the overall product dimensions and highlighting the adjustable shelf feature within the cabinet.

## Step 6: Secure Anti-Tip Device

Attach the anti-tip device to the back of the cabinet and then to a wall stud using the provided hardware. This step is essential for safety and stability, especially in households with children or pets.

## OPERATING INSTRUCTIONS

The Mericonia Rattan Buffet Cabinet is designed for versatile storage and display. Its primary function is to provide organized space for various household items.

- **Door Operation:** Gently pull the metal handles to open the rattan doors. Push them firmly to close. Avoid slamming the doors to prevent damage to hinges and the cabinet structure.
- **Adjustable Shelves:** To change the shelf height, remove all items from the shelf, lift the shelf, remove the pins, reposition the pins to the desired height, and then place the shelf back on the pins.
- **Weight Capacity:** Distribute weight evenly across shelves. Do not exceed the recommended weight capacity for each shelf to ensure stability and longevity of the cabinet.

## Stabler & Sturdier



Anti-tip device



High base with extra storage

Image: An open view of the cabinet's interior, demonstrating its spacious storage compartments and adjustable shelf, suitable for various kitchen or dining items.

## MAINTENANCE AND CARE

Proper care will extend the life and appearance of your cabinet.

- **Cleaning:** Wipe the cabinet surfaces with a soft, damp cloth. Avoid using harsh chemicals, abrasive cleaners, or excessive moisture, as these can damage the wood finish and rattan.
- **Spills:** Immediately wipe up any spills to prevent staining or water damage to the wood.
- **Sunlight Exposure:** Avoid prolonged direct sunlight exposure, which can cause fading or discoloration of the wood and rattan.
- **Humidity:** Maintain a stable room temperature and humidity level to prevent warping or cracking of the wood.
- **Hardware Check:** Periodically check all screws and connections to ensure they remain tight. Tighten if necessary.

## TROUBLESHOOTING

If you encounter any issues with your cabinet, refer to the following common problems and solutions:

Problem	Possible Cause	Solution
Cabinet is wobbly	Uneven floor; loose connections	Adjust the leveling feet at the bottom of the cabinet. Tighten all assembly screws.
Doors are misaligned or do not close properly	Hinges need adjustment; incorrect hinge installation	Refer to Step 4 in the Assembly Instructions for hinge adjustment (screws A, B, C). Ensure hinges are installed correctly.
Rattan appears damaged or loose	Manufacturing defect; rough handling	Contact customer service for assistance. Avoid pulling or picking at the rattan.

## SPECIFICATIONS

Feature	Detail
Brand	Mericonia
Model Name	Rattan Buffet Cabinet RA-4D-01
Color	Natural
Product Dimensions (D x W x H)	15.35"D x 47.24"W x 26.77"H
Item Weight	42.8 Pounds
Material	Rattan and Wood
Number of Doors	4
Number of Shelves	1 (Adjustable)
Mounting Type	Floor Mount (with wall-mounted safety option)
Assembly Required	Yes

## WARRANTY AND SUPPORT

Mericonia stands behind the quality of its products. For any questions, concerns, or assistance with assembly, missing parts, or product defects, please contact Mericonia customer service. Refer to your purchase documentation for specific warranty details and contact information.

You can also visit the official Mericonia store on Amazon for more information and support: [Mericonia Store](#)