



[Manuals.plus](#) /

> [podofo](#) /

> PODOFO Car Stereo User Manual

podof0 4Core 2G+64G with Knob

PODOFO Car Stereo User Manual

Model: 4Core 2G+64G with Knob

1. INTRODUCTION

This manual provides comprehensive instructions for the installation, operation, and maintenance of your PODOFO 2G 64G Car Stereo. This advanced car stereo system is designed for select Ford models, offering a 7-inch IPS touchscreen with Wireless CarPlay, Android Auto, Bluetooth, DAB+, OBD2, WiFi, FM/RDS, GPS, SWC, and backup camera support. Please read this manual thoroughly before use to ensure proper installation and optimal performance.



Figure 1.1: PODOFO 7-inch Car Stereo (4Core 2G+64G with Knob) with included accessories and smartphone integration icons.

2. VEHICLE COMPATIBILITY

This car stereo is compatible with various Ford models. Please verify your vehicle's make, model, and year against the list below to ensure proper fitment.

Carplay Radio for Ford

Before Installation



After Installation

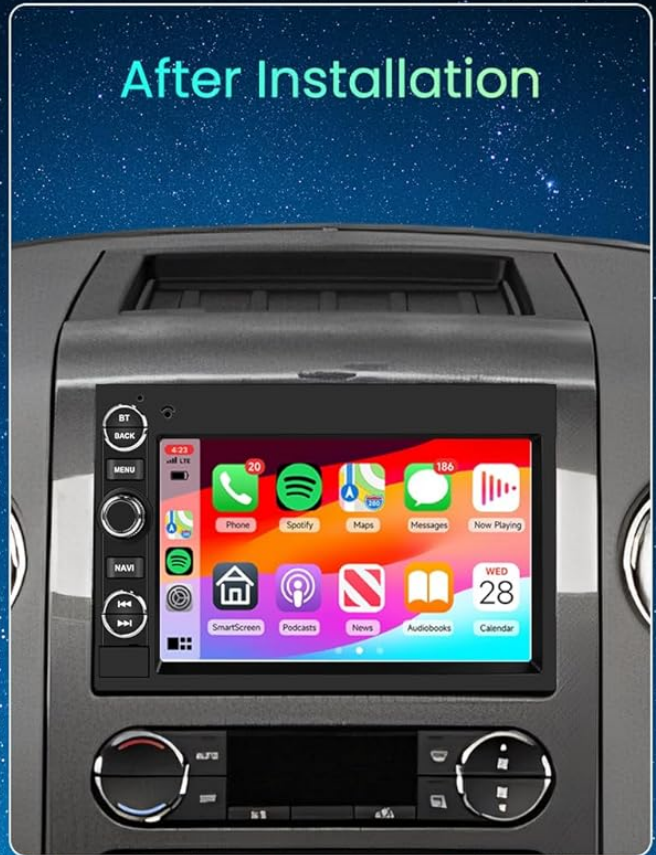

For F150 2004~2008
For F250/F350 2006~2014
For E250/E350 2009~2014
For Shelby GT500 2007~2009
For Five Hundred 2005~2007
For Montego 2005~2007
For Milan 2006~2009
For Sable 2008~2009
For Mountaineer 2007~2010
For Fusion 2006~2009
For Taurus 2008~2009

For Escape 2008~2012
For Freestyle 2005~2007
For Freestar 2004~2007
For MKX 2007~2009
For Mark LT 2006~2008
For Edge 2007~2010
For Focus 2005~2007
For Mustang 2005~2009
For Explorer(U251) 2006~2010
For Expedition 2007~2014
For Expedition EL/MAX(U354)2007~2014

Figure 2.1: Visual comparison of a Ford dashboard before and after the installation of the PODOFO car stereo, demonstrating seamless integration.

2.1 Compatible Ford Models:

- Ford F150 (2004-2008)
- Ford F250/F350 (2006-2014)
- Ford E250/E350 (2009-2014)
- Ford Edge (2007-2010)
- Ford Taurus/Sable (2008-2009)

- Ford Fusion/Milan (2006-2009)
- Ford Focus/Montego/Freestyle (2005-2007)
- Ford Explorer (U251) (2006-2010)
- Ford Escape (2008-2012)
- Ford Expedition (2007-2014)
- Lincoln MKX (2007-2009)
- Lincoln Mark LT (2006-2008)
- Ford Mustang (2005-2009)



Figure 2.2: Comprehensive list of compatible Ford models and years, alongside visual examples of various Ford dashboards.

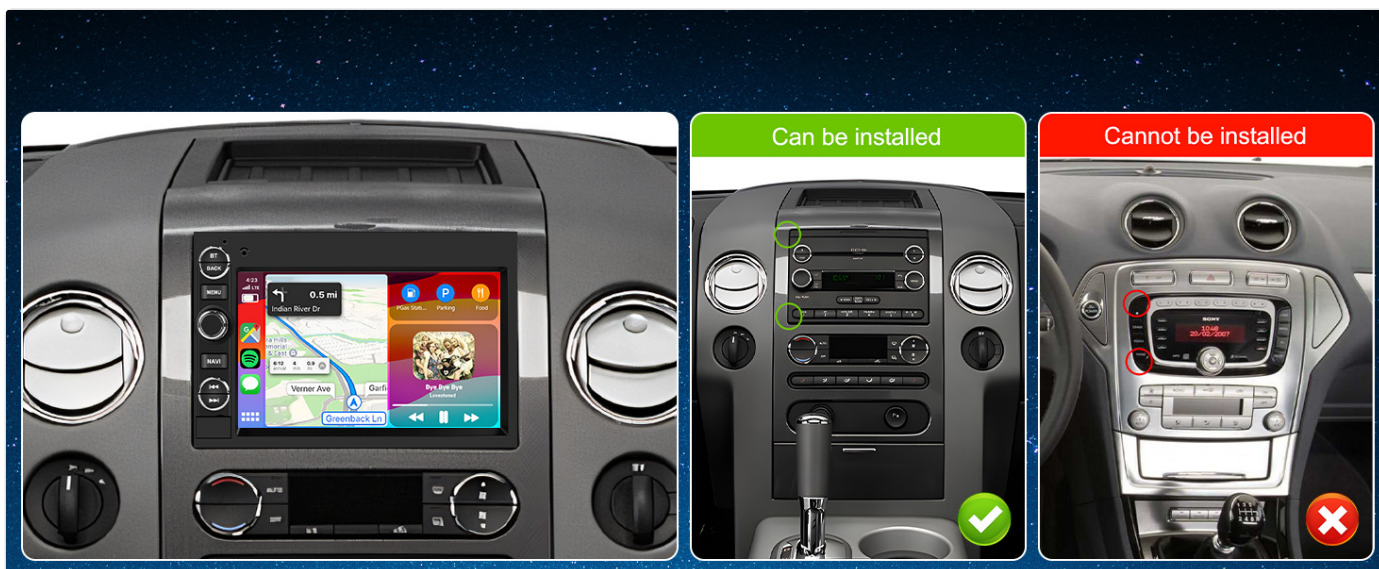

Figure 2.3: Visual guide indicating which Ford dashboard configurations are suitable for installation and which are not.

3. WHAT'S IN THE BOX

Upon opening the package, please ensure all the following components are present and in good condition:

- PODOFO Car Stereo Unit
- Power Cable
- RCA Cable
- 3.8Pin Canbus Plug

- USB Cable
- Rear Camera Input Cable
- Radio Antenna
- GPS Antenna
- Canbus Decoder
- External Microphone
- Backup Camera (if included in package variant)
- User Manual

Size & Package Contents

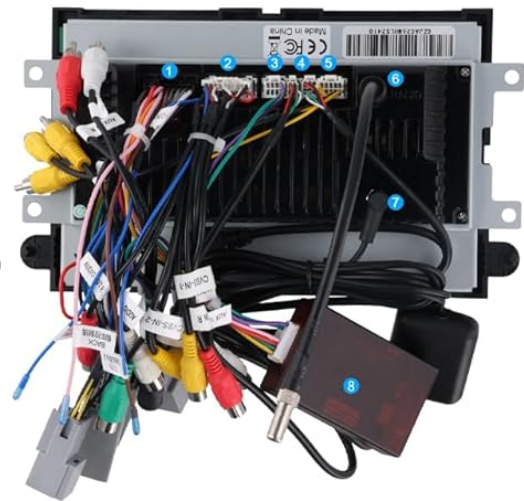
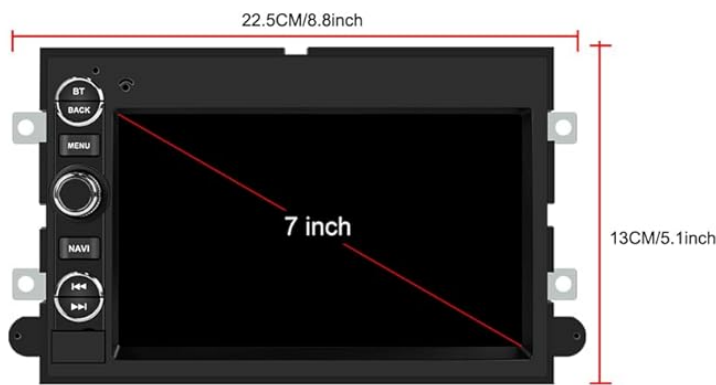

1. Power Cable
2. RCA Cable
3. 8Pin Canbus Plug
4. USB Cable
5. Rear Camera Input Cable
6. Radio Antenna
7. GPS Antenna
8. Canbus



Power Cable



RCA Cable



Rear Camera



Adapter Antenna



MIC



Canbus



GPS Antenna



USB Cable



User Manual



Camera

Figure 3.1: Overview of the PODOFO car stereo's dimensions and a visual representation of all components included in the package.

4. SETUP AND INSTALLATION

Proper installation is crucial for the optimal performance of your car stereo. It is recommended that installation be performed by a qualified professional. Always disconnect the vehicle's battery before beginning any electrical work.

4.1 Wiring Diagram

Refer to the following diagrams for correct wiring connections. Ensure all connections are secure to prevent malfunctions.

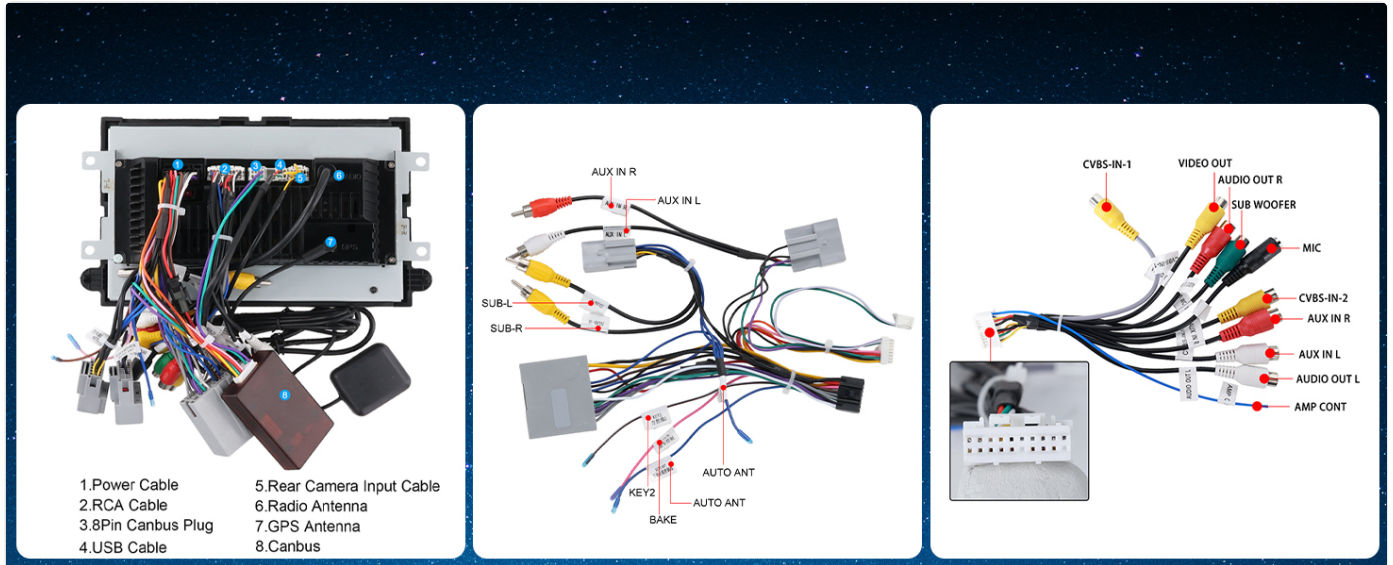

Figure 4.1: Comprehensive wiring diagrams illustrating connections for power, RCA cables, and other peripheral inputs for the car stereo system.

4.2 Backup Camera Installation (If Applicable)

If your package includes a backup camera, follow these steps for installation and wiring. The camera provides a 170-degree ultra-angle view with 1280 x 720 resolution and IP67 waterproof rating.



Figure 4.2: Close-up view of the AHD reverse camera, highlighting its HD image quality, night vision capabilities, wide-angle lens, and waterproof design.



Figure 4.3: Step-by-step wiring guide for connecting the backup camera to the car stereo system, showing cable routing and connections.

1. Mount the backup camera securely at the rear of your vehicle.
2. Connect the camera's video output cable to the "Rear Camera Input" on the stereo unit.
3. Connect the camera's power wire to your vehicle's reverse light circuit (typically the positive wire of the reverse light) to enable automatic display when shifting into reverse.
4. Route all cables safely and discreetly to avoid interference or damage.

5. OPERATING INSTRUCTIONS

Your PODOFO car stereo offers a wide range of features for an enhanced driving experience. This section covers the basic operation of key functions.

5.1 Wireless CarPlay & Android Auto

Connect your smartphone wirelessly or via USB to access navigation, music, calls, and more directly on the 7-inch IPS touchscreen.

Wireless/Wired Carplay & Android Auto



Figure 5.1: Display of the car stereo interface showing various CarPlay and Android Auto applications, demonstrating both wireless and wired connectivity options.

1. Ensure Bluetooth is enabled on your smartphone.
2. On the stereo, navigate to the CarPlay/Android Auto icon and select it.
3. Follow the on-screen prompts to pair your device. For wired connection, simply connect your phone via a USB cable.

5.2 Mirror Link & Split Screen

Mirror your phone's screen onto the stereo display or use the split-screen function to run two applications simultaneously,

such as navigation and music.



Figure 5.2: Illustration of the car stereo's capabilities including CarPlay, Android Auto, Mirror Link, and Split Screen, with an emphasis on voice control functionality.



Figure 5.3: Demonstration of Mirror Link and Split Screen features, displaying a video playing on one side and a navigation map on the other.



Figure 5.4: Example of the Split Screen mode, showing three different applications (FM radio, music player, and another app) running

concurrently on the display.

5.3 Bluetooth Connectivity

Enjoy hands-free calling and wireless audio streaming via Bluetooth 5.0. An external microphone ensures clear call quality.



Figure 5.5: The car stereo's Bluetooth interface, showing options for making calls and streaming music wirelessly from a connected smartphone.

1. Go to the Bluetooth menu on the stereo.

2. Enable Bluetooth on your phone and search for available devices.
3. Select "PODOFO Car Stereo" from the list and confirm pairing.

5.4 FM/RDS Radio

Tune into your favorite radio stations with FM/RDS functionality, providing station information and enhanced signal reception.



Figure 5.6: The car stereo's interface for Bluetooth and FM Radio, showing frequency tuning and station presets.

1. Select the "Radio" application from the main menu.
2. Use the tuning controls to find desired stations or use the auto-scan function.
3. Save frequently listened stations to presets for quick access.

5.5 GPS Navigation & WiFi

Utilize offline maps with the included GPS antenna or connect to WiFi for online navigation apps like Google Maps and Waze. Stay updated with global weather information.



Figure 5.7: The car stereo's GPS navigation display, showing a map with route guidance and various navigation app icons.



Figure 5.8: The car stereo's WiFi/Hotspot interface, displaying available networks and various application icons that can be downloaded and used with internet access.

1. For offline maps, ensure the GPS antenna is properly connected and maps are downloaded.

2. To use online features, connect to a WiFi network via your phone's hotspot or a dedicated WiFi source.
3. Access navigation apps from the main menu.

5.6 Steering Wheel Control (SWC)

Program your vehicle's steering wheel controls to manage stereo functions for safe and convenient operation.



Figure 5.9: The car stereo's interface for learning and configuring steering wheel controls, showing various assignable functions.

1. Navigate to the "Steering Wheel Control" settings in the stereo menu.
2. Follow the on-screen instructions to assign functions to your vehicle's steering wheel buttons.

6. SPECIFICATIONS

Feature	Specification
Operating System	Android
RAM	2GB
ROM	64GB
Display Size	7 Inches
Display Resolution	1080P (for video playback)
Connectivity	Bluetooth 5.0, USB, Wi-Fi
Special Features	Wireless CarPlay, Android Auto, DAB+, OBD2, GPS, SWC, Backup Camera Support
Audio Output Mode	APE/FLAC/WAV/MP3/WMA etc.
Mounting Type	Dashboard Mount
Item Weight	1.76 pounds
Package Dimensions	9.84 x 5.91 x 3.94 inches

7. TROUBLESHOOTING

This section provides solutions to common issues you might encounter. If the problem persists, please contact customer support.

Problem	Possible Cause	Solution
No Power	Loose power connection, blown fuse, vehicle battery issue.	Check all power cables and connections. Inspect vehicle fuses. Ensure vehicle battery is charged.
No Sound	Speaker wires disconnected, volume too low, incorrect audio source selected.	Verify speaker wire connections. Increase volume. Select the correct audio input source (e.g., FM, Bluetooth, CarPlay).
CarPlay/Android Auto Not Connecting	Bluetooth/USB connection issue, phone settings, incompatible phone.	Ensure Bluetooth is on and paired. Try a different USB cable. Restart phone and stereo. Check phone's CarPlay/Android Auto settings.
Backup Camera Not Displaying	Camera wiring issue, incorrect input selected, camera malfunction.	Check camera power and video signal connections. Ensure vehicle is in reverse. Verify camera is functional.
GPS Signal Weak/Lost	GPS antenna placement, environmental interference.	Ensure GPS antenna has a clear view of the sky. Avoid placing near metal objects.

8. MAINTENANCE

To ensure the longevity and optimal performance of your PODOFO car stereo, follow these simple maintenance guidelines:

- **Cleaning the Screen:** Use a soft, lint-free cloth specifically designed for electronic screens. Do not use abrasive cleaners or solvents. Gently wipe the screen to remove dust and fingerprints.
- **General Cleaning:** Wipe the exterior of the unit with a soft, dry cloth. Avoid spraying liquids directly onto the unit.
- **Software Updates:** Periodically check for software updates from the manufacturer (if available) to ensure the system runs efficiently and has the latest features. Updates can typically be performed via WiFi.
- **Environmental Conditions:** Avoid exposing the unit to extreme temperatures, direct sunlight for prolonged periods, or excessive moisture.
- **Cable Connections:** Periodically check all cable connections to ensure they are secure and free from corrosion or damage.

9. WARRANTY AND SUPPORT

PODOFO is committed to providing high-quality products and excellent customer service. Your car stereo comes with the following support:

- **Warranty:** 2-Year Replacement Warranty.
- **Money-Back Guarantee:** 30-day Money-Back Guarantee.
- **Technical Support:** Lifetime Technical Support.
- **Customer Service:** Professional technical support and customer service are available. For questions regarding installation or use, please contact Podofotech directly.

To contact support, you can typically find contact information on the seller's page or through the official Podofotech website. Please have your product model and purchase details ready when contacting support.



Figure 9.1: Overview of PodofO's customer service commitments, including quick reply times, return policy, replacement period, and lifetime technical support.