



Manuals.plus /

- › SNDOAS /
- › SNDOAS GF3990WH 36-inch Under Cabinet Range Hood User Manual

## SNDOAS GF3990WH

# SNDOAS GF3990WH 36-inch Under Cabinet Range Hood User Manual

Model: GF3990WH | Brand: SNDOAS

## 1. INTRODUCTION

---

Thank you for choosing the SNDOAS GF3990WH 36-inch Under Cabinet Range Hood. This manual provides essential information for the safe and efficient installation, operation, and maintenance of your new appliance. Please read these instructions thoroughly before use and retain them for future reference.

## 2. IMPORTANT SAFETY INFORMATION

---

To reduce the risk of fire, electric shock, or injury, observe the following:

- Read all instructions before operating this appliance.
- Installation work and electrical wiring must be done by qualified person(s) in accordance with all applicable codes and standards, including fire-rated construction.
- Do not operate any fan with a damaged cord or plug. Discard fan or return to an authorized service facility for examination and/or repair.
- Sufficient air is needed for proper combustion and exhausting of gases through the flue (chimney) of fuel-burning equipment to prevent back-drafting. Follow the heating equipment manufacturer's guideline and safety standards such as those published by the National Fire Protection Association (NFPA), and the American Society for Heating, Refrigeration and Air Conditioning Engineers (ASHRAE), and the local code authorities.
- When cutting or drilling into wall or ceiling, do not damage electrical wiring and other hidden utilities.
- Ducted fans must always be vented to the outdoors.
- This unit must be grounded.
- To reduce the risk of fire, use only metal ductwork.
- Do not use this unit with any solid-state speed control device.
- Never leave surface units unattended at high settings. Boilovers cause smoking and greasy spillovers that may ignite.
- Clean ventilating fans frequently. Grease should not be allowed to accumulate on fan or filter.
- Use proper pan size. Always use cookware appropriate for the size of the surface element.

### 3. PRODUCT OVERVIEW

---

The SNDOAS GF3990WH is a 36-inch under cabinet range hood designed to efficiently remove smoke, steam, and cooking odors from your kitchen. It features a sleek white spray-painted stainless steel finish, rocker button controls, and versatile installation options.

#### Key Features:

- **Dimensions:** 35.4" wide x 4.7" high x 17.5" deep.
- **Airflow:** Max. 230 CFM.
- **Ventilation:** Convertible for ducted (top/rear) or ductless (recirculating) operation.
- **Filtration:** 3-layer aluminum mesh filter with included carbon sponge filter (Part # CF-3976) for ductless use.
- **Controls:** Rocker buttons for 2-speed fan and LED lighting.
- **Lighting:** Integrated LED light for enhanced cooktop visibility.
- **Material:** White spray-painted stainless steel.

#### Included Components:

- Range Hood Body
- Carbon Filter (Part # CF-3976)
- User Manual (this document)
- Installation Hardware



Figure 3.1: The SNDOAS GF3990WH 36-inch Under Cabinet Range Hood.

## Easy to Clean

Made by stainless steel white painted, durable, clean easily by wiping it with a cloth.



Figure 3.2: Detailed dimensions of the range hood, showing its slim profile and vent options.

## 4. INSTALLATION

---

Proper installation is crucial for the performance and safety of your range hood. It can be installed as either ducted (vented to the outside) or ductless (recirculating).

### 4.1 Pre-Installation Checklist:

- Ensure you have all necessary tools and additional parts (e.g., aluminum exhaust pipe for ducted, or power cord kit Part # PCK-GF3976 for plug-in).
- Verify the mounting surface is strong enough to support the hood's weight.
- Confirm electrical supply meets 110-120V/60Hz requirements.

### 4.2 Mounting Options:

The hood can be mounted under a cabinet or against a wall. Use the provided installation hardware and follow the template for precise drilling.

## 4.3 Venting Options:

This range hood offers flexible ventilation to suit your kitchen setup.

### 4.3.1 Ducted Exhaust Mode:

For ducted installation, the hood vents air to the outside. It features two venting outlets:

- **7-inch Round Top Vent:** For vertical ducting.
- **9.9"x3.1" Rectangular Rear Vent:** For horizontal ducting.

*Note: An aluminum exhaust pipe is not included and must be purchased separately.*



Figure 4.1: Ducted exhaust mode with top venting.



Figure 4.2: Ducted exhaust mode with rear venting.

### 4.3.2 Ductless Recirculation Mode:

For ductless installation, the hood filters the air and recirculates it back into the kitchen. This mode uses the included carbon sponge filter (Part # CF-3976) to remove odors and grease. An indoor exhaust baffle is not required for ductless use.



Figure 4.3: Ductless recirculation mode with front venting.

#### 4.4 Electrical Connection:

The range hood defaults to hard-wired installation. If you prefer a plug-in connection, you will need to purchase the power cord kit (Part # PCK-GF3976) separately.

## Dimensions of range hood

thin body, not occupying any extra space.

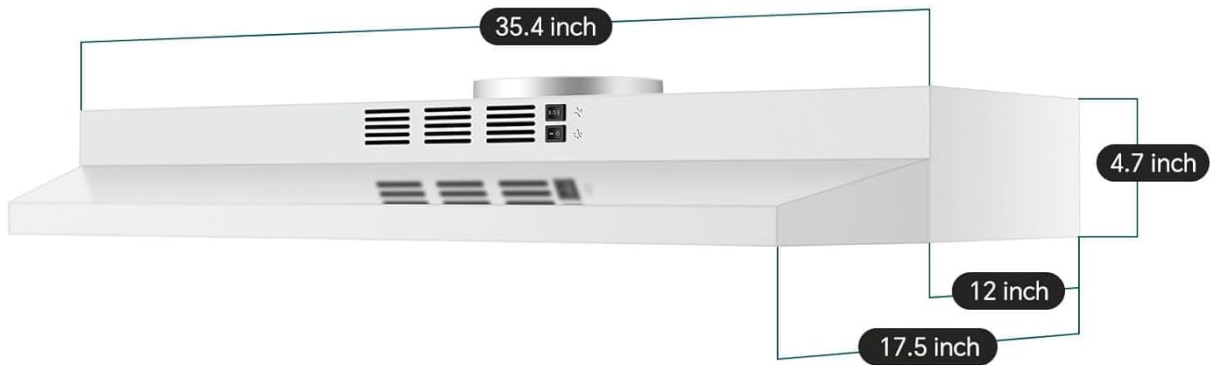

2 vents, venting from top or rear as your needs.



## 5. OPERATION

The SNDOAS GF3990WH range hood is operated using simple rocker button controls located on the front panel.

### 5.1 Fan Control:

The fan features two speed settings to accommodate different cooking needs:

- **Low Speed:** Ideal for light cooking, simmering, or maintaining air quality.
- **High Speed:** Provides maximum 230 CFM airflow for heavy cooking, frying, or when strong ventilation is required.

Press the fan rocker button to toggle between off, low speed, and high speed.



Figure 5.1: Rocker buttons for selecting low or high fan speed.

### 5.2 Lighting Control:

The integrated LED light provides illumination for your cooking area. Press the light rocker button to turn the light on or off.



## Hard-wired Installation

Default is hard-wired, convert it to plug in by using power cord kit [#PCK-GF3976](#)(NOT included).

*Figure 5.2: The LED light illuminates the cooktop, controlled by a dedicated rocker button.*

## 6. MAINTENANCE

---

Regular maintenance ensures the longevity and optimal performance of your range hood.

### 6.1 Surface Cleaning:

The white spray-painted stainless steel surface is easy to clean. Wipe it regularly with a soft cloth and mild detergent. Avoid abrasive cleaners or scouring pads that could damage the finish.

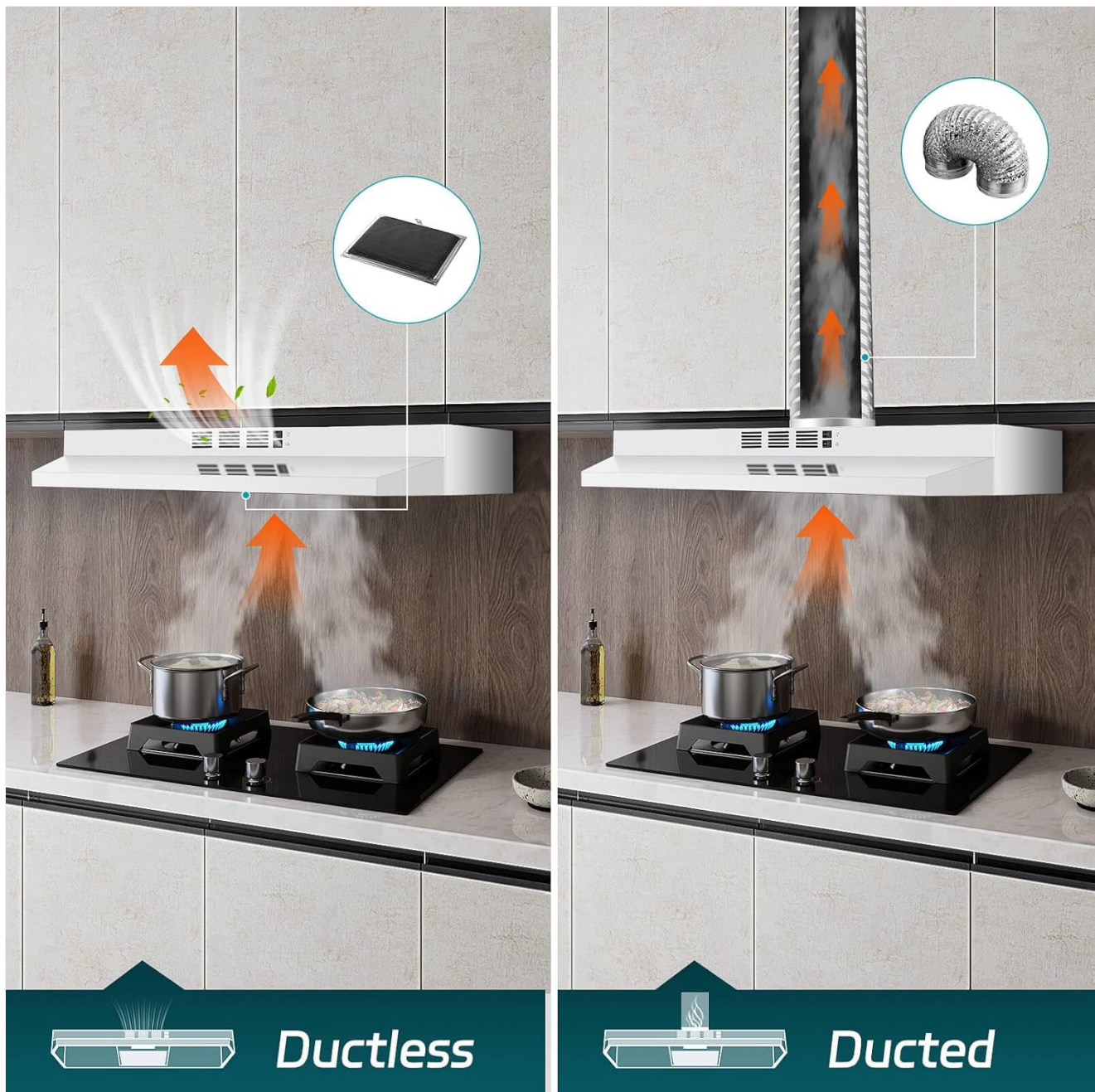

Figure 6.1: The range hood's surface is designed for easy cleaning.

## 6.2 Aluminum Mesh Filter Cleaning:

The 3-layer aluminum mesh filter should be cleaned regularly to maintain effective grease capture. Remove the filter by gently pulling down on the release tab. Wash the filter in warm, soapy water or place it in a dishwasher. Ensure it is completely dry before re-installing.

## 6.3 Carbon Sponge Filter Replacement (Ductless Mode):

If using the range hood in ductless (recirculating) mode, the carbon sponge filter (Part # CF-3976) is essential for odor removal. It is recommended to replace this filter every 3-6 months, depending on cooking frequency and habits, to ensure optimal effectiveness. Refer to the filter replacement instructions included with the new filter.

## 2-watts energy saving LED light

Located in front, giving cooking space extra lighting (NOT as a night light).



Figure 6.2: Diagram showing the 3-layer aluminum mesh filter and carbon sponge filter.

## 7. TROUBLESHOOTING

---

Before contacting customer support, please refer to the following troubleshooting guide for common issues:

Problem	Possible Cause	Solution
Fan does not operate	No power supply; Fan switch off; Motor malfunction	Check circuit breaker/fuse; Ensure fan switch is on; Contact qualified technician for motor repair.
Light does not operate	No power supply; Light switch off; LED bulb failure	Check circuit breaker/fuse; Ensure light switch is on; Contact customer support for LED light replacement.
Insufficient suction	Clogged filters; Improper ducting (for ducted mode); Incorrect fan speed	Clean aluminum mesh filters; Replace carbon sponge filter (if ductless); Check ductwork for obstructions or leaks; Select higher fan speed.
Excessive noise	Loose parts; Obstruction in fan/ductwork; Improper installation	Check for and tighten any loose components; Remove any obstructions; Ensure proper installation and sealing of ductwork.

## 8. SPECIFICATIONS

Feature	Detail
Brand	SNDOAS
Model Number	GF3990WH
Product Dimensions (D x W x H)	17.5" x 35.9" x 4.7"
Color	White
Material Type	Stainless Steel
Finish Type	Painted
Mounting Type	Under Cabinet Mount
Air Flow Capacity	230 Cubic Feet Per Minute (CFM)
Noise Level	55 Decibels
Number of Speeds	2
Controls Type	Rocker Buttons
Light Source	LED
Wattage	52 watts
Voltage/Frequency	110-120V/60Hz
Filter Type	Mesh (Aluminum) with Carbon Sponge
Ventilation Type	Convertible (Ducted/Ductless)
Special Feature	2 vents (top & rear) for optional ducting
Certification	ETL

## 9. WARRANTY AND SUPPORT

---

For warranty information or technical support, please refer to the documentation provided with your purchase or contact SNDOAS customer service. Keep your proof of purchase for any warranty claims.

## **10. PRODUCT VIDEOS**

---

No official seller videos were found that met the embedding criteria for this product. Please refer to the images and text instructions for guidance.