



Manuals.plus /

› MOUNTUP /

› MOUNTUP Dual Monitor Arm MU8012-W-07 Instruction Manual

## MOUNTUP MU8012-W-07

# MOUNTUP Dual Monitor Arm MU8012-W-07 Instruction Manual

Model: MU8012-W-07 | Brand: MOUNTUP

## 1. INTRODUCTION

Thank you for choosing the MOUNTUP Dual Monitor Arm MU8012-W-07. This instruction manual provides essential information for the safe and correct installation, operation, and maintenance of your new monitor arm. Please read this manual thoroughly before installation and keep it for future reference.

### Safety Precautions

- Ensure all components are present and undamaged before assembly. Do not use if any parts are missing or faulty.
- Verify that your desk surface is strong enough to support the combined weight of the monitor arm and your monitors.
- Do not exceed the maximum weight capacity of 10kg (22 lbs) per arm.
- Always follow the installation steps carefully. Improper installation may result in product damage or personal injury.
- Keep children away from the product during assembly. Small parts may be a choking hazard.

# デュアルモニター環境



耐荷重  
2~10kg



対応サイズ  
32インチまで



VESA規格  
75x75mm/100x100mm

MOUNTUP Dual Monitor Arm in a typical dual monitor setup, enhancing workspace efficiency.

## 2. PACKAGE CONTENTS

Please check that all the following components are included in your package:

- Monitor Arm Assembly (x1)
- VESA Plate (x2)
- Desk Clamp Base (x1)

- Grommet Base (x1)
- Mounting Hardware Kit (screws, washers, spacers)
- Hex Wrenches (various sizes)
- Instruction Manual (x1)

### 3. SPECIFICATIONS

Feature	Specification
Model	MU8012-W-07
Material	Alloy Steel
Color	White
Screen Size Compatibility	13 - 32 inches
Weight Capacity (per arm)	2 - 10 kg (4.4 - 22 lbs)
VESA Compatibility	75x75mm, 100x100mm
Mounting Options	Clamp, Grommet
Tilt Range	+85° to -45°
Swivel Range	180° (monitor plate), 270° (middle joint), 360° (base)
Rotation (Pivot)	360°
Max Height Adjustment	44 cm (17.3 inches)
Max Arm Extension	50 cm (19.7 inches)
Product Weight	3.1 kg (6.8 lbs)



Ensure your monitors meet the size, weight, and VESA compatibility requirements.

### 4. SETUP AND INSTALLATION

## Step 1: Choose Your Mounting Method

The MOUNTUP Dual Monitor Arm supports two installation methods: Clamp Mount and Grommet Mount. Choose the method that best suits your desk.

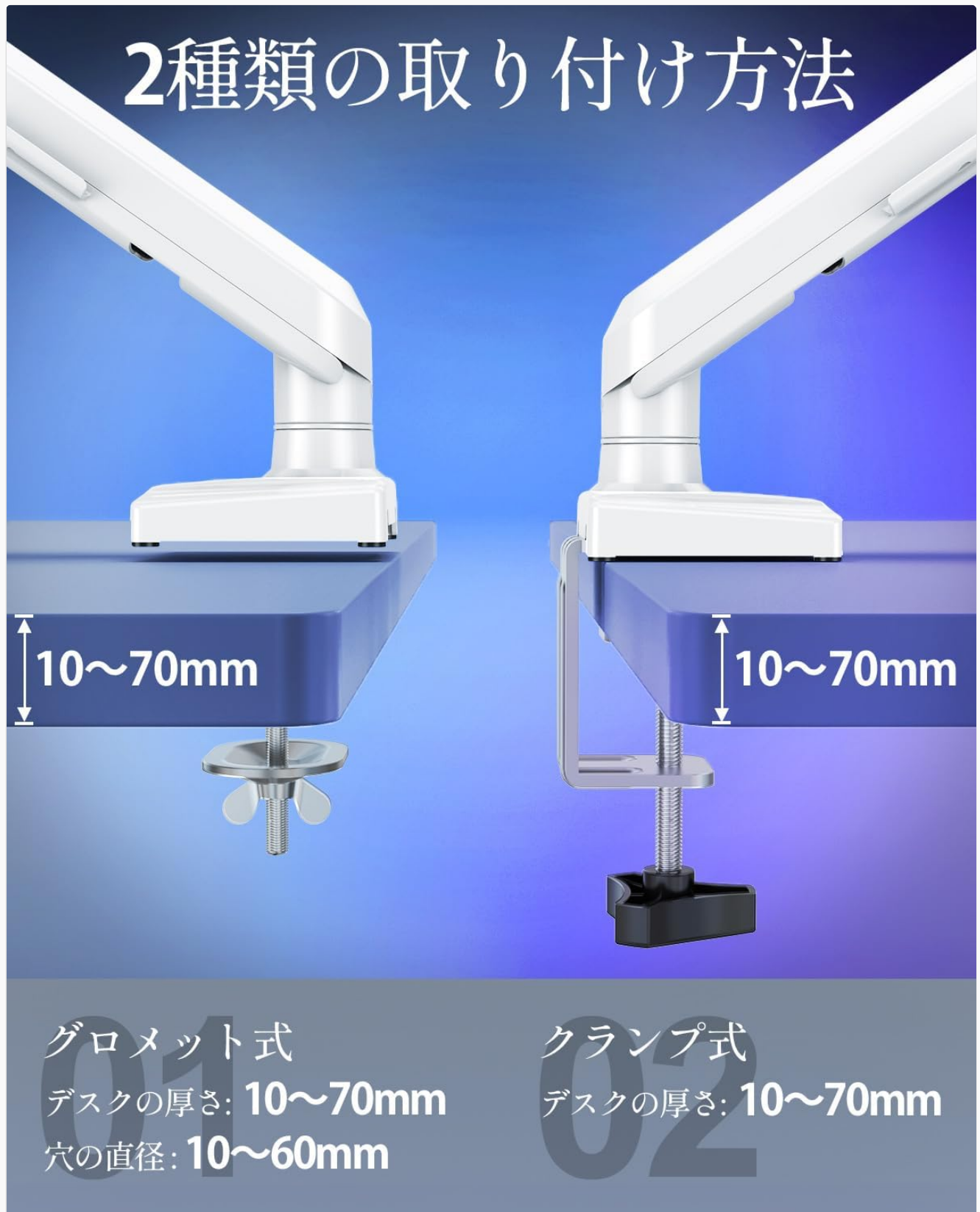

Two common installation methods: Clamp (right) and Grommet (left).

### Clamp Mount Installation

1. Attach the clamp base to the main pole of the monitor arm.
2. Place the clamp onto the edge of your desk. Ensure the desk thickness is between 10-70mm (0.4-2.7 inches).

3. Tighten the clamp screw until the arm is securely fastened to the desk. Ensure it is stable and does not wobble.



Clamp installation details for various desk configurations.

## Grommet Mount Installation

1. If your desk has a grommet hole, ensure its diameter is between 10-60mm (0.4-2.4 inches) and the desk thickness is between 10-70mm (0.4-2.7 inches).
2. Attach the grommet base to the main pole.
3. Insert the grommet bolt through the desk hole and secure it from underneath with the provided plate and nut.
4. Tighten the nut until the arm is firmly attached to the desk.

## Step 2: Attach VESA Plates to Monitors

1. Carefully lay your monitor face down on a soft, clean surface.
2. Align the VESA plate with the mounting holes on the back of your monitor.
3. Use the appropriate screws (M4 or M5) and washers from the hardware kit to secure the VESA plate to the monitor. Do not overtighten.

## Step 3: Mount Monitors to Arms

1. Slide the monitor (with the attached VESA plate) onto the VESA head of the monitor arm.
2. Ensure the monitor clicks into place or is securely fastened by the quick-release mechanism.
3. Repeat for the second monitor.

# 手軽にロック & 取り外す



Quick-release VESA plate for easy monitor attachment and detachment.

## Step 4: Cable Management

Route your monitor cables through the integrated cable management clips on the underside of the arms. This helps maintain a tidy workspace.

# ケーブル管理



六角レンチ収納

Integrated cable management keeps your workspace organized. Hex wrenches can be stored in the arm base.

## 5. OPERATING AND ADJUSTMENTS

The MOUNTUP Dual Monitor Arm offers flexible adjustments to optimize your viewing experience.

# 角度を自由に変えられる

左右向き  
180°

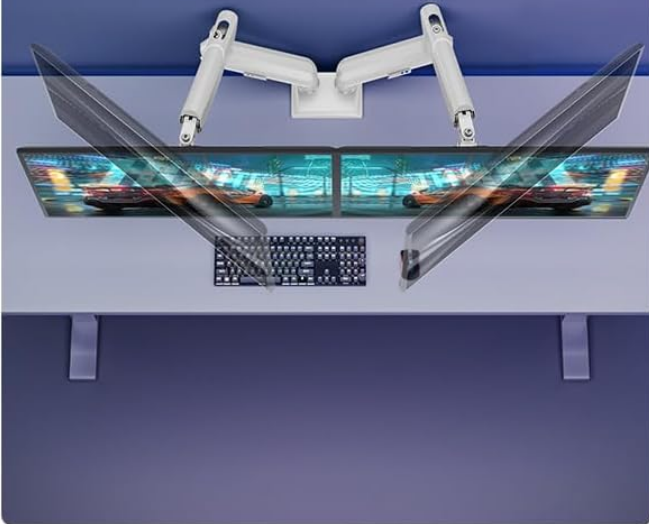

高さ調節  
130~440mm



上下向き  
+85° to -45°



回転  
360°



Overview of the monitor arm's extensive adjustment capabilities.

## Adjusting Arm Tension (Gas Spring)

The gas spring mechanism allows for smooth height adjustments. If your monitor sags or is difficult to move, you may need to adjust the tension.

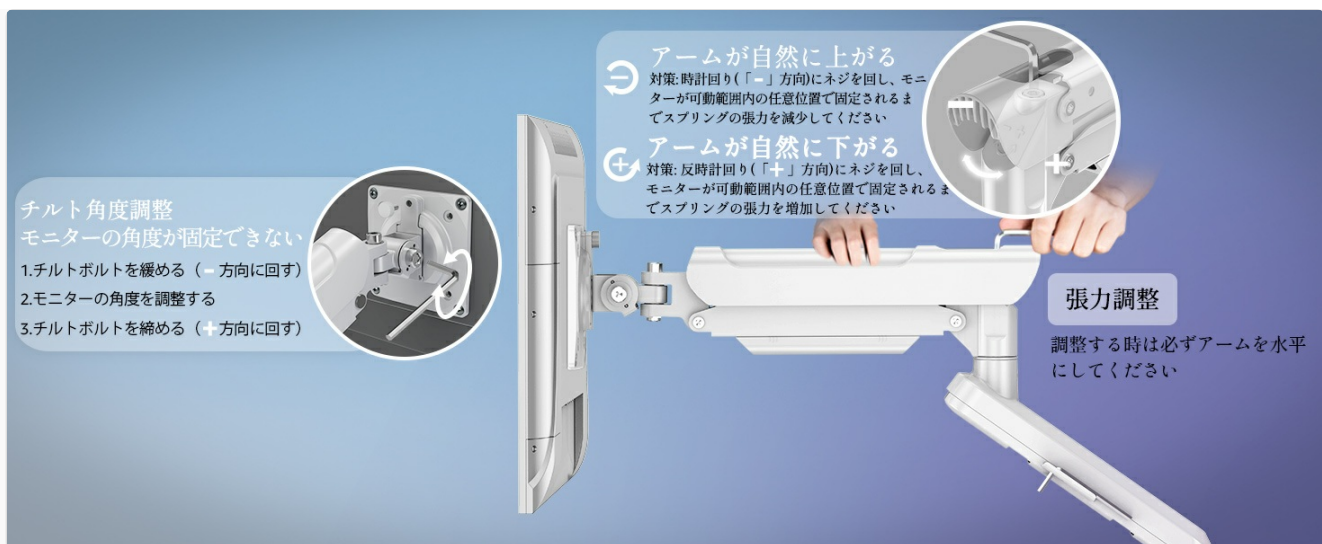

Adjusting gas spring tension for optimal monitor positioning.

- **To increase tension (if monitor sags):** Use the provided hex wrench to turn the adjustment screw clockwise.
- **To decrease tension (if arm is too stiff):** Turn the adjustment screw counter-clockwise.
- Always adjust tension with the arm held horizontally. Test the movement after each small adjustment until the monitor holds its position freely.

## Monitor Adjustments

- **Height Adjustment:** Gently push or pull the monitor up or down to your desired height. The gas spring will assist in holding the position. Max height is 44cm (17.3 inches).
- **Tilt Adjustment:** Tilt the monitor screen up to +85° or down to -45° to reduce glare and optimize viewing angles. Loosen the tilt bolt, adjust, then re-tighten.
- **Swivel Adjustment:** The arm allows for 180° swivel at the monitor plate, 270° at the middle joint, and 360° at the base, providing wide range of motion.
- **Rotation (Pivot):** Rotate your monitor 360° to switch between landscape and portrait orientations.

# 多角度調整

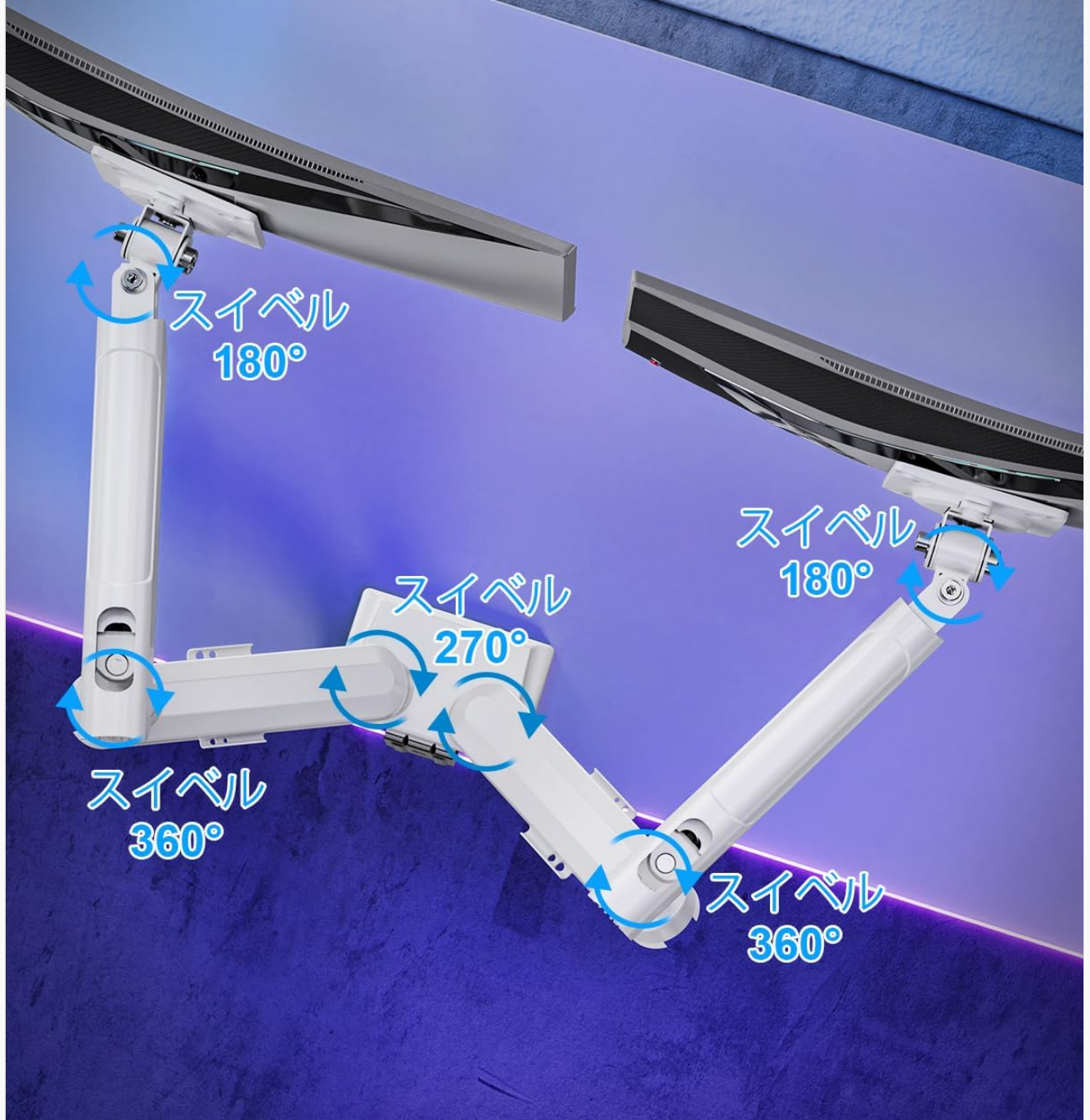

Detailed swivel capabilities of the monitor arm joints.

# モニターを自由昇降



Maximum height and extension capabilities of the monitor arm.

## 6. MAINTENANCE

- **Cleaning:** Wipe the monitor arm with a soft, damp cloth. Avoid abrasive cleaners or solvents that could damage the finish.
- **Periodic Checks:** Periodically check all screws and connections to ensure they remain tight and secure. Retighten if necessary.
- **Gas Spring Longevity:** The high-quality gas spring is tested for over 20,000 cycles. Proper tension

adjustment will help maintain its performance over time.

# 高品質ガススプリングアーム



昇降テスト

2万回

以上をクリア

The durable gas spring is designed for long-lasting performance.

## 7. TROUBLESHOOTING

- **Monitor Sags or Won't Stay Up:** The gas spring tension is too low. Refer to the "Adjusting Arm Tension" section and turn the adjustment screw clockwise to increase tension.
- **Arm is Too Stiff or Difficult to Move:** The gas spring tension is too high. Refer to the "Adjusting Arm Tension" section and turn the adjustment screw counter-clockwise to decrease tension.

- **Monitor Wobbles:** Ensure all mounting screws (VESA plate to monitor, arm to desk) are securely tightened. Check that the desk clamp or grommet mount is firm.
- **Monitor Tilt Angle Won't Hold:** The tilt bolt may be loose. Tighten the tilt bolt on the VESA head.

## 8. WARRANTY AND SUPPORT

MOUNTUP provides a **2-year quality guarantee** from the date of purchase for this product. This warranty covers manufacturing defects and issues arising from normal use.

If you encounter any problems with your MOUNTUP Dual Monitor Arm, or if you have questions regarding installation or operation, please contact our customer support. You can typically find seller contact information through your purchase history on the platform where you bought the product (e.g., Amazon order details).

Please have your model number (MU8012-W-07) and purchase date ready when contacting support to ensure a swift resolution.