

Bloody AT98-BloodyRed

Bloody AT98 Alpha Optical Switch Performance Keyboard User Manual

Model: AT98-BloodyRed

[Setup](#)

[Operation](#)

[Maintenance](#)

[Troubleshooting](#)

[Specifications](#)

[Warranty & Support](#)

INTRODUCTION

This manual provides comprehensive instructions for the setup, operation, maintenance, and troubleshooting of your Bloody AT98 Alpha Optical Switch Performance Keyboard. Please read this manual thoroughly before using the product to ensure proper function and longevity.

SETUP

Package Contents

- Bloody AT98 Alpha Optical Switch Performance Keyboard
- USB-C Cable
- Keycap Puller
- Dust Cover
- Additional Keycaps (for customization)

Connecting the Keyboard

1. Locate the USB-C port on the back of the keyboard. The port is recessed for cable management.
2. Connect the provided USB-C cable to the keyboard's USB-C port.
3. Route the cable through the integrated cable management channels on the underside of the keyboard (left, right, or center) as desired.
4. Connect the other end of the USB-C cable (USB-A) to an available USB port on your computer.
5. The keyboard will be automatically recognized by your operating system.

ALPHA OPTICAL SWITCH α

Precision-tuned actuation points and forces redefine gaming with unmatched speed and tactile feedback.



Switch Type: Linear

Durability: 100 Million Keystrokes

Initial Force: 48 ± 3 cN Min

Total Travel Distance: $3.8 \text{ mm} \pm 0.2 \text{ mm}$

Actuation Point Customization Range: 0.8 mm ~ 3.0 mm



Linear High
Rebound



Actuation
Force

 Profile 1 Customization	 Profile 2 Customization	 Profile 3 Customization	 Alpha Gamer Precision Customization
Actuation Point: 23 Options 0.8mm ~ 3.0mm*			Fully Customizable Variable Speed for Every Key

4 Customizable Variable Speed Profiles

Customize actuation points range from 0.8mm to 3.0mm, delivering precision tailored to your gaming style.

Image: The Bloody AT98 keyboard with its USB-C cable connected, showcasing the cable management options on the underside.

Adjusting Keyboard Height

The keyboard features dual-height adjustable feet on the underside. Flip out the feet to achieve your preferred typing angle and ergonomic comfort.

3-Direction Cable Management

Cable management system for cleanly routing the cable from the keyboard's central connector, allowing you to direct it to the left, right, or center.

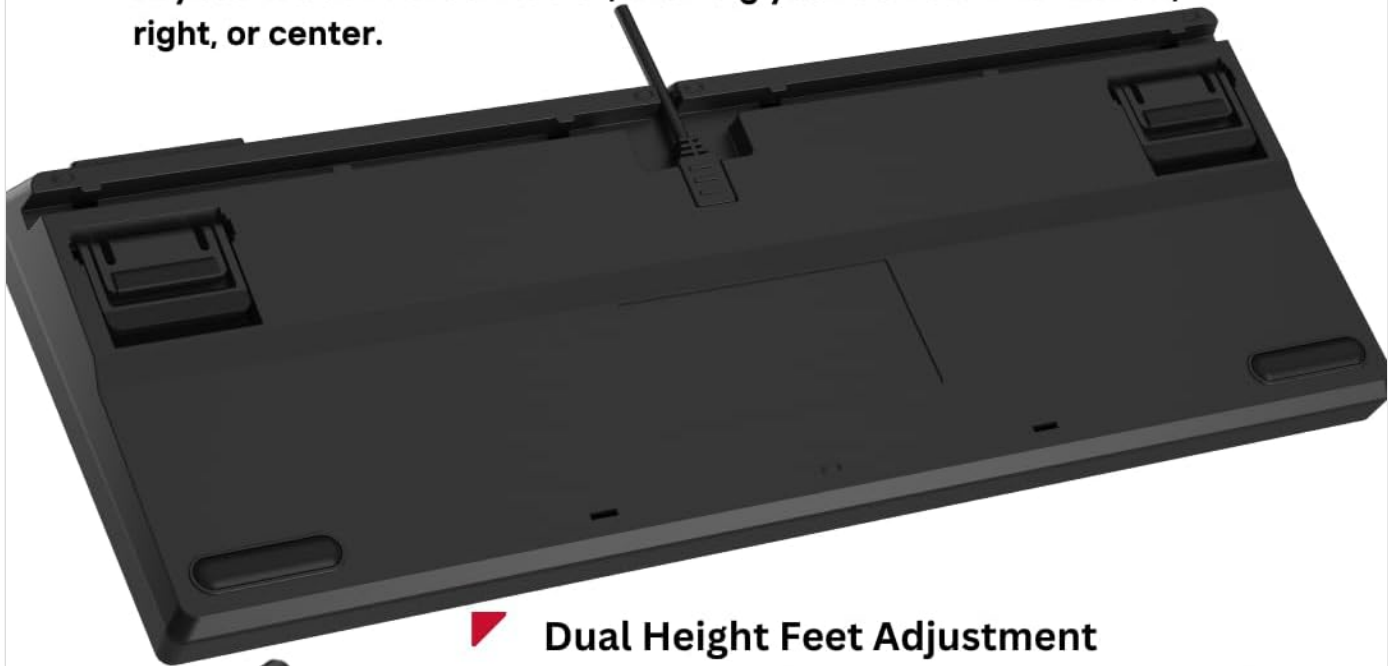

Dual Height Feet Adjustment

Adjustable dual-height feet for customizable keyboard elevation.



Image: Underside view of the Bloody AT98 keyboard, illustrating the dual-height adjustable feet for ergonomic positioning.

OPERATION

Alpha Optical Switches

The Bloody AT98 keyboard is equipped with Alpha Optical Switches, which offer a fast response and high durability (up to 100 million keystrokes). These linear switches have a total travel distance of $3.8 \text{ mm} \pm 0.2 \text{ mm}$ and an initial force of $48 \pm 3 \text{ cN}$.



25%
**SPACE
SAVING**

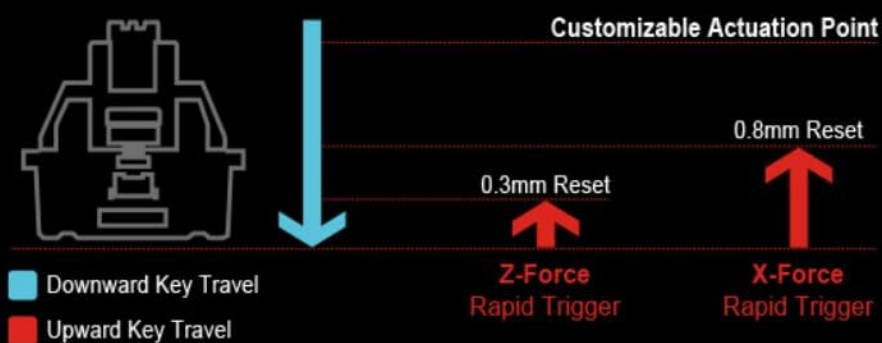

eXact Reset System

Hyper Z-Force Mode: Ultra-fast reset at 0.3mm for peak precision. Extreme X-Force Mode: Enhanced reset at 0.8mm for superior control. Classic Mode: Cancels out the eXact Reset and reverts to the default key reset point for a traditional response.

Image: Detailed diagram illustrating the specifications of the Alpha Optical Switch, including switch type, durability, initial force, total travel distance, and actuation point customization range.

Customizable Actuation Points

The keyboard allows for customization of actuation points, ranging from 0.8mm to 3.0mm. This feature enables users to fine-tune key responsiveness to their preference. There are 4 customizable variable speed profiles available.

To adjust actuation points, use the dedicated function keys (often marked 'LT' or similar, refer to keyboard layout) in combination with other keys as specified in the software or quick guide.



Alpha Optical Switch



Adjustable Actuation Point



eXact Reset System



7 RGB Backlit Effects



87-Key Style



Gaming PBT Keycaps

Most keycaps are equipped with PBT materials to extend their durability. Bloody's PBT Keycaps are designed with lightweight in mind, providing a quick bounce back in the gaming experience.

Image: Visual representation of the customizable actuation points and the eXact Reset System, detailing downward key travel, Z-Force Rapid Trigger, and X-Force Rapid Trigger.

eXact Reset System

The eXact Reset System provides enhanced key reset functionality:

- **Hyper Z-Force Mode:** Ultra-fast reset at 0.3mm for peak precision.
- **Extreme X-Force Mode:** Enhanced reset at 0.8mm for superior control.
- **Classic Mode:** Cancels out the eXact Reset and reverts to the default key reset point for a traditional response.

RGB Backlighting

The keyboard features 7 preset RGB backlit effects. These can be adjusted using function key combinations. Refer to the keyboard's quick start guide or software for specific key combinations to change lighting patterns and brightness.



Image: The Bloody AT98 keyboard illuminated with its RGB backlighting, showcasing the key layout and design.

Multimedia Functions

Secondary multimedia functions are integrated into the F-key row. These functions are typically activated by pressing the **FN** key in combination with the corresponding F-key (e.g., FN + F1 for volume down, FN + F2 for volume up, FN + F3 for mute). Specific key assignments may vary; consult the keyboard's quick start guide for details.

MAINTENANCE

Cleaning the Keyboard

- Disconnect the keyboard from your computer before cleaning.
- Use a soft, lint-free cloth slightly dampened with water or a mild cleaning solution to wipe the keycaps and surface.
- For dust and debris between keys, use compressed air.
- Avoid spraying liquids directly onto the keyboard.
- Do not use harsh chemicals or abrasive materials.

Keycap Replacement

The Bloody AT98 comes with additional keycaps and a keycap puller for customization. To replace keycaps:

1. Gently attach the keycap puller to the keycap you wish to remove.
2. Pull upwards with steady, even pressure until the keycap detaches from the switch.
3. Align the new keycap with the switch stem and press down firmly until it clicks into place.

The PBT keycaps are designed for durability and a quick bounce-back feel.

STEAL QUIET TYPING

Immerse yourself in silent keystrokes,
maximizing your gaming experience

LT Alpha Optical Switch
Precision-tuned Actuation
Points

Silicon Filling
reduce typing resonance

Silicon Pads
Absorb Noise From Interior Collision

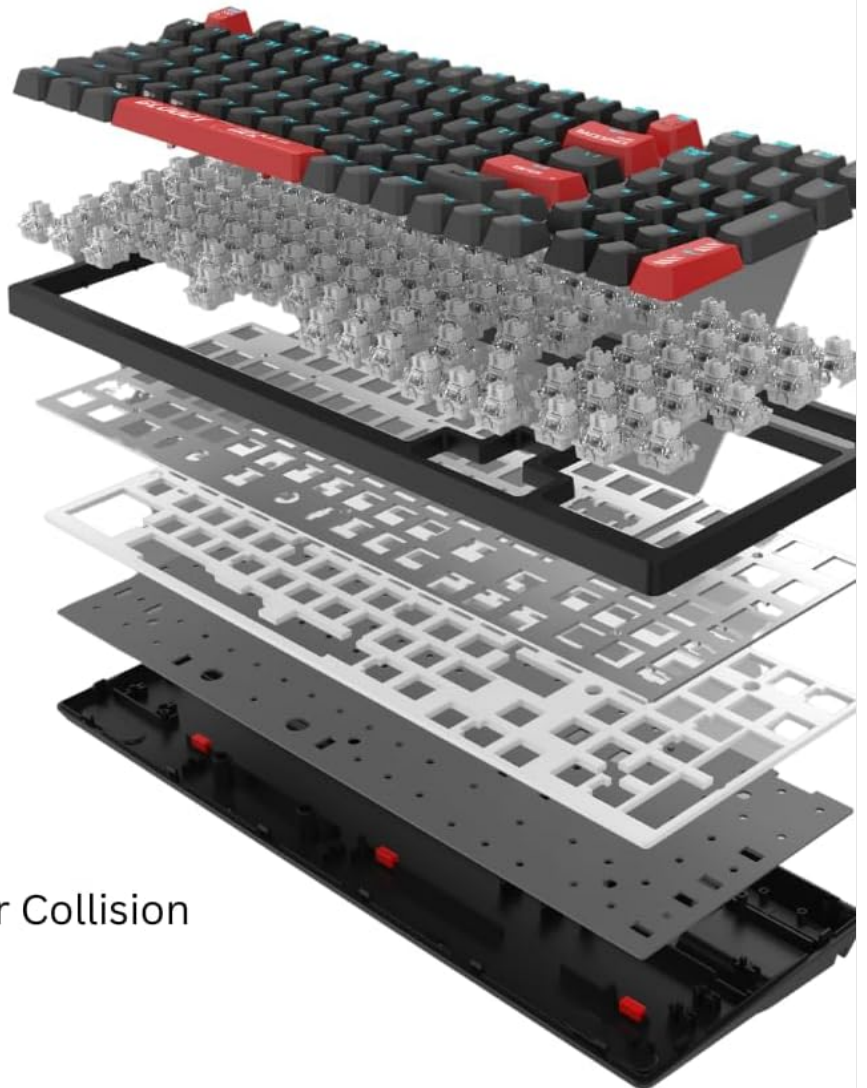

Image: Close-up view of the Bloody AT98 keyboard highlighting the PBT keycaps, emphasizing their material and design.

Dust Cover Usage

Utilize the provided dust cover when the keyboard is not in use to protect it from dust and debris, which can affect performance and longevity.

TROUBLESHOOTING

Keyboard Not Responding

- Ensure the USB-C cable is securely connected to both the keyboard and the computer.
- Try connecting the keyboard to a different USB port on your computer.
- Test the keyboard on another computer to rule out a computer-specific issue.
- Restart your computer.

Backlighting Not Working or Incorrect

- Check if the backlighting is turned off. Use the designated FN key combinations to cycle through lighting effects and

adjust brightness.

- Ensure any keyboard software is up to date and correctly configured.

Keys Not Registering or Double-Typing

- Clean the affected key(s) using compressed air to remove any debris.
- Verify that the keycap is properly seated on the switch.
- If using custom actuation points, try resetting them to default settings.

Software Issues

- Download the latest software and drivers from the official Bloody website.
- Ensure your operating system is up to date.

SPECIFICATIONS

Model Name	AT98-BloodyRed
Brand	Bloody
Keyboard Description	Alpha Optical Switch
Switch Type	Linear Optical Switch
Key Count	98 Keys
Actuation Point Customization	0.8mm - 3.0mm (23 options)
Initial Force	48 ± 3 cN
Total Travel Distance	3.8 mm ± 0.2 mm
Durability	Up to 100 Million Keystrokes
Connectivity Technology	USB-C
Compatible Devices	PC
Product Dimensions	5.43 x 15.16 x 1.61 inches (13.79 x 38.51 x 4.09 cm)
Item Weight	1.65 pounds (0.75 kg)
Special Feature	eXact Reset System, RGB Backlit, PBT Keycaps, Dual-Height Feet

WARRANTY AND SUPPORT

Warranty Information

For detailed warranty information, please refer to the warranty card included with your product or visit the official Bloody website. Keep your proof of purchase for warranty claims.

Customer Support

If you encounter any issues not covered in this manual or require further assistance, please contact Bloody customer support through their official website or the contact information provided in your product packaging.

Official Bloody Website: www.bloody.com



Related Documents - AT98-BloodyRed

	<p>BLOODY V-Series Gaming Mice: V7M, V7MA, V8M, V8MA Datasheet</p> <p>Detailed specifications and features for the BLOODY V-Series gaming mice, including models V7M, V7MA, V8M, and V8MA. Discover optical switches, customizable RGB lighting, high DPI, and advanced gaming performance.</p>
	<p>Bloody GR230 Wireless Headset Quick Start Guide</p> <p>Comprehensive guide to setting up and using the Bloody GR230 wireless headset with Bluetooth 5.3 and 2.4G connectivity, including features, controls, compatibility, and technical specifications.</p>

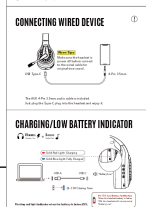
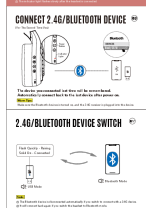
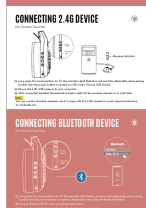
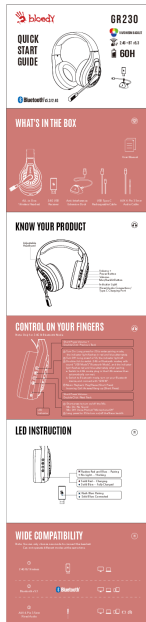

[Bloody S98 Hot-Swappable Mechanical Keyboard Quick Guide](#)

A quick guide to the Bloody S98 hot-swappable mechanical keyboard, covering package contents, installation, FN key combinations, and switch replacement steps.



[Bloody M70 True Wireless Gaming Earphones Quick Start Guide](#)

A quick start guide for the Bloody M70 True Wireless Gaming Earphones, covering what's in the box, how to wear, first-time use, power on/connect, reconnect/disconnect, charging, controls, LED indicators, technical specifications, cleaning and maintenance, safety rules, and warning statements.



[Bloody R72 Pro Duo Gaming Mouse Quick Start Guide - Enhanced Performance and Connectivity](#)
Comprehensive Quick Start Guide for the Bloody R72 Pro Duo wireless gaming mouse. Learn about product features, setup, connectivity options, pairing, firmware updates, and troubleshooting for optimal gaming performance.

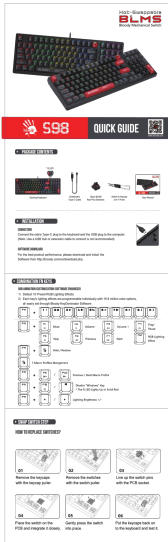

[Bloody S98 Gaming Keyboard Quick Guide](#)

A concise guide to installing and using the Bloody S98 hot-swappable mechanical gaming keyboard, including key combinations and switch replacement instructions.