

Monster AC500

Monster Open Ear AC500 Clip-On Earbuds User Manual

Model: AC500 | Brand: Monster

1. INTRODUCTION

Welcome to the user manual for your Monster Open Ear AC500 Clip-On Earbuds. This guide provides detailed instructions on how to set up, operate, maintain, and troubleshoot your new earbuds. Please read this manual thoroughly to ensure optimal performance and longevity of your device.



Image: Monster Open Ear AC500 Clip-On Earbuds and Charging Case.

2. WHAT'S IN THE BOX

Upon opening your Monster Open Ear AC500 package, you should find the following items:

- Monster Open Ear AC500 Clip-On Earbuds (Left and Right)
- Charging Case
- USB Charging Cable
- User Manual (this document)

3. PRODUCT OVERVIEW

The Monster Open Ear AC500 earbuds are designed for comfort and situational awareness, featuring an open-ear clip-on design. They deliver high-quality audio while allowing you to remain aware of your surroundings.

Key Features:

- **Open Ear Design:** Allows you to hear ambient sounds while enjoying audio.
- **Secure Clip-On Fit:** Designed to stay securely on your ear during various activities.
- **Pure Monster Sound:** Equipped with 13mm dynamic drivers for rich bass and clear highs.
- **Crystal-Clear Call:** Dual-microphone design enhances voice and cancels background noise.
- **Long Battery Life:** Up to 6 hours on a single charge, and 30 hours with the charging case.
- **IPX5 Waterproof:** Resistant to sweat and light rain, suitable for workouts.
- **Bluetooth 5.3:** Provides stable connection and synchronized audio-video playback.

Open-Ear Clip-On Design

Fit the ear securely and not easy to fall off, ensuring stable and comfortable wear.

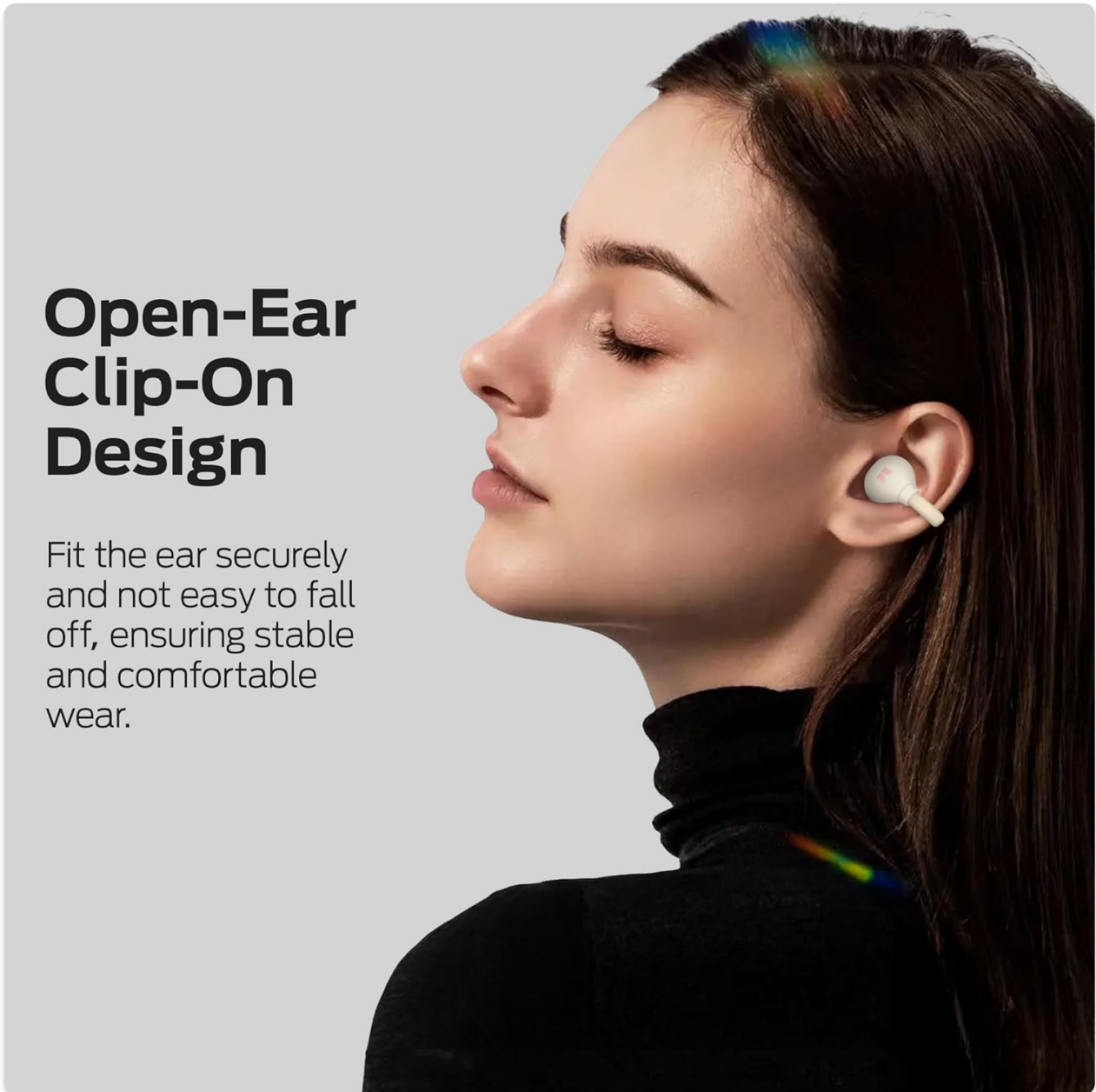

Image: The open-ear clip-on design ensures a secure and comfortable fit, allowing awareness of surroundings.

Pure Monster Sound

Featured 13mm dynamic drivers to provide rich bass and crystal-clear highs.

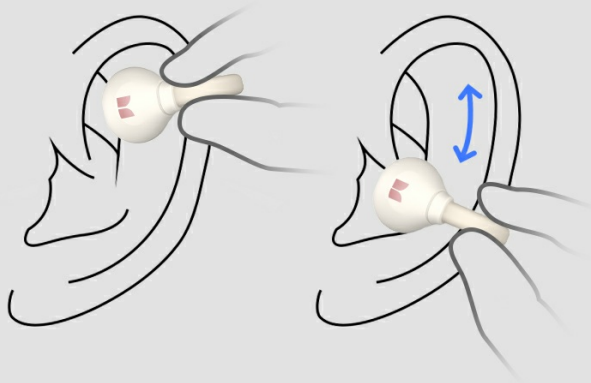

Image: Internal view highlighting the 13mm dynamic speaker technology for enhanced sound.

4. WEARING INSTRUCTIONS

To ensure the best sound experience and comfort, follow these steps to properly wear your Monster Open Ear AC500 earbuds:

1. Gently clip the earbuds onto your ear, positioning the speaker part directly over your ear canal.
2. Adjust the earbud's position slightly up or down until it feels secure and comfortable. The flexible design allows for easy adaptation to various ear shapes.
3. Ensure the earbud is not pressing uncomfortably against your ear. The design is intended to be pressure-free for extended wear.



How to Wear

1. Clip the earbuds on your ear
2. Adjust it up and down until you feel satisfied and comfortable
3. Start to enjoy your favorite melody and rhythm

Image: Visual guide on how to correctly wear the earbuds.

Upgraded Clip-On Design

Compact; Comfortable; Stable



Other Earbuds

Ear Discomfort

Ear Pain

Fall off Easily



Image: Comparison illustrating the comfortable, pain-free fit of the AC500 earbuds.

5. SETUP

5.1 Charging the Earbuds and Case

Before first use, it is recommended to fully charge both the earbuds and the charging case.

- Place the earbuds into the charging case. Ensure they are correctly seated in their respective slots.
- Connect the charging case to a power source using the provided USB charging cable.
- The indicator lights on the case will show the charging status. Once fully charged, the lights will indicate completion or turn off.

All Day Battery Life



6 Hours
Single Charge

30 Hours
with Charging Case

Up to 30 hours playtime, easily use it all day.

Image: Battery life indication for earbuds and charging case.

5.2 Bluetooth Pairing

The Monster Open Ear AC500 earbuds utilize Bluetooth 5.3 technology for a stable and efficient connection.

1. **First-time Pairing:** Open the charging case. The earbuds will automatically enter pairing mode.
2. On your device (smartphone, tablet, laptop), go to Bluetooth settings and ensure Bluetooth is enabled.
3. Search for available devices. Select "Monster Open Ear AC500" from the list.
4. Once connected, you will hear a confirmation tone, and the earbuds will be ready for use.
5. **Automatic Reconnection:** After the initial pairing, the earbuds will automatically connect to your last paired device when you open the charging case, provided Bluetooth is enabled on your device.

Bluetooth 5.3 Technology

Link the headphones and your devices with a smooth, stable and lag-free connection.



Image: Earbuds connecting to a device via Bluetooth 5.3.

6. OPERATING INSTRUCTIONS

Your Monster Open Ear AC500 earbuds feature intuitive touch controls for easy management of music and calls.

6.1 Touch Controls

Action	Earbud (L/R)	Function
Double Tap (During Call)	L / R	Answer / End Call
Double Tap (Playing Music)	L / R	Play / Pause Music
One Tap	L	Volume Up
One Tap	R	Volume Down

Action	Earbud (L/R)	Function
Long Press	L	Previous Track
Long Press	R	Next Track

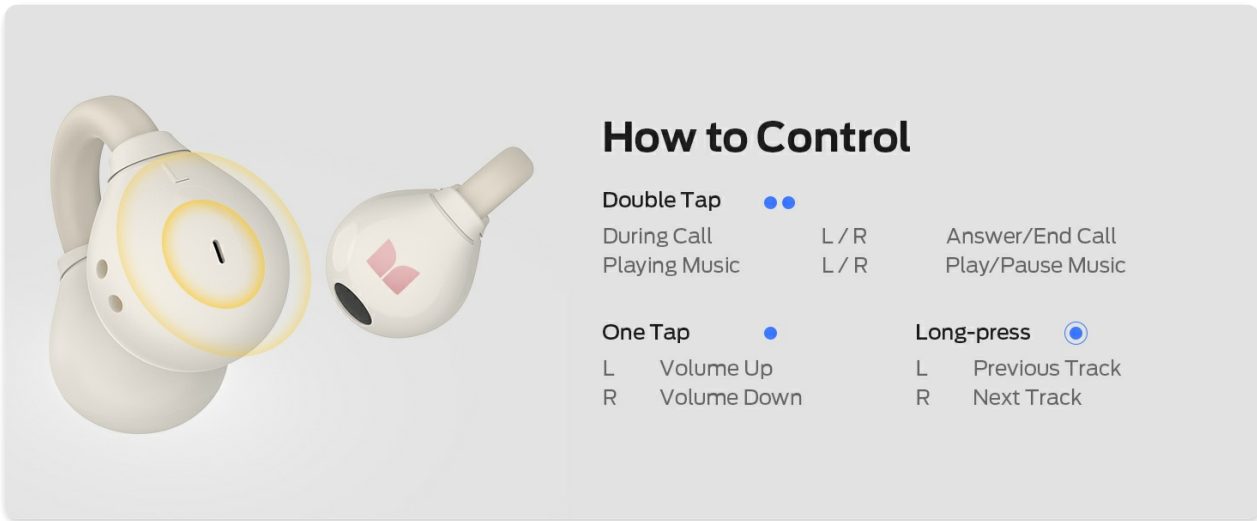

Image: Detailed touch control functions for the earbuds.

6.2 Making and Receiving Calls

With the dual-microphone design, your AC500 earbuds ensure clear communication.

- **Answering a Call:** When an incoming call rings, double tap either earbud to answer.
- **Ending a Call:** During a call, double tap either earbud to end the conversation.
- **Rejecting a Call:** To reject an incoming call, long press either earbud for approximately 2 seconds.



Crystal-Clear Call

A dual-microphone design enhancing voice and canceling background noise, maintaining crystal clear call, even in a busy environment.

Image: Demonstrating crystal-clear call quality with the earbuds.

7. MAINTENANCE AND CARE

Proper care will extend the life of your Monster Open Ear AC500 earbuds.

- **Cleaning:** Use a soft, dry, lint-free cloth to clean the earbuds and charging case. Do not use abrasive cleaners or solvents.
- **Water Resistance:** The earbuds are IPX5 waterproof, meaning they are resistant to sweat and splashes. Do not submerge them in water or expose them to strong jets of water. Dry them thoroughly if they get wet.
- **Storage:** When not in use, store the earbuds in their charging case to protect them from dust and damage. Store in a cool, dry place away from extreme temperatures.
- **Battery Care:** To preserve battery life, avoid fully discharging the earbuds and charging case frequently. Charge them regularly, even if not in constant use.

IPX5 Waterproof & Sweatproof



Image: IPX5 waterproof rating for sweat and splash resistance.

8. TROUBLESHOOTING

If you encounter issues with your Monster Open Ear AC500 earbuds, try the following solutions:

8.1 Connectivity Issues

- **Earbuds not connecting:** Ensure Bluetooth is enabled on your device and the earbuds are charged. Place earbuds back in the case, close it, then open it again to re-enter pairing mode.
- **Only one earbud working:** Place both earbuds back into the charging case. Close the lid for 5 seconds, then open it again. This often re-syncs the earbuds. If the issue persists, try unpairing from your device and re-pairing both earbuds.
- **Intermittent connection:** Ensure there are no obstructions between the earbuds and your device. Keep the earbuds within the Bluetooth range (typically 10 meters/33 feet). Avoid strong electromagnetic interference.

8.2 Sound Issues

- **No sound:** Check the volume level on both your device and the earbuds. Ensure the earbuds are properly connected to your device.
- **Low volume:** Increase the volume on your device and using the earbud touch controls. Ensure the earbuds are positioned correctly on your ears.
- **Poor call quality:** Ensure the microphones are not obstructed. Move to a quieter environment if there is excessive background noise.

8.3 Charging Issues

- **Earbuds not charging:** Ensure the earbuds are correctly seated in the charging case. Check if the charging case itself has power.
- **Charging case not charging:** Ensure the USB cable is securely connected to both the case and the power source. Try a different USB cable or power adapter.

9. SPECIFICATIONS

Detailed technical specifications for the Monster Open Ear AC500 Clip-On Earbuds:

Feature	Specification
Model Name	AC500
Connectivity Technology	Wireless (Bluetooth 5.3)
Wireless Communication Technology	Bluetooth
Ear Placement	Open Ear
Form Factor	Over Ear (Clip-On)
Noise Control	Active Noise Cancellation (for calls)
Frequency Range	20 Hz to 20,000 Hz
Impedance	200 Ohm
Waterproof Rating	IPX5
Battery Life (Single Charge)	Up to 6 Hours
Total Playtime (with Charging Case)	Up to 30 Hours
Battery Cell Composition	Lithium Ion
Compatible Devices	Smartphones, Tablets, Laptops, Desktops
Included Components	Charging Case
Item Model Number	MH22189
Color	White2

10. WARRANTY AND SUPPORT

Your Monster Open Ear AC500 Clip-On Earbuds come with a standard manufacturer's warranty. Please refer to the warranty card included in your product packaging for specific terms and conditions, including the warranty period and coverage details.

For technical support, troubleshooting assistance, or warranty claims, please contact Monster customer service through their official website or the contact information provided in your product documentation. When contacting support, please have your product model number (AC500 or MH22189) and proof of purchase ready.