

## AMTIFO A8

# AMTIFO A8 Magnetic Solar Wireless Backup Camera Instruction Manual

Model: A8 | Brand: AMTIFO

### 1. SAFETY INFORMATION

Please read all instructions carefully before installation and use. Keep this manual for future reference. Ensure proper installation to prevent accidents. Always check your surroundings manually before relying solely on the camera system.

### 2. PACKAGE CONTENTS

- 1 x 7 Inch IPS Touch Key Monitor with U Bracket
- 1 x RV Backup Camera (Magnetic Solar Wireless)
- 1 x Charge Plug
- 1 x USB to Type C Cable (for Camera)
- 1 x USB to Type C Cable (for Monitor)
- 1 x Cigarette Lighter Plug
- 3 x Antennas

### 3. PRODUCT OVERVIEW

The AMTIFO A8 system provides enhanced visibility for large vehicles. It features a magnetic, solar-powered wireless camera and a 7-inch portable monitor. Key features include 1080P HD resolution, 170° wide-angle view, advanced night vision, and built-in recording.



Figure 1: Complete AMTIFO A8 Backup Camera System showing the 7-inch monitor and the magnetic solar-powered camera.

## 4. SETUP

### 4.1 Charging the Camera

The camera is equipped with a solar panel for continuous charging and a built-in 15000mAh battery. For initial use or if the battery is low, charge the camera using the provided USB to Type C cable.

# About Solar Magnetic Camera

✓ Solar powered

✓ Built-in 15000mah battery



Solar power panel

**3W**

Built-in battery

**15000mah**

Configurable 5W solar panel  
(Please contact us)



Ultra-soft rubber base



Figure 2: The camera unit showing the solar panel and the Type-C charging port. The solar panel provides 3W power, and the built-in battery is 15000mAh.

## 4.2 Mounting the Camera

The camera features a strong magnetic base for easy, drill-free installation. It can be attached to any ferrous-metal surface on your vehicle. Ensure the surface is clean and flat for optimal adhesion. The camera also includes a 90° up/down adjustment for optimal viewing angle.



100% Wireless 👍

No splicing of wires 👍

Strong magnet that no drill 👍

15000Mah Battery life and solar assisted 👍

## **Two power supply:**



Car charger powered



USB cable powered



Figure 3: The camera unit highlighting its strong magnetic base for secure attachment to vehicle surfaces.



# 7-inch Super Large Display

7"

7 inch screen

HD

HD 1080P



Dual antenna



120.7cm / 47.51inch

187.5cm / 73inch

**Fit for use on long vehicles**



**Tips:** This product is compatible on **furrion pre-wired** and **voyager cars**



RVs



5th wheels



Trailers



Boat



Campers



Rig



Harvester



Hitch trailers



Horse Trailer

Figure 4: The camera with its solar panel and dual power supply options, including USB cable and car charger.

# About Solar Magnetic Camera

✓ Solar powered

✓ Built-in 15000mah battery



Solar power panel

**3W**

Built-in battery

**15000mah**

Configurable 5W solar panel  
(Please contact us)



Ultra-soft rubber base



Figure 5: The camera's solar power panel and built-in 15000mAh battery, with a 90° up/down adjustment for the camera lens.

## 4.3 Mounting the Monitor

Attach the 7-inch IPS monitor to your dashboard or windshield using the provided U bracket or suction cup mount. Position it for clear visibility without obstructing your view of the road.



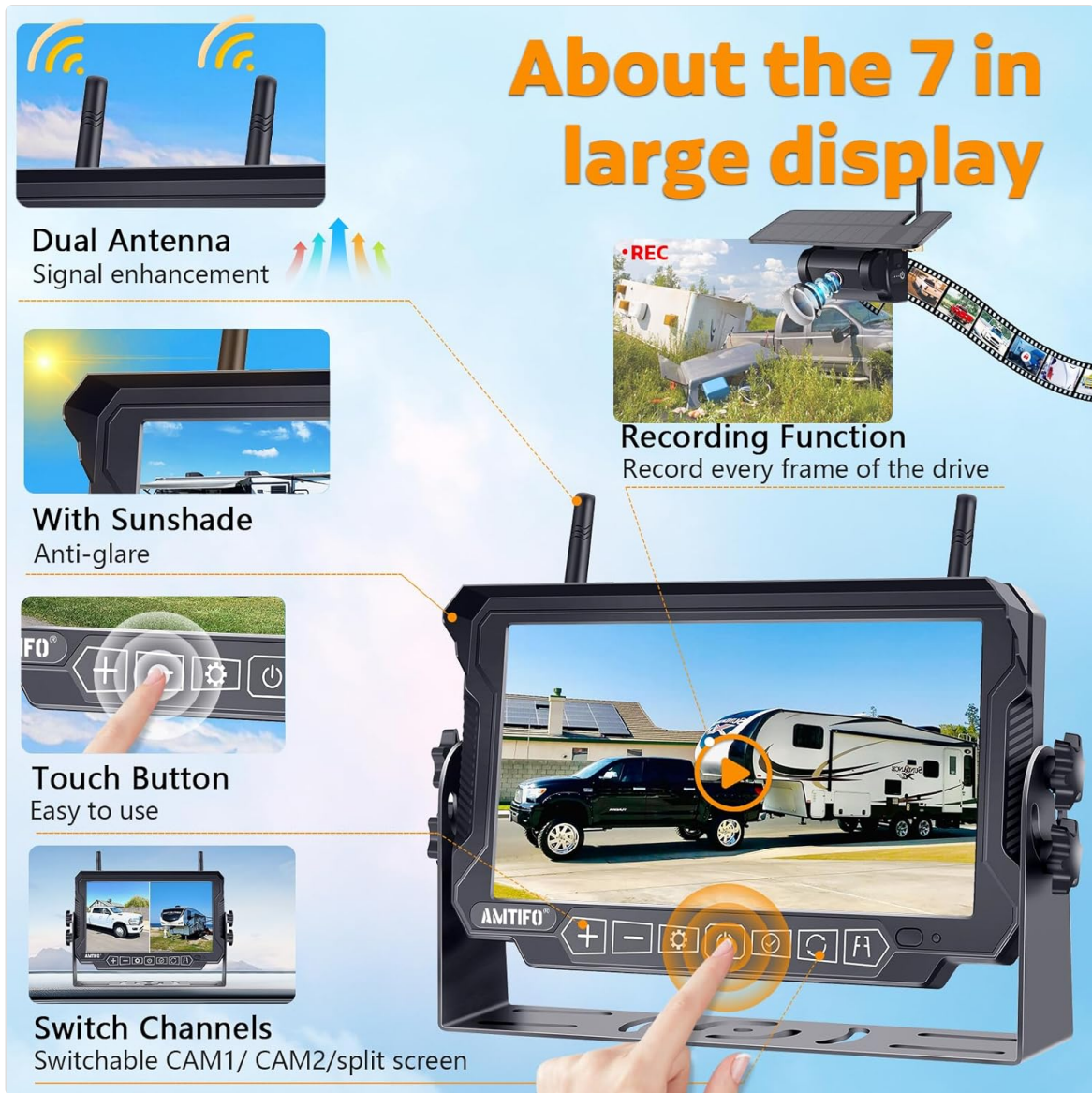

Figure 6: The 7-inch monitor with dual antennas for signal enhancement, a sunshade for anti-glare, and touch buttons for easy operation.

#### 4.4 Powering the Monitor

Connect the monitor to your vehicle's power source using the cigarette lighter plug or the USB to Type C cable. The system is designed for quick DIY installation without requiring special tools.

Your browser does not support the video tag.

Video 1: Demonstrates the easy installation of the magnetic wireless backup camera and monitor, including power options via USB and car charger. This video is provided by the seller, Yakry-US.

## 5. OPERATING INSTRUCTIONS

### 5.1 Turning On/Off

Press and hold the power button on the monitor for 5-10 seconds to turn the system on or off. The camera will automatically activate when the monitor is powered on.

### 5.2 Display Modes and Settings

The 7-inch IPS monitor features touch buttons for easy navigation. You can switch between different camera channels (if multiple cameras are paired) and view in full screen or split screen mode. Access the menu to adjust brightness, contrast, hue, and other display settings.

# Loop Recording Function

Automatically overwrites the unprotected video when the SD card is full, record like a dash cam does. Supports max **128 GB SD card**.



Touch Button



Loop Record



Search Video  
Conveniently



56ft



(Not included)



Figure 7: The monitor's multi-functional menu, allowing access to pairing, picture settings, mirror/flip options, system settings, recording, and playback.



# Multi Functional RV Backup Camera System

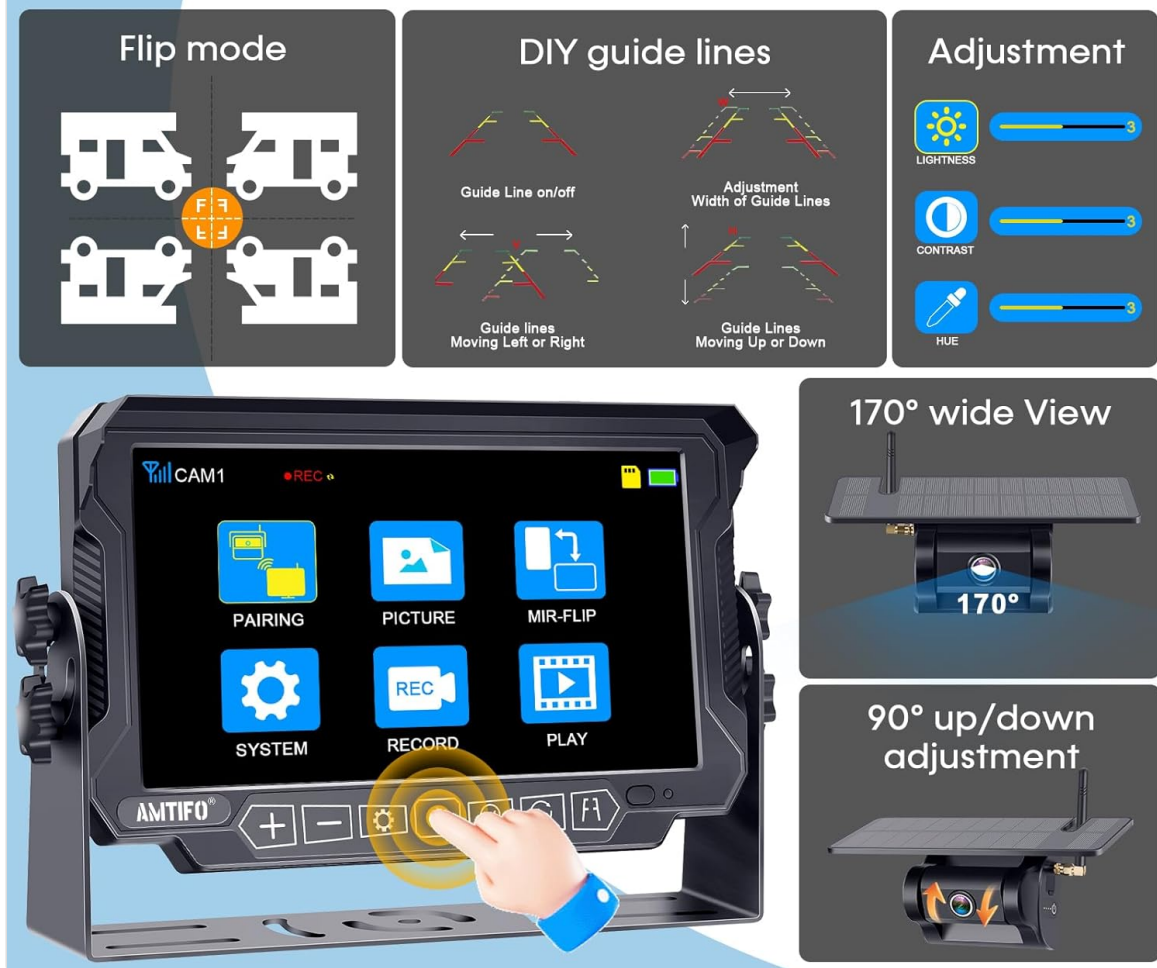

Figure 8: The monitor displaying options for adjusting DIY guide lines, including width, height, and horizontal position.

## 5.3 Guide Lines and Image Flip

Customize your view with adjustable guide lines for precise parking and reversing. The image flip function allows you to change the orientation of the camera feed (Normal, Mirror, Inverted Front, Inverted Mirror) to suit your preference or mounting position.

# The great gift

◀ Families

◀ Friends



Suitable for up  
to **99.9%** of vehicles



Figure 9: The monitor illustrating various image flip modes: Normal, Mirror, Inverted Front Image, and Inverted Mirror Image.

## 5.4 Recording Function

The built-in recording function allows you to capture and store video footage. The system supports up to a 128GB SD card and features loop recording, automatically overwriting unprotected video when the card is full.

## 5.5 Night Vision and Wide-Angle View

The camera provides advanced night vision for clear visibility in low-light conditions. Its 170° wide-angle lens minimizes blind spots, offering full coverage for safer maneuvering of large vehicles.

## Sturdy and Durable Metal Camera

Temperature Range: -22°F~176°F



IP69K Waterproof



High temperature  
resistance



Low temperature  
resistance



Figure 10: Comparison of day and night vision capabilities, showcasing the HD 1080P and crystal night vision of the AMTIFO A8 camera.

## 6. MAINTENANCE

- **Cleaning:** Regularly clean the camera lens and monitor screen with a soft, damp cloth. Avoid abrasive cleaners.
- **Battery Care:** Ensure the solar panel is exposed to sunlight when possible to maintain battery charge. If storing for extended periods, fully charge the camera battery.
- **Weather Protection:** The camera is IP69K-rated for weather resistance. However, avoid prolonged exposure to extreme conditions when not in use to extend product lifespan.

## 7. TROUBLESHOOTING

Problem	Possible Solution
No signal on monitor	Ensure both camera and monitor are powered on. Check antenna connections. Verify wireless range (up to 100ft).
Camera not charging	Ensure solar panel is exposed to direct sunlight. Connect via USB-C cable to charge manually.
Image is distorted or unclear	Clean camera lens and monitor screen. Check for obstructions. Adjust brightness/contrast settings.
Monitor does not turn on	Check power connection (cigarette lighter or USB). Ensure vehicle's power outlet is functional.

## 8. SPECIFICATIONS

- **Product Dimensions:** 4.75 x 1.72 x 7.38 inches
- **Item Weight:** 3.81 pounds
- **Item Model Number:** A8
- **Batteries:** 1 Lithium Ion batteries required (included)
- **Display Technology:** LCD
- **Other Display Features:** Wireless
- **Screen Size:** 7 Inches
- **Compatible Devices:** RVs, trailers, campers, trucks, 5th-wheels, boats, tractors
- **Installation Type:** Surface Mount (Magnetic)
- **Voltage:** 12 Volts
- **Optical Sensor Technology:** CMOS Infrared
- **Lens Type:** Wide Angle
- **Real Angle of View:** 170 Degrees
- **Connector Type:** Wireless
- **Weatherproof Rating:** IP69K
- **Wireless Range:** Up to 100ft
- **Camera Battery:** 15000mAh (Solar & Battery Powered)







## 9. WARRANTY AND SUPPORT

This product comes with a 2-year protection plan option. For technical support, warranty claims, or any inquiries, please refer to the contact information provided with your purchase or visit the official AMTIFO website. Ensure you retain your proof of purchase for warranty services.

For additional support and product information, you may visit the [AMTIFO Store on Amazon](#).

### Related Documents - A8

 <p>AMTIFO Solar Magnetic Backup Camera &amp; Monitor Kit Product Manual - Installation Instructions</p> <p>Please read the manual thoroughly before operating the device, and keep it for future reference.</p>	<p><a href="#">AMTIFO Solar Magnetic Backup Camera &amp; Monitor Kit: User Manual and Installation Guide</a></p> <p>Comprehensive user manual and installation guide for the AMTIFO Solar Magnetic Backup Camera &amp; Monitor Kit. Learn about setup, features, troubleshooting, and product specifications for vehicles.</p>
 <p>Wireless Backup Camera and Touch Button Screen System Product Manual - Installation Instructions</p> <p>Please read the manual thoroughly before operating the device, and keep it for future reference. Customer Service Team Email: <a href="mailto:amtifo@yourcamera.store">amtifo@yourcamera.store</a></p>	<p><a href="#">Amtifo Wireless Backup Camera and Touch Button Screen System Manual</a></p> <p>Comprehensive manual for the Amtifo Wireless Backup Camera and Touch Button Screen System, covering installation, features, and troubleshooting. Includes 1080P DVR and touch button functionality.</p>
 <p>AMTIFO Wireless Backup Camera with 7-inch Dash Cam Monitor Product Manual - Installation Instructions</p> <p>Please read the manual thoroughly before operating the device, and keep it for future reference.</p>	<p><a href="#">AMTIFO Wireless Backup Camera with 7-inch Dash Cam Monitor User Manual</a></p> <p>Comprehensive user manual for the AMTIFO Wireless Backup Camera system featuring a 7-inch dash cam monitor. Includes installation guides, troubleshooting tips, and product features for enhanced vehicle safety.</p>
 <p>AMTIFO A6 Digital Wireless Backup Camera &amp; Monitor Kit Product Manual - Installation Instructions</p> <p>Please read the manual thoroughly before operating the device, and keep it for future reference.</p>	<p><a href="#">AMTIFO A6 Digital Wireless Backup Camera &amp; Monitor Kit: Installation Manual</a></p> <p>Comprehensive installation manual and user guide for the AMTIFO A6 Digital Wireless Backup Camera &amp; Monitor Kit, featuring HD 1080P resolution, stable signal transmission, and easy setup for various vehicles.</p>
 <p>User Manual AMTIFO 2K Wireless Magnetic Security Camera</p>	<p><a href="#">AMTIFO 2K Wireless Magnetic Security Camera User Manual</a></p> <p>Comprehensive user manual for the AMTIFO 2K Wireless Magnetic Security Camera, detailing its features, installation, and operation for both indoor and outdoor use. Highlights include 2K video quality, color night vision, two-way talk, PIR motion detection, and magnetic mounting.</p>

AMTIFO®

Solar Wireless Security Camera

Product Manual & Installation Instructions



Please read this manual thoroughly before operating the device and keep it for future reference.

## [AMTIFO Solar Wireless Security Camera: User Manual & Installation Guide](#)

Comprehensive user manual and installation guide for the AMTIFO Solar Wireless Security Camera. Learn about setup, features, app connection, and troubleshooting for your home security system.