

## HARDELL DM22410ORAHD-1

# HARDELL 4V Cordless Rotary Tool Kit Instruction Manual

Model: DM22410ORAHD-1

## 1. SAFETY INFORMATION

Please read and understand all safety warnings and instructions before operating this tool. Failure to follow the warnings and instructions may result in electric shock, fire, and/or serious injury.

- **Eye Protection:** Always wear appropriate eye protection (safety glasses or goggles) when operating the rotary tool.
- **Secure Workpiece:** Always secure the workpiece firmly to prevent movement during operation.
- **Correct Accessories:** Use only accessories designed for this tool and suitable for the specific task. Ensure accessories are properly installed and tightened.
- **Keep Hands Clear:** Keep hands and fingers away from rotating accessories.
- **Disconnect Power:** Disconnect the tool from its power source (or ensure it is off) before changing accessories, making adjustments, or performing maintenance.
- **Environmental Conditions:** Do not operate the tool in damp or wet conditions. Keep the work area well-lit and clear of clutter.
- **Bystander Safety:** Keep children and bystanders away from the operating area.
- **Avoid Overloading:** Do not force the tool. Allow the tool to work at its intended speed.
- **Battery Safety:** Do not disassemble, crush, or expose the battery to high temperatures. Dispose of batteries properly.

## 2. PRODUCT OVERVIEW

The HARDELL 4V Cordless Rotary Tool is a versatile handheld power tool designed for various tasks such as cutting, sanding, polishing, drilling, and carving. It features a powerful motor, variable speed settings, a digital display, and a long-lasting 4000mAh battery with Type-C fast charging.

## 2.1 Package Contents

Verify that all items are present in your package:

- 1x HARDELL 4V Cordless Rotary Tool
- 20x Sandpaper
- 5x Big Sand Ring
- 1x Big Sand Drum
- 10x Small Sand Ring
- 1x Small Sand Drum
- 15x Standard Cutting Disc
- 5x Mesh Cutting Disc
- 1x Diamond Cutting Disc
- 1x Cutting Disc Connecting Handle
- 5x Big Wool Wheel
- 1x Wool Wheel Connecting Handle
- 2x Silicon Carbide Grinding Wheel
- 3x Aluminum Oxide Grinding Wheel
- 1x Wire Brush (flat)
- 2x 1/8 inch Chuck
- 1x 1/8 inch Drill Bit
- 1x Milling Cutter
- 3x Diamond Grinding Head
- 1x Wrench
- 1x Data Cable (Type-C)
- 1x Instruction Manual



Image 2.1: The HARDELL 4V Cordless Rotary Tool and its complete set of 80 accessories, including various sanding, cutting, polishing, grinding, and drilling attachments, along with charging cable and wrench.

### 3. SPECIFICATIONS

Feature	Specification
Brand	HARDELL
Model Number	DM22410ORAHD-1
Voltage	4 Volts
Power Source	Battery Powered (Lithium Ion)
Battery Capacity	4000mAh
Charging Type	Type-C Fast Charging
Charging Time	2-4 hours

Continuous Working Time	60-120 minutes
Variable Speeds	6 settings (8000-28000 RPM)
Chuck Size	1/8 inch
Item Weight	0.88 pounds (tool only) / 1.26 pounds (package)
Product Dimensions	7.6 x 1.5 x 1.4 inches
Special Features	Cordless, Ergonomic Grip, Lightweight, Digital Gear & Power Display, Safety Lock

## 4. SETUP

---

### 4.1 Charging the Tool

Before first use, fully charge the rotary tool. The digital power display will indicate the charging status.

1. Connect the provided Type-C data cable to the charging port on the tool.
2. Connect the other end of the cable to a compatible USB power source (e.g., wall adapter, computer, power bank).
3. The digital display will show charging progress. A full charge typically takes 2-4 hours.
4. Disconnect the cable once fully charged.



# 4000MAH & TYPE-C

Large capacity battery – ultra-long battery life

## Visual battery reminder

no more worries about battery life

Image 4.1: The HARDELL rotary tool connected to a laptop via a Type-C cable for charging, with the digital display showing battery status. This illustrates the convenient charging method.

## 4.2 Attaching Accessories

Always ensure the tool is powered off before changing accessories.

### 4.2.1 General Accessory Installation

1. Press down the spindle locking button to secure the shaft and unscrew the nut at the chuck.
2. Choose the appropriate collet for your accessory's shank size and insert it into the chuck. Then, place the black nut over the collet.
3. Insert the desired accessory bit into the collet. Hold the lock button and screw on the nut tightly using the provided wrench.
4. **Important:** Do not press the spindle lock button while the motor is running.



Image 4.2: A visual guide demonstrating the four steps for installing a general accessory: pressing the spindle lock, selecting the collet, inserting the bit, and tightening the nut with a wrench.

#### 4.2.2 Sanding Band Installation

1. Insert the sanding drum into the collet and tighten the nut.
2. Loosen the screw on the sanding drum.
3. Install the sanding band onto the drum.
4. Press down the spindle lock button and tighten the screw of the sanding drum with the wrench.

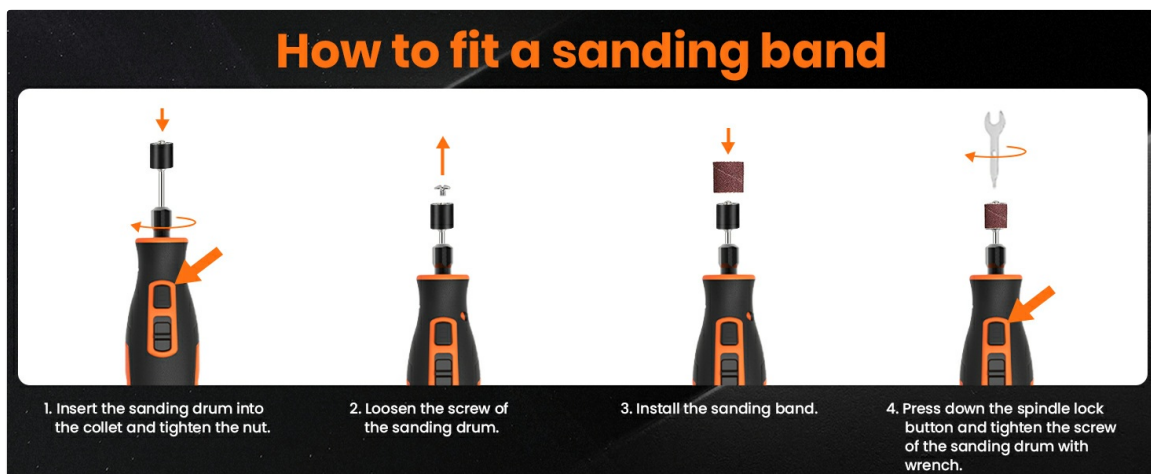

Image 4.3: A visual guide demonstrating the four steps for fitting a sanding band: inserting the drum, loosening the screw, installing the band, and tightening the screw.

#### 4.2.3 HSS Cutting Disc / Sanding Paper Installation

1. Insert the wheel mandrel into the collet and tighten the nut.
2. Dismantle the screw of the wheel mandrel.
3. Install the wheel mandrel and assemble the HSS cutting disc or sanding paper.
4. Press down the spindle lock button and tighten the screw of the wheel mandrel with the wrench.



Image 4.4: A visual guide demonstrating the four steps for fitting an HSS cutting disc or sanding paper: inserting the mandrel, dismantling the screw, assembling the disc/paper, and tightening the screw.

## 5. OPERATING INSTRUCTIONS

### 5.1 Powering On/Off

- To turn on the tool, press the power button. The digital display will illuminate.
- To turn off the tool, press the power button again.

### 5.2 Adjusting Speed

The tool features 6 variable speed settings, ranging from 8000 RPM to 28000 RPM. The digital display shows the current speed setting.

- Use the '+' and '-' buttons to increase or decrease the rotational speed.
- Select a lower speed for polishing and cleaning, and higher speeds for grinding, sharpening, cutting, and drilling.



Image 5.1: An internal view of the HARDELL rotary tool highlighting the 6-speed adjustment gear, with a chart indicating recommended RPM ranges for various applications like polishing, cleaning, grinding, cutting, and drilling.

### 5.3 Digital Display

The digital display provides real-time information about the tool's status:

- **Speed Setting:** Displays the current gear/speed level (1-6).
- **Battery Level:** Shows the remaining battery charge (100%, 75%, 50%, 25%). This helps prevent unexpected power outages during use.

## REAL-TIME POWER DISPLAY

no longer worry about power outages



Image 5.2: The HARDELL rotary tool showcasing its digital display, which indicates the current speed setting (e.g., '6') and the battery charge level (e.g., 100%, 75%, 50%, 25%).

### 5.4 Applications

The HARDELL rotary tool is suitable for a wide range of applications:

- **Cutting:** Use appropriate cutting discs for materials like metal, plastic, or wood.
- **Sanding:** Utilize sanding bands or paper for smoothing surfaces and removing material.
- **Polishing:** Attach wool wheels or felt wheels with polishing compound for a smooth, shiny finish.
- **Drilling:** Use drill bits for creating small holes in various materials.
- **Carving/Engraving:** Employ diamond grinding heads or milling cutters for detailed work on wood, metal, or stone.



Image 5.3: The rotary tool in use, demonstrating a cutting application on a metal rod, with sparks indicating active material removal.



Image 5.4: The rotary tool being used for sanding a piece of wood, showing a sanding band attachment smoothing the surface.



Image 5.5: The rotary tool in action, demonstrating a polishing application on a small, spherical object using a soft polishing wheel.

## DRILLING



Image 5.6: The rotary tool being used for a drilling application, creating a small hole in a piece of wood.

## CARVING



Image 5.7: The rotary tool engaged in a carving application, creating intricate designs on a wooden surface.

## 6. MAINTENANCE

---

Regular maintenance ensures optimal performance and extends the life of your tool.

- **Cleaning:** After each use, wipe the tool body with a clean, dry cloth. Use a soft brush or compressed air to clear dust and debris from ventilation openings. Do not use harsh chemicals or abrasive cleaners.
- **Accessory Care:** Clean accessories after use. Store them in the provided case to prevent damage and loss. Replace worn or damaged accessories promptly.
- **Battery Storage:** For long-term storage, charge the battery to approximately 50% and store the tool in a cool, dry place away from direct sunlight. Recharge every 3-6 months if not in use to maintain battery health.
- **General Inspection:** Periodically check for loose screws, damaged cords (if applicable), or any other signs of wear or damage. Do not operate a damaged tool.

## 7. TROUBLESHOOTING

Refer to the table below for common issues and their solutions.





Problem	Possible Cause	Solution
Tool does not turn on	Battery is depleted	Charge the tool fully using the Type-C cable.
Tool stops during operation	Overload protection activated / Low battery	Reduce pressure on the tool or recharge the battery.
Accessory wobbles or falls out	Chuck nut not tightened / Incorrect collet size	Ensure the chuck nut is securely tightened with the wrench. Verify the correct collet size is used for the accessory shank.
Poor performance / Slow cutting/sanding	Worn accessory / Incorrect speed setting / Excessive pressure	Replace the accessory if worn. Increase the speed setting. Apply less pressure, allowing the tool to do the work.
Tool gets hot quickly	Continuous heavy use / Blocked ventilation	Allow the tool to cool down. Ensure ventilation ports are clear of debris. Avoid prolonged heavy-duty tasks.

## 8. WARRANTY AND SUPPORT

HARDELL provides a one-year warranty for this product from the date of purchase. Additionally, a 30-day free return policy is offered to ensure customer satisfaction.

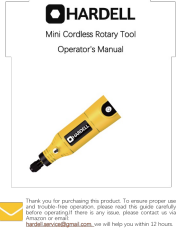
For technical support, warranty claims, or any questions regarding your HARDELL 4V Cordless Rotary Tool Kit, please contact our customer service team through the retailer's platform or visit the official HARDELL website for contact information.

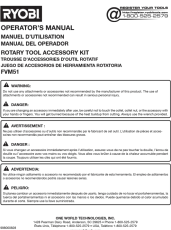
© 2025 HARDELL. All rights reserved.

	<p><a href="#">HARDELL 4V Cordless Rotary Tool Kit User Manual - Comprehensive Guide</a></p> <p>Detailed user manual for the HARDELL 4V Cordless Rotary Tool Kit. Learn about components, technical specifications, operating instructions, speed control, accessory usage, safety precautions, maintenance, and warranty. Includes 101 accessories and USB-C charging.</p>
	<p><a href="#">HARDELL Mini Cordless Rotary Tool Operator's Manual &amp; Guide</a></p> <p>Comprehensive operator's manual for the HARDELL Mini Cordless Rotary Tool, covering product descriptions, package contents, usage instructions, applications, safety guidelines, and warranty information.</p>
	<p><a href="#">HARDELL Mini Cordless Rotary Tool Operator's Manual</a></p> <p>Operator's manual for the HARDELL Mini Cordless Rotary Tool, detailing components, specifications, package contents, usage instructions, applications, and safety guidelines.</p>
	<p><a href="#">HARDELL Mini Cordless Rotary Tool FAQ</a></p> <p>Frequently asked questions about the HARDELL Mini Cordless Rotary Tool, covering its uses, charging, and included accessories.</p>
	<p><a href="#">RYOBI FVM51 Rotary Tool Accessory Kit Operator's Manual</a></p> <p>Operator's manual for the RYOBI FVM51 Rotary Tool Accessory Kit. Includes safety warnings, detailed accessory descriptions, applications, and RPM specifications for engraving, polishing, sanding, and sharpening tasks.</p>
	<p><a href="#">Bosch UniversalHammer 18V Cordless Rotary Hammer</a></p> <p>Discover the Bosch UniversalHammer 18V cordless rotary hammer, designed for versatile drilling applications in concrete, brick, wood, and metal. This guide details its features, usage, and battery compatibility.</p>