

## Manuals+

[Q & A](#) | [Deep Search](#) | [Upload](#)

Manuals.plus /

› [UBORSY](#) /

› UBORSY FAN53T Ceiling Fan Remote Control User Manual

## UBORSY FAN53T Remote

# UBORSY FAN53T Ceiling Fan Remote Control User Manual

Model: FAN53T Remote (Internal Model: HK-RE)

## 1. INTRODUCTION

---

This manual provides comprehensive instructions for the UBORSY FAN53T Ceiling Fan Remote Control. This remote is designed as a replacement for various ceiling fan models, offering 3-speed fan control and light dimming capabilities. Please read these instructions carefully before installation and operation to ensure proper function and safety.





Image 1.1: The UBORSY FAN53T remote control, showing its ergonomic design and button layout.

## 2. PRODUCT FEATURES

---

- **3-Speed Fan Control:** High, Medium, Low, and OFF settings for fan speed.
- **Light Control:** ON/OFF functionality for all bulb types. Dimming feature for incandescent lights.
- **Luminous Button:** The light button glows in the dark for easy location.
- **DIP Switch Pairing:** Multiple pairing methods for broad compatibility.
- **Upgraded Circuit Board:** Enhanced durability and heat dissipation.



## Remote Control Feature



Image 2.1: Illustration of the remote control's features, including 3-speed fan control, light control, and a luminous button, shown with a ceiling fan in a living room setting.

### 3. COMPATIBILITY

The FAN53T remote is designed to replace various ceiling fan remotes. To ensure compatibility, verify the FCC ID/Model number on the back of your original remote. Compatible FCC ID/Model numbers include:

- FAN-53T
- FAN-11T
- KUJCE9103
- UC7030T
- L3HFAN35T
- L3HFAN35T1
- 2AAZPFAN35TI
- FAN-HD
- FAN-HD5

This remote operates at 303.9MHz. It is compatible with most downrod style ceiling fans. It is **not compatible** with wall-mounted fans, exhaust-type fans, or hugger-style fans.

### Light Bulb Compatibility:

- **Dimmable:** Halogen, Incandescent, Dimmable LED, Dimmable CFL lamps.
- **ON/OFF Only:** Non-dimmable LED/CFL bulbs will only support ON/OFF functionality.
- **Not Supported:** Smart bulbs.



## Fan Remote Compatible



Check the number on the back of your original remote, it needs to have one of the FCC ID/Model numbers listed below.

Compatible with *FAN28R / FAN18R Receiver*

Replacement of these Remotes.  
FCC ID/ Model:

2AAZPFAN53T/FAN-53T/  
L3HFANIIT/FAN/11T/  
KUJCE9103/EO8BT  
CHQ7030T/UC7030T(53T)



2AAZPFAN35T1/L3HFAN35T/  
L3HFAN35T1



L3H2010FANHD/FAN-HD/  
L3H2014FANHD/FAN-HD/  
FAN-HD5(HD5)



UC-9050T/CHQ905IT/  
UC7067(9050T)



### Note:

This FAN-53T remote works at 303.9MHz,  
NOT have Reverse button.

Image 3.1: Diagram showing the location of the FCC ID on the back of the remote and a list of compatible FCC ID/Model numbers for replacement.



## Compatible with Lights and Fans



❌ Not recommended for use with wall mounted fans or exhaust-type fans



✅ Compatible with most downrod style fans



**Compatible with incandescent light bulbs and dimmable LED/CFL Lamps,  
Non-dimmable LED/CFL bulbs only support ON/OFF function**

Image 3.2: Visual guide illustrating compatible fan types (downrod style) and light bulb types (halogen, incandescent, dimmable LED/CFL) for the remote control.

## 4. SETUP AND PAIRING

### 4.1 Battery Installation

The FAN53T remote control requires a 9V battery (not included). Open the battery compartment cover on the back of the remote and insert the 9V battery, observing the correct polarity. Close the cover securely.

### 4.2 Pairing the Remote (DIP Switches)

The remote control uses DIP switches for pairing with your ceiling fan receiver. There are three methods to pair your new remote:

1. **Match Existing Remote:** If you have your old remote, open its battery compartment to locate the DIP switches. Set the DIP switches on your new FAN53T remote to match the exact configuration of your old remote. The DIP switches on the new remote are located within the battery compartment, behind the battery slot.
2. **Trial and Error (16 Combinations):** If you do not have your old remote, you can try the 16 possible DIP switch combinations. Systematically try each combination until the remote successfully controls your fan.
3. **Match Receiver Settings:** Locate the receiver unit inside your ceiling fan canopy. The receiver will have its own set of DIP switches. Set the DIP switches on your new remote to match the configuration found on the receiver.

After setting the DIP switches, insert the battery and test the remote's functionality.



## How to Pair

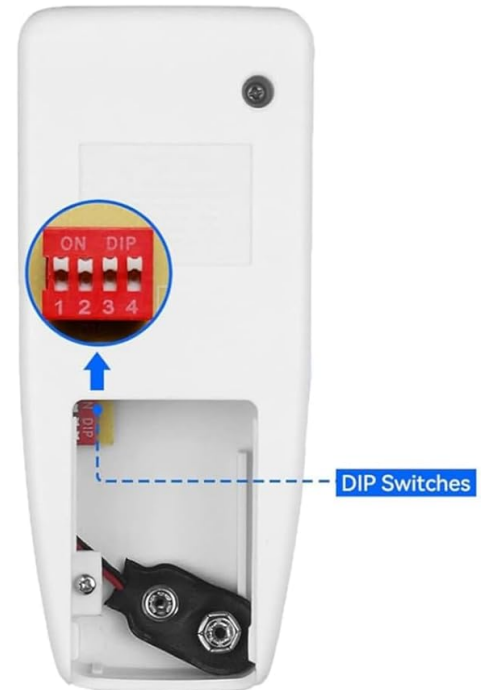

### *There are 3 ways to pair your new ceiling fan remote:*

1. Match DIP switches settings from your old remote to your new remote.
2. If you don't have your old remote, try the 16 possible DIP switches combinations.
3. Find the DIP switches settings on the receiver inside your ceiling fan and match them on your new remote.

Image 4.1: Diagram illustrating the location of the DIP switches inside the remote's battery compartment and the three methods for pairing the remote with a ceiling fan.

# Quality Upgrades

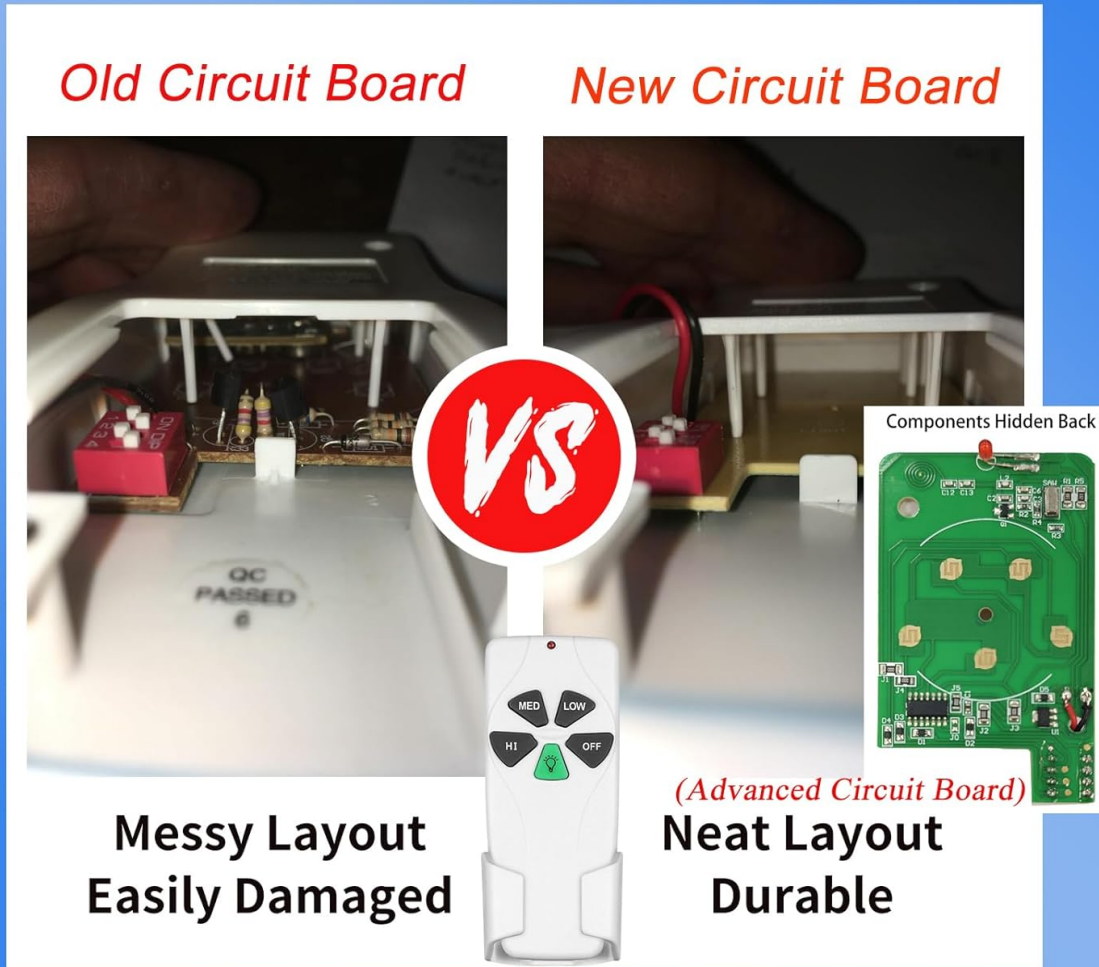

Image 4.2: Comparison of an old circuit board design with a new, upgraded circuit board, highlighting the neat layout and hidden components of the advanced design for improved durability.

## 5. OPERATING INSTRUCTIONS

Once paired, the remote control provides intuitive operation of your ceiling fan and light.

### 5.1 Fan Control

- **HI:** Press to set the fan to high speed.
- **MED:** Press to set the fan to medium speed.
- **LOW:** Press to set the fan to low speed.
- **OFF:** Press to turn the fan off.

### 5.2 Light Control

- **Light Button (Green):** Press once to turn the light ON or OFF.
- **Dimming:** For incandescent lights, press and hold the light button to dim or brighten the light. Release the button when the desired brightness is reached.
- **LED/CFL Bulbs:** If using non-dimmable LED or CFL bulbs, the light button will only function as an ON/OFF switch. Dimming functionality is not supported for these bulb types unless they are

specifically dimmable models.

## 6. MAINTENANCE

---

### 6.1 Battery Replacement

When the remote control's range decreases or buttons become unresponsive, it is likely time to replace the 9V battery. Follow the battery installation steps in Section 4.1.

### 6.2 Cleaning

Wipe the remote control with a soft, dry cloth. Do not use abrasive cleaners or immerse the remote in water.

## 7. TROUBLESHOOTING

---

- **Remote Not Working:**

- Check if the 9V battery is installed correctly and has sufficient charge. Replace if necessary.
- Verify that the DIP switch settings on the remote match those of your fan's receiver or your old remote. Refer to Section 4.2.
- Ensure the fan's power supply is on at the wall switch or circuit breaker.

- **Light Not Dimming:**

- Confirm that the light bulbs installed are dimmable (e.g., incandescent, dimmable LED/CFL). Non-dimmable bulbs will only turn ON/OFF.

- **Fan Not Responding to Speed Changes:**

- Recheck DIP switch settings.
- Ensure the fan motor is not obstructed.

## 8. SPECIFICATIONS

---

Feature	Specification
Model Number	HK-RE
Operating Frequency	303.9 MHz
Power Source	9V Battery (not included)
Fan Speeds	3 (High, Medium, Low) + OFF
Light Control	ON/OFF, Dimming (for incandescent bulbs)
Dimensions (Remote)	Approximately 5.12 x 2.44 x 1.18 inches
Item Weight	2.4 ounces



## Size and Package

### ① Remote control



### ② Wall mount holder

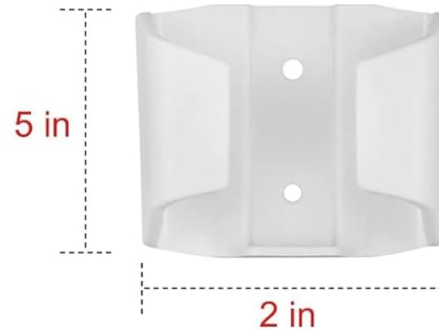

### ③ Screws

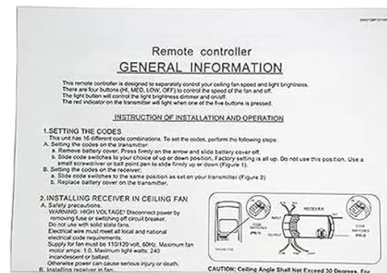

### ④ User manual

Image 8.1: Diagram showing the dimensions of the remote control and the typical package contents, including the remote, wall mount holder, screws, and user manual.

## 9. WARRANTY AND SUPPORT

For warranty information or technical support, please refer to the documentation included with your purchase or contact UBORSY customer service through the retailer where the product was purchased. Keep your purchase receipt for warranty claims.