

## DELI DC095

# DELI Mini Heat Gun DC095 User Manual

Model: DC095

## 1. INTRODUCTION

Thank you for choosing the DELI Mini Heat Gun DC095. This compact and versatile tool is designed for a variety of crafting, DIY, and light industrial applications. With its dual temperature settings and included nozzles, it provides precise heat for tasks such as shrink wrapping, embossing, resin work, and more. Please read this manual thoroughly before use to ensure safe and optimal operation.



Image 1.1: DELI Mini Heat Gun DC095 and included accessories.

## 2. IMPORTANT SAFETY INSTRUCTIONS

**WARNING: Failure to follow these instructions may result in electric shock, fire, or serious personal injury.**

- Always wear appropriate personal protective equipment, such as heat-resistant gloves and eye protection.
- Do not touch the metal nozzle or surrounding areas during or immediately after use, as they become extremely hot.
- Ensure adequate ventilation when operating the heat gun to prevent the buildup of fumes.
- Keep the heat gun away from flammable materials, liquids, and gases.
- Never point the heat gun directly at people or animals.
- Do not block the air intake or exhaust vents. Keep them clear of dust and debris.

- Unplug the heat gun from the power outlet when not in use, before cleaning, or before changing accessories.
- Do not use the heat gun in damp or wet conditions.
- This appliance is not intended for use by persons (including children) with reduced physical, sensory, or mental capabilities, or lack of experience and knowledge, unless they have been given supervision or instruction concerning use of the appliance by a person responsible for their safety.
- The heat gun features built-in overheating protection. If the unit overheats, it will automatically shut off. Allow it to cool down before resuming use.

### 3. PACKAGE CONTENTS

---

Please check the package to ensure all items are present and undamaged:

- DELI Mini Heat Gun DC095
- Reflector Nozzle
- Flat Nozzle

### 4. PRODUCT FEATURES

---

- **Powerful Performance:** 350W motor provides efficient heating.
- **Dual Temperature Settings:** Offers two heat levels for versatile applications: Low (500°F / 260°C) and High (842°F / 450°C).
- **Fast Heating:** Reaches operating temperature quickly, typically within 1.5 seconds.
- **Compact & Lightweight Design:** Ergonomic build for comfortable and precise handling, reducing fatigue during extended use.
- **Built-in Metal Stand:** Allows for hands-free operation and safe cooling.
- **Overheating Protection:** Integrated safety mechanism to prevent damage from excessive heat.
- **Long Power Cable:** Equipped with a 6.07 ft (approximately 1.85m) cable for extended reach.
- **Versatile Nozzles:** Includes a reflector nozzle and a flat nozzle for various tasks.

**350W High Power**

**1.5s**

**Fast Heating**



Image 4.1: The 350W heating element provides rapid heat-up.



01

**Comfortable Grip:**  
For precise,  
effortless handling

02

**Built-in Metal Stand:**  
For hands-free  
convenience



**L 9.4" D1.8" Cord length: 6.07 ft**



Image 4.2: Ergonomic design with a comfortable grip and integrated stand for convenience.

## 5. SETUP

1. **Unpack the Heat Gun:** Carefully remove the heat gun and all accessories from the packaging.
2. **Inspect for Damage:** Check the heat gun and power cord for any signs of damage. Do not use if damaged.
3. **Attach Nozzle (Optional):** Select the appropriate nozzle for your task. Align the nozzle with the heat gun's outlet and push it firmly into place. Ensure it is securely attached before use.
4. **Position the Heat Gun:** Place the heat gun on a stable, heat-resistant surface, or hold it securely. If using the built-in stand, unfold it to support the unit.
5. **Connect to Power:** Plug the power cord into a standard 110V AC electrical outlet.

## 6. OPERATING INSTRUCTIONS

### 6.1 Powering On and Temperature Selection



1. Ensure the heat gun is plugged into a suitable power source.
2. Locate the power switch on the handle. This switch typically has three positions: OFF, LOW, and HIGH.
3. To turn on the heat gun at the lower temperature setting (500°F / 260°C), slide the switch to the 'LOW' position.
4. To turn on the heat gun at the higher temperature setting (842°F / 450°C), slide the switch to the 'HIGH' position.
5. Allow a few seconds for the heat gun to reach the desired temperature.
6. To turn off the heat gun, slide the switch to the 'OFF' position. Always allow the unit to cool down completely before storing.



Image 6.1: The heat gun offers two distinct temperature settings for various tasks.

## 6.2 Using the Nozzles

The DELI Mini Heat Gun comes with specialized nozzles to direct heat effectively:

- **Reflector Nozzle:** Ideal for shrink wrapping applications, such as heat shrink tubing or packaging. It helps distribute heat evenly around the object.

- **Flat Nozzle:** Useful for general heating tasks, such as drying paint, removing stickers, or working with resin. It provides a broader, more focused heat stream.

## 3 in 1 Nozzle

Versatile heating for every task

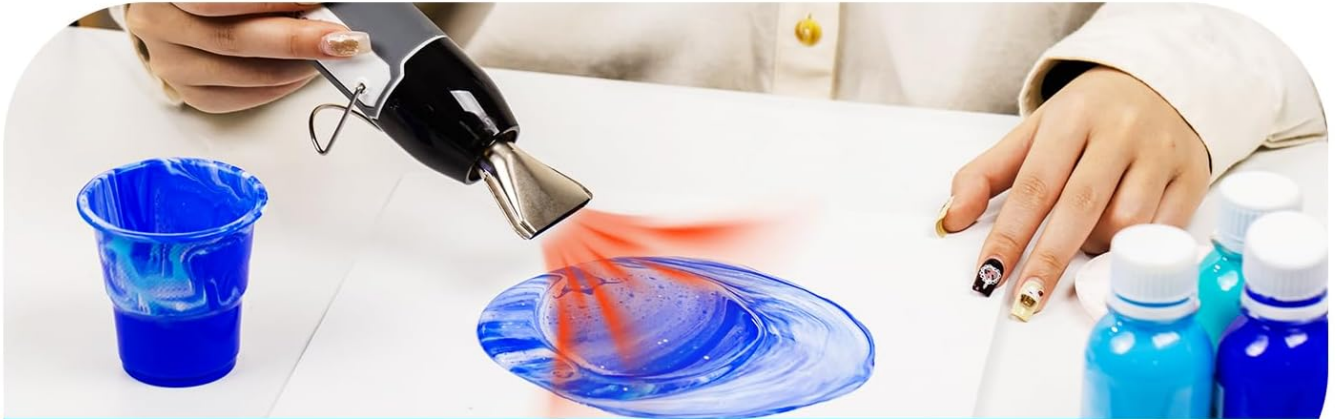

Fish Tail Nozzle: Control the flow direction in liquid art



Round Nozzle: Removing bubbies



Reflector Nozzle: Heating shrink

Image 6.2: Different nozzles for specific heating requirements.

### 6.3 Common Applications

The DELI Mini Heat Gun is suitable for a wide range of tasks:

- **Shrink Wrapping:** Use the reflector nozzle to evenly shrink films around objects like soaps, mugs, or electrical connections.
- **Craft Embossing:** Apply heat to embossing powder on cards or other craft projects to create raised designs.
- **Resin Projects:** Remove air bubbles from epoxy resin by gently heating the surface.
- **Candle Making:** Smooth the tops of candles or melt wax for various designs.
- **Removing Stickers/Labels:** Soften adhesive for easier removal from surfaces.
- **Fabric Patches:** Activate heat-sensitive adhesives on fabric patches.
- **Drying Paint/Ink:** Accelerate the drying process for certain paints or inks in art projects.
- **Thawing Pipes:** Gently apply heat to thaw frozen water pipes (exercise extreme caution and ensure pipes are not under pressure).

- **Repairing Electronics:** For specific tasks like heat shrinking wire insulation or desoldering components (requires advanced knowledge and caution).

# Versatile and Powerful

## Shrink wrapping mugs



Image 6.3: Examples of versatile applications for the heat gun.





Image 6.4: Removing stickers with gentle heat.



Image 6.5: Applying heat to shrink tubing for electrical insulation.

## 7. MAINTENANCE

---

Proper maintenance ensures the longevity and safe operation of your DELI Mini Heat Gun.

- **Cleaning:** After each use, ensure the heat gun is unplugged and completely cool. Use a soft, dry cloth to wipe down the exterior. Do not use abrasive cleaners or solvents.
- **Clear Air Vents:** Periodically check the air intake and exhaust vents for dust, lint, or debris. Use a soft brush or compressed air to gently clear any blockages. Blocked vents can lead to overheating.
- **Cord Inspection:** Regularly inspect the power cord for cuts, fraying, or damage. If the cord is damaged, do not use the heat gun and seek professional repair.
- **Storage:** Store the heat gun in a dry, cool place, away from direct sunlight and out of reach of children. Ensure the power cord is neatly coiled and not kinked.

## 8. TROUBLESHOOTING

---

If you encounter issues with your DELI Mini Heat Gun, refer to the following common problems and solutions:

Problem	Possible Cause	Solution
Heat gun does not turn on.	No power supply. Power switch is OFF. Damaged power cord.	Check if the power cord is securely plugged into a live outlet. Ensure the power switch is set to 'LOW' or 'HIGH'. Inspect the power cord for damage. Do not use if damaged.
Heat gun turns on but produces no heat or insufficient heat.	Air vents are blocked. Overheating protection activated. Internal component failure.	Unplug and allow to cool. Clear any blockages from air vents. Unplug and allow the unit to cool down for at least 15-20 minutes. Contact customer support if the issue persists after checking other solutions.
Excessive smoke or unusual odor.	Foreign material inside. Overheating.	Immediately unplug the unit. Do not use. Contact customer support. Unplug and allow to cool. Ensure air vents are clear.

## 9. SPECIFICATIONS

Feature	Detail
Model Number	DC095
Power Source	Corded Electric
Wattage	350 watts
Voltage	110 Volts
Temperature Settings	Low: 500°F (260°C) High: 842°F (450°C)
Product Dimensions (L x W x H)	9" x 1.8" x 1.8" (approx.)
Item Weight	13.7 ounces (approx.)
Cable Length	6.07 ft (approx. 1.85m)
Compatible Materials	Heat shrink tubing, Plastic, Resin, Sealing wax
Included Components	Heat gun, Reflector Nozzle, Flat Nozzle

## 10. WARRANTY AND SUPPORT

### 10.1 Warranty Information

For detailed warranty information, including coverage period and terms, please refer to the product packaging or the official DELI website. Keep your purchase receipt as proof of purchase for any warranty claims.

### 10.2 Customer Support

If you have any questions, require technical assistance, or need to report a problem with your DELI Mini Heat Gun, please

© 2025 DELI. All rights reserved.

## Related Documents - DC095

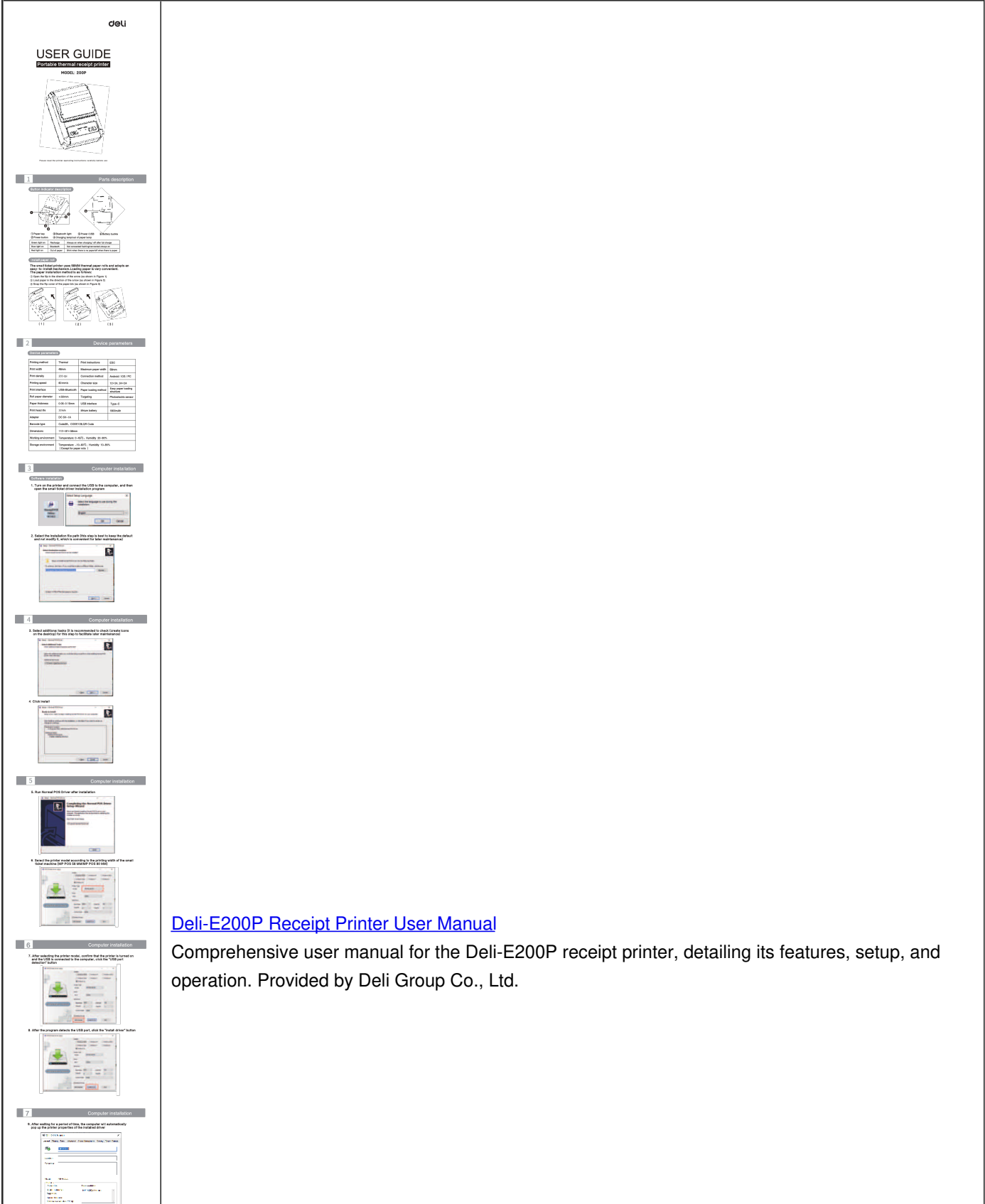

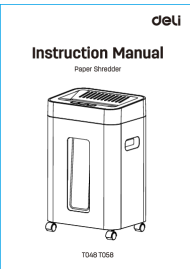
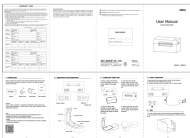
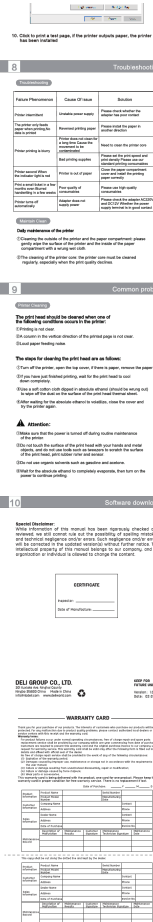

Deli E3765 Face Recognition Attendance Machine User Manual

Comprehensive user manual for the Deli E3765 Face Recognition Attendance Machine, covering installation, setup, registration, operation, and reporting.

[Deli 760DW Thermal Label Printer User Manual and Warranty Information](#)

User manual and warranty information for the Deli 760DW Thermal Label Printer, covering packing list, appearance, paper loading, power connection, and tips. Includes warranty card details and special disclaimers.

[Deli Laminator User Manual: Models 3891, 3892, 3893, 3894 - Operation and Maintenance](#)

Comprehensive user manual for Deli laminators (models 3891, 3892, 3893, 3894) covering operation, safety precautions, maintenance, technical specifications, and troubleshooting. Learn how to use your Deli laminator effectively.

[Deli T048 & T058 Paper Shredder Instruction Manual](#)

Official instruction manual for Deli T048 and T058 paper shredders. Covers safety, specifications, operation, maintenance, and troubleshooting for secure document destruction in office environments.



# U

Thermal Receipt Printer  
USER'S MANUAL  
MODEL: 581P/581PW

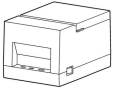

deli DELI ELECTRONICS CO., LTD.

## [Deli 581P/581PW Thermal Receipt Printer User Manual](#)

User manual for the Deli 581P and 581PW thermal receipt printers, covering packing, setup, operation, and important tips.