

VOVO VOVO+

VOVO Go Portable Electric Bidet Instruction Manual

Model: VOVO+

1. INTRODUCTION

Thank you for choosing the VOVO Go Portable Electric Bidet. This compact and lightweight device is designed to provide convenient personal hygiene on the go, featuring adjustable pressure settings and a leak-proof design. Please read this manual thoroughly before use to ensure proper operation and maintenance.

2. SAFETY INFORMATION

- Do not immerse the entire unit in water. The device is IPX6 waterproof, meaning it is protected against powerful water jets, but not continuous submersion.
- Use only clean, potable water. Do not use chemical solutions or abrasive cleaners in the water tank.
- Keep out of reach of children.
- Ensure batteries are inserted correctly according to polarity markings.
- Do not attempt to disassemble or repair the unit yourself. Contact customer support if service is required.

3. PACKAGE CONTENTS

Verify that all items are included in your package:

- VOVO Go Portable Bidet
- Protective Case
- User Manual
- AAA Batteries (x2)
- Spare Nozzle Tip (3-holes, optional)

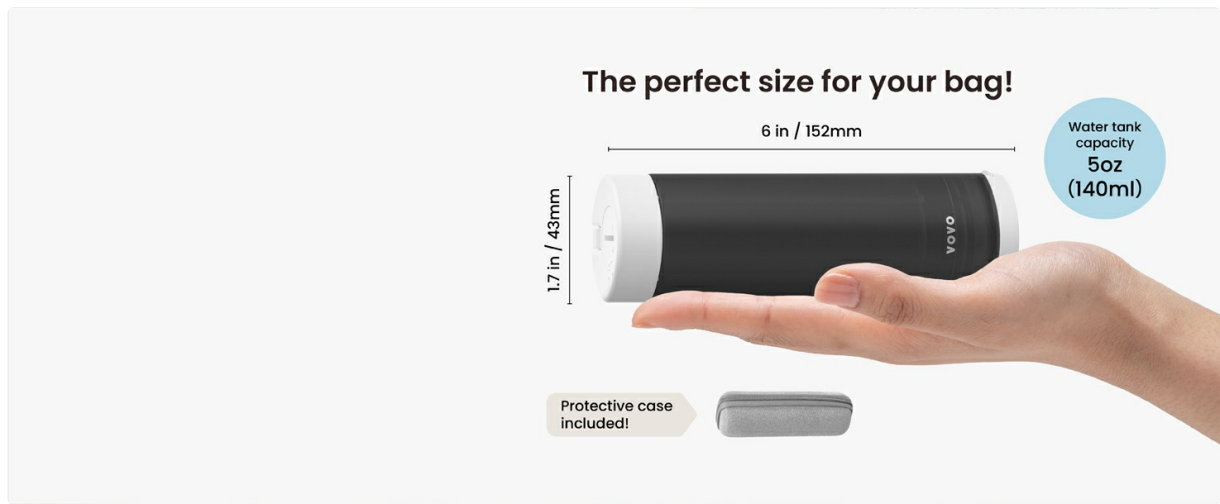

Image: Package contents of the VOVO Go Portable Bidet.

4. SPECIFICATIONS

Feature	Detail
Model Name	VOVO+
Material	Plastic, Rubber
Color	Pearl Black
Water Tank Capacity	140ml (5 oz)
Power Source	2 x AAA Alkaline Batteries
Water Pressure Settings	2 (High, Low)
Waterproof Rating	IPX6
Dimensions	1.7 x 1.7 x 6 inches (43 x 43 x 152 mm)
Weight	0.48 lb (220g)

5. SETUP

5.1 Inserting Batteries

1. Twist and remove the battery cover from the top of the bidet unit.
2. Insert two AAA alkaline batteries, ensuring correct polarity (+/-) as indicated inside the compartment.
3. Replace the battery cover and twist to secure it.

How to Use Our Product: Simple and Effortless!



1 Insert batteries



2 Open the lid

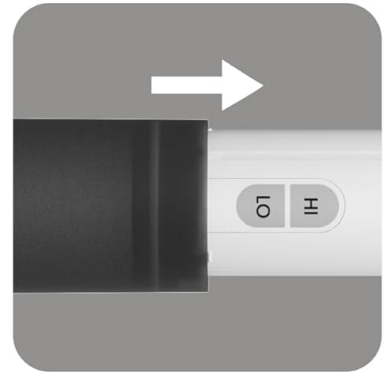

3 Pull out the tank



4 Add water



5 Pull out the nozzle



6 Enjoy your bidet!

Image: Step 1 of the usage guide, showing battery insertion.

5.2 Filling the Water Tank

1. Open the water tank lid.
2. Pull out the internal water tank from the main body.
3. Fill the tank with clean, warm, or cold water (up to 140ml). Do not overfill.
4. Insert the water tank back into the main body and close the lid securely.



Image: Steps for filling the water tank.

6. OPERATING INSTRUCTIONS

6.1 Adjusting the Nozzle

Gently pull out the nozzle from the bidet unit. The nozzle can be adjusted up to 180 degrees to achieve the desired angle for cleaning.



Image: Nozzle adjustment and IPX6 rating.

6.2 Selecting Water Pressure

The VOVO Go bidet offers two pressure settings:

- **HI (High):** Provides a powerful water spray for effective cleaning.
- **LO (Low):** Provides a soft water spray for a gentle cleanse.

Press the corresponding 'HI' or 'LO' button on the unit to select your preferred pressure.



VOVO GO Portable Bidet
설명서 / User Manual / Manuel d'utilisation / Manual de usuario

공식 자사몰에서 등록 등록을 해주세요.
공식 자사몰에서 등록 등록을 해주세요.
공식 자사몰에서 등록 등록을 해주세요.

Please go to the link below for any customer support and register the product.
Please go to the link below for any customer support and register the product.
Please go to the link below for any customer support and register the product.

(Optional)



What's included:

- 1 VOVO GO portable bidet
- 2 Protective case
- 3 User manual
- 4 AAA batteries X2
- 5 Spare nozzle tip 3-holes (Option)
(Replace if requires stronger pressure)

Image: Dual-mode sprayer with High and Low pressure options.

6.3 General Usage

1. After filling the tank and extending the nozzle, position the bidet as desired (can be used from front or back).
2. Press the 'HI' or 'LO' button to activate the water spray.
3. Move the bidet gently to ensure thorough cleaning.

4. Release the button to stop the water flow.
5. After use, retract the nozzle and empty any remaining water from the tank.

How to Use Our Product: Simple and Effortless!



1 Insert batteries



2 Open the lid

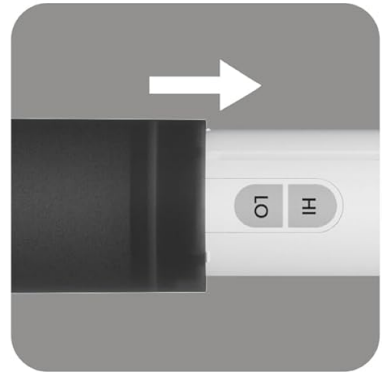

3 Pull out the tank



4 Add water



5 Pull out the nozzle



6 Enjoy your bidet!

Image: How to use the VOVO Go Portable Bidet.

6.4 Product Video Guide

Your browser does not support the video tag.

Video: Official VOVO GO Portable Bidet product overview and usage demonstration. This video illustrates the features and operation of the bidet, including battery installation, water filling, nozzle adjustment, and pressure settings.

7. MAINTENANCE

7.1 Cleaning

- After each use, empty any remaining water from the tank.
- Wipe the exterior of the bidet with a soft, damp cloth.
- For thorough cleaning, the nozzle can be gently removed and rinsed under running water. Ensure it is dry before reattaching.
- Do not use harsh chemicals, abrasive cleaners, or boiling water, as these may damage the unit.

7.2 Storage

Store the bidet in its protective case in a cool, dry place when not in use. If storing for an extended period, remove the batteries to prevent leakage.

8. TROUBLESHOOTING

Problem	Possible Cause	Solution
No water spray	Low or no water in tank Batteries are dead or incorrectly inserted	Refill water tank Replace batteries or check polarity
Weak water spray	Low battery power Nozzle clogged	Replace batteries Clean the nozzle thoroughly
Water leakage	Tank lid not closed properly Nozzle not fully retracted	Ensure tank lid is securely fastened Push nozzle back into unit completely

9. WARRANTY AND SUPPORT

VOVO products are manufactured with high-quality standards. For warranty information or technical support, please refer to the warranty card included in your package or visit the official VOVO website. Keep your purchase receipt as proof of purchase.