

AUTOTOP SF20250910B0DLKNT166

AUTOTOP Wireless CarPlay Android Auto Adapter for BMW NBT Systems

Instruction Manual

1. INTRODUCTION

This manual provides detailed instructions for the installation and operation of your AUTOTOP Wireless CarPlay and Android Auto Adapter. This device integrates advanced smartphone functionalities into your BMW's original NBT system, enhancing your driving experience with navigation, communication, and entertainment features.

Key Features:

- Supports wireless and wired CarPlay and Android Auto.
- Wireless connectivity for mobile phones via Bluetooth and Wi-Fi.
- Retains original car control functionality (steering wheel, iDrive knob).
- Adaptive original car resolution function.
- Supports original reverse camera, 360° camera, front view DVR, and rear-mounted DAB+ radio.

Compatibility: Suitable for BMW 1-7 Series, X1-X6 Series with NBT system (LVDS 6-pin).



Image 1.1: The AUTOTOP Wireless CarPlay Android Auto Adapter module and its integration with a BMW's in-car display, showing Apple CarPlay interface.

2. SAFETY INFORMATION

- Read all instructions carefully before installation and use.
- Installation should ideally be performed by a qualified technician to avoid damage to the vehicle's electrical system.
- Ensure the vehicle's ignition is off and the battery is disconnected before beginning installation.
- Do not operate the device in a manner that distracts you from driving. Always prioritize road safety.
- Keep the device away from water, moisture, and extreme temperatures.

3. PACKAGE CONTENTS

Please verify that all items listed below are included in your package:

- 1 x AUTOTOP CarPlay Adapter Module
- 1 x Power Harness

- 1 x LVDS Cable
- 1 x USB Cable
- 1 x Wi-Fi Antenna
- 1 x USB-CVBS Cable
- 1 x Microphone (only for NBT systems)

Product list



Image 3.1: Overview of the included components: CarPlay box, power harness, LVDS cable, Wi-Fi antenna, USB-CVBS cable, and microphone.

4. SETUP AND INSTALLATION

The installation process involves connecting the adapter to your vehicle's existing wiring. This is a plug-and-play solution, designed to avoid cutting or damaging original wires.

4.1 Pre-Installation Checks

- Verify your BMW has an NBT system with a 6-pin LVDS port.
- Measure your original car screen size (not an upgraded screen).
- For NBT EVO MGU systems, ensure the toggle switch adjustment is correctly set according to your screen size and model. Refer to the product documentation or contact support if unsure.

4.2 Wiring Diagram

Follow the wiring diagram carefully. The adapter connects between the original head unit and the display.

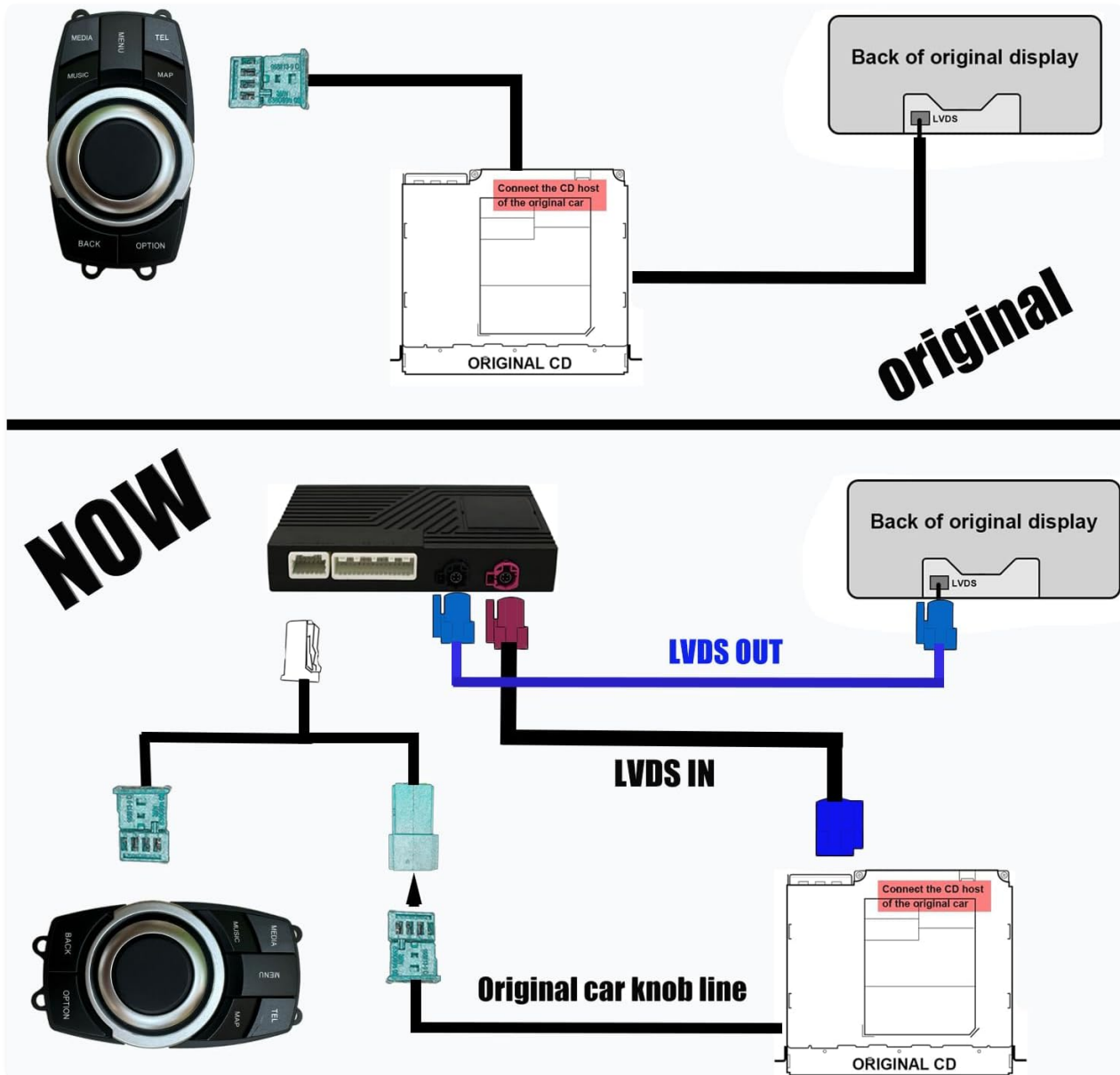

Image 4.1: Detailed wiring diagram showing connections from the original CD unit, original display, and iDrive knob to the new CarPlay adapter module.

4.3 iDrive Controller Connection

The iDrive controller connection depends on the button label on your controller:

- If your iDrive button is labeled "MENU", use the blue connector.
- If your iDrive button is labeled "HOME", use the black connector.

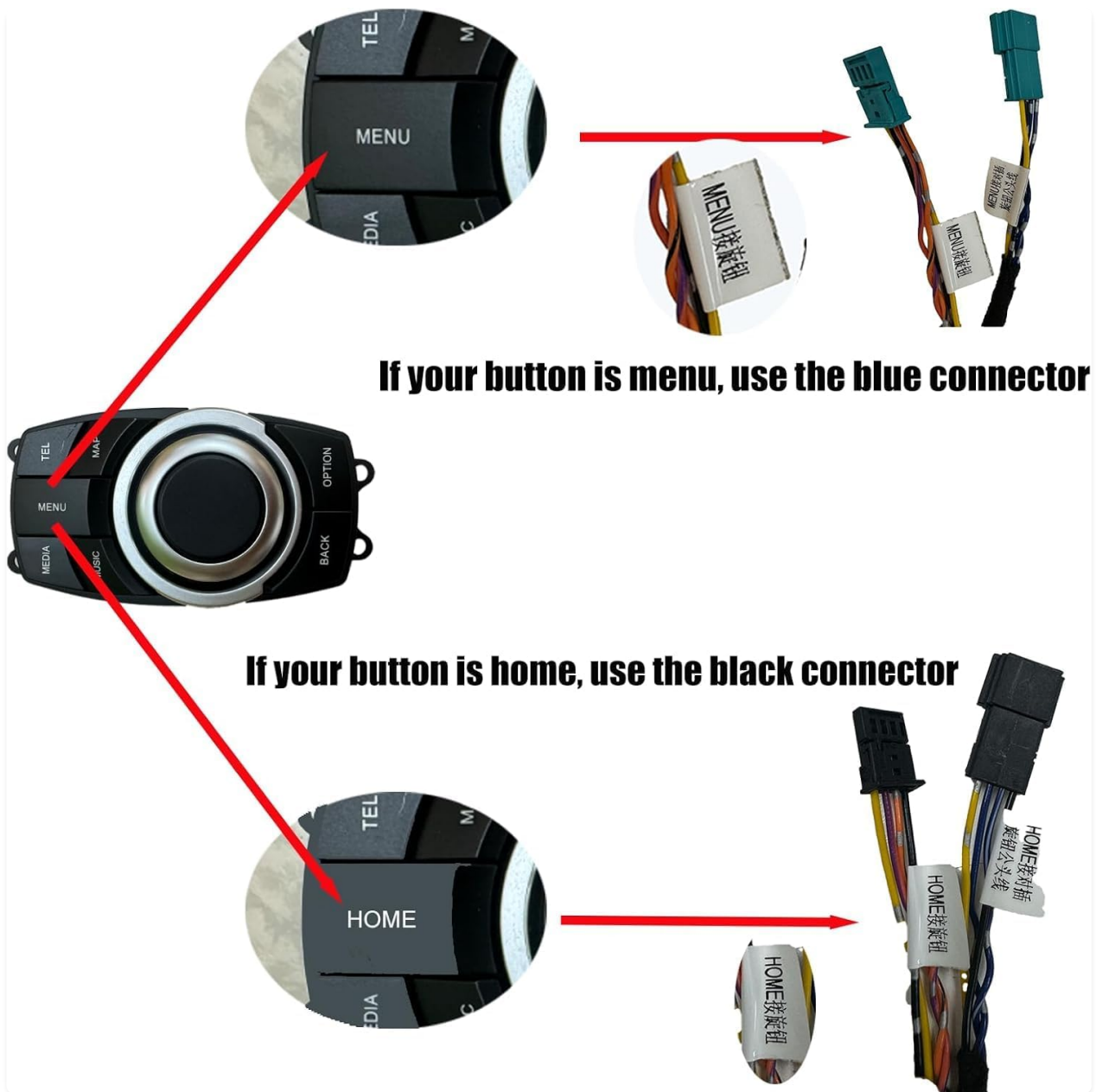

Image 4.2: Visual guide for connecting the iDrive controller based on whether its main button is labeled "MENU" or "HOME".

5. OPERATING INSTRUCTIONS

5.1 Switching Between Systems

To switch between your BMW's original system and the CarPlay/Android Auto interface, simply press the "MENU" button on your iDrive controller. This allows for seamless transition between the two systems.

System switch



Just press Menu button on idrive,you can switch original system and carplay system freely



Image 5.1: Demonstrates how to switch between the original BMW system and the CarPlay system by pressing the iDrive "MENU" button.

5.2 Connecting Your Smartphone

The adapter supports both wireless and wired connections for CarPlay, Android Auto, and Mirrorlink. Enable Bluetooth and Wi-Fi on your smartphone and follow the on-screen prompts to pair your device with the adapter.



Image 5.2: Illustrates the various connectivity options including CarPlay, Android Auto, Airplay, and Autolink.

5.3 Supported Controls and Functions

The adapter integrates with your car's original controls:

- **Steering Wheel Controls:** Supports voice control, phone button, next/previous track, and volume +/- buttons.
- **iDrive Knob Control:** Full control over the CarPlay/Android Auto interface.
- **Supported Applications:** Access navigation, music, Siri, phone calls, and messaging directly from your car's display.
- **Additional Features:** Supports original reverse camera, 360° camera, front view DVR, and rear-mounted DAB+ radio.

Product features



Original car control operation

The upgrade is not just to assemble the intelligent system for your car,
but also supports the original car operation control system



Support Steering
wheel control



Support iDrive
knob control

Image 5.3: Highlights key product features such as CarPlay, Android Auto, Wi-Fi, Bluetooth, Maps, Music, and Phone, along with integration for steering wheel and iDrive knob controls.

6. MAINTENANCE

The AUTOTOP adapter requires minimal maintenance. Keep the unit clean and free from dust. Avoid exposing it to extreme temperatures or direct sunlight for prolonged periods. Do not attempt to open the adapter casing, as this will void the warranty.

7. TROUBLESHOOTING

If you encounter any issues, please refer to the following common solutions:

- **No Display/Black Screen:** Check all cable connections, especially the LVDS cable. Ensure the power harness is securely connected. Verify the toggle switch settings for NBT EVO MGU systems.
- **No Sound:** Ensure your phone's volume is up and the car's audio input is correctly selected (e.g., AUX). Check Bluetooth connection.
- **Connection Issues (Wireless CarPlay/Android Auto):** Ensure Wi-Fi and Bluetooth are enabled on your phone and the adapter. Try forgetting the device on your phone and re-pairing.
- **Controls Not Responding:** Verify the correct iDrive connector (MENU/HOME) was used during

installation. Ensure steering wheel control wires are properly connected.

- **Intermittent Functionality:** Check for loose connections. Restart both your phone and the car's infotainment system.

If problems persist, please contact AUTOTOP customer support for professional technical assistance.

8. SPECIFICATIONS

Feature	Specification
Brand	AUTOTOP
Model	SF20250910B0DLKNT166
Host System Compatibility	BMW NBT
Port Type	LVDS 6-pin
Supported Connectivity	Wireless CarPlay, Wired CarPlay, Wireless Android Auto, Wired Android Auto, MirrorLink
Wireless Technologies	Bluetooth, Wi-Fi
Compatible Peripherals	Smartphone, Tablet
Additional Features	360° Camera Support, Front View DVR Support, DAB+ Radio Support
Audio Output Mode	Stereo
Surround Configuration	5.1
Video Encoding	H.264, H.265/HEVC
Item Weight	1.01 Kilograms
Package Dimensions	25.4 x 16.3 x 9.8 cm

9. WARRANTY AND SUPPORT

AUTOTOP is committed to providing high-quality products and customer satisfaction. For any questions regarding installation, operation, or troubleshooting, please contact our technical support team. We aim to provide professional technical assistance within 24 hours.

Please refer to your purchase documentation for specific warranty terms and conditions. Keep your proof of purchase for warranty claims.