

Groove e51f9b41-672f-4a44-9b61-f1ef3df7f698

Groove Wireless Bluetooth Earbuds with Charging Case Instruction Manual

Model: e51f9b41-672f-4a44-9b61-f1ef3df7f698

INTRODUCTION

Thank you for choosing Groove Wireless Bluetooth Earbuds. This manual provides essential information for the proper setup, operation, and maintenance of your new earbuds. Please read it thoroughly before use to ensure optimal performance and longevity of your device.

WHAT'S IN THE BOX

Carefully unpack your Groove Wireless Bluetooth Earbuds package. Ensure all items listed below are present:

- Wireless Active Lifestyle Earphones (Left and Right)
- Charging Case
- Eartips (Small, Medium, Large)
- USB-C Charging Cable



Image: Contents of the Groove Wireless Bluetooth Earbuds package, including earbuds, charging case, USB-C cable, and various eartip sizes.

SETUP

1. Charging the Earbuds and Case

Before first use, fully charge both the earbuds and the charging case.

- Insert the USB-C charging cable into the charging port on the case.
- Connect the other end of the cable to a USB power adapter (not included) or a computer's USB port.
- The LED display on the charging case will indicate the charging status. A full charge for the case provides up to 80 hours of additional playtime for the earbuds.
- Place the earbuds into the charging case. They will begin charging automatically. A single charge for the earbuds provides approximately 14 hours of playtime.



Image: The charging case displaying battery levels, indicating 14 hours of single charge playtime for earbuds and 80 hours total with the case.

2. Bluetooth Pairing

Follow these steps to pair your earbuds with your device:

1. Ensure the earbuds are charged and placed in the charging case.
2. Open the charging case. The earbuds will automatically enter pairing mode, indicated by a flashing LED light on the earbuds.
3. On your device (smartphone, tablet, computer), go to Bluetooth settings and turn Bluetooth on.
4. Search for available devices. Select "Groove-X31" (or similar model name) from the list.
5. Once connected, the LED indicator on the earbuds will stop flashing. You are now ready to use your earbuds.



Image: A visual representation of the Bluetooth pairing process, showing the earbuds connecting to a mobile device.

3. Wearing the Earbuds

For optimal sound quality and a secure fit, choose the correct eartip size and adjust the ear hooks.

- Select the eartips (Small, Medium, or Large) that provide the best seal and comfort for your ears.
- Gently insert the earbud into your ear canal.
- Adjust the flexible ear hook over your ear to secure the earbud in place.

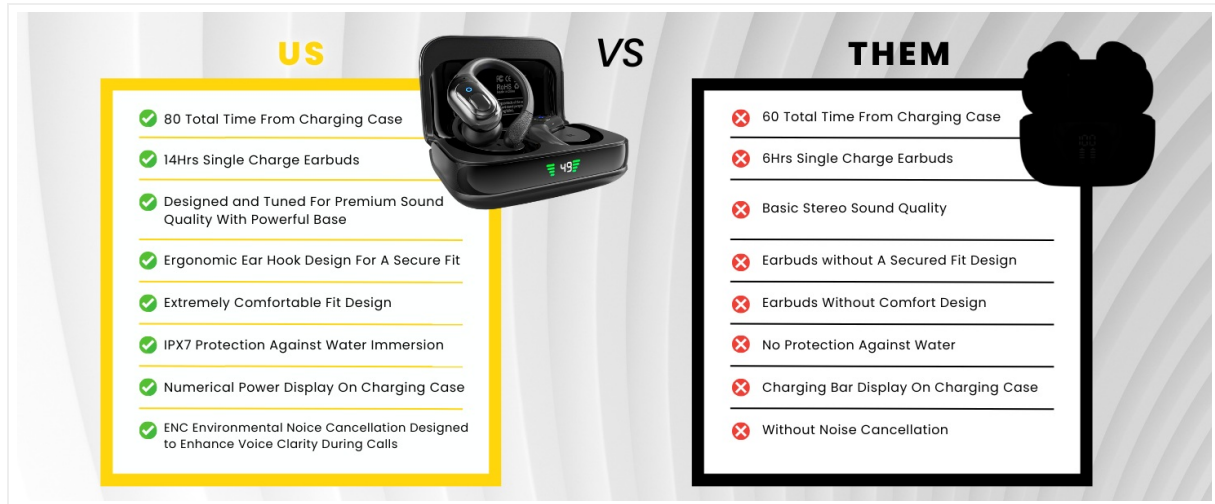

Image: Illustration of ergonomic design with different eartip sizes (S, M, L) and a person wearing the earbud for a secure fit.

OPERATING INSTRUCTIONS

Your Groove Wireless Bluetooth Earbuds feature intuitive push-button controls for various functions.

INTUITIVE PUSH BUTTON CONTROL



Image: Detailed guide to the push-button controls on the earbuds for various audio and call functions.

Button Controls Summary:

- **Play/Pause:** Press the button once (X1) on either L/R earbud.
- **Switch Song (Next/Previous):** Press the button twice (X2) on L/R earbud.
- **Voice Assistant (Siri/Google Assistant):** Press the button three times (X3) on L/R earbud.
- **Answer/Hang Up Call:** Press the button once (X1) on L/R earbud.
- **Adjust Volume:** Press and hold for 2 seconds (2S) on L/R earbud.
- **Reject Call:** Press and hold for 2 seconds (2S) on L/R earbud.
- **Reset:** Press the button five times (X5) on L/R earbud.
- **Power On/Off:** Press and hold for 2-5 seconds (2S/5S) on L/R earbud.

MAINTENANCE

Proper maintenance ensures the longevity and performance of your earbuds.

Cleaning

- Regularly clean the eartips and earbud surfaces with a soft, dry, lint-free cloth.

- If necessary, use a slightly damp cloth with mild soap for stubborn dirt, then wipe dry immediately.
- Do not use abrasive cleaners, alcohol, or chemical solvents.
- Ensure charging contacts on both earbuds and case are clean and dry to prevent charging issues.

Storage

- When not in use, store the earbuds in their charging case to protect them from dust and damage.
- Store the charging case and earbuds in a cool, dry place, away from extreme temperatures and direct sunlight.



Image: Earbuds shown with water droplets, highlighting their IPX7 waterproof and sweat-resistant design, making them suitable for active use.

TROUBLESHOOTING

If you encounter issues with your earbuds, refer to the following common solutions:

Problem	Possible Solution
Earbuds not turning on	Ensure earbuds are charged. Place them in the charging case and check the LED indicator.
Cannot pair with device	Make sure Bluetooth is enabled on your device. Ensure earbuds are in pairing mode (flashing LED). Forget previous pairings on your device and try again. Move closer to your device.
Only one earbud working	Place both earbuds back into the charging case, close the lid, then open it again. Check if both earbuds are charged. Perform a factory reset (press button five times).
Poor sound quality or disconnections	Ensure earbuds are fully charged. Move closer to your device to avoid interference. Check for obstructions between earbuds and device. Clean eartips and earbud mesh.

Problem	Possible Solution
Charging case not charging	Check the USB-C cable and power adapter. Ensure the charging port is clean and free of debris. Try a different cable or power source.

SPECIFICATIONS

Feature	Detail
Model Number	e51f9b41-672f-4a44-9b61-f1ef3df7f698
Brand	Groove
Connectivity Technology	Wireless, Bluetooth 5.3
Bluetooth Range	Up to 15 meters (49 feet)
Battery Life (Earbuds)	Up to 14 hours (single charge)
Total Playtime (with Case)	Up to 80 hours
Water Resistance Level	IPX7 Waterproof
Noise Control	Environmental Noise Cancellation (ENC) for calls
Audio Driver Type	Dynamic Driver (10mm)
Frequency Range	20Hz - 20,000Hz
Impedance	140 Ohm
Control Method	Push Button
Earpiece Shape	Hook
Item Weight	5 ounces
Package Dimensions	5.43 x 3.66 x 1.65 inches

WARRANTY AND SUPPORT

Groove Electronics stands behind the quality of its products. For specific warranty information, please refer to the warranty card included with your purchase or visit the official Groove Electronics website. If you require technical assistance or have questions not covered in this manual, please contact Groove customer support through their official channels.

Contact Information: Please refer to the packaging or the official Groove Electronics website for the most up-to-date customer support contact details.

