

VEVOR HZS006

VEVOR Rattan Shoe Cabinet Black Instruction Manual

Model: HZS006

INTRODUCTION

Thank you for choosing the VEVOR Rattan Shoe Cabinet. This manual provides essential information for the safe assembly, operation, and maintenance of your new shoe cabinet. Please read all instructions carefully before assembly and use, and retain this manual for future reference.

Safety Warnings

- **Weight Capacity:** The top surface has a maximum weight capacity of 27.2 kg (60 lbs). Each flip-open drawer has a maximum weight capacity of 9.1 kg (20 lbs). Do not exceed these limits to prevent damage or injury.
- **Anti-Tipping Device:** It is crucial to install the included anti-tipping device correctly. This device prevents the cabinet from falling over, especially important in households with children or pets. Failure to install it properly can result in serious injury.
- **Assembly:** Ensure all components are securely fastened according to the assembly instructions. Do not use power tools for tightening screws unless explicitly stated, as over-tightening can strip threads or damage parts.
- **Placement:** Place the cabinet on a flat, stable surface. Avoid placing it in areas with high humidity or direct sunlight to prevent material degradation.

SETUP AND ASSEMBLY

The VEVOR Rattan Shoe Cabinet is designed for easy assembly with detailed graphic instructions provided in the packaging. Please follow these instructions step-by-step.

Key Assembly Steps:

1. **Unpack and Verify:** Carefully unpack all components and compare them against the parts list in your

assembly guide to ensure all pieces are present and undamaged.

2. **Assemble Frame:** Begin by assembling the main frame of the cabinet, ensuring all connections are firm but not overly tightened until the entire structure is stable.
3. **Install Drawers:** Attach the flip-open drawer mechanisms and the sliding top drawer according to the diagrams. Ensure smooth operation before proceeding.
4. **Attach Legs:** Securely fasten the metal support legs to the base of the cabinet.
5. **Install Anti-Tipping Device:** This is a critical safety step. Attach the anti-tipping device to the back of the cabinet and secure it to a wall stud using appropriate hardware. Refer to the specific instructions for the anti-tipping device for proper installation.

2 ANTI-TIPPING DEVICE

Ensures stability and safety

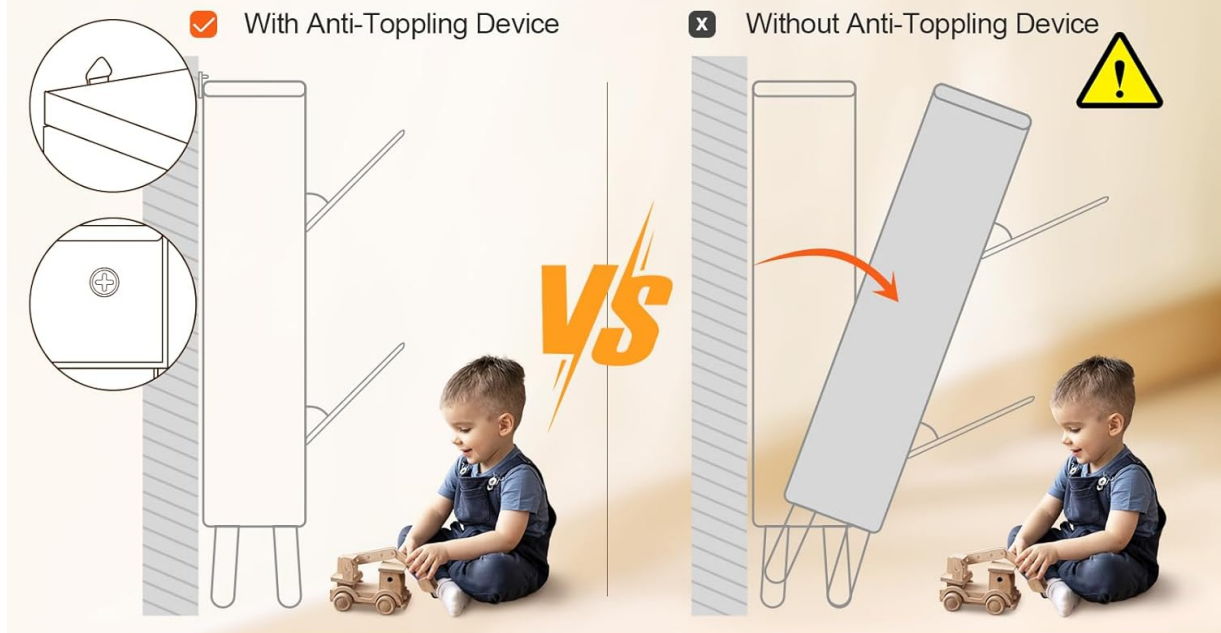

Image: Illustration of the anti-tipping device installation, showing how to secure the cabinet to a wall for stability and safety.

PRODUCT DIMENSIONS



Image: Detailed product dimensions, including overall height, width, depth, and individual drawer measurements, useful for planning placement and assembly.

OPERATION

The VEVOR Rattan Shoe Cabinet is designed for efficient and discreet shoe storage, featuring flip-open drawers and a top sliding drawer.

Using the Flip-Open Drawers:

- Gently pull the handle on the front of each rattan panel to open the drawer. The drawer will tilt forward, revealing the shoe compartments.
- Place shoes into the designated slots. The innovative design allows for various shoe types, including sports shoes, flats, high heels, and ankle boots.
- To close, push the drawer back into the cabinet until it is flush with the cabinet front.

Adjustable and Removable Panels:

Each flip-open drawer contains internal panels that can be adjusted or removed to accommodate different shoe sizes and styles. This feature maximizes storage flexibility.

- To adjust a panel, gently lift it from its current position and reinsert it into a different slot.
- To remove a panel, lift it completely out of the drawer. This creates a larger single compartment for taller items or multiple smaller shoes.

Top Sliding Drawer:

The cabinet features a small sliding drawer at the top, ideal for storing miscellaneous items such as keys, wallets, sunglasses, or small accessories, keeping your entryway tidy.

Additional Bottom Storage:

The space beneath the lowest flip-open drawer and above the metal support legs can be utilized for additional storage of items that do not fit inside the drawers or for quick access.



Image: The shoe cabinet with its two main flip-open drawers open, showcasing how shoes are stored neatly inside.

COMBINATION OF FLIP-OPEN DRAWERS

Effortlessly store more shoes



Small Drawer for Miscellaneous Storage



Bottom Additional
Storage Space



Double-Lid Drawer
for Shoe Storage



Image: A close-up illustrating the functionality of the flip-open drawers, the small top sliding drawer for miscellaneous items, and the additional storage space at the bottom.

REMOVABLE & ADJUSTABLE PANELS

Fit Different Shoe Types



Image: Visual representation of how the internal panels can be adjusted or removed to fit different shoe types and sizes, enhancing storage versatility.

MAINTENANCE

Proper care and maintenance will ensure the longevity and appearance of your VEVOR Rattan Shoe Cabinet.

- **Cleaning:** Wipe surfaces with a soft, damp cloth. Avoid abrasive cleaners or harsh chemicals that could damage the finish or rattan material. For the rattan, a soft brush can be used to remove dust from crevices.
- **Spills:** Immediately wipe up any spills to prevent staining or water damage, especially on the rattan and wood surfaces.
- **Dusting:** Regularly dust the cabinet with a dry, soft cloth to prevent buildup.
- **Inspection:** Periodically check all screws and connections to ensure they remain tight. Re-tighten if necessary, but do not over-tighten.
- **Environment:** Keep the cabinet away from direct heat sources, prolonged direct sunlight, and excessive moisture to prevent warping, fading, or damage to the rattan.

TROUBLESHOOTING

If you encounter any issues with your VEVOR Rattan Shoe Cabinet, refer to the following common solutions:

- **Drawers not closing smoothly:**
 - a. Check for any obstructions inside the drawer or along the runners.
 - b. Ensure all assembly screws for the drawer mechanism are properly tightened.
 - c. Verify that the cabinet is placed on a level surface. Uneven surfaces can cause misalignment.
- **Cabinet feels unstable:**
 - a. Confirm that the anti-tipping device is securely installed to a wall stud.
 - b. Check all assembly screws throughout the cabinet frame and legs for tightness.
 - c. Ensure the cabinet is on a flat, stable floor. Use furniture levelers if your floor is uneven.
- **Rattan appears damaged or loose:**
 - a. Rattan is a natural material; minor variations are normal. If significant damage occurs, contact customer support.
- **Missing parts during assembly:**
 - a. Double-check all packaging materials. If parts are genuinely missing, contact VEVOR customer support with your product model and purchase information.

SPECIFICATIONS

Feature	Detail
Brand	VEVOR
Model Number	HZS006
Color	Black
Product Dimensions (L x W x H)	64.69 x 26.29 x 102.79 cm (25.47 x 10.35 x 40.47 inches)
Item Weight	20 kg (44 lbs)
Top Weight Capacity	27.2 kg (60 lbs)
Drawer Weight Capacity (each)	9.1 kg (20 lbs)
Material	Wood, Rattan, Metal
Style	2-tier flip-open drawers with 1 sliding top drawer
Mounting Type	Floor Mount (with anti-tipping wall attachment)

VEVOR

Model:	HZS006	
Product Weight:	19.95 kg / 43.98 lbs	
Weight Capacity:	Top: 60 lbs / 27.2 kg, Drawers: 20 lbs / 9.1 kg each (4 x Drawers)	
Product Dimensions:	64.7 x 26.3 x 102.8 cm / 25.47 x 10.35 x 40.47 inches	
Tabletop Dimensions:	60 x 23.7 cm / 23.62 x 9.33 inches	
Side Panel Dimensions:	89.5 x 23.7 cm / 35.24 x 9.33 inches	
Shelf Dimensions:	56.1 x 14 cm / 22.09 x 5.51 inches	
Support Leg Dimensions:	1.9 x 23.5 cm / 0.75 x 9.25 inches	
Panel Height:	36.3 cm / 14.29 inches	
Drawer Height:	10 cm / 3.94 inches	
Internal Shelf Width:	9 cm / 3.54 inches	External Shelf Width: 11 cm / 4.33 inches

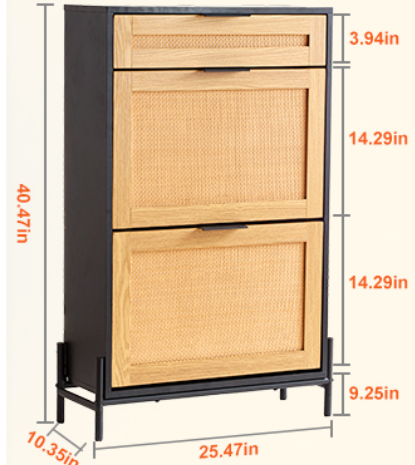

We continue to be committed to provide you with cost-effective tools.
"Save Half" or any other similar expressions used by us only represents an estimate of savings you might benefit from buying certain tools with us compared to the major top brands and does not necessarily mean to cover all categories of tools offered by us. You are kindly reminded to verify carefully when you are placing an order with us if you are actually saving half in comparison with the top major brands.

Image: A visual summary of the product's key specifications, including model number, weight, and detailed dimensions for various parts of the cabinet.

WARRANTY INFORMATION

VEVOR products are manufactured to high-quality standards. For specific warranty details, including coverage period and terms, please refer to the warranty card included with your product or visit the official VEVOR website. Please retain your proof of purchase for any warranty claims.

CUSTOMER SUPPORT

If you have any questions, require assistance with assembly, or need to report a missing/damaged part, please contact VEVOR customer support. Have your product model number (HZS006) and purchase details ready when contacting support for faster service.

You can typically find contact information on the VEVOR official website or on the packaging materials included with your product.