



[Manuals.plus](#) /

> [Inefala](#) /

> Inefala Car Stereo User Manual for Hyundai Tucson IX35 (2010-2015) Model 4-Core 2+64G

## Inefala 4-Core 2+64G

# Inefala Car Stereo User Manual for Hyundai Tucson IX35 (2010-2015)

Model: 4-Core 2+64G

## INTRODUCTION

---

This manual provides comprehensive instructions for the installation, operation, and maintenance of your Inefala Car Stereo system, designed specifically for Hyundai Tucson IX35 models from 2010 to 2015. Please read this manual thoroughly before installation and use to ensure proper functionality and safety.



Image: Inefala Car Stereo main unit, showing the 10-inch display, included backup camera, and external microphone.

## SETUP AND INSTALLATION

---

Before beginning installation, ensure your vehicle's ignition is off and the battery is disconnected to prevent electrical damage.

### Package Contents

Verify that all components are present in your package:

- 1 x Android Car Stereo Unit
- 1 x Power Cable
- 1 x GPS Antenna
- 1 x Backup Camera Input Cable
- 1 x RCA Cable
- 2 x USB Cables

- 2 x Mounting Brackets
- 1 x Installation Tool
- 1 x Instruction Manual (this document)
- 1 x External Microphone
- 1 x Backup Camera

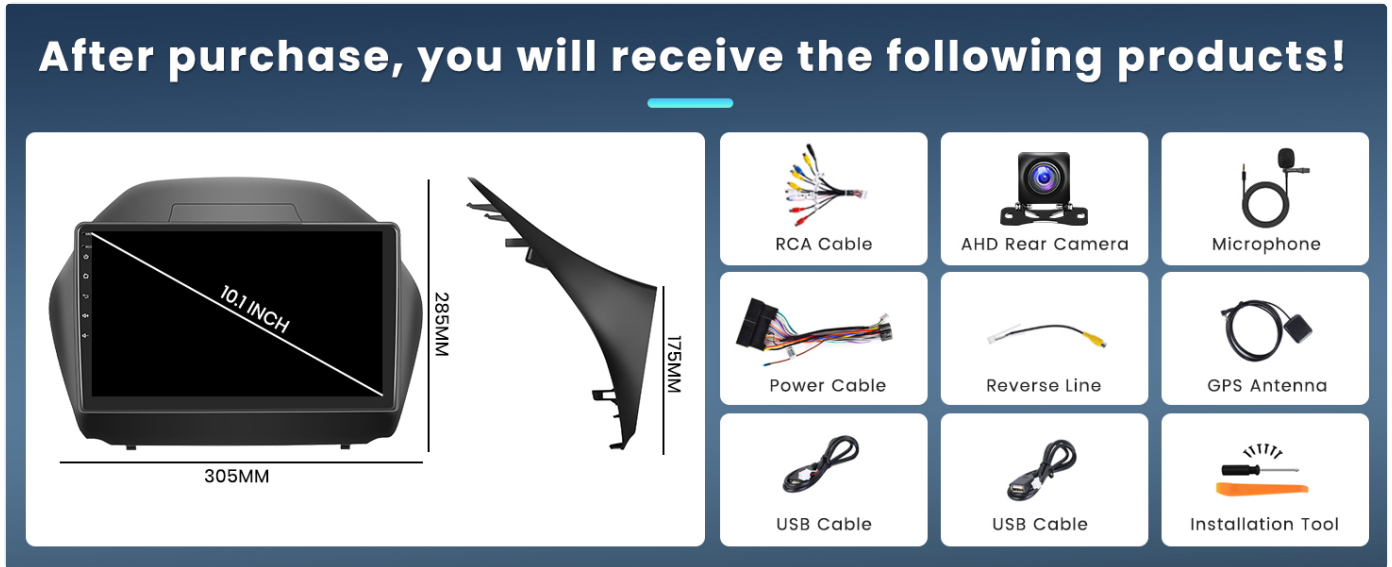

Image: Visual representation of all items included in the product package, such as the stereo unit, cables, camera, and tools.

### Physical Installation

1. Remove the original car stereo unit from your Hyundai Tucson IX35 (2010-2015).
2. Connect the provided power cable harness to the vehicle's wiring and the new stereo unit.
3. Attach the GPS antenna to the designated port on the stereo and position it for optimal signal reception (e.g., on the dashboard).
4. Secure the new Inefala Car Stereo unit into the dashboard using the mounting brackets.
5. Reconnect the vehicle's battery.

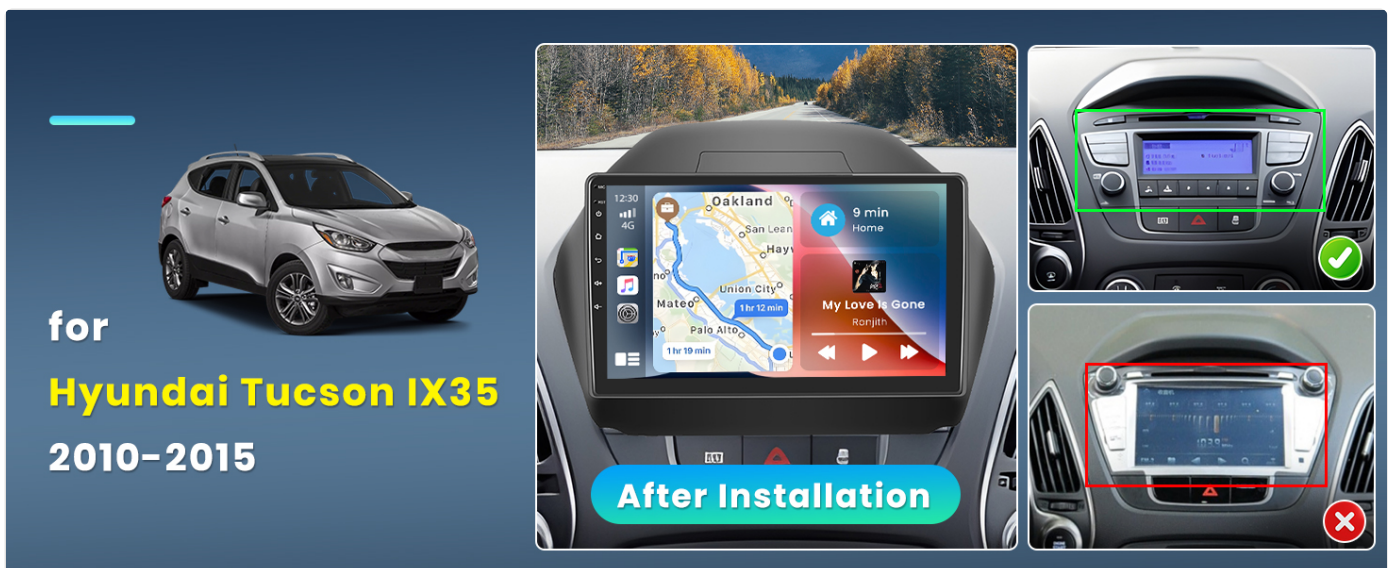

Image: A visual comparison demonstrating the dashboard of a Hyundai Tucson IX35 before and after the Inefala Car Stereo installation, highlighting proper fitment.

### Backup Camera Installation

Follow these steps to connect the backup camera:

1. Connect the red wire of the camera's power cable to the positive pole of the car's reversing light.
2. Connect the black wire of the camera's power cable to the negative pole of the car's reversing light.
3. Connect the video signal cable from the camera to the "CAM IN" port on the car stereo.
4. The white plug (reversing trigger) must be connected to the main device to ensure proper Bluetooth and Wi-Fi signal functionality.

## Reversing Camera Installation

Tip: The reversing input must be plugged in even when the reversing cam Reversing Camera Wiring.

1. Connect to the positive pole of the power supply of the car's reversing light.
2. Connect to the negative pole of the power supply of the car's reversing light.
- 3.4. The reversing trigger is controlled by stereo. so 3 4 does not require to connect! The white plug must be connected to the main device, or you can't get bluetooth and wifi signals

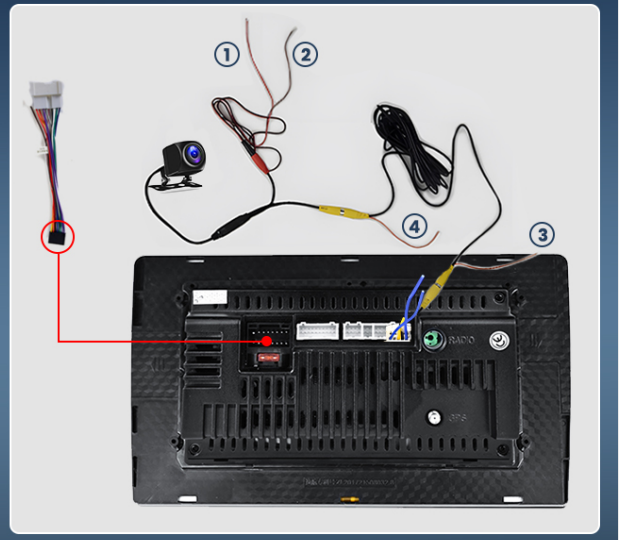

Image: Detailed wiring diagram illustrating the correct connections for the backup camera to the car stereo and vehicle's reversing lights.

## Steering Wheel Control (SWC) Configuration

After connecting the Canbus, it is essential to configure the Steering Wheel Controls:

- Go to **Settings > Factory Setup**.
- Enter the password **1234**.
- Select **Hiworld** + your car's year and model.
- Proceed to **"Steering Learning"** under Factory Setting to finalize the steering wheel button learning process.

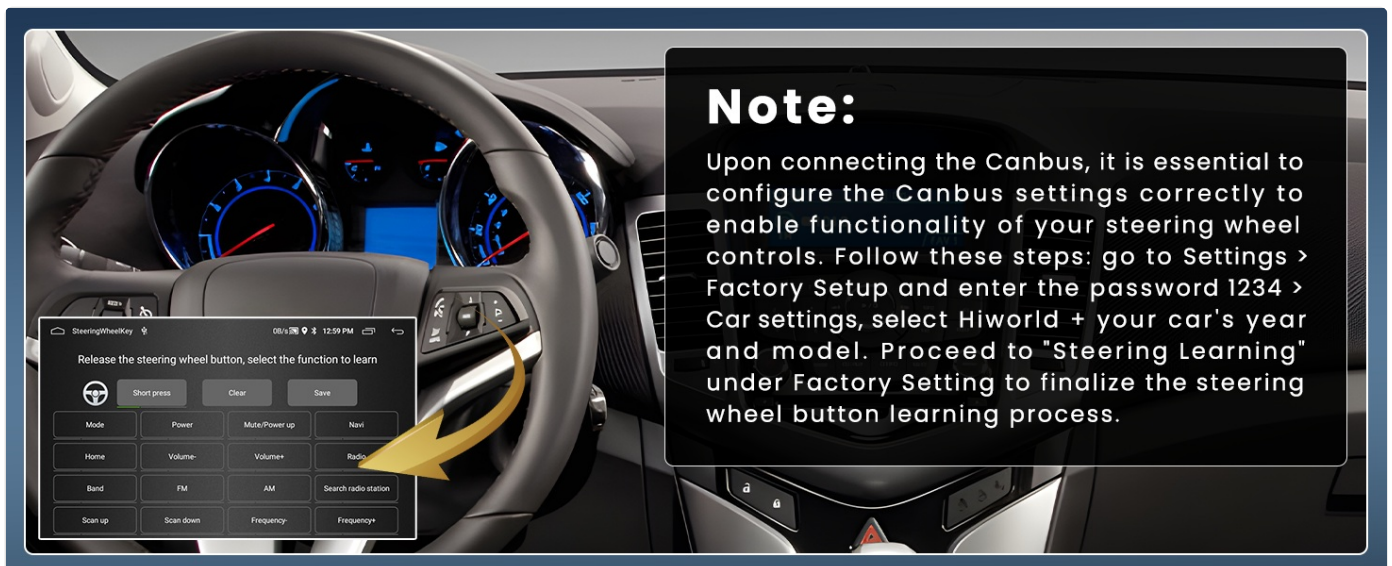

Image: Screenshot showing the user interface for configuring steering wheel controls, with options to learn and save button functions.

## OPERATING INSTRUCTIONS

### Wireless/Wired CarPlay & Android Auto

The stereo supports both wireless and wired CarPlay and Android Auto, allowing seamless integration with your smartphone for navigation, calls, and music.

- Connect your iPhone via USB or wirelessly for CarPlay.
- Connect your Android phone via USB or wirelessly for Android Auto.
- Access phone features directly from the stereo's display.



Image: The car stereo display showing the CarPlay interface with various app icons, demonstrating smartphone integration.

## Mirror Link

Mirror Link functionality allows you to display your smartphone's screen directly onto the car stereo. This is useful for viewing maps, videos, or other applications.

- Connect your smartphone via USB or Wi-Fi.
- Activate Mirror Link on both your phone and the stereo.



Image: Illustration of the Mirror Link feature, showing a smartphone screen duplicated on the car stereo display.

## GPS Navigation

The unit features built-in GPS with support for offline maps and online navigation applications like Google Maps and Waze.

- Ensure the GPS antenna is properly installed.

- Download offline maps for areas with weak signal, or use online maps with a Wi-Fi connection.

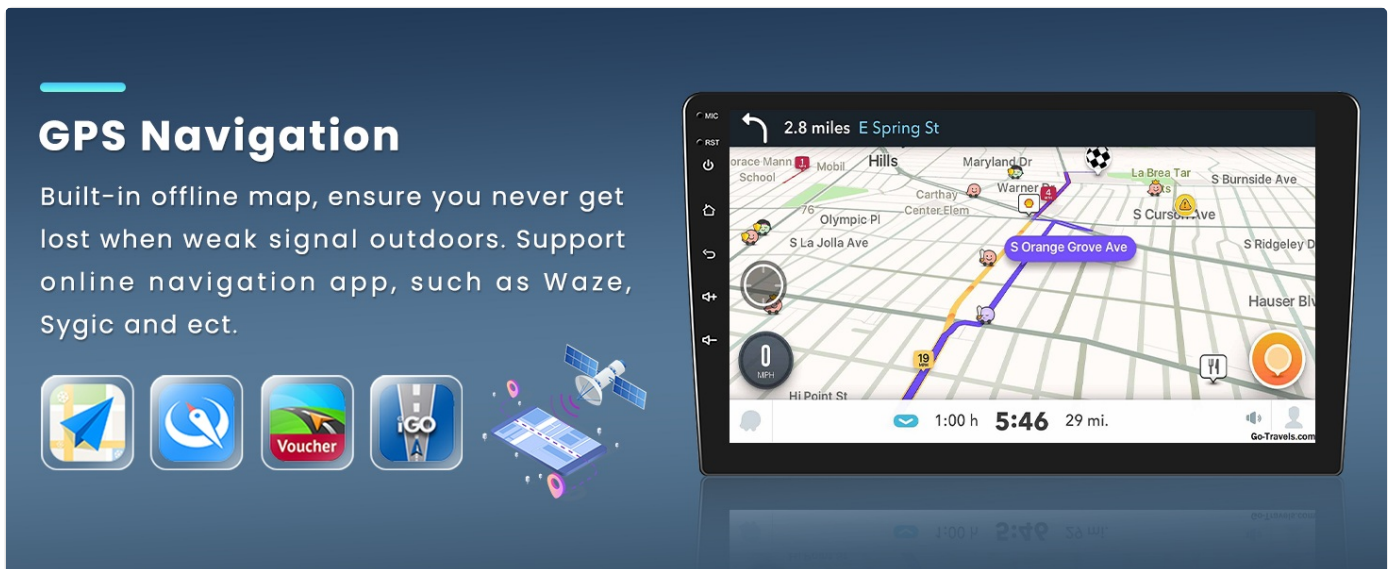

Image: The car stereo display showing a detailed GPS navigation map with route information and estimated arrival time.

## Wi-Fi Connection

Connect the car stereo to a Wi-Fi network or a mobile hotspot to access online content and services.

- Go to **Settings > Network & Internet > Wi-Fi**.
- Select your desired network and enter the password.



Image: The car stereo display showing various online applications like YouTube, Instagram, and Facebook, indicating successful Wi-Fi connectivity.

## Bluetooth Functionality

Pair your smartphone via Bluetooth for hands-free calling and audio streaming.

- Enable Bluetooth on your phone and the car stereo.
- Search for available devices on the stereo and select your phone.
- Confirm the pairing code.

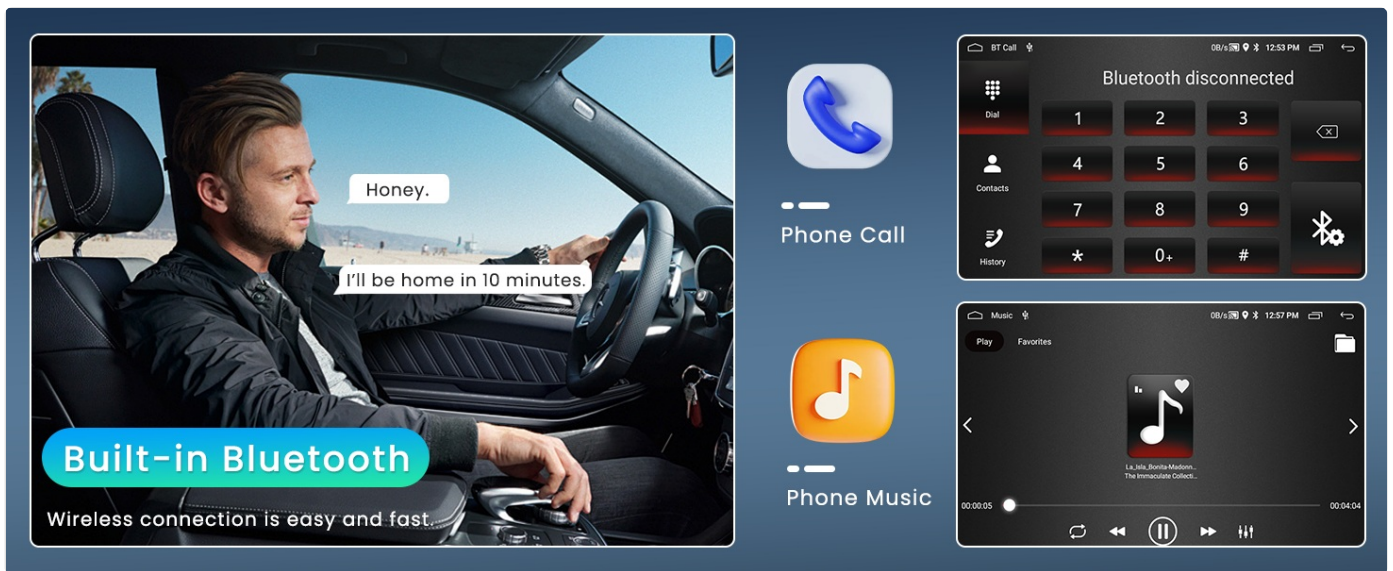

Image: The car stereo display showing the Bluetooth interface for making phone calls and playing music, with a visual of a driver using hands-free calling.

## FM/RDS Radio

Tune into your favorite radio stations with FM/RDS support.

- Select the Radio application from the main menu.
- Use the scan function to find stations or manually tune to a frequency.
- Save preferred stations as presets.



Image: The car stereo display showing the FM/RDS radio interface with frequency display, station presets, and sound effect settings.

## Split Screen Display

The split-screen feature allows you to run two applications simultaneously, such as navigation and music playback.

- Long-press an app icon and drag it to one side of the screen to activate split-screen mode.
- Select another app to fill the remaining screen space.

## Split Screen Display

Screens are displayed at the same time, not only for entertainment, phone calls, Bluetooth... bus also for navigation and music.

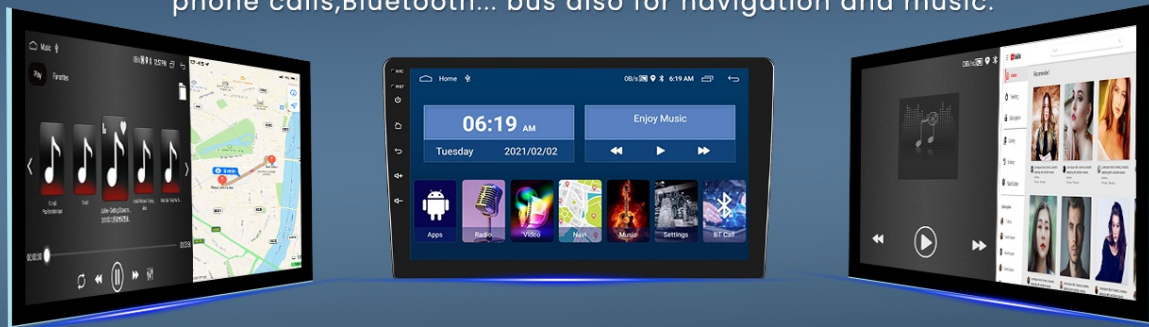

Image: The car stereo display showing two applications running side-by-side in split-screen mode, such as navigation and a music player.

## Video Playback

The unit supports video playback. An RCA cable can be used to connect external headrest monitors for rear-seat entertainment.

## Video

Use an RCA cable to connect the headrest, allowing your child to watch their favorite cartoons during travel, keeping them entertained and giving parents peace of mind.

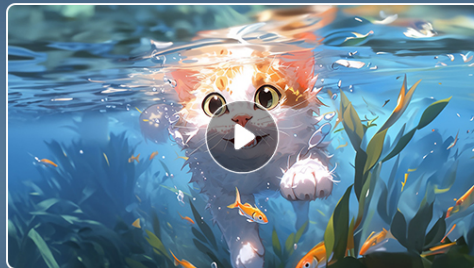

Image: The car stereo displaying video content, with an illustration of how external headrest monitors can be connected via RCA for rear passenger viewing.

## SPECIFICATIONS

Feature	Detail
Model	4-Core 2+64G
Operating System	Android
RAM	2GB
ROM	64GB
CPU	Octa 4-core

Screen Size	10.1 Inches
Display Resolution	1024x600 (supports 1080P video playback)
Connectivity	Bluetooth, USB, Wi-Fi
Special Features	Wireless/Wired CarPlay, Android Auto, Mirror Link, GPS Navigation, FM/RDS Radio, SWC, Backup Camera Support
Product Dimensions	12.01 x 5.12 x 11.22 inches
Item Weight	4.89 pounds

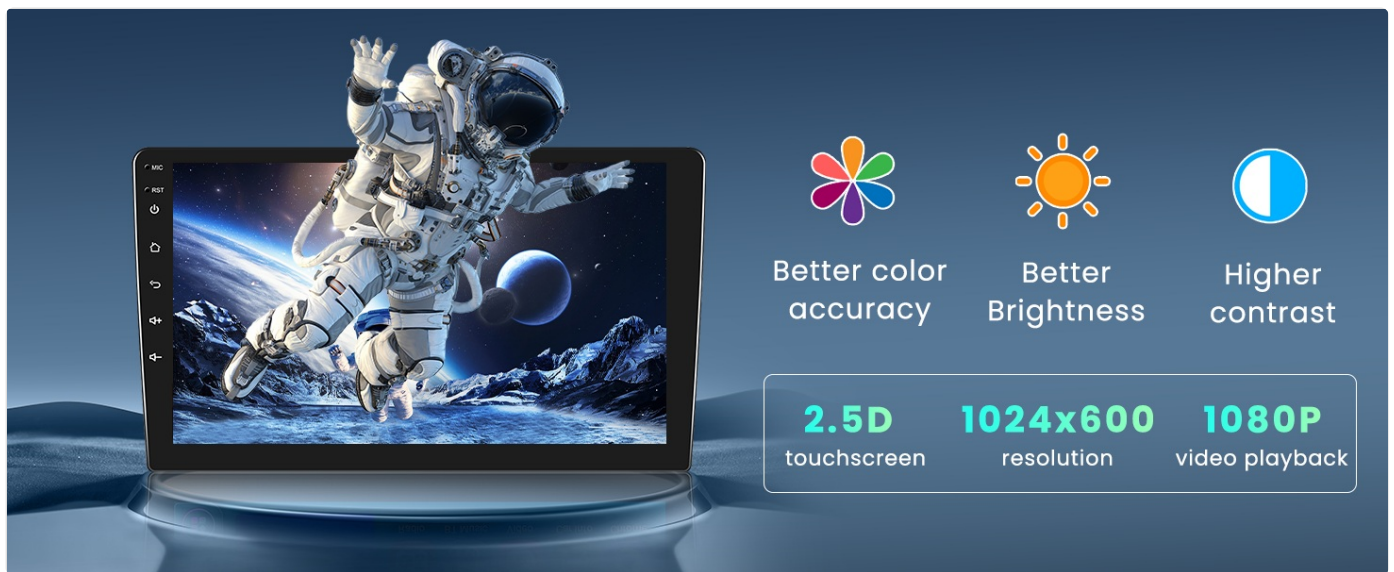

Image: Visual representation of the display's key features: 2.5D touchscreen, 1024x600 resolution, 1080P video playback, better color accuracy, brightness, and higher contrast.

## TROUBLESHOOTING

If you encounter issues with your Inefala Car Stereo, refer to the following common problems and solutions:

- **No Power:** Check all power connections and ensure the vehicle's battery is properly reconnected. Verify fuses.
- **No Sound:** Check speaker wiring connections. Ensure volume is not muted or set to zero. Verify audio output settings.
- **GPS Signal Loss:** Ensure the GPS antenna is securely connected and positioned with a clear view of the sky.
- **Bluetooth Connection Issues:** Ensure Bluetooth is enabled on both the stereo and your phone. Delete previous pairings and attempt to re-pair. Ensure the white trigger wire for the backup camera is connected to the main device for proper signal.
- **Steering Wheel Controls Not Working:** Re-perform the SWC learning process as described in the Setup section. Ensure Canbus connection is correct.
- **Backup Camera Not Displaying:** Verify the camera's power and video connections. Ensure the reversing trigger wire is correctly connected.
- **Touchscreen Unresponsive:** Try restarting the unit. If the issue persists, contact customer support.

## MAINTENANCE

To ensure the longevity and optimal performance of your car stereo:

- **Cleaning:** Use a soft, dry cloth to clean the screen and unit. Avoid abrasive cleaners or solvents.
- **Software Updates:** Periodically check for available software updates to improve performance and add new features.
- **Environmental Conditions:** Avoid exposing the unit to extreme temperatures or direct sunlight for extended periods.

## WARRANTY AND SUPPORT

Inefala provides comprehensive support for your product:

- **Quality Assurance:** 24 Months Quality Assurance.
- **Returns:** 30-day Money-Back guarantee.
- **After-Sales Support:** 2-years after sales support.
- **Online Reply:** Online reply within 24 hours.
- **Fitment Guarantee:** If the harness you receive does not fit, please contact us immediately, and we will replace it with a suitable harness.

## Contact Support

For any questions or technical assistance, please contact Inefala-US directly:

Email: [inefalatech@163.com](mailto:inefalatech@163.com)

**How to swiftly enable us to assist you?**

**Step 1**

Add to Cart

Buy Now

Ships from Amazon

Sold by **Inefala-US**

Returns

Payment

See more

**Step 2**

**About Seller**

- Welcome to Inefala-US store!
- We sell electronic products related to vehicles, such as car radios, portable displays, backup camera kits, dash cams, and more.
- We are responsible for handling all quality issues within 24 months from the date of purchase.
- Please be reminded to use the product according to the instructions provided. If you have any other questions, we would be happy to assist you! Don't hesitate to contact us directly at [inefalatech@163.com](mailto:inefalatech@163.com).
- We guarantee that 100% of your concerns can be resolved by contacting us.

See less

Have a question for Inefala-US? **Ask a question**

Image: A graphic detailing how to contact Inefala-US support, including an email address for inquiries.