

Translator Earbuds

T26 Pro Language Translator Earbuds User Manual

Model: Translator Earbuds | Brand: Generic

1. INTRODUCTION

The T26 Pro Language Translator Earbuds are designed to facilitate seamless real-time communication across language barriers. Utilizing advanced technology, these earbuds support over 144 languages with high accuracy, making them suitable for various scenarios from daily use to international travel. This manual provides detailed instructions for setting up, operating, maintaining, and troubleshooting your T26 Pro earbuds to ensure optimal performance.



Figure 1.1: T26 Pro Language Translator Earbuds and charging case.

2. PACKAGE CONTENTS AND SETUP

2.1 What's in the Box

- 1 x T26 Pro Bluetooth Headset
- 1 x USB Charging Cable
- 1 x Lanyard
- 1 x Instruction Manual (this document)



Figure 2.1: Included components in the product package.

2.2 Initial Setup

- 1. Charge the Earbuds:** Before first use, fully charge the earbuds using the provided USB Type-C charging cable. Connect the cable to the earbuds' charging port and a compatible USB power source. The charging indicator light will provide status.
- 2. Download the Companion App:** The T26 Pro earbuds require a dedicated mobile application for translation functionality. Scan the QR code provided in the physical instruction manual or search for the official app on your device's app store. Install the app on your smartphone.
- 3. Pair with Your Device:**
 - Ensure Bluetooth is enabled on your smartphone.
 - Open the T26 Pro companion app.
 - Follow the on-screen instructions within the app to pair your earbuds. This typically involves putting the earbuds into pairing mode (refer to the physical manual for specific button presses if needed) and selecting them from the Bluetooth device list in the app.
- 4. App Membership Activation:** The product includes one year of translation function use and six months of APP membership. Follow the app's instructions to activate these features upon initial setup.

3. OPERATING INSTRUCTIONS

The T26 Pro earbuds offer versatile translation modes and functions through their dedicated mobile application.

3.1 Translation Modes

The earbuds support multiple translation modes to suit different communication needs. Access and select these modes within the companion app.

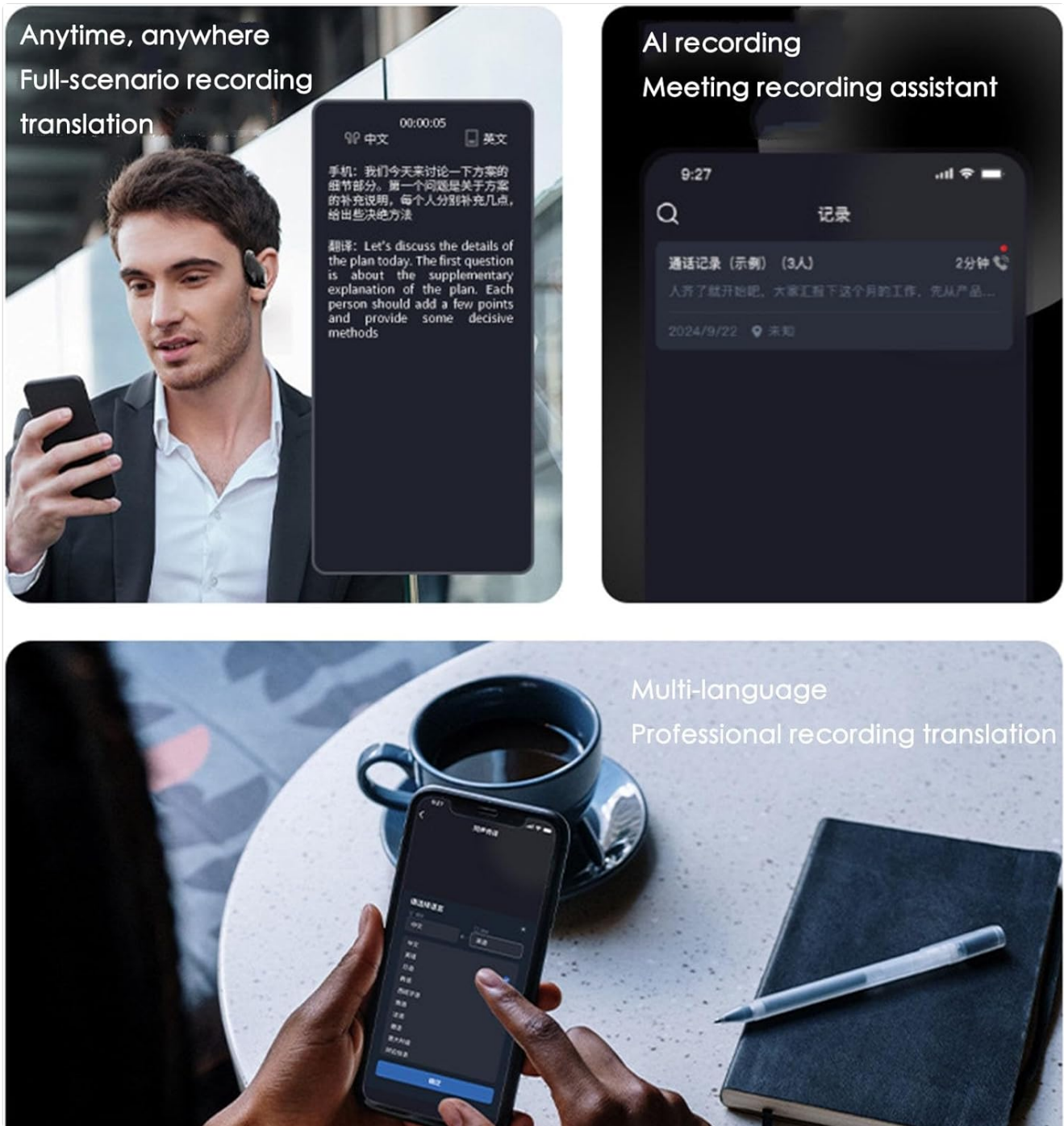

Figure 3.1: Real-time translation interface within the app.

- **Real-time Translation:** Speak into the earbuds, and the app will translate and output the speech in the selected target language. This is ideal for direct conversations.
- **Recording Translation:** Use the app to record audio, and it will provide a translated transcript. Useful for lectures, meetings, or capturing spoken information for later review.
- **Chat/AI Function:** Engage with an AI assistant or use chat features for text-based translation and interaction.



Figure 3.2: Recording translation feature in the app.



Figure 3.3: AI chat feature for interactive translation.

3.2 Audio Features

Beyond translation, the T26 Pro earbuds deliver high-quality audio for music and calls.

- **Crystal-Clear Vocals & Deep Bass:** Enjoy an immersive audio experience with enhanced sound quality.
- **Advanced Noise Reduction:** Minimizes background noise for clearer communication and listening.
- **360° Audio Quality:** Built-in 16mm speakers provide rich, enveloping sound.



Figure 3.4: Earbud highlighting audio capabilities.

4. MAINTENANCE AND CARE

Proper maintenance ensures the longevity and optimal performance of your T26 Pro earbuds.

- **Cleaning:** Regularly wipe the earbuds with a soft, dry, lint-free cloth. Do not use abrasive cleaners or solvents.
- **Storage:** Store the earbuds in their charging case when not in use to protect them from dust and damage.
- **Battery Care:** To preserve battery life, avoid fully discharging the earbuds frequently. Charge them regularly, even if not in constant use.
- **Water Resistance:** The earbuds have an IPX5 rating, meaning they are resistant to low-pressure water jets. Do not submerge them in water.

5. TROUBLESHOOTING

If you encounter issues with your T26 Pro earbuds, refer to the following common solutions:

Problem	Possible Cause	Solution
---------	----------------	----------

Problem	Possible Cause	Solution
Earbuds not pairing	Bluetooth off, earbuds not in pairing mode, low battery.	Ensure Bluetooth is on. Put earbuds in pairing mode. Charge earbuds. Restart phone and app.
Translation not working	No internet connection, app not running, incorrect language selection, microphone blocked.	Check internet connection. Ensure app is open and active. Verify language settings. Ensure microphone is clear.
Poor audio quality	Earbuds not seated correctly, low battery, interference.	Adjust earbud position. Charge earbuds. Move away from sources of interference.
App not responding	App crash, outdated app version.	Close and reopen the app. Check for app updates in your app store. Restart your phone.

6. SPECIFICATIONS

Feature	Detail
Model	Translator Earbuds (T26 Pro)
Bluetooth Version	Bluetooth 5.4
Speaker Specification	16mm
MIC Signal-to-Noise Ratio	58dB
Interface Type	Type-C
Water Resistance Rating	IPX5
Product Size (headphones)	51*41*18mm
Listening Time	Up to 3 hours
Standby Time	Up to 480 hours
Communication Range	10m
Item Weight	5.4 ounces

7. WARRANTY AND SUPPORT

The T26 Pro Language Translator Earbuds come with a limited warranty and support for its features.

- **Translation Function:** One year of use for the translation function is included with your purchase.
- **APP Membership:** Six months of APP membership is included, providing access to additional features.
- **Technical Support:** For further assistance or issues not covered in this manual, please refer to the contact information provided in the physical instruction manual or within the companion app.

