



[Manuals.plus](#) /

> [Seesii](#) /

> Seesii SH300 6-in-1 Cordless Pole Saw and Hedge Trimmer Combo Kit User Manual

Seesii SH300

Seesii SH300 6-in-1 Cordless Pole Saw and Hedge Trimmer Combo Kit User Manual

Model: SH300

1. INTRODUCTION

The Seesii SH300 6-in-1 Cordless Pole Saw and Hedge Trimmer Combo Kit is a versatile battery-powered tool designed for various gardening and yard maintenance tasks. This kit allows you to effortlessly switch between a mini chainsaw, hedge trimmer, and grass shear, with the added functionality of an extendable pole for increased reach. This manual provides essential information for safe operation, assembly, maintenance, and troubleshooting to ensure optimal performance and longevity of your tool.

2. SAFETY INFORMATION

Always prioritize safety when operating power tools. Failure to follow safety instructions can result in serious injury or property damage.

General Safety Warnings:

- **Read all instructions:** Familiarize yourself with the controls and proper use of the tool.
- **Wear appropriate personal protective equipment (PPE):** This includes safety goggles, gloves, sturdy footwear, and hearing protection.
- **Keep work area clear:** Ensure the area is free from bystanders, children, and pets. Remove any obstacles that could interfere with operation.
- **Avoid dangerous environments:** Do not use the tool in wet or damp conditions, or in the presence of flammable liquids or gases.
- **Secure footing:** Always maintain proper balance and footing, especially when using the extension pole.
- **Inspect before use:** Check for damaged parts, loose connections, or any other condition that may affect safe operation.
- **Disconnect power:** Always remove the battery pack before making adjustments, changing accessories, or storing the tool.

Battery Safety:

- Use only the specified charger for the battery pack.
- Do not expose batteries to water, heat, or direct sunlight.
- Store batteries in a cool, dry place away from metal objects.
- Do not short-circuit the battery terminals.
- Dispose of batteries properly according to local regulations.

3. PACKAGE CONTENTS

Verify that all items are present in your package:

- Extendable Pole x1
- 6" Mini Chainsaw Head x1
- Hedge Trimmer Head x1
- 4000mAh Battery x2
- 12" Long Shrub Blade x1 (pre-installed on hedge trimmer head)
- 5" Wide Grass Shear Head x1
- Chains x2 (One pre-installed on the saw)
- Fast Charger x1
- Oil Bottle x1
- Anti-Slip Gloves x1
- Goggle x1
- User Manual x1

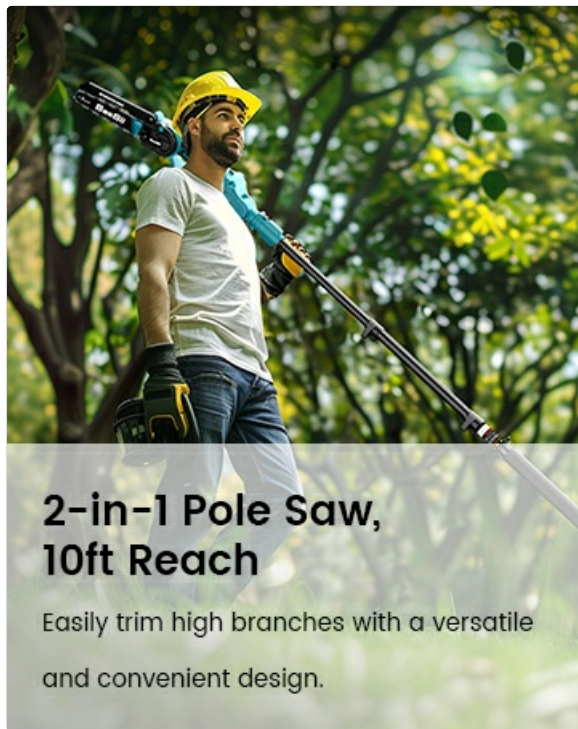

Image: All components included in the Seesii 6-in-1 Combo Kit.

4. SETUP

4.1 Charging the Battery

Insert the battery into the provided fast charger. The indicator light on the charger will show the charging status. Ensure batteries are fully charged before first use for optimal performance.



2-in-1 Pole Saw, 10ft Reach

Easily trim high branches with a versatile and convenient design.

Image: Two 4000mAh batteries with charge indicators.

4.2 Assembling the Chainsaw Head

1. **Install the Mini Saw:** Align the mini chainsaw head with the main unit or extension pole and slide it into place.
2. **Secure the Safety Latch:** Engage the safety latch to firmly secure the chainsaw head.
3. **Install the Battery:** Insert a charged 4000mAh battery into the battery slot until it clicks.
4. **Lubricate the Chain:** Before first use and periodically during operation, fill the oil bottle with appropriate chain lubricant and ensure the automatic lubrication system is functioning.



Image: Step-by-step assembly of the mini chainsaw.

4.3 Assembling the Hedge Trimmer Head

1. **Press Release Button:** Locate and press the release button on the main unit or extension pole.
2. **Attach the Hedge Blade:** Align the hedge trimmer head and slide it onto the main unit or extension pole until it locks into place.
3. **Insert to the Pole (if applicable):** If using the extension pole, connect the main unit with the hedge trimmer head to the pole.
4. **Install the Battery:** Insert a charged 4000mAh battery into the battery slot until it clicks.

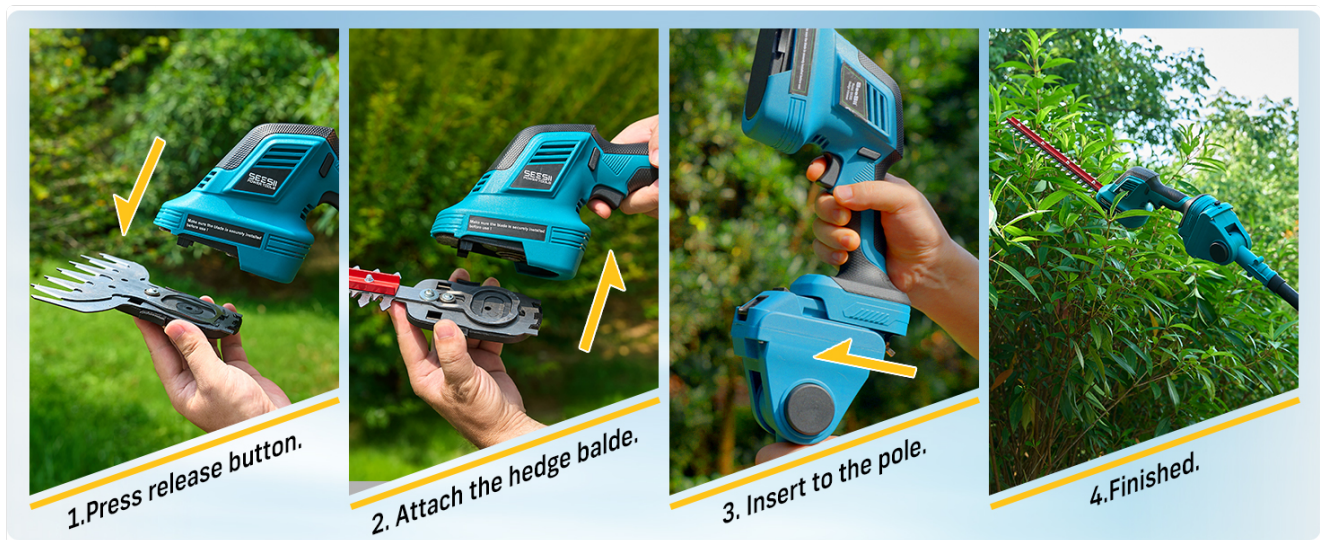

Image: Step-by-step assembly of the hedge trimmer.

4.4 Assembling the Grass Shear Head

Follow a similar procedure as the hedge trimmer to attach the grass shear head to the main unit or extension pole.

4.5 Attaching and Adjusting the Extension Pole

The extendable pole adjusts from 6 to 9 feet, allowing for a maximum reach of 16 feet. To adjust, loosen the locking mechanism, extend the pole to the desired length, and securely tighten the mechanism.



Image: Multi-angle adjustable extension pole in use.

5. OPERATING INSTRUCTIONS

5.1 General Operation

Once the desired attachment is secured and the battery is installed, press the safety lock button and then the trigger to start the tool. Release the trigger to stop. Always ensure the safety lock is engaged when not actively cutting.



**And then we
went deeper**

Image: The 6-in-1 tool demonstrating its versatility as a pole hedge trimmer, pole saw, and pole grass shear.

5.2 Using the Mini Chainsaw

The mini chainsaw is designed for cutting branches and small logs. It features an automatic lubrication system to keep the chain oiled during operation, reducing wear and improving cutting efficiency. The chainsaw offers a chain speed of 26.2 ft/s and can cut a 6-inch branch in approximately 8 seconds.

- Ensure the oil reservoir is filled with chain lubricant before use.
- Hold the chainsaw firmly with both hands.
- Start the saw before contacting the material to be cut.
- Allow the saw to do the work; do not force it through the cut.
- Be aware of kickback and maintain a stable stance.



Image: Mini chainsaw in action, demonstrating automatic chain oiling.

5.3 Using the Hedge Trimmer

The hedge trimmer is equipped with a 12-inch dual-action blade, ideal for shaping hedges and shrubs. It can handle thick shrubbery with a cutting capability of up to 3/4 inch.

- Use a sweeping motion to trim hedges evenly.
- Avoid cutting branches thicker than the recommended capacity.
- Keep the blades clean for efficient cutting.



Image: Grass shear and hedge trimmer blade specifications.

5.4 Using the Grass Shear

The grass shear attachment is suitable for trimming grass in tight spaces or along edges. It features a 5-inch wide cutting path.

- Use for light trimming of grass and small weeds.
- Do not attempt to cut thick branches or heavy brush.



Image: Versatile trimming modes of the Seesii 6-in-1 tool.

6. MAINTENANCE

Regular maintenance ensures the longevity and safe operation of your Seesii tool.

6.1 Cleaning

- Always remove the battery before cleaning.
- Use a brush or compressed air to remove sawdust, grass clippings, and debris from the tool, especially around the

blades and motor vents.

- Wipe down external surfaces with a damp cloth. Do not use harsh chemicals or abrasive cleaners.

6.2 Chainsaw Chain Maintenance

- **Lubrication:** Regularly check and refill the chain oil reservoir. The automatic lubrication system requires sufficient oil to function correctly.
- **Tension:** Ensure the chain tension is correct. A properly tensioned chain should be snug but still allow you to pull it around the guide bar by hand.
- **Sharpening/Replacement:** A dull chain will reduce cutting efficiency and increase strain on the motor. Sharpen the chain as needed or replace it with a new one.

6.3 Hedge Trimmer and Grass Shear Blade Maintenance

- Keep blades sharp for optimal cutting performance.
- After each use, clean the blades and apply a light coat of machine oil to prevent rust.

6.4 Battery Care

- Store batteries in a cool, dry place.
- Do not store fully discharged batteries for extended periods. Charge them periodically if not in use.

7. TROUBLESHOOTING

If you encounter issues with your Seesii tool, refer to the following common problems and solutions:

Problem	Possible Cause	Solution
Tool does not start	Battery not charged or improperly installed; Safety lock not disengaged; Damaged switch.	Ensure battery is fully charged and correctly inserted. Press safety lock before trigger. Contact support if switch is faulty.
Chainsaw cuts slowly or binds	Dull chain; Incorrect chain tension; Insufficient lubrication; Overheating.	Sharpen or replace chain. Adjust chain tension. Refill chain oil reservoir. Allow tool to cool down.
Hedge trimmer/Grass shear blades jam	Debris caught in blades; Attempting to cut material too thick.	Remove battery, then carefully clear debris. Do not exceed recommended cutting capacity.
Battery life is short	Battery not fully charged; Old or damaged battery; Heavy usage.	Ensure battery is fully charged. Consider replacing old batteries. Reduce continuous heavy load.

8. SPECIFICATIONS

- **Brand:** Seesii
- **Model Number:** SH300
- **Power Source:** Battery Powered
- **Battery Type:** 21V, 4000mAh Lithium-ion (x2 included)
- **Chainsaw Bar Length:** 6 inches

- **Hedge Trimmer Blade Length:** 12 inches
- **Hedge Trimmer Cutting Capacity:** Up to 3/4 inch
- **Grass Shear Width:** 5 inches
- **Extension Pole Length:** Adjustable 6 to 9 feet (up to 16ft reach)
- **Chainsaw Motor:** Brushless
- **Hedge Trimmer Motor:** Brushed



Image: Key features and specifications of the Seesii 6-in-1 tool.

9. WARRANTY AND SUPPORT

Seesii products are designed for durability and performance. This product typically comes with a 3-year warranty, as indicated by customer feedback. For warranty claims, technical support, or any inquiries, please contact Seesii customer service.

Manufacturer Contact Information: support@seesiius.com