

Furnulem ET-109-CL-4D

Furnulem ET-109-CL-4D Tall LED Nightstand User Manual

Model: ET-109-CL-4D

Brand: Furnulem

1. INTRODUCTION

Thank you for choosing the Furnulem Tall LED Nightstand. This manual provides essential information for the safe assembly, operation, and maintenance of your new nightstand. Please read these instructions carefully before beginning assembly and retain them for future reference.

This nightstand features a unique design with a charging station, LED lighting, and ample storage. It is designed to enhance functionality and aesthetics in various settings such as bedrooms, dorms, and home offices.





Image 1.1: The Furnulem Tall LED Nightstand in a bedroom environment.

2. SAFETY INFORMATION

WARNING: Failure to follow these safety instructions may result in injury or damage to the product.

- Always assemble the product on a soft, clean surface to prevent scratches.
- Ensure all screws and fasteners are securely tightened before use. Periodically check and re-tighten as necessary.
- Do not exceed the weight limits: Top shelf: 50 lbs (22.7 kg), Open shelves: 20 lbs (9.1 kg) each, Fabric drawers: 10 lbs (4.5 kg) each.
- Use the provided anti-tip kit to secure the nightstand to a wall. This is crucial to prevent tipping and

potential injury, especially in households with children or pets.

- Keep electrical components (charging station) away from water or damp environments.
- Do not attempt to modify the electrical components or wiring.
- Ensure the power cord is not pinched or placed under heavy objects.

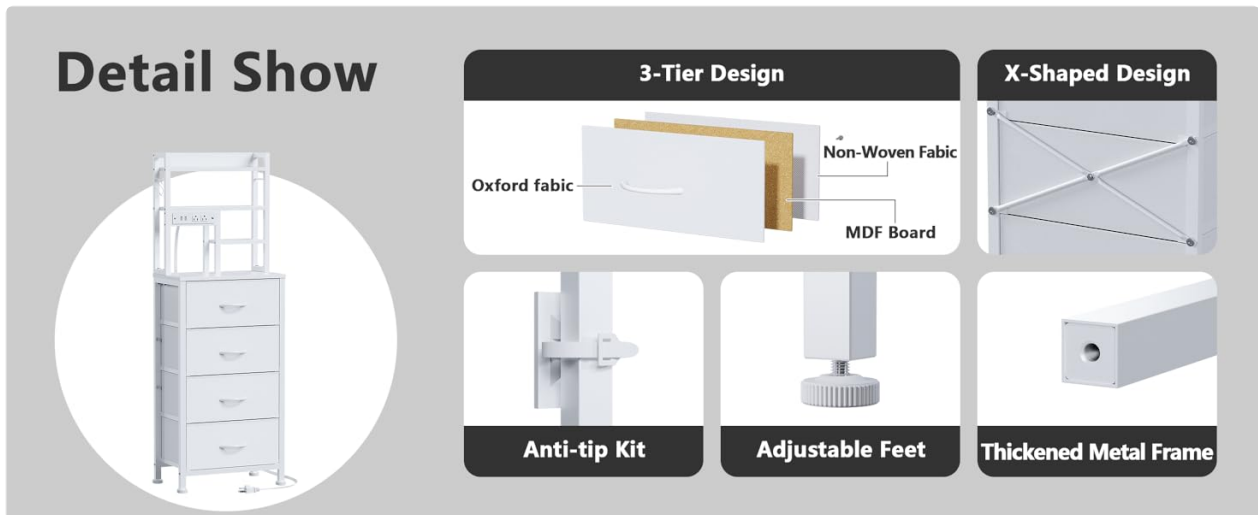

Image 2.1: Detail showing the anti-tip kit and structural components for stability.

3. SETUP AND ASSEMBLY

This section provides step-by-step instructions for assembling your Furnulem Tall LED Nightstand. All necessary parts and tools are included in the package.

3.1 Unpacking and Part Identification

Carefully unpack all components and lay them out on a clean, soft surface. Verify that all parts listed in the instruction manual are present. If any parts are missing or damaged, please contact customer support.

3.2 Assembly Steps

Follow the visual guide in the video below for a detailed assembly process. Ensure all connections are secure.

Your browser does not support the video tag.

Video 3.1: Step-by-step assembly guide for the Furnulem Tall Nightstand.

1. **Assemble the Base Frame:** Connect the bottom horizontal bars to the vertical side frames using the designated screws. Ensure the metal drawer stops are facing the correct direction as indicated in the visual instructions.
2. **Attach Lower Shelves:** Secure the lower wooden shelves to the frame.
3. **Install Upper Frame:** Attach the upper vertical frame components to the main structure.
4. **Add Upper Shelves:** Install the remaining wooden shelves in the upper section. Pay attention to the orientation of shelves that will hold the charging station.
5. **Integrate Charging Station:** Carefully place and secure the charging station unit into its designated slot on the shelf.
6. **Insert Fabric Drawers:** Unfold the fabric drawers and insert the bottom panels. Place them into the designated slots in the frame.
7. **Install Anti-Tip Kit:** Securely attach the anti-tip kit to the back of the nightstand and to a wall stud using appropriate hardware.



Image 3.2: Key structural features including the anti-tip kit, X-steel frame, and adjustable feet.

4. OPERATING INSTRUCTIONS

4.1 LED Lighting System

The integrated LED lighting system offers 7 adjustable colors and brightness levels. Control is available via a mobile application or a key switch.

- **Mobile App Control:** Download the specified mobile application (refer to packaging or included leaflet for QR code/name). Connect the LED lights via Bluetooth as per the app's instructions. This allows for color changes, brightness adjustments, schedule modes, music sync, and mic modes.
- **Key Switch Control:** Use the physical key switch to cycle through colors and adjust brightness.

LED Tall Nightstand-Multiple Colors Changing



Image 4.1: The LED lighting system showcasing various color options and control methods.

4.2 Charging Station

The nightstand is equipped with a charging station featuring 2 AC outlets (120V/12A) and 2 USB ports (5V/2A). The 6.5 ft power cord provides flexible placement.

- Plug the nightstand's power cord into a standard wall outlet.
- Connect your electronic devices to the AC outlets or USB ports for charging.
- The charging station can be positioned either facing forward or backward during assembly, depending on your preference.



120V/12A
2 AC Outlets



5V/2A
2 USB Ports



6.5-FT
Power Cord

Image 4.2: Detailed view of the integrated charging station with AC and USB ports.

4.3 Fabric Drawers and Storage Shelves

The nightstand includes 4 PVC fabric drawers and 4 open-tier storage shelves. These provide versatile storage for various items.

- Use the fabric drawers for soft items like clothing, accessories, or personal belongings.
- The open shelves are suitable for displaying books, decorative items, or frequently accessed essentials.

Your browser does not support the video tag.

Video 4.3: Demonstration of the fabric drawers and storage capacity of the nightstand.

5. MAINTENANCE

- **Cleaning:** Wipe the metal frame and wooden shelves with a soft, damp cloth. Avoid harsh chemicals. For fabric drawers, spot clean with a mild detergent and allow to air dry.
- **Dusting:** Regularly dust all surfaces to prevent buildup.
- **Fasteners:** Periodically check all screws and connections to ensure they remain tight. Re-tighten if necessary.

- **LED Strip:** If the LED strip adhesive weakens, re-secure it with appropriate adhesive.

6. TROUBLESHOOTING

Problem	Possible Cause	Solution
LED lights not working.	Power connection loose; LED strip disconnected; App not connected.	Check power cord connection. Ensure LED strip is properly plugged in. Reconnect via mobile app or use key switch.
Charging station (AC/USB) not providing power.	Nightstand not plugged in; Internal wiring issue.	Ensure the nightstand's main power cord is securely plugged into a working wall outlet. If problem persists, contact customer support.
Nightstand feels unstable or wobbly.	Screws are loose; Uneven floor; Anti-tip kit not installed.	Tighten all assembly screws. Adjust the leveling feet at the bottom. Install the anti-tip kit to secure to the wall.
Fabric drawers do not slide smoothly.	Overloaded drawer; Obstruction.	Reduce the weight in the drawer. Check for any items obstructing the drawer's movement.

7. SPECIFICATIONS

Feature	Detail
Model Name	ET-109-CL-4D
Product Dimensions (D x W x H)	11.81"D x 15.75"W x 52.05"H
Item Weight	16.86 Pounds (7.65 kg)
Frame Material	Metal
Drawer Material	PVC Fabric
Number of Drawers	4
Charging Station	2 AC Outlets (120V/12A), 2 USB Ports (5V/2A)
Power Cord Length	6.5 ft
LED Lighting	7 Colors, Adjustable Brightness, App/Key Switch Control
Included Components	Installation Tool, Anti-Tip Kit

PRODUCT SIZE

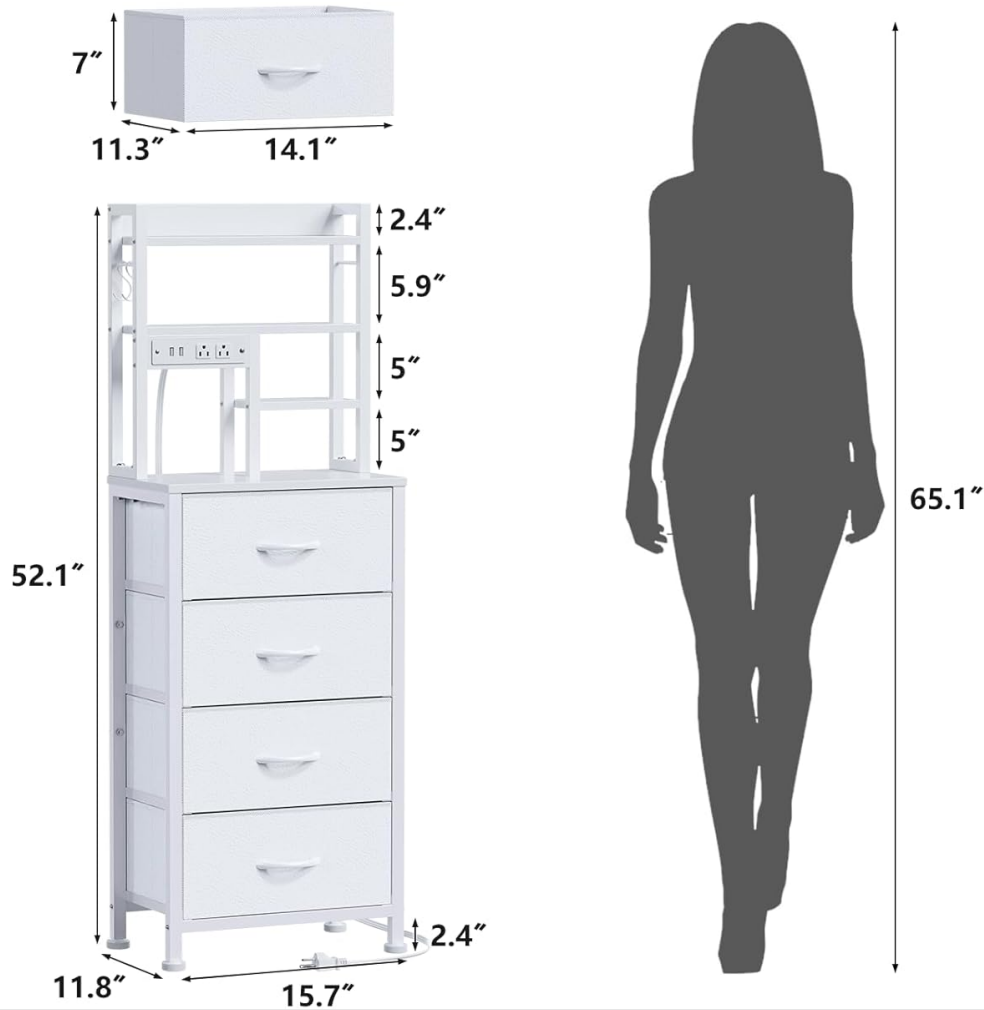

Image 7.1: Diagram illustrating the overall dimensions of the nightstand.

8. WARRANTY AND SUPPORT

For warranty information, please refer to the purchase documentation or contact your retailer. If you encounter any issues or have questions regarding your Furnulem Tall LED Nightstand, please contact Furnulem customer support for assistance.

Customer Support: Please visit the official Furnulem website or refer to your product packaging for contact details.