

## FLEXISPOT P1F-2

# FLEXISPOT Office Pod Booth User Manual

Model: P1F-2 | Brand: FLEXISPOT

## 1. INTRODUCTION

Thank you for choosing the FLEXISPOT Office Pod Booth. This soundproof enclosure is designed to provide a private and productive space for solo phone calls, virtual meetings, and focused work. This manual provides essential information for the safe and efficient setup, operation, and maintenance of your new office pod. Please read this manual thoroughly before assembly and use, and retain it for future reference.

## 2. SAFETY INFORMATION

To ensure safe operation and prevent damage, please adhere to the following safety guidelines:

- Always follow all assembly instructions carefully.
- Ensure the pod is placed on a stable, level surface capable of supporting its weight (approximately 584 pounds).
- Do not attempt to move the assembled pod without proper equipment or assistance.
- Keep all electrical components dry and away from liquids.
- Do not obstruct ventilation openings.
- Use only the provided power cords and adapters.
- Keep children and pets away from the pod during assembly and operation.
- In case of malfunction or damage, disconnect power immediately and contact customer support.

## 3. PACKAGE CONTENTS

Please verify that all components are present and undamaged before beginning assembly. If any parts are missing or damaged, contact FLEXISPOT customer support.

- FLEXISPOT Office Pod Booth components (panels, door, frame, etc.)
- Integrated lighting system
- Ventilation system

- Power supply and cables
- Assembly hardware
- Phillips screwdriver
- User Manual (this document)

## 4. SETUP AND ASSEMBLY

---

Assembly of the FLEXISPOT Office Pod requires multiple individuals due to its size and weight. Follow the detailed assembly instructions provided in the separate assembly guide included with your product. Ensure you have adequate space for assembly.



This diagram illustrates the external dimensions of the FLEXISPOT Office Pod: 36.85 inches in width, 39.37 inches in depth, and 92.36 inches in height. Plan your space accordingly.



An interior shot of the FLEXISPOT Office Pod, featuring a compact desk and a high stool, designed for comfortable and productive solo work. These internal components are installed during the assembly process.

#### 4.1 Initial Placement

Choose a location with sufficient clearance around the pod for door operation and ventilation. Ensure the floor is capable of supporting the pod's weight. Avoid placing the pod in direct sunlight or near heat sources.

#### 4.2 Power Connection

Once assembled, connect the power cable to a standard 100-240V AC outlet. Ensure the cable is not pinched or damaged.

### 5. OPERATING INSTRUCTIONS

---

The FLEXISPOT Office Pod is designed for intuitive operation, primarily managed by its integrated smart motion sensor system.

# Discover the P1F-2 Office Pod

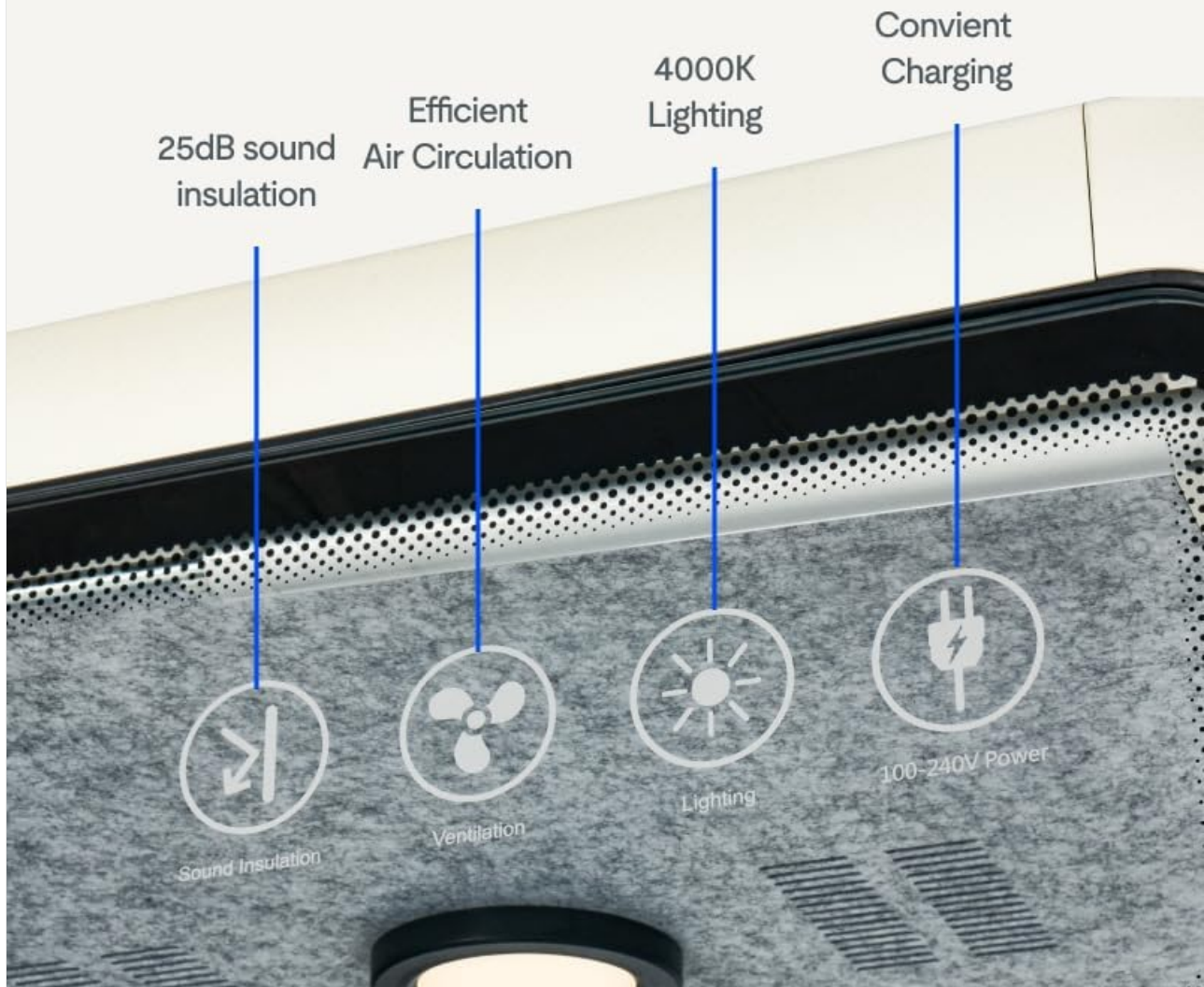

A detailed view of the top interior panel of the FLEXISPOT Office Pod, highlighting its key features: 25dB sound insulation, efficient air circulation, 4000K lighting, and convenient charging ports.

## 5.1 Smart Motion Sensor Activation

The pod features a smart motion sensor. When you enter the pod, the internal lighting and ventilation system will automatically activate. Upon exiting, the systems will automatically turn off after a short delay to conserve energy.

## 5.2 Lighting System

The integrated lighting system provides 4000K clear lighting, designed to reduce eye strain and enhance focus. This system is controlled by the motion sensor for automatic operation.

## 5.3 Ventilation System

An advanced ventilation system ensures a constant flow of fresh air, circulating at 81m³/h. This system operates automatically when the pod is occupied, maintaining a comfortable and productive environment.

# Discover the P1F-2 Office Pod

Stay fresh with air volume efficiency of 70m<sup>3</sup>/h



This close-up image shows the ventilation fan component within the FLEXISPOT Office Pod, responsible for maintaining fresh air circulation.

## 5.4 Integrated Charging Solutions

The pod includes built-in charging ports to keep your devices powered. Locate the charging ports on the interior panel and connect your devices as needed. These ports are active when the pod is powered.

## 6. MAINTENANCE

---

Regular maintenance will help prolong the life and performance of your FLEXISPOT Office Pod.

- **Cleaning:** Use a soft, damp cloth with a mild, non-abrasive cleaner to wipe down interior and exterior surfaces. Avoid harsh chemicals that may damage the finish or materials.
- **Glass Panels:** Clean glass surfaces with a standard glass cleaner and a lint-free cloth.
- **Ventilation System:** Periodically check the ventilation grilles for dust accumulation. Gently clean with a soft brush or vacuum cleaner attachment. Do not attempt to disassemble the ventilation unit.
- **Door Mechanism:** Ensure the door hinges and latch operate smoothly. Do not apply excessive force when opening or closing the door.

- **Electrical Components:** Ensure all cables are securely connected and free from damage. Do not attempt to repair electrical components yourself.

## 7. TROUBLESHOOTING

If you encounter issues with your FLEXISPOT Office Pod, refer to the following table for common problems and solutions.

Problem	Possible Cause	Solution
Lights/Ventilation not turning on automatically.	No power; Motion sensor obstructed or faulty.	Check power connection. Ensure nothing is blocking the motion sensor. If problem persists, contact support.
Unusual noise from ventilation.	Dust accumulation; Loose component.	Clean ventilation grilles. If noise continues, contact support.
Charging ports not working.	No power; Device compatibility issue.	Ensure pod is powered on. Try a different device or cable.
Door not closing properly.	Obstruction; Misalignment.	Check for any obstructions. Inspect hinges for damage or misalignment.

If the issue is not resolved by the above steps, please contact FLEXISPOT customer support for assistance.

## 8. SPECIFICATIONS

Detailed technical specifications for the FLEXISPOT Office Pod Booth P1F-2:

Feature	Specification
Model Number	P1F-2
Brand	FLEXISPOT
Product Dimensions (L x W x H)	36.85 x 39.37 x 90.55 inches
Item Weight	584 pounds
Material	Glass, Plastic Panel
Color	White
Lighting Temperature	4000K
Air Circulation Rate	81m³/h
UPC	840460412285

## 9. WARRANTY AND SUPPORT

FLEXISPOT products are manufactured to high-quality standards and are backed by a limited warranty. For specific





warranty terms and conditions, please refer to the warranty card included with your product or visit the official FLEXISPOT website.

For technical support, troubleshooting assistance, or to inquire about replacement parts, please contact FLEXISPOT customer service:

- **Online Support:** Visit the FLEXISPOT official website for FAQs and support resources.
- **Customer Service:** Refer to your product packaging or the FLEXISPOT website for contact phone numbers and email addresses.

When contacting support, please have your model number (P1F-2) and purchase information readily available.

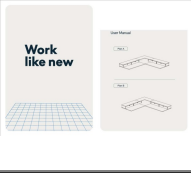
Related Documents - P1F-2

 <p><b>UAD SYSTEM MANUAL</b> Software Version 6.4</p>	<p><a href="#">UAD System Manual - Universal Audio: Installation &amp; Operation Guide</a></p> <p>The official UAD System Manual (v6.4) from Universal Audio provides in-depth guidance on installing, configuring, and operating UAD-2 DSP accelerators and Powered Plug-Ins. Discover features of UAD-2 SOLO, DUO, QUAD, OCTO, Satellite, SOLO/Laptop, and Apollo audio interfaces. Learn about audio processing, DAW integration, and achieving classic analog studio sound.</p>
 <p><b>solo stove</b></p>	<p><a href="#">Solo Stove: Instructions, Safety Warnings, and Product Family Guide</a></p> <p>Comprehensive guide to firing up and using your Solo Stove, including essential safety warnings, helpful tips, and an overview of the Solo Stove product family. Learn how to safely operate and maximize your outdoor cooking experience.</p>
 <p><b>UAD SYSTEM MANUAL</b> Software Version 7.0.1</p>	<p><a href="#">Universal Audio UAD System Manual: DSP Audio Processing Guide</a></p> <p>The official system manual for Universal Audio's UAD Powered Plug-Ins and UAD-2 DSP hardware accelerators. Covers installation, setup, and operation of UAD-2 SOLO, DUO, QUAD, OCTO, Satellite, SOLO/Laptop, and Apollo audio interfaces for professional audio production.</p>
 <p><b>Work like new</b></p>	<p><a href="#">Inbox Zero L-Shaped Standing Desk User Manual and Assembly Guide</a></p> <p>Comprehensive user manual and assembly guide for the Inbox Zero L-Shaped Standing Desk, detailing parts, assembly steps for Plan A and Plan B, attention notes, recycling information, and limited warranty.</p>
 <p><b>Focusrite Scarlett Solo</b></p>	<p><a href="#">Focusrite Scarlett Solo 4th Gen User Guide</a></p> <p>A comprehensive user guide for the Focusrite Scarlett Solo 4th Gen, a 2-in, 2-out audio interface designed for songwriters and musicians. This guide covers setup, hardware features, software integration with DAWs like Ableton Live, Logic Pro, Pro Tools, FL Studio, and Reaper, as well as Focusrite Control 2 software, presets, and troubleshooting.</p>

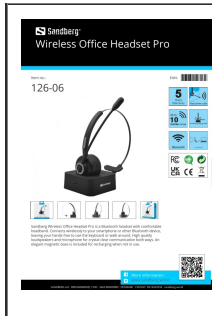

### [Sandberg Wireless Office Headset Pro - Bluetooth Headset for Clear Communication](#)

Discover the Sandberg Wireless Office Headset Pro, a comfortable Bluetooth headset offering up to 15 hours of talk time and a 10-meter wireless range. Ideal for hands-free calls and clear communication with smartphones and other Bluetooth devices.