

Darmoshark M5PRO

Darmoshark M5PRO Mini Wireless Gaming Mouse User Manual

Model: M5PRO

1. PRODUCT OVERVIEW

The Darmoshark M5PRO is a lightweight, tri-mode wireless gaming mouse designed for precision and versatility. It features a PAW3950 optical sensor, up to 30000 DPI, and 5 programmable buttons. The mouse supports 8K wireless, Bluetooth, and wired connections.



Image 1.1: The Darmoshark M5PRO mouse (red) and its 8K wireless receiver.



Image 1.2: Key features of the M5PRO mouse, including its sensor, polling rate, and microcontroller.

Your browser does not support the video tag.

Video 1.1: An overview of the Darmoshark M5PRO Wireless Gaming Mouse, showcasing its design and various color options.

2. SETUP INSTRUCTIONS

2.1 Charging the Mouse

Before initial use, ensure the mouse is fully charged. Connect the provided USB-C cable to the mouse and a power source (e.g., computer USB port, USB wall adapter). The LED indicator will show charging status.



Image 2.1: The M5PRO mouse is equipped with a 300mAh lithium battery for extended use.

2.2 Connection Modes

The M5PRO mouse supports three connection modes: 8K wireless, Bluetooth, and wired USB-C.

2.2.1 8K Wireless Connection

1. Connect the 8K wireless receiver to an available USB port on your computer.
2. Turn on the mouse and select the 8K wireless mode using the switch on the bottom of the mouse.
3. The mouse should automatically connect to the receiver.



Image 2.2: The 8K wireless receiver provides a high-speed connection for the M5PRO mouse.

2.2.2 Bluetooth Connection

1. Turn on the mouse and select the Bluetooth mode using the switch on the bottom of the mouse.
2. On your computer or device, navigate to Bluetooth settings and search for new devices.
3. Select "Darmoshark M5PRO" from the list of available devices to pair.

2.2.3 Wired Connection

1. Connect the USB-C cable to the mouse and the other end to a USB port on your computer.
2. The mouse will automatically switch to wired mode and begin charging.

3. OPERATING INSTRUCTIONS

3.1 Button Functions

The M5PRO mouse features 5 programmable buttons:

- Left Click Button
- Right Click Button
- Scroll Wheel (Clickable)

- Forward Button (Side)
- Backward Button (Side)

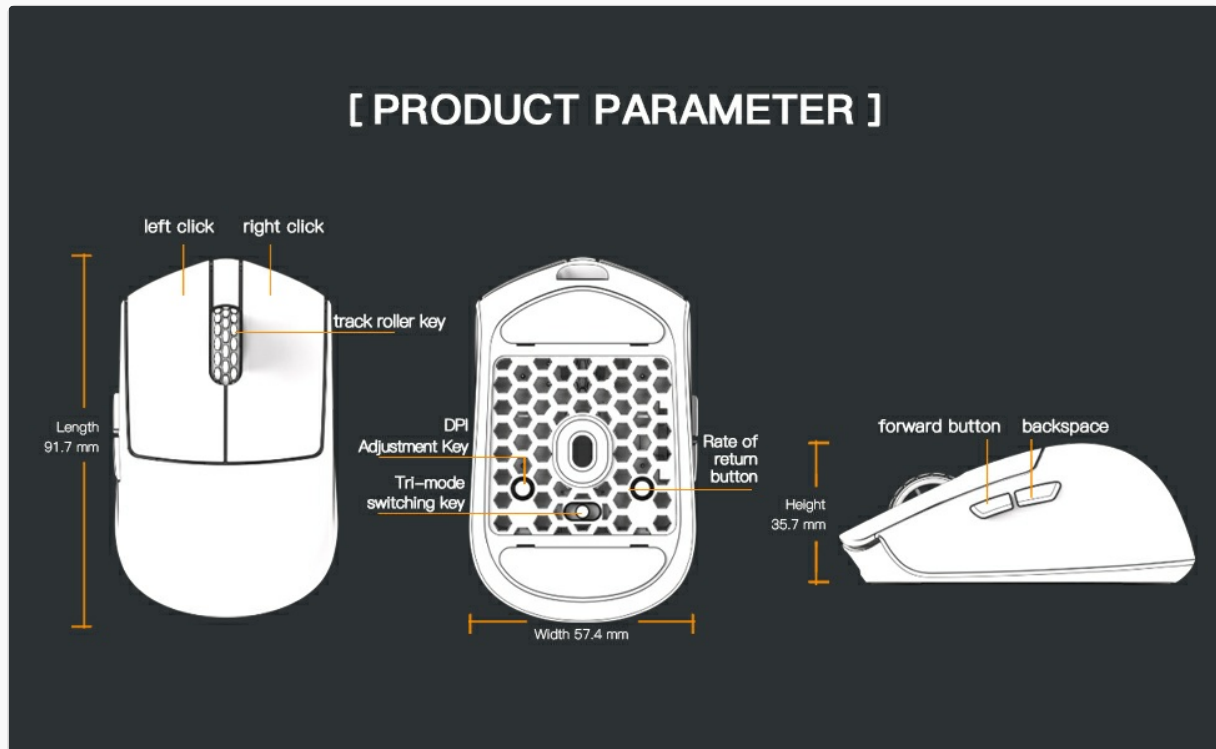

Image 3.1: Diagram illustrating the button layout and dimensions of the M5PRO mouse.

3.2 DPI Adjustment

The DPI (Dots Per Inch) sensitivity can be adjusted using the dedicated DPI adjustment key located on the bottom of the mouse. Press the button to cycle through preset DPI levels. The current DPI level may be indicated by an LED color change (refer to software for specific mappings).

3.3 Mode Switching

Use the switch on the bottom of the mouse to select between 8K wireless, Bluetooth, and wired modes.

3.4 Software Customization

For advanced customization, including button remapping, macro creation, and DPI fine-tuning, download the proprietary drivers from the official Darmoshark website. The software allows for personalized settings to optimize your experience.



Image 3.2: The proprietary driver software allows for extensive customization of mouse settings.

4. MAINTENANCE

4.1 Cleaning

To clean the mouse, use a soft, dry cloth. For stubborn dirt, a slightly damp cloth can be used, but ensure no moisture enters the mouse. Avoid using harsh chemicals or abrasive materials.

4.2 Storage

When not in use for extended periods, store the mouse in a cool, dry place away from direct sunlight and extreme temperatures. Ensure the mouse is turned off to conserve battery life.



Image 4.1: Exploded view of the M5PRO mouse, highlighting its internal structure and lightweight components.

5. TROUBLESHOOTING

5.1 Mouse Not Responding

- **Check Battery:** Ensure the mouse is charged. Connect it via USB-C cable to charge.
- **Check Connection:** Verify the correct mode (8K wireless, Bluetooth, or wired) is selected on the mouse.
- **Receiver/Cable:** For 8K wireless, ensure the receiver is securely plugged into a working USB port. For wired, ensure the cable is properly connected.
- **Re-pair Bluetooth:** If using Bluetooth, try removing the device from your computer's Bluetooth settings and re-pairing it.

5.2 Cursor Movement Issues

- **Clean Sensor:** Ensure the optical sensor on the bottom of the mouse is clean and free from debris.
- **Surface:** Use the mouse on a suitable surface, preferably a mouse pad, for optimal tracking.
- **DPI Setting:** Adjust the DPI sensitivity to a comfortable level.

5.3 Software Not Detecting Mouse

- **Wired Connection:** Connect the mouse via USB-C cable to ensure the software can detect it.
- **Reinstall Software:** Try uninstalling and reinstalling the proprietary drivers.
- **Firmware Update:** Check the Darmoshark website for any available firmware updates for the mouse.

6. SPECIFICATIONS

Feature	Specification
Brand	Darmoshark
Model	M5PRO
Connectivity Technology	8K Wireless, Bluetooth, Wired (USB-C)
Movement Detection Technology	PAW3950 Optical Sensor
Maximum DPI	30000 DPI
Polling Rate	Up to 8KHz (8K wireless mode)
Number of Buttons	5 (Programmable)
Weight	Approximately 38 grams
Battery	1 Lithium Ion battery (included)
Compatibility	Windows, Apple Mac



Image 6.1: The PAW3950 optical sensor is a core component for precise tracking.



7. WARRANTY AND SUPPORT

For warranty information and technical support, please refer to the official Darmoshark website or contact their customer service. Keep your proof of purchase for warranty claims.
Official Darmoshark Website: [Darmoshark Store](#)

© 2025 Darmoshark. All rights reserved.

Related Documents - M5PRO

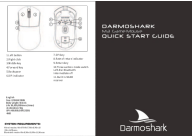
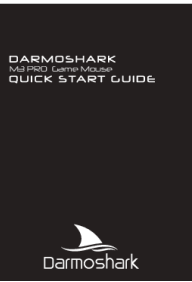
	<p>Darmoshark M2 PRO TRI-MODE Game Mouse Quick Start Guide</p> <p>Quick start guide for the Darmoshark M2 PRO TRI-MODE Game Mouse, detailing setup, connection modes (2.4G, Bluetooth, Wired), system requirements, technical specifications, indicator lights, and warranty information.</p>
	<p>DARMOSHARK M3XS PRO Game Mouse Quick Start Guide - Setup, Features, Specs</p> <p>Get started quickly with the DARMOSHARK M3XS PRO Game Mouse. This guide covers setup, connectivity (2.4G, Bluetooth, Wired), DPI settings, specifications, and warranty information.</p>

	<p>DARMOSHARK M3 Game Mouse Quick Start Guide - Specifications & Setup</p> <p>Comprehensive quick start guide for the DARMOSHARK M3 Game Mouse, detailing its features, electrical parameters, connection modes, system requirements, and FCC compliance.</p>
	<p>Darmoshark M3 PRO Game Mouse Quick Start Guide</p> <p>Get started quickly with the Darmoshark M3 PRO Game Mouse. This guide provides essential information on setup, features, and specifications for optimal gaming performance.</p>
	<p>Darmoshark N3 Gaming Mouse Quick Start Guide</p> <p>Quick start guide for the Darmoshark N3 gaming mouse, covering setup, features, specifications, and troubleshooting. Includes details on wired and wireless connectivity, DPI settings, battery life, and system requirements.</p>
	<p>Darmoshark K7 Pro Gaming Keyboard Quick Start Guide</p> <p>A quick start guide for the Darmoshark K7 Pro gaming keyboard, covering custom lighting, wired and wireless modes, system switching, multimedia controls, and troubleshooting.</p>