

**Ebitcam B0DHX2WK2T**

# Ebitcam Indoor Camera User Manual

Model: B0DHX2WK2T

Brand: Ebitcam

## 1. INTRODUCTION

The Ebitcam Indoor Camera is a versatile home security device designed to provide comprehensive monitoring with its 360° pan/tilt capabilities, 1080P HD video, and advanced features like color night vision and two-way audio. This camera is ideal for monitoring pets, babies, or for general home security. It operates on 2.4GHz WiFi networks.



Figure 1.1: Ebitcam Indoor Camera and its mobile application interface.

## 2. WHAT'S IN THE BOX

Please check the package contents to ensure all items are present:

- 1x Ebitcam Smart Security Camera
- 1x USB Adapter
- 1x Cable
- 1x Quick Installation Guide
- 1x Mounting Accessories

## 3. SETUP GUIDE

1. **Power On the Camera:** Connect the camera to a power source using the provided USB adapter and cable. The camera will power on automatically.

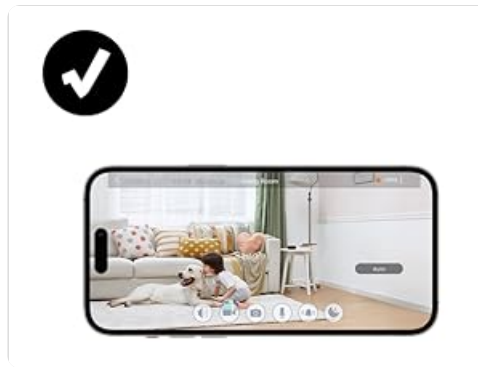

Figure 3.1: Connect the camera to power.

2. **Download the EbitCam App:** Scan the QR code in the Quick Installation Guide or search for "EbitCam" in your mobile app store (iOS or Android) to download and install the application.

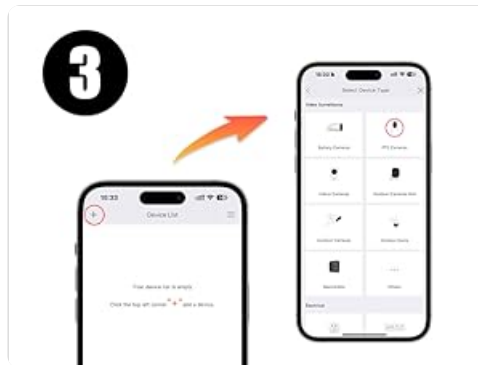

Figure 3.2: Download the EbitCam mobile application.

3. **Add Device in App:** Open the EbitCam app, create an account if you don't have one, and log in. Tap the "+" icon to add a new device. Follow the on-screen instructions to connect the camera to your 2.4GHz Wi-Fi network. Ensure your phone is connected to the same 2.4GHz Wi-Fi network during setup.



Figure 3.3: Steps to add the camera in the EbitCam app.

4. **View Live Feed:** Once successfully connected, you can view the live video feed from your camera through the EbitCam app.



Figure 3.4: Live view of the camera feed on a smartphone.

## 4. OPERATING INSTRUCTIONS

### 4.1. Pan and Tilt Control

The Ebitcam Indoor Camera offers a 355° horizontal and 115° vertical rotation range, allowing you to monitor a wide area. Control the camera's movement directly from the EbitCam app by swiping on the live video feed.



Figure 4.1: Camera's pan and tilt capabilities.

### 4.2. 1080P HD Color Night Vision

The camera provides sharp 1080P HD resolution and features advanced color night vision technology with a dual-source lighting system. Equipped with 1 PIR LED, it offers clear visibility up to 20 feet in low-light conditions. You can select between vivid full-color night vision or traditional infrared night vision modes within the app.

# See clearly day & night

Infrared LEDs illuminate up to 32ft for stunning night vision.



Figure 4.2: Clear day and night vision capabilities.

## 4.3. AI Human/Sound/Motion Detection

The camera is equipped with advanced motion sensors and intuitive analytics. It can detect human movement and unusual sounds, sending timely notifications to your EbitCam app. This feature helps minimize unnecessary alerts while ensuring important events are captured.

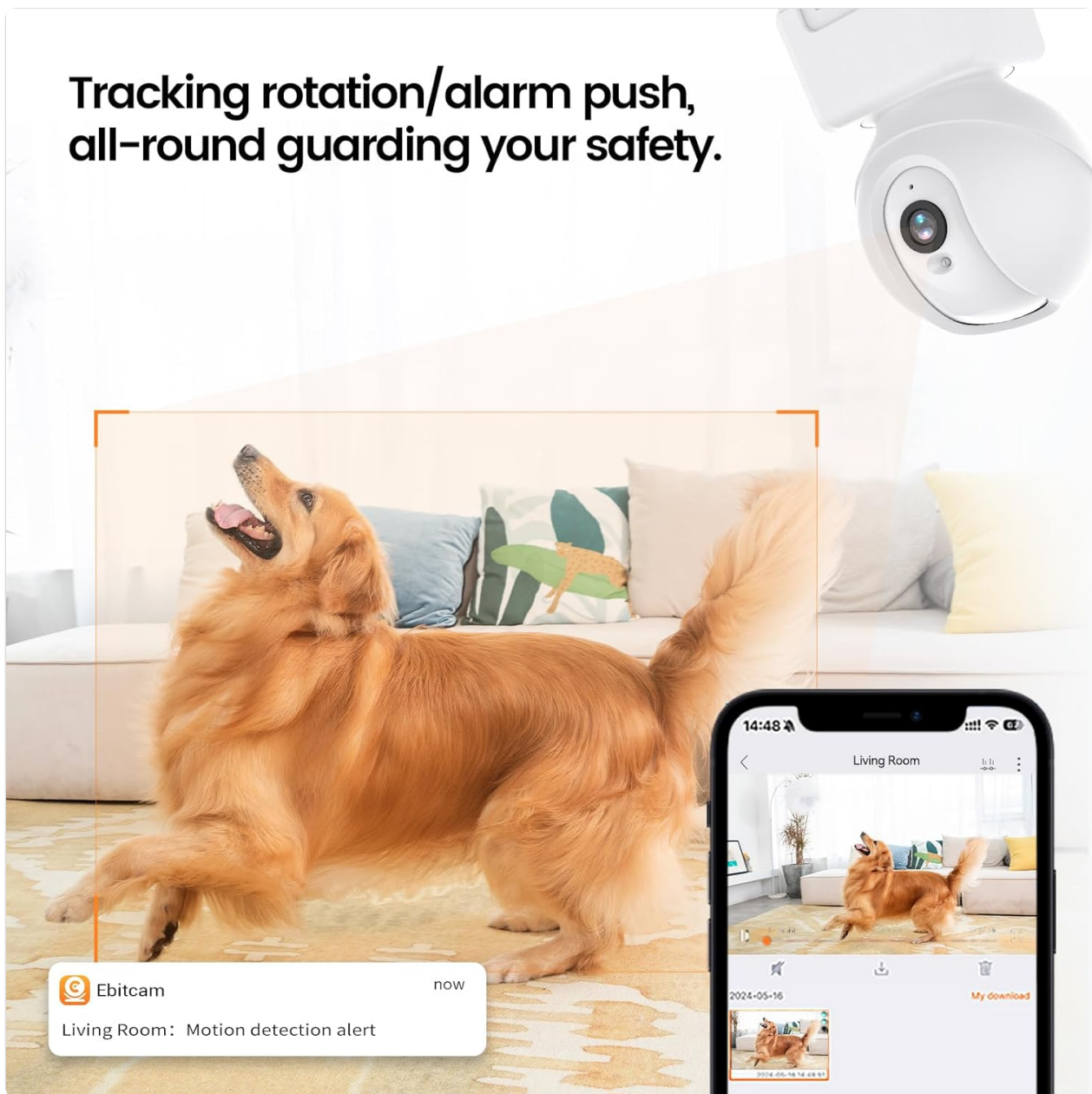

Figure 4.3: Motion detection and tracking in action.

#### 4.4. Two-Way Audio & Alexa Integration

With a built-in microphone and speaker, the camera supports two-way audio communication, allowing you to speak with and listen to your baby, pet, or family members remotely. The camera also works with Alexa; simply ask Alexa to display the camera's view on compatible devices.

# Recording and Playback

Support cloud service and SD card storage.



Figure 4.4: Camera integration with Alexa for voice control.

## 4.5. Multi-User Support

The EbitCam mobile application allows multiple users to control and view the camera simultaneously on both iOS and Android devices. You can easily share access to the camera with friends and family members.



# Works With Alexa



Figure 4.5: Multiple users can access the camera feed.

## 4.6. Recording and Storage

The camera supports two storage options for continuous 24/7 recording:

- **Cloud Storage:** Financial encryption video storage technology allows private recording in the EbitCam cloud storage (sold separately). A 30-day free cloud trial is available for first-time users.
- **Local SD Card Storage:** The camera supports a Micro SD card up to 512GB (not included) for local storage, providing continuous recording without a subscription fee. To access the Micro SD card slot, gently push the camera head upwards.

# Two-Way Audio & User Sharing

Talk and Hear, Peace of Mind is Near



Figure 4.6: Cloud and local SD card storage options.

## 5. MAINTENANCE

To ensure optimal performance and longevity of your Ebitcam Indoor Camera, follow these maintenance guidelines:

- **Cleaning:** Use a soft, dry cloth to clean the camera's exterior. For the lens, use a microfiber cloth specifically designed for optics. Avoid using harsh chemicals or abrasive cleaners.
- **Placement:** Place the camera in a stable location, away from direct sunlight, heat sources, and excessive moisture. Ensure proper ventilation around the device.
- **Firmware Updates:** Regularly check the EbitCam app for available firmware updates to ensure your camera has the latest features and security enhancements.

## 6. TROUBLESHOOTING

If you encounter issues with your Ebitcam Indoor Camera, refer to the following common problems and solutions:

| Problem                      | Possible Cause  | Solution   |
|------------------------------|---|--|
| Camera not powering on       | Power adapter or cable issue; power outlet problem.                       | Ensure the power adapter is securely connected to the camera and a working power outlet. Try a different outlet.                                     |
| Cannot connect to Wi-Fi      | Incorrect Wi-Fi password; 5GHz Wi-Fi network; camera too far from router. | Verify Wi-Fi password. Ensure you are connecting to a 2.4GHz Wi-Fi network. Move the camera closer to the router.                                    |
| Poor video quality           | Weak Wi-Fi signal; dirty lens.  | Check your Wi-Fi signal strength in the app. Clean the camera lens with a soft cloth.  |
| Motion detection not working | Detection settings disabled or sensitivity too low.                       | Check the motion detection settings in the EbitCam app and adjust sensitivity as needed.   |
| SD card not recording        | SD card not inserted correctly; card full or corrupted; incorrect format. | Ensure the SD card is inserted correctly. Check card capacity and format (FAT32 recommended). Try reformatting the card via the app or replacing it. |

## 7. TECHNICAL SPECIFICATIONS

| Feature                  | Specification                                |
|--------------------------|--|
| Model                    | B0DHX2WK2T                                   |
| Video Capture Resolution | 1080p  |
| Viewing Angle            | 360 Degrees (355° horizontal, 115° vertical) |
| Connectivity Technology  | Wi-Fi (2.4GHz)                               |
| Night Vision Range       | 6 Meters (approx. 20 ft)                     |
| Storage                  | Micro SD (up to 512GB), Cloud Storage        |
| Two-Way Audio            | Yes  |
| Motion Detection         | AI Human/Sound/Motion Detection              |

| Feature                | Specification                                  |
|------------------------|--|
| Compatible Devices     | Amazon Alexa, Android, Apple HomeKit (via app) |
| Power Source           | Corded Electric (5 Volts DC, 5 Watts)          |
| Dimensions (L x W x H) | 3.15 x 4.21 x 2.83 inches                      |
| Item Weight            | 9.9 ounces                                     |
| Material               | Acrylonitrile Butadiene Styrene (ABS)          |

## 8. WARRANTY AND SUPPORT

Ebitcam is committed to customer satisfaction. Your Ebitcam Indoor Camera comes with **aone-year warranty** from the date of purchase. Additionally, Ebitcam offers **lifetime technical support** for the product.

If you encounter any problems or have questions regarding your camera, please contact Ebitcam customer service. They aim to reply within 24 hours for assistance with returns, refunds, or technical queries.

For support, please refer to the contact information provided in your Quick Installation Guide or visit the official Ebitcam website.