

## INFIYA M1

# INFIYA M1 Wireless 2K Video Doorbell Camera Instruction Manual

Model: M1

## 1. INTRODUCTION

The INFIYA M1 Wireless 2K Video Doorbell Camera provides advanced home security with convenient features. This manual offers detailed instructions for setting up, operating, and maintaining your video doorbell to ensure optimal performance and security for your home.

Key features include 2K video resolution, an included indoor chime, night vision, AI human detection, instant alerts, and two-way audio communication.



Image 1.1: INFIYA M1 Video Doorbell Camera and Chime highlighting key features like 2K resolution, two-way audio, human detection, instant alerts, night vision, built-in battery, weather resistance, and 2.4GHz Wi-Fi support.

## 2. WHAT'S IN THE BOX

- Video Doorbell Camera (with mounting plate attached) x1
- Indoor Chime x1
- AAA Batteries x3 (for chime)
- 1.5m (4.92ft) USB Power Cord x1
- Mounting Kit (screws and anchors) x1

- Positioning Sticker x1
- Quick Start Guide x1
- 24-hour Surveillance Sticker x1



Image 2.1: All items included in the INFIYA M1 Video Doorbell Camera package, neatly arranged in their packaging.

### 3. PRODUCT OVERVIEW

The INFIYA M1 Video Doorbell features a sleek, compact design suitable for outdoor installation. It includes a camera lens, motion sensor, microphone, speaker, and a doorbell button with an LED indicator. The accompanying indoor chime is a portable unit that alerts you to visitors.



Image 3.1: The INFIYA M1 Wireless 2K Video Doorbell Camera and its indoor chime, with a smartphone displaying the live feed.



Image 3.2: Icons representing the main features of the INFIYA M1 Doorbell: 2.4GHz Wi-Fi, AI Human Detection, Battery Powered, Night Vision, IP65 Waterproof, Two-way Audio, Cloud Storage, Wide-Angle Lens, and 2K Clear Image.

## 4. SETUP

### 4.1. Chime Setup

1. Open the battery compartment on the back of the indoor chime.
2. Insert 3 AAA batteries (included) into the compartment, ensuring correct polarity.
3. Close the battery compartment.

### 4.2. Doorbell Installation

The doorbell offers two installation methods: screw mounting or adhesive mounting.

- **Screw Mounting:** Use the provided mounting kit (screws and anchors) to securely attach the backing plate to your desired location on the wall. Then, slide the doorbell onto the backing plate.
- **Adhesive Mounting:** For apartment tenants or surfaces where drilling is not preferred, use the pre-applied 3M adhesive

backing plate. Ensure the surface is clean and dry before attaching.



Image 4.1: Visual guide for installing the doorbell using either screws or 3M adhesive tape.

### 4.3. App Connection & Pairing

To connect your INFIYA M1 Video Doorbell, follow these steps:

1. **Download the App:** Install the 'Wansview Cloud' app from Google Play Store (Android) or Apple App Store (iOS).
2. **Register/Log In:** Open the app, create a new account, and log in.
3. **Connect to 2.4GHz Wi-Fi:** Ensure your smartphone is connected to a 2.4GHz Wi-Fi network. 5GHz Wi-Fi is not supported.
4. **Power On Doorbell:** Remove the doorbell from its mounting plate. Press and hold the power button for 5 seconds until you hear a startup sound and see the lights turn on.
5. **Enter Pairing Mode:** Press and hold the reset button on the back of the doorbell until the indicator light flashes blue and red alternately.
6. **Add Device in App:** In the Wansview Cloud app, tap 'Add device' or the '+' icon. Select 'Video doorbell' and then 'M1'.
7. **Scan QR Code:** The app will display a QR code. Double-tap to enlarge it. Position the doorbell camera 3-8 inches in front of your phone screen to scan the QR code. Adjust screen brightness to avoid reflections.
8. **Confirmation:** Once the QR code is successfully scanned, you will hear a voice prompt and the indicator light will flash blue. Tap 'Next' in the app.
9. **Pair Chime:** Follow the in-app instructions to pair the indoor chime with the doorbell. Press the pairing button on the chime, then press the doorbell button within 30 seconds.
10. **Name Device:** Name your video doorbell (e.g., 'Front Door') and tap 'OK'.

Video 4.1: Official INFIYA guide demonstrating how to connect the M1 Wireless Video Doorbell Camera to the Wansview Cloud app, including Wi-Fi setup and QR code scanning.

Video 4.1 Description: This video provides a step-by-step visual guide on connecting your INFIYA M1 Wireless Video Doorbell. It covers downloading the Wansview Cloud app, connecting to a 2.4GHz Wi-Fi network, powering on the doorbell, entering pairing mode, scanning the QR code displayed in the app, and pairing the indoor chime. The video emphasizes ensuring the doorbell is in pairing mode (flashing blue and red lights) and that the phone is connected to a 2.4GHz Wi-Fi network.

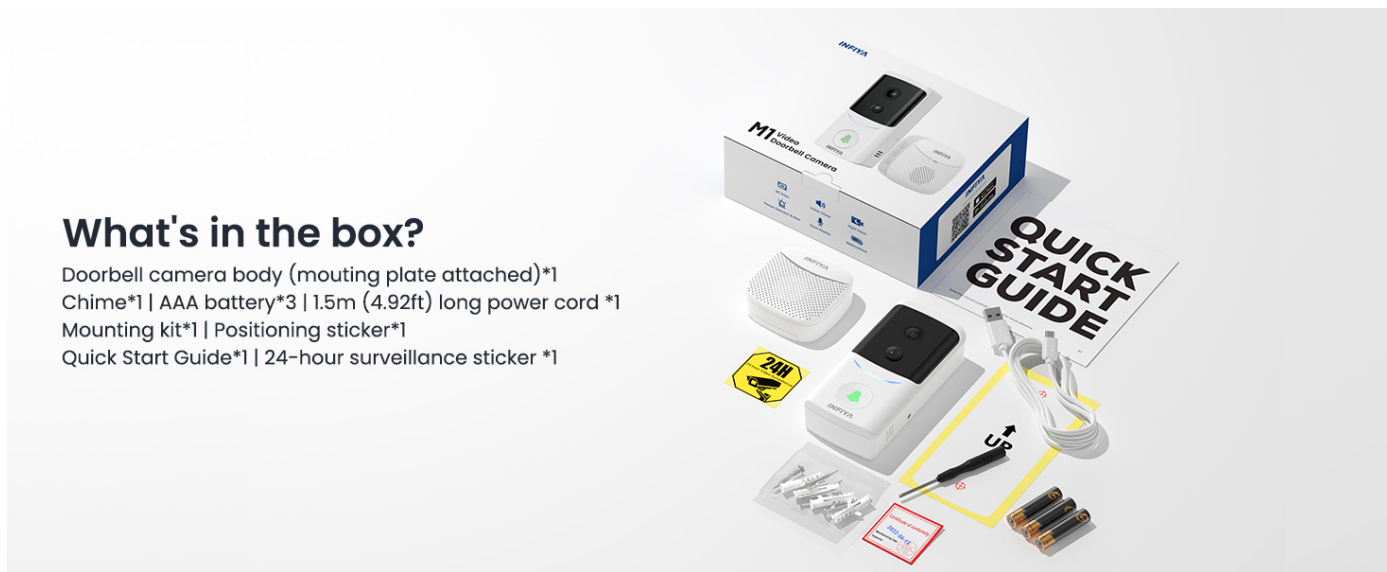

Image 4.2: A visual flowchart showing the steps to connect the doorbell camera: install Wansview Cloud app, register account, power on and place near router, then follow app instructions for Wi-Fi configuration.

## 5. OPERATING THE DOORBELL

## 5.1. Live View & 2K Resolution

Access the live video feed anytime, anywhere through the Wansview Cloud app. The doorbell provides crystal-clear 2K resolution, offering sharper images and more details than 1080P video, with a 125-degree wide viewing angle.



### What's in the box?

- Doorbell camera body (mounting plate attached)\*1
- Chime\*1 | AAA battery\*3 | 1.5m (4.92ft) long power cord \*1
- Mounting kit\*1 | Positioning sticker\*1
- Quick Start Guide\*1 | 24-hour surveillance sticker \*1

Image 5.1: Comparison of 2K resolution video quality during day and night, showcasing the wide 125-degree viewing angle.

## 5.2. Two-Way Audio & Voice Changer

Communicate with visitors at your door using the two-way audio feature. The app also includes a built-in voice changer function, allowing you to modify your voice for added privacy or security, especially when children or elderly individuals are home alone.



# Two Way Audio

Leave it at the door, thank you.

Hello, your package has arrived.

Image 5.2: A person using the smartphone app to communicate via two-way audio with a delivery person at the door.

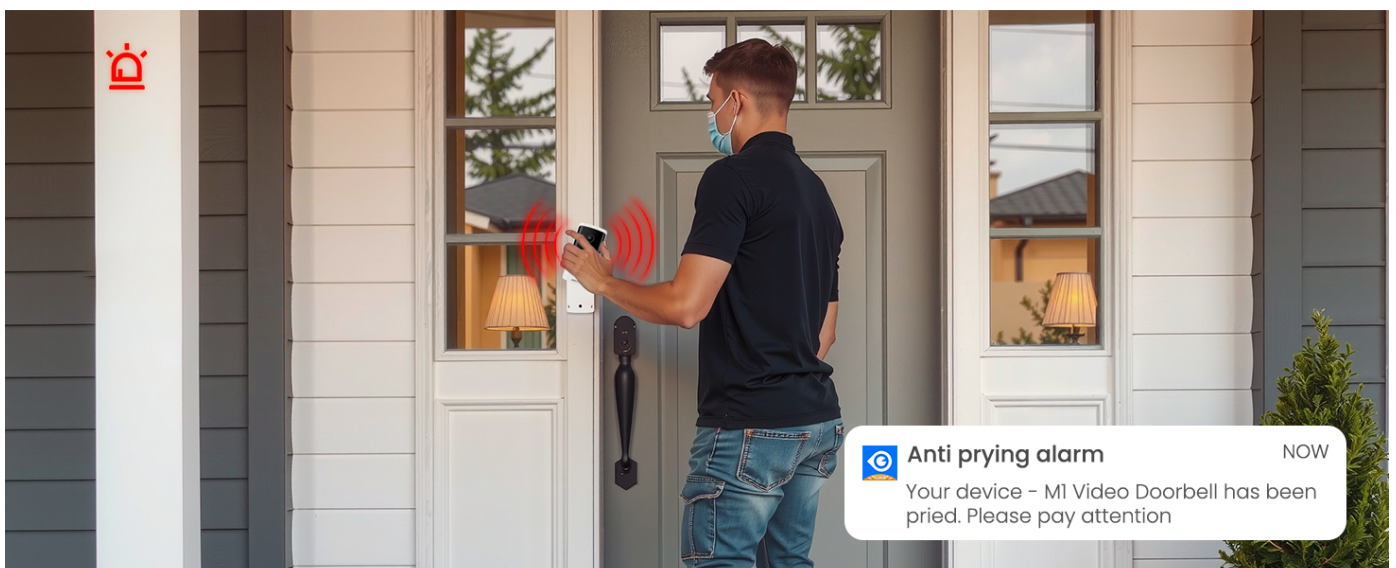

Image 5.3: Illustration of the voice changer function in the app, offering original, gentleman, and funny tone options for two-way audio.

### 5.3. AI Human Detection & Instant Alerts

The doorbell features AI-enhanced human detection with customizable sensitivity. When a person is detected, the camera records a 10-second alert video and sends an instant notification to your smartphone via the app, reducing false alarms from pets or inanimate objects.

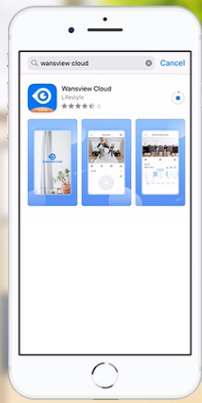

Image 5.4: A person walking with a dog, with the AI human detection feature highlighting the person and sending a motion alarm notification to a smartphone.



## How to Connect the Doorbell Camera

\*This doorbell camera doesn't support 5GHz Wi-Fi.  
\*Please make sure that the camera has enough battery power in advance.



1. Install the Wansview Cloud APP.

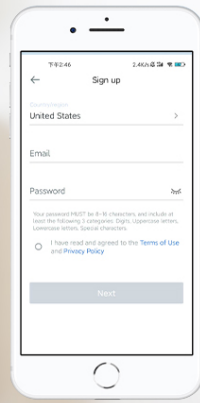

2. Register your own account.

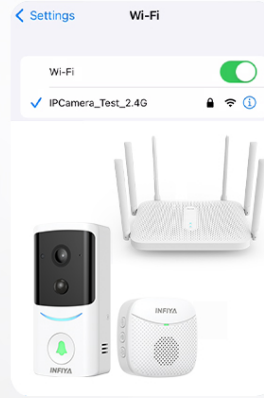

3. Power on the camera and place it near the router within 3 feet. Then connect the phone with 2.4GHz Wi-Fi.

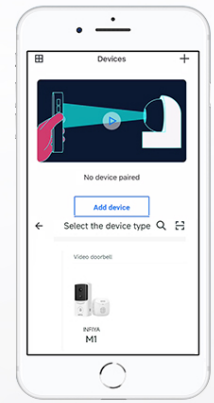

4. Follow the instructions on the APP to finish Wi-Fi configuration.

Image 5.5: Screenshot of the app's custom mode settings for motion detection, allowing adjustment of detection distance, length of stay, motion sensitivity, and retrigger interval.

### 5.4. Night Vision

Equipped with 4 infrared LEDs and a high-sensitivity PIR sensor, the doorbell provides clear night vision for extended surveillance in low-light conditions, ensuring your property is monitored 24/7.





Image 5.6: A split image showing the difference between day vision (color) and night vision (black and white infrared) from the doorbell camera.

### 5.5. Real-time Call

When a visitor presses the doorbell button, a real-time video call notification is pushed to your phone. You can choose to accept or decline the call. If unanswered, the call automatically ends after 60 seconds. These calls are generated via the app and do not consume cellular minutes.

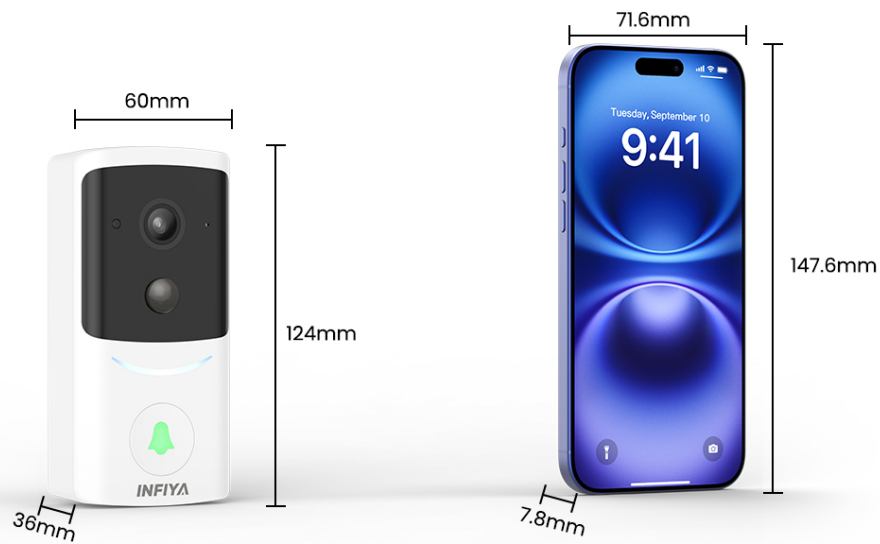

Image 5.7: A hand pressing the doorbell button, triggering a real-time call notification on a smartphone screen.

## 5.6. Tamper-Proof Alert

The doorbell is equipped with an anti-theft feature. If the doorbell is forcibly removed from its backing plate, it will sound an immediate alarm, and a warning message will be sent to your mobile phone via the app.

# Tamper-proof Alert

Once the doorbell is violently removed, it will sound an alarm and send an app notification.



Image 5.8: A two-panel image showing a person attempting to remove the doorbell, followed by a smartphone displaying an 'Anti prying alarm' notification.

## 6. MAINTENANCE

### 6.1. Battery Charging

The doorbell has a built-in 5000mAh rechargeable battery. To charge, remove the doorbell from its mounting plate and connect it to the provided USB power cord. You can customize power-save settings in the app to balance performance and battery



efficiency.



Image 6.1: The doorbell with an illustration of its 5000mAh battery and a smartphone screen showing power-save, standard, performance, and custom modes.

## 6.2. Weather Resistance

The INFIYA M1 doorbell is IP65 dustproof and waterproof, ensuring stable operation in various weather conditions including rain, snow, and sunshine.



# IP65 Waterproof

Suitable for various weather conditions to ensure house safety.



Image 6.2: The doorbell mounted outdoors in the rain, with icons indicating its suitability for shine, rain, dust, and snow conditions.

## 6.3. Data Security & Storage

All data from the doorbell camera is secured with AES-128 encryption. Alerts are stored safely on the cloud. Only the doorbell owner and invited members can view recordings in the app. Optional cloud service provides longer video recording and storage loops.

## AI-enhanced Motion Detection

With a simple tap on app to enable the human detection label, camera can only focus on important events caused by visitors. Adjust the retrigger interval & length of stay settings to control how often and how long will it take for the camera to record alert videos at your needs.

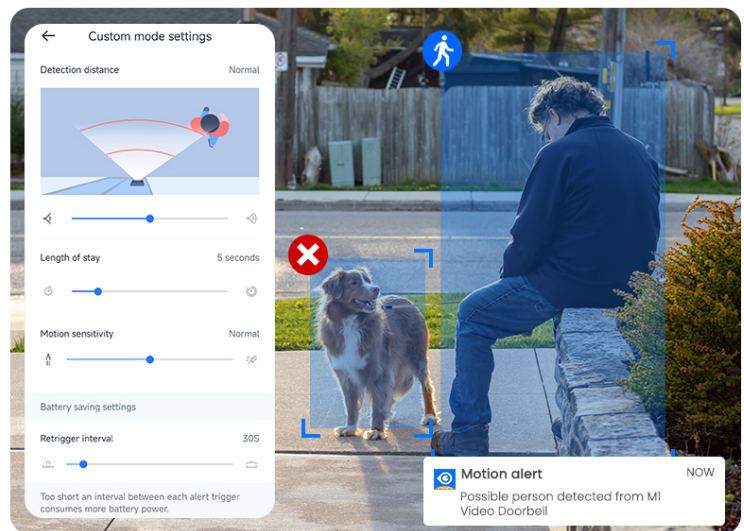

Image 6.3: A smartphone displaying the app's interface for reviewing recorded events stored in optional cloud storage.

## 7. TROUBLESHOOTING

- **Doorbell not connecting to Wi-Fi:** Ensure your router is broadcasting a 2.4GHz Wi-Fi signal. The doorbell does not support 5GHz Wi-Fi. Make sure your phone is connected to the 2.4GHz network during setup.
- **Poor video quality:** Check your Wi-Fi signal strength at the doorbell's location. A weak signal can affect video streaming quality. Ensure the camera lens is clean and free from obstructions.
- **Short battery life:** Adjust power-save settings in the app. High motion detection sensitivity or frequent live view access can drain the battery faster. Ensure the doorbell is fully charged after installation.
- **False motion alerts:** Customize the AI human detection sensitivity in the app to reduce alerts triggered by non-human movements.
- **Chime not ringing:** Verify that the chime has fresh AAA batteries and is properly paired with the doorbell. Check the volume settings on the chime.







## 8. SPECIFICATIONS

Model Name	M1
Brand	INFIYA
Video Resolution	2K (3MP Max Webcam Image Resolution)
Viewing Angle	125 degrees
Connectivity	2.4GHz Wi-Fi (5GHz not supported)
Power Source	Battery Powered (Built-in 5000mAh Lithium Ion battery)
Weather Rating	IP65 Dustproof and Waterproof
Special Features	2-Way Audio, AI Human Detection, Chime Included, Easy to Install, Night Vision, Tamper-Proof Alert
Dimensions	4.88 x 2.36 x 1.42 inches
Item Weight	14.4 ounces

## 9. WARRANTY AND SUPPORT

For warranty information, technical support, or any product-related inquiries, please refer to the contact details provided in your Quick Start Guide or visit the official INFIYA website. Our customer service team is available to assist you with any questions or issues.

### Related Documents - M1

	<p><a href="#">INFIYA Z1 Battery Camera Quick Start Guide</a></p> <p>Quick start guide for the INFIYA Z1 battery-powered security camera, covering setup, installation, troubleshooting, and regulatory information. Learn how to connect, install, and manage your camera.</p>
	<p><a href="#">INFIYA M1 Smart Doorbell Camera Quick Start Guide</a></p> <p>Concise guide for setting up and installing the INFIYA M1 Smart Doorbell Camera and Chime. Includes setup steps, indicator light status, pairing instructions, and troubleshooting FAQs.</p>
	<p><a href="#">INFIYA M1 Video Doorbell Camera Quick Start Guide</a></p> <p>A quick start guide for the INFIYA M1 Video Doorbell Camera, covering product diagram, what's in the box, setup instructions, indicator light status, connecting to the chime, chime buttons, installation, FAQ, and regulatory notices.</p>
	<p><a href="#">INFIYA M1 Smart Doorbell Quick Installation Guide</a></p> <p>A concise and SEO-optimized guide for installing and setting up the INFIYA M1 Smart Doorbell, covering app download, device pairing, WiFi configuration, and troubleshooting.</p>
	<p><a href="#">INFIYA Z1 Battery Camera Quick Start Guide: Setup, Installation, and FAQ</a></p> <p>Get started quickly with the INFIYA Z1 wireless outdoor security camera. This guide covers setup, installation, solar panel mounting, troubleshooting, and FAQs.</p>
	<p><a href="#">Wansview Cloud APP User Manual for Z1 Smart Solar Battery Outdoor Camera</a></p> <p>Comprehensive user manual for the INFIYA Wansview Cloud APP and Z1 Smart Solar Battery Outdoor Camera. Learn how to set up, configure, and use features like motion detection, cloud storage, and live feed.</p>