

QUMOX B1197

QUMOX Solar-Powered Driveway Alert System B1197 User Manual

INTRODUCTION

This manual provides comprehensive instructions for the installation, operation, and maintenance of your QUMOX Solar-Powered Driveway Alert System, model B1197. This wireless motion sensor system is designed to enhance security by alerting you to movement in designated areas such as driveways, entryways, or gardens.

PRODUCT OVERVIEW

Components

- 1 x Solar Wireless Motion Sensor (Detector)
- 1 x Plug-in Alarm Receiver
- Mounting Hardware

Key Features

- **Wireless Operation:** The infrared sensor detects movement and wirelessly communicates with the receiver.
- **Extensive Detection Range:** Detects movement from approximately 16 to 52 feet, with three adjustable sensitivity settings.
- **Extended Transmission Range:** Operates up to 328 feet (100 meters) between the sensor and receiver in open areas.
- **Solar Powered Sensor:** The sensor charges via an integrated solar panel, reducing the need for battery replacements. A DC5V adapter option is also available for charging.
- **Customizable Alerts:** Choose from 38 melodies and 3 adjustable volume levels.
- **Weatherproof Design:** Sensor is designed for outdoor use in various weather conditions.

SOLAR WIRELESS MOTION SENSOR



PIUG-IN ALARM RECEIVER

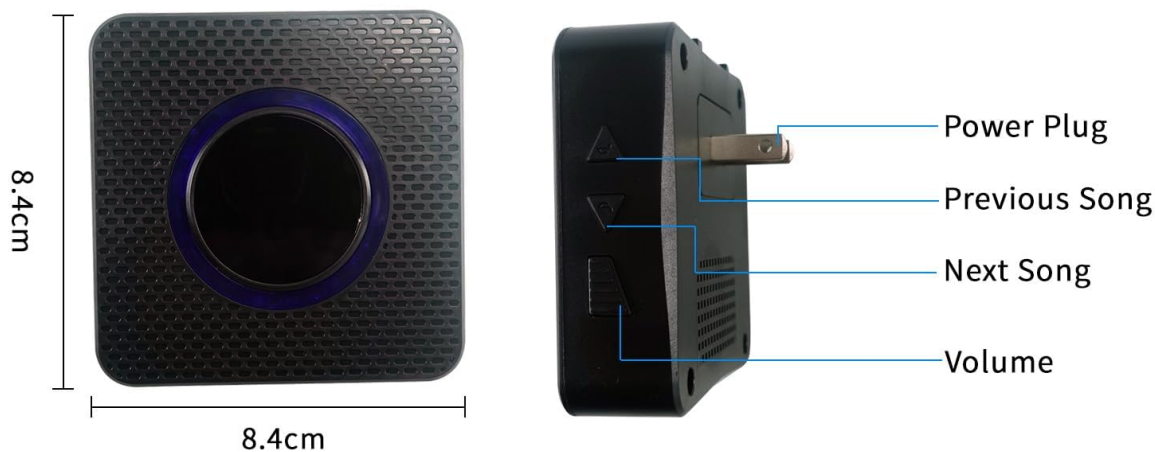

Image: Overview of the Solar Wireless Motion Sensor and Plug-in Alarm Receiver, highlighting the solar panel, ON/OFF switch, Type-C port on the sensor, and the power plug, song selection, and volume controls on the receiver. Dimensions are also indicated.

SETUP

1. Sensor Installation

- Choose Location:** Select a location for the motion sensor that provides an unobstructed view of the area you wish to monitor. Ensure the solar panel faces towards direct sunlight for optimal charging.
- Mounting:** Use the provided mounting hardware to securely attach the sensor to a wall, post, or other stable surface. The sensor is designed for wall mounting.
- Adjust Angle:** Adjust the sensor's angle to cover the desired detection zone. Avoid pointing it directly at moving objects like trees or busy roads to minimize false alarms.

Image: Guide for adjusting the solar sensor's tilt to modify its detection range, showing how a slight upward adjustment increases the sensing distance for vehicles.

LONG RANGE SOLAR WIRELESS DRIVEWAY ALARM SYSTEM

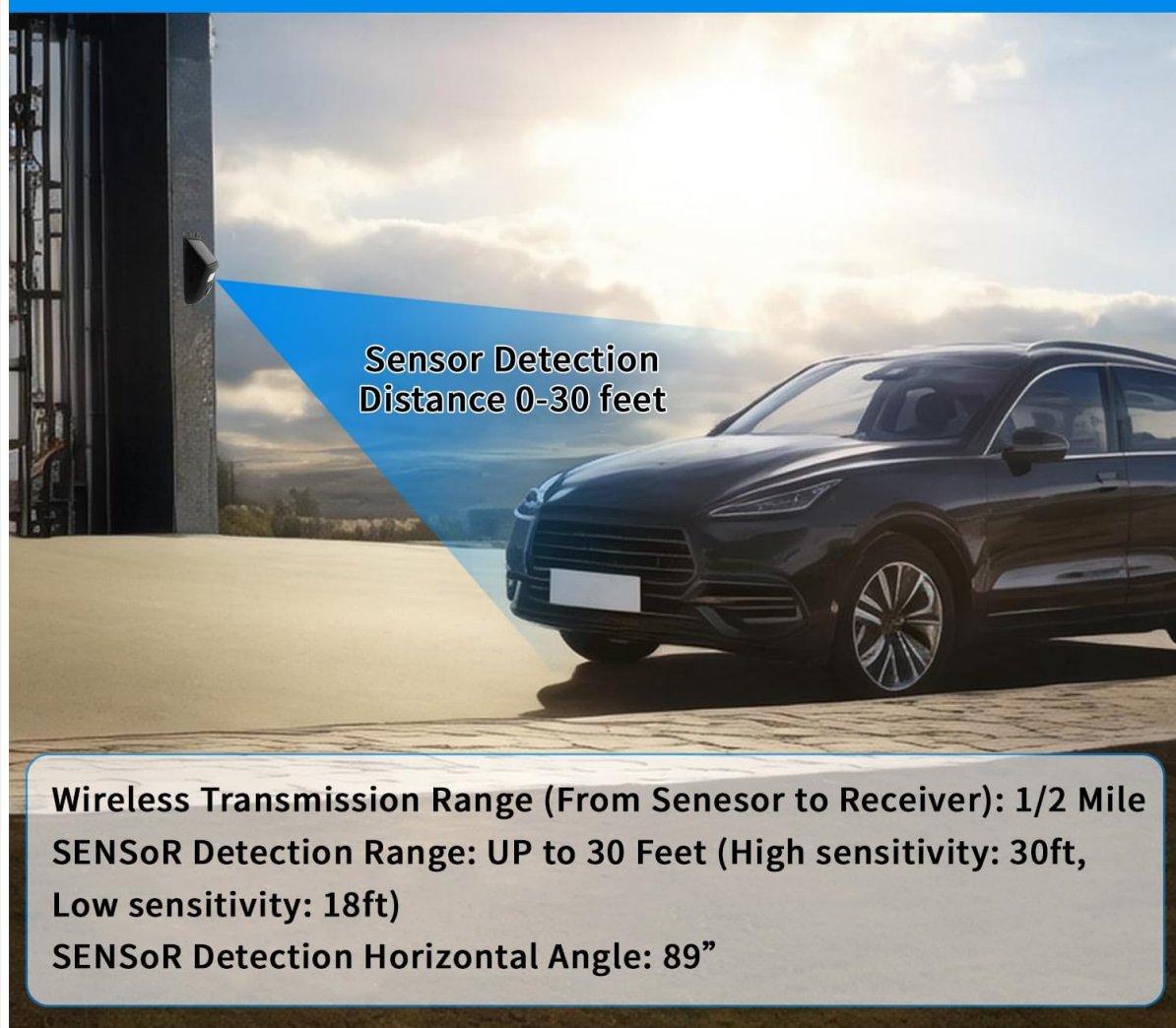

Image: Example of sensor placement for a driveway, indicating a sensor detection distance of up to 30 feet and a wireless transmission range of up to 1/2 mile.

2. Receiver Setup

Plug the alarm receiver into a standard electrical outlet inside your home or business. Ensure it is within the wireless transmission range of the sensor (up to 328 feet in open areas).

3. Sensitivity Adjustment

The sensor features three sensitivity settings to adjust the detection range and minimize false alarms:

- **Low Sensitivity:** Approximately 16 feet detection range.
- **High Sensitivity:** Approximately 52 feet detection range.

Adjust the sensitivity based on your environment to prevent triggers from small animals or environmental factors.

OPERATING INSTRUCTIONS

1. Adjusting Volume and Melodies

The receiver offers 38 optional melodies and 3 adjustable volume levels. Use the 'Previous Song', 'Next

Song', and 'Volume' buttons on the side of the receiver to customize your alert sound and loudness.



Image: The plug-in alarm receiver interface, detailing its features including adjustable volume, multiple melodies, and the option for sound with indicator light or indicator light only.

2. Silent Mode

The receiver can be set to operate in two modes:

- **Sound + Indicator Light:** The receiver will play a melody and illuminate an indicator light upon detection.
- **Indicator Light Only:** The receiver will only illuminate an indicator light, providing a silent alert.

Refer to the receiver's controls to switch between these modes.

MAINTENANCE

Solar Charging

Ensure the solar panel on the motion sensor remains clean and free from obstructions (e.g., leaves, dirt, snow) to allow for efficient charging. If the sensor is placed in an area with insufficient sunlight, it can also be charged via a DC5V adapter using the Type-C port.

Cleaning

Wipe the sensor and receiver with a soft, damp cloth. Do not use harsh chemicals or abrasive cleaners.

TROUBLESHOOTING

- **No Detection:**
 - Check if the sensor is powered on and fully charged. Ensure the solar panel receives adequate sunlight or charge via DC5V adapter.
 - Verify the sensor's angle and sensitivity settings. Increase sensitivity if necessary.
 - Ensure the sensor and receiver are within the maximum transmission range (328 feet) and there are no significant obstructions (thick walls, metal structures) between them.
- **False Alarms:**
 - Adjust the sensor's angle to avoid detecting unwanted movement (e.g., tree branches, passing traffic, small animals).
 - Decrease the sensitivity setting (to 16 feet) to reduce triggers from distant or minor movements.
 - Ensure the sensor is not exposed to direct sunlight changes or strong winds that might cause false triggers.
- **Receiver Not Responding:**
 - Ensure the receiver is properly plugged into a working power outlet.
 - Confirm the sensor is transmitting signals (check sensor indicator light if available).
 - Re-pair the sensor and receiver if connection issues persist (refer to pairing instructions, if provided separately).

SPECIFICATIONS

Brand	QUMOX
Model Number	B1197
Color	Black
Power Source (Sensor)	Solar Powered (Lithium Polymer battery included), DC5V adapter option
Maximum Transmission Range	328 Feet (100 meters)
Motion Detection Range	16 to 52 Feet (adjustable sensitivity)
Mounting Type	Wall Mount
Included Components	Detector, Receiver
Product Dimensions	6.4 x 4.2 x 3.75 inches
Item Weight	10.6 ounces

SAFETY INFORMATION

- Do not attempt to disassemble or repair the device yourself. Contact qualified personnel for service.
- Keep the receiver away from water and high humidity.
- Ensure the power outlet for the receiver is easily accessible.
- Dispose of batteries according to local regulations.

WARRANTY AND SUPPORT

Specific warranty details and customer support contact information are not provided in this manual. Please refer to the product packaging or the retailer's website for warranty claims and technical assistance.