

R-MUSIC RM484529

R-MUSIC Party Boost S High Power Speaker User Manual

Model: RM484529

INTRODUCTION

The R-MUSIC Party Boost S speaker is designed to provide an immersive audio experience, perfect for parties and events. This high-power speaker features Bluetooth 5.3 connectivity, dynamic RGB light effects, a dedicated karaoke mode, and an impressive battery life, combining robust performance with portable design.

This manual provides essential information for setting up, operating, and maintaining your Party Boost S speaker to ensure optimal performance and longevity.

WHAT'S IN THE BOX

Upon unboxing your R-MUSIC Party Boost S, please verify that all components are present:

- Party Boost S Speaker
- Wired Microphone
- Charging Cable
- Charger
- User Manual (this document)

PRODUCT OVERVIEW

Familiarize yourself with the key features and components of your Party Boost S speaker.



The R-MUSIC Party Boost S speaker, showcasing its integrated RGB lighting on the front grille and top control panel. The speaker is black with a textured finish on the sides and a convenient carry handle on top.

POIGNÉE INTÉGRÉE



A close-up view of the integrated handle located on the top of the Party Boost S speaker, designed for easy portability and transport.

PORTS USB, USB-C AUX, MICRO-SD



The connectivity panel of the Party Boost S speaker, featuring various input ports including USB, USB-C, AUX, and Micro-SD slots for versatile device connections.

ÉGALISEUR, RÉGLAGE VOLUME & ÉCHO



The top control panel of the Party Boost S speaker, showing buttons for equalizer settings, volume adjustment, and echo control, along with a digital display.

SETUP

Charging the Speaker

Before first use, fully charge the speaker. Connect the provided charging cable to the speaker's charging port and the other end to the charger. Plug the charger into a power outlet. The charging indicator will show the charging status. A full charge takes approximately 5 hours and provides up to 10 hours of continuous playback.

Initial Power On

Locate the power button on the speaker's control panel. Press and hold the power button for a few seconds until the speaker powers on and the LED lights illuminate.

OPERATING INSTRUCTIONS

Bluetooth Connection

1. Ensure the Party Boost S speaker is powered on.
2. Activate Bluetooth on your smartphone, tablet, PC, or laptop.
3. Search for "R-MUSIC Party Boost S" in your device's Bluetooth settings.
4. Select the speaker to pair. A confirmation sound will indicate a successful connection.
5. The speaker uses Bluetooth 5.3 for a stable connection up to 10 meters.

Using Other Connectivity Options

- **USB Port:** Insert a USB drive with audio files into the USB port. The speaker will automatically detect and play the music.
- **AUX Input:** Connect an external audio device (e.g., MP3 player) using a 3.5mm AUX cable to the AUX port.
- **Micro SD Card:** Insert a Micro SD card with audio files into the Micro SD slot.
- **6.35mm Jack:** This port is primarily for the wired microphone.

Karaoke Mode and Microphone Use

To use the karaoke feature:

1. Connect the wired microphone to the 6.35mm jack port on the speaker.
2. Play your desired instrumental track via Bluetooth or other input methods.
3. Adjust the microphone volume and echo effects using the controls on the speaker's top panel for an optimal karaoke experience.

MICRO INCLUS



The wired microphone included with the Party Boost S speaker, featuring an on/off switch and a standard audio jack for connection.

Sound Adjustment (Bass & Treble)

Use the dedicated controls on the speaker's top panel to adjust the bass and treble levels according to your audio preferences. This allows for fine-tuning the sound output for various music genres or environments.

RGB Light Effects

The speaker features integrated RGB light shows that synchronize with your music. Use the light mode button on the control panel to cycle through different light animations or turn them off.

7 ANIMATIONS LED



The Party Boost S speaker illuminated with vibrant RGB LED animations, showcasing its ability to create a dynamic visual experience synchronized with audio.

Multi-Speaker Connection

For an enhanced stereo experience, you can connect two Party Boost S speakers together. Refer to the specific instructions for TWS (True Wireless Stereo) pairing, usually initiated by a dedicated button or a long press on the Bluetooth button on both speakers. Ensure both speakers are in pairing mode before attempting to connect them to each other.

MAINTENANCE

- **Cleaning:** Use a soft, dry cloth to clean the speaker's exterior. Do not use abrasive cleaners, waxes, or solvents.
- **Storage:** When not in use for extended periods, store the speaker in a cool, dry place away from direct sunlight and extreme temperatures.
- **Battery Care:** To prolong battery life, avoid fully discharging the battery frequently. Charge the speaker regularly, even if not in use.

- **Water Resistance:** This speaker is not water-resistant. Avoid exposure to liquids.

TROUBLESHOOTING

Problem	Possible Cause	Solution
No power	Battery is depleted; Power cable not connected properly.	Charge the speaker fully; Ensure power cable is securely connected.
No sound	Volume is too low; Incorrect input source selected; Device not paired correctly.	Increase volume on speaker and connected device; Select correct input (Bluetooth, AUX, USB, SD); Re-pair Bluetooth device.
Bluetooth connection unstable	Device is out of range; Interference from other devices.	Move device closer to speaker (within 10m); Move speaker away from other wireless devices.
Microphone not working	Microphone not plugged in correctly; Microphone switch is off.	Ensure microphone is fully inserted into the 6.35mm jack; Turn on the microphone switch.

SPECIFICATIONS

Model Number	RM484529
Brand	R-MUSIC
Connectivity Type	Bluetooth 5.3
Audio Inputs	Bluetooth, USB, 6.35mm Jack, AUX, Micro SD
Frequency Response	20 Hz - 20 kHz
Battery Life	Up to 10 hours (3600mAh Lithium-ion)
Charging Time	Approx. 5 hours
Dimensions (L x W x H)	29 x 34 x 26 cm
Weight	3.95 kg
Color	Black
Compatible Devices	Smartphones, Tablets, PCs, Laptops
Special Features	Integrated RGB Lights, Karaoke Mode, Wired Microphone Included, Bass & Treble Adjustment, Multi-speaker Connection (TWS), Integrated Handle

WARRANTY AND SUPPORT

Manufacturer Warranty

The R-MUSIC Party Boost S speaker comes with a **2-year manufacturer's warranty** from the date of purchase. This warranty covers defects in materials and workmanship under normal use. It does not cover damage caused by misuse, accidents, unauthorized modifications, or normal wear and tear.

Please retain your proof of purchase for warranty claims.

Customer Support

For technical assistance, warranty claims, or any questions regarding your R-MUSIC Party Boost S speaker, please contact your retailer or the manufacturer's customer support. Refer to the product packaging or the retailer's website for contact information.

© 2024 R-MUSIC. All rights reserved.

Documents - R-MUSIC – RM484529

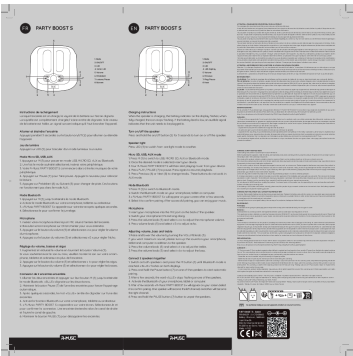

[\[pdf\]](#) Instructions

Notice Chloé Lasneau R MUSIC Party Boost S Enceinte High Power Bluetooth 5 3 Réglage des Graves et aigus Mode karaoké Microphone Filaire 10h d autonomie Amazon fr Informatique 91FW7DmrPSL m media amazon images I |||

PARTY BOOST S 5 1 blue 2 34 6 7 8 1. Mode 2. ON/OFF 3. LED 4. Ecran LED 5. Volume 6. Prcdent 7 ... spectifs. Mobility, 5 Avenue de Verdun, 94200 Ivry-sur-Seine, France 5 - 15 W PARTY BOOST S - BLACK **RM484529** - LN: CF2400662 Battery: lithium-ion, 3600mAh Input: 5V 2A Mobility, 5 Avenue de Verdun 942...

lang:fr **score:15** filesize: 734.16 K page_count: 2 document date: 2024-06-11