

Weofly OutFits

Weofly OutFits Open Ear Headphones User Manual

Model: OutFits

INTRODUCTION

Thank you for choosing the Weofly OutFits Open Ear Headphones. These wireless Bluetooth 5.4 earbuds are designed for comfort and performance, especially during sports and active use. They feature an open-ear design, IPX7 waterproofing, and clear call quality with ENC noise cancellation. This manual provides detailed instructions to help you get the most out of your new headphones.



Image: The Weofly OutFits Open Ear Headphones, black in color, shown with their charging case. The earbuds feature an ear-hook design and a sleek, modern appearance.

WHAT'S IN THE BOX

- Weofly OutFits Open Ear Earbuds (1 pair)
- Wireless Charging Case (1)
- User Manual (1)
- USB-C Charging Cable (1)



Image: A flat lay showing the Weofly OutFits packaging, the open ear headphones, the charging case, a user manual, and a USB-C charging cable.

PRODUCT FEATURES

- **Open-Ear Design:** Allows awareness of surroundings while listening to audio.
- **Comfortable Ear Hooks:** Soft, flexible, and secure fit for active use.
- **IPX7 Waterproof Rating:** Resistant to water splashes and sweat, suitable for sports.
- **18mm Dynamic Driver:** Delivers balanced audio with clear treble, deep bass, and crisp vocals.
- **ENC Noise Cancelling:** Enhances call clarity by filtering ambient noise.
- **Bluetooth 5.4 Technology:** Provides faster transmission speeds, stronger connection stability, and a longer range of up to 15 meters.
- **Long Battery Life:** Up to 6-10 hours of music playback per charge, with the charging case providing additional power.

SETUP

1. Charging the Headphones and Case

Before first use, fully charge the headphones and the charging case. Place the earbuds into the charging case. Connect the USB-C charging cable to the case and a power source. The indicator lights on the case will show the charging status.

- **Charging Time:** Approximately 2.5 hours for a full charge.
- **Battery Life:** 6-10 hours for music playback, 5 hours for calls. The charging case provides additional charges for extended use.



Image: The Weofly OutFits headphones inside their open charging case, with text indicating 30 hours standby time, 5.5 hours music playtime per charge, and 5 hours calling time per charge.

2. Pairing with Your Device

1. Ensure your device's Bluetooth is turned on.
2. Open the charging case and take out the earbuds. They will automatically enter pairing mode.
3. On your device, search for Bluetooth devices and select "OutFits" from the list.
4. Once connected, the earbuds will automatically pair with the last connected device when taken out of the case.

Bluetooth 5.4 Connection



20% Faster
Transmission



Lower
Energy



Lower
latency



Image: A visual representation of the Bluetooth 5.4 connection technology within the earbuds, highlighting benefits such as 20% faster transmission, lower energy consumption, and lower latency.

OPERATING INSTRUCTIONS

Wearing the Headphones

For optimal sound and comfort, follow these steps to wear your OutFits headphones:

1. Take out the earphones from the charging case.
2. Hang the end of the earphones over your ear bone.
3. Turn the earphones and slide them behind your ear.
4. Adjust the ear hook for a secure and comfortable fit.

How to wear?



1 Take it out earphones;



2 Hang the end of the earphones on the ear bone.



3 Turn the earphones and slide it behind the ear.



4 Adjust ear hook, wear and pull down ear hook for secure fit.

Image: A four-panel diagram illustrating the correct method for wearing the open ear headphones, showing how to position the ear hook and adjust for a secure fit.

Basic Controls

The OutFits headphones feature touch controls for various functions:

- **Play/Pause:** Single tap on either earbud.
- **Next Track:** Double tap on the right earbud.
- **Previous Track:** Double tap on the left earbud.
- **Answer/End Call:** Single tap on either earbud.
- **Reject Call:** Press and hold either earbud.
- **Volume Control:** Some models may support continuous press on one side for volume adjustment. Refer to the specific manual for your model if this feature is desired.

MAINTENANCE

Cleaning

To ensure longevity and optimal performance:

- After exercise, wipe the metal parts of the headphones with a dry cloth to prevent corrosion from sweat.
- Clean the earbuds and charging case regularly with a soft, dry cloth.
- Avoid using abrasive cleaners or solvents.

Water Resistance (IPX7)

The headphones are IPX7 waterproof, meaning they can withstand splashes, rain, and sweat. They are not designed for submersion in water. Ensure the charging port is dry before charging.

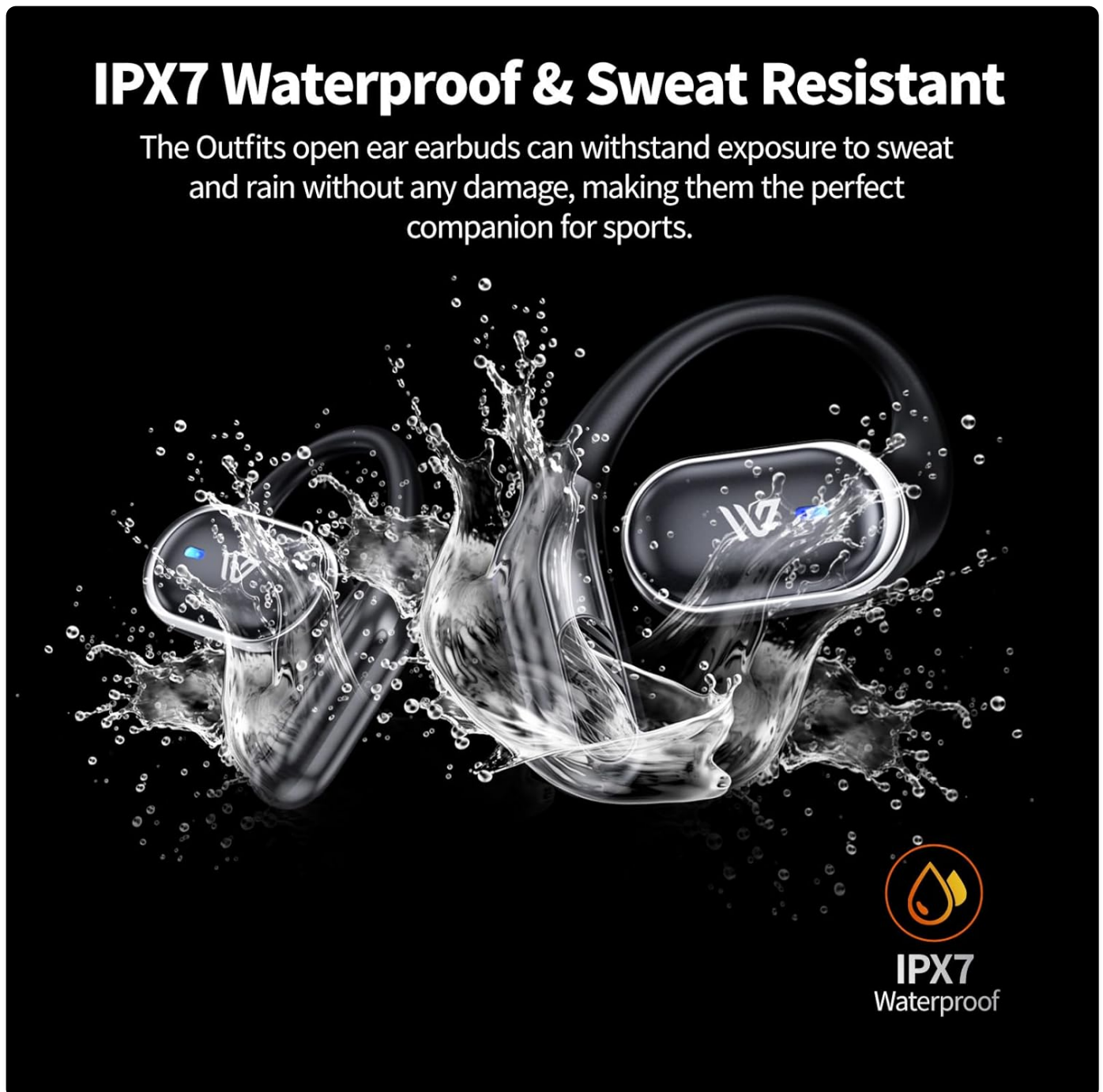

Image: The Weofly OutFits open ear headphones shown with water splashing around them, emphasizing their IPX7 waterproof and sweat-resistant capabilities.

TROUBLESHOOTING

Problem	Solution
---------	----------

Problem	Solution
Headphones not pairing.	Ensure Bluetooth is enabled on your device. Make sure the earbuds are charged. Place earbuds back in the case, close, then reopen to re-enter pairing mode. Forget "OutFits" from your device's Bluetooth list and try pairing again.
No sound or low volume.	Check the volume level on both your device and the headphones. Ensure the headphones are properly connected to your device. Reposition the earbuds on your ears for optimal sound delivery.
Earbuds not turning off when removed from case.	The earbuds are designed to automatically turn off when placed back into the charging case and the lid is closed. If they remain on, ensure they are correctly seated in the case and the case has power.
Touch controls are unresponsive or overly sensitive.	Ensure your fingers are clean and dry when using touch controls. Try restarting the earbuds by placing them in the case and taking them out again.

SPECIFICATIONS

Feature	Detail
Model Name	OutFits
Brand	Weofly
Connectivity Technology	Wireless (Bluetooth 5.4)
Bluetooth Range	Up to 15 meters
Audio Driver Type	18mm Dynamic Driver
Noise Control	Active Noise Cancellation (for calls)
Water Resistance Level	IPX7 Waterproof
Battery Life (Music Playback)	6-10 hours (earbuds)
Battery Life (Call Time)	5 hours (earbuds)
Charging Time	2.5 hours
Item Weight	5.3 ounces
Package Dimensions	5 x 4.29 x 1.93 inches
Included Components	Open Ear Earbuds, User Manual, Wireless Charging Case, USB-C Charging Cable

WARRANTY AND SUPPORT







For warranty information and customer support, please refer to the contact details provided in the packaging or visit the official Weofly website. Keep your purchase receipt for warranty claims.

Your browser does not support the video tag.

Video: A brief overview of the Weofly OutFits Open Ear Headphones, showcasing their design, key features, and how they are used. This video highlights the product's comfort, sound quality, and suitability for active lifestyles.

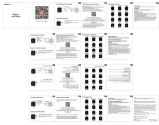
© 2024 Weofly. All rights reserved.

Related Documents - OutFits

	<p>WEOFLY OutFits User Manual</p> <p>User manual for WEOFLY OutFits earbuds, covering connection, operation, problem handling, and safety instructions.</p>
	<p>WEOFLY Power 2 Akıllı Saat Kullanım Kılavuzu</p> <p>Bu kullanım kılavuzu, WEOFLY Power 2 akıllı saatinizin temel girişini, operasyonunu, uygulama kurulumunu, temel fonksiyonlarını ve dikkat edilmesi gerekenleri ayrıntılı olarak açıklar. Cihazınızı en iyi şekilde kullanmanıza yardımcı olacak bilgiler içerir.</p>
	<p>Weofly Edge 2 Smart Watch User Manual</p> <p>Comprehensive user manual for the Weofly Edge 2 Smart Watch, covering basic introduction, APP download and installation, and detailed product functions. Includes instructions in multiple languages.</p>
	<p>Weofly Explorer Smartwatch User Manual</p> <p>Comprehensive user guide for the Weofly Explorer Smartwatch, covering setup, features, operation, and important safety information.</p>
	<p>Weofly Energy 2 Smartwatch User Manual - Features, Setup, and Operation</p> <p>Comprehensive user manual for the Weofly Energy 2 smartwatch. Learn about its basic functions, app connection, additional features like heart rate monitoring, sleep tracking, sport modes, and important usage precautions.</p>
	<p>WEOFLY OutFits User Manual</p> <p>User manual for WEOFLY OutFits earbuds, covering connection, operation, problem handling, and safety instructions.</p>

Shenzhen Weofly Innovation Technology Co.,LTD

Federal Communications Commission
Authorization and Evaluation Division
Equipment Authorization Branch
7435 Oakland Mills Road
Columbia, MD 21046

09/08/24

U.S. Agent Designation

Shenzhen Weofly Innovation Technology Co.,LTD acknowledges their consent for the following
covered equipment to be placed in the United States to act as their agent for service of process for the equipment for
which authorization is sought (FCC ID:2BF3T-OUTFITS).

Applicant:Shenzhen Weofly Innovation Technology Co.,LTD

Company name:Shenzhen Weofly Innovation Technology Co.,LTD

Product Description:Earbuds

Device code:2BF3T

FCC ID:2BF3T-OUTFITS

FRN:000336114

Contact Name:Meng Li

Address:Factory Building 001-11,Nanshan Second Industrial Zone,Nanshan Community, Baotian
Street, Longgang District, Shenzhen, China

Telephone No:18602000095

Email:poor18310@poor-aet.com

Name and company of U.S. agent: REP America LLC

Physical U.S. address of agent: REP America LLC, 1942 Broadway St, STE 314C Boulder,
CO 80502 United States

FRN of U.S. agent: 003410200

Email address of U.S. agent: c.meng@rep-america.de

REP America LLC acknowledges their obligation to accept service of process on behalf of the Applicant.

The Applicant accepts its obligation to maintain an agent for service of process in the United States for no less
than one year after the grantee has permanently terminated all marketing and importation of the applicable
equipment within the U.S., or the conclusion of any Commission-related administrative or judicial proceeding
involving the equipment, whichever is later.

By signing this form, we confirm the above and that we are aware of the application requirements listed under §
2.101(a)(7).

U.S. agent:
Signature: 
Name: Meng Li
Title: Manager
Company: REP America LLC

Applicant:
Signature: 
Name: Meng Li
Title: Manager
Date: 2024/06/03

The information provided in this letter is based on the information submitted by the applicant on or before 08/08/2024 00:01.
The expiration date for this letter does not exist. In order for U.S. agent design, the grantee is obligated to notify the FCC.

[pdf]

COMPANY LETTERHEAD Baschin section 2 911 d 7 filing Shenzhen Weofly Innovation Technology Co
LTD OUTFITS 2BF3T 2BF3TOUTFITS outfits
Shenzhen Weofly Innovation Technology Co.,LTD Federal Communications
Commission Authorization and E ... heir agent for service of process for the
equipment for which authorization is sought FCC ID:2BF3T-**OUTFITS** :
Applicant:Shenzhen Weofly Innovation Technology Co.,LTD Company
name:Shenzhen Weofly Innov...
lang:en score:31 filesize: 1.14 M page_count: 1 document date: 2024-08-09

Shenzhen Weofly Innovation Technology Co.,LTD

Covered Equipment Certification Attestation Letter

DATE

Federal Communications Commission
Authorization and Evaluation Division
7435 Oakland Mills Road
Columbia, MD 21046
USA

ATTN: Reviewing Engineer

FCC ID:2BF3T-OUTFITS

Shenzhen Weofly Innovation Technology Co.,LTD ("the applicant") certifies that the
equipment for which authorization is sought is not "covered" equipment prohibited from
receiving an equipment authorization pursuant to section 2.903 of the FCC rules.

Note: If the equipment for which the applicant seeks authorization is produced by
any of the entities identified on the current [Covered List](#), the applicant should
include an explanation on why the equipment is not "covered" equipment.

Shenzhen Weofly Innovation Technology Co.,LTD("the applicant") certifies that, as of the
date of the filing of the application, the applicant is not identified on the Covered List as
an entity producing "covered" equipment.

Signed: 

Name: Meng Li

Title: manager

Company: Shenzhen Weofly Innovation Technology Co., LTD

Date: 2024/8/9

[pdf]

PROJECT NO Debbie Bedard section 2 911 d 5 i ii filing Shenzhen Weofly Innovation Technology Co
LTD OUTFITS 2BF3T 2BF3TOUTFITS outfits
Shenzhen Weofly Innovation Technology Co.,LTD Covered Equipment Certification
Attestation Letter DATE Federal Communications Commission Authorization and
Evaluation Division 7435 Oakland Mills Road Columbia, MD 21046 USA ATTN.:
Reviewing Engineer FCC ID:2BF3T-**OUTFITS** Shenzhen Weofly Innovation Techn...
lang:en score:30 filesize: 121.55 K page_count: 1 document date: 2024-08-09

Earbuds

3BF T-0 TTITS

Outfits

We declare that this product has left and right headphone components, and the left
and right headphones are electrically identical (BOM, PCB), so they can share the
same FCC ID.

<Signature> 

Name: meng

Title: manager

Company:

[pdf]

Windows Cover Letter Shenzhen Weofly Innovation Technology Co LTD OUTFITS 2BF3T
2BF3TOUTFITS outfits
Product: Earbuds FCC ID: 2BF3T-**OUTFITS** Model: OutFits We declare that this
product has left and right headphone components, and the left and right headphones
are electrically identical BOM, PCB , so they can share the same FCC ID. Signature
Name:Meng Li Title:manager Company:Shenzhen Weofly Innov...
lang:en score:30 filesize: 545.86 K page_count: 1 document date: 2024-08-09



[pdf] Confidentiality Request Letter

Authority to Act as Agent a TCB RUBY DULMAGE Confidential Letter Shenzhen Weofly Innovation Technology Co LTD OUTFITS Earbuds 2BF3T 2BF3TOUTFITS outfits
DATE:2024/8/9 Equipment Autorisation Division Federal Communications Commission 7435 Oakland Mills Road Columbia, MD 21046 FCC ID:2BF3T-**OUTFITS**
Product Name:Earbuds Request for Confidentiality Pursuant to Sections 0.457 and 0.459 of the commission s rules, we hereby request that the following docume...
lang:en score:28 filesize: 140.66 K page_count: 1 document date: 2024-08-09

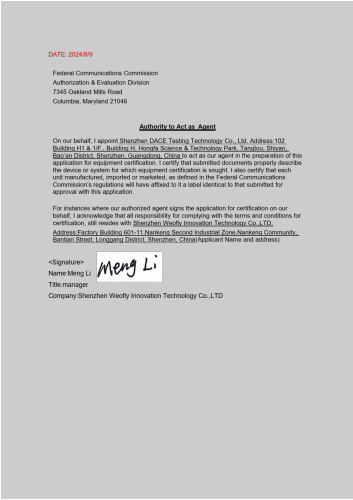

[pdf] Label Agent Authorization

2 FCC to Act as Agent TCB qua stanleyye Authorization Letter form Shenzhen Weofly Innovation Technology Co LTD OUTFITS Earbuds 2BF3T 2BF3TOUTFITS outfits
DATE: 2024/8/9 Federal Communications Commission Authorization Evaluation Division 7345 Oakland Mills Road Columbia, Maryland 21046 Authority to Act as Agent On our behalf, I appoint Shenzhen DACE Testing Technology Co., Ltd.
Address:102 Building H1 1/F., Building H, Hongfa Science Technology ...
lang:en score:25 filesize: 141.61 K page_count: 1 document date: 2024-08-09



[pdf] User Manual

OutFits DownloadWeofly User Manual Download Weofly GlobalOutFits Russiacdn shopify s files 1 0880 2153 2968 Russia v 1739961277 |||
...
lang:en score:21 filesize: 984.94 K page_count: 1 document date: 2025-02-19

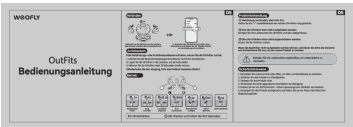

[pdf] User Manual

OutFits DownloadWeofly User Manual Download Weofly GlobalOutFits Germancdn shopify s files 1 0880 2153 2968 German v 1739961279 |||
...
lang:en score:21 filesize: 1.09 M page_count: 1 document date: 2025-02-19

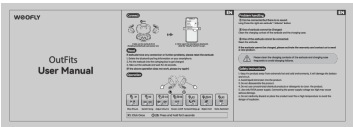

[pdf] User Manual

OutFits DownloadWeofly User Manual Download Weofly GlobalOutFits Englishcdn shopify s files 1 0880 2153 2968 English v 1739961278 |||
...
lang:en score:21 filesize: 1.02 M page_count: 1 document date: 2025-02-19

WEOFLY OutFits User Manual



User manual for WEOFLY OutFits earbuds, covering connection, operation, problem handling, and safety instructions.
lang:en score:20 filesize: 4.54 M page_count: 1 document date: 2024-06-25



[\[pdf\]](#) User Manual

OutFits DownloadWeofly User Manual Download Weofly GlobalOutFits Polandcdn shopify s files 1
0880 2153 2968 Poland v 1739961279 |||

...

lang:en **score:20** filesize: 1.05 M page_count: 1 document date: 2025-02-19

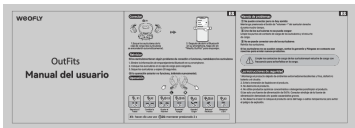

[\[pdf\]](#) User Manual

OutFits DownloadWeofly User Manual Download Weofly GlobalOutFits Spaincdn shopify s files 1
0880 2153 2968 Spain v 1739961280 |||

...

lang:en **score:20** filesize: 1.18 M page_count: 1 document date: 2025-02-19



[\[pdf\]](#) User Manual

OutFits DownloadWeofly User Manual Download Weofly GlobalOutFits Arabiacdn shopify s files 1
0880 2153 2968 Arabia v 1739961281 |||

...

lang:en **score:20** filesize: 1.33 M page_count: 1 document date: 2025-02-19

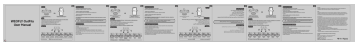

[\[pdf\]](#) User Manual

Weofly OutFits Earbuds User Manual 24 anp 2025 r — Long Press the right ear earbuds Volume button 2
One of cannot be Consult dealer or an experienced radio TV technician for help sluchawki weofly outfits
czarne instrukcja obsługi maxelektro pl storage file pimcore import 4
18c564ccc9df428f15c777ead613dd56 |||

...

lang:en **score:19** filesize: 1.7 M page_count: 1 document date: 2024-07-22



[\[pdf\]](#) Product Photos

TST External Photo Shenzhen Weofly Innovation Technology Co LTD OUTFITS 2BF3T 2BF3TOUTFITS
outfits
FCC ID:2BF3T-**OUTFITS** External FCC ID:2BF3T-**OUTFITS** FCC ID:2BF3T-**OUTFITS**
FCC ID:2BF3T-**OUTFITS** FCC ID:2BF3T-**OUTFITS** ...
lang:en **score:19** filesize: 799.62 K page_count: 5 document date: 2024-08-09

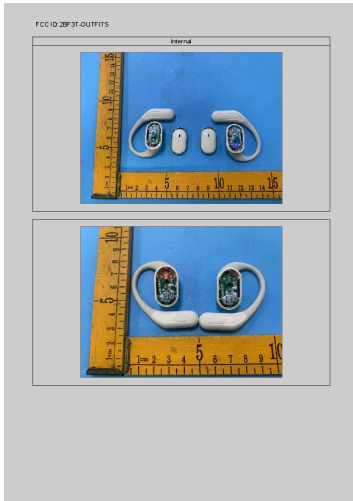

[\[pdf\]](#) Product Photos Teardown

Internal Photo Shenzhen Weofly Innovation Technology Co LTD OUTFITS 2BF3T 2BF3TOUTFITS outfits
FCC ID:2BF3T-**OUTFITS** Internal FCC ID:2BF3T-**OUTFITS** ANT FCC
ID:2BF3T-**OUTFITS** ...

lang:en **score:19** filesize: 661 K page_count: 3 document date: 2024-08-15



[\[pdf\]](#) Product Photos

TST Test Setup Photo Shenzhen Weofly Innovation Technology Co LTD OUTFITS 2BF3T
2BF3TOUTFITS outfits

FCC ID:2BF3T-**OUTFITS** Conducted Emission at AC power line Emissions in
frequency bands below 1GHz FCC ID:2BF3T-**OUTFITS** Emissions in frequency
bands above 1GHz ...

lang:en **score:19** filesize: 295.8 K page_count: 2 document date: 2024-08-09

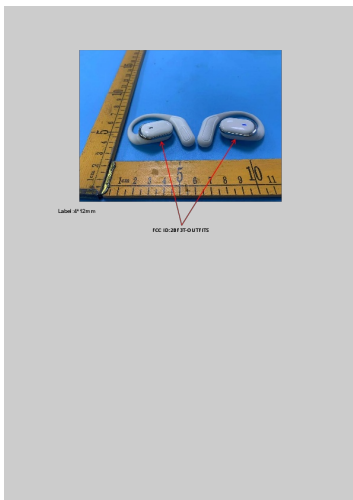

[\[pdf\]](#) Label

Administrator Label Shenzhen Weofly Innovation Technology Co LTD OUTFITS 2BF3T 2BF3TOUTFITS
outfits

Label:4*12mm FCC ID:2BF3T-**OUTFITS** ...

lang:en **score:19** filesize: 125.04 K page_count: 1 document date: 2024-08-09

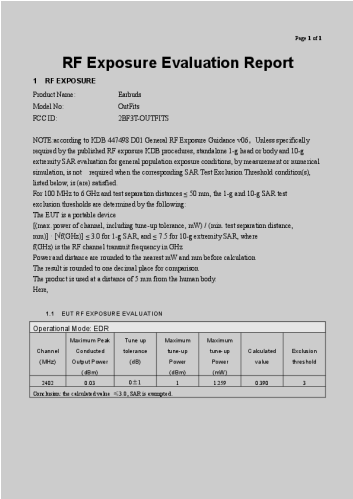

[pdf] Test Report SAR Rating

EMC COMPLIANCE TEST REPORT Simon RF Exposure Info Shenzhen Weofly Innovation Technology Co LTD OUTFITS 2BF3T 2BF3TOUTFITS outfits

Page 1 of 1 RF Exposure Evaluation Report 1 RF EXPOSURE Product Name: Model No: FCC ID: Earbuds OutFits 2BF3T-OUTFITS NOTE:according to KDB 447498 D01 General RF Exposure Guidance v06Unless specifically required by the published RF exposure KDB procedures, standalone 1-g head or body and 10-g e... lang:en score:18 filesize: 132.02 K page_count: 1 document date: 2024-08-09

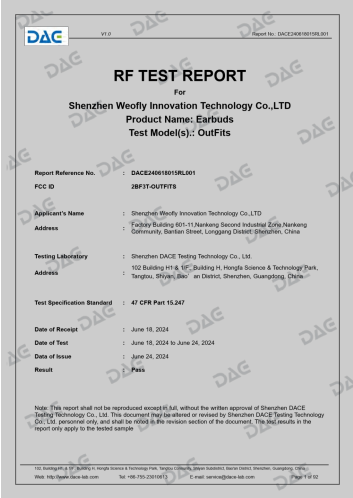

[pdf] Test Report

Hank Yan Test Report Shenzhen Weofly Innovation Technology Co LTD OUTFITS 2BF3T 2BF3TOUTFITS outfits

... lang:en score:13 filesize: 5.16 M page_count: 92 document date: 2024-08-09



[pdf]

OutFits WeOfLY 5 Używaj tylko zasilacza 5V 1A Zbyt wysokie napięcie zasilania może spowodować poważne uszkodzenia 6 Nie wyrzucaj produktu przypadkowo ani nie umieszczaj instrukcja obsługi WEOFLY mediaexpert pl products files 77 7714597 |||

... lang:en score:12 filesize: 1.05 M page_count: 1 document date: 2025-02-19