

[Manuals.plus](#) /

> [FFJ](#) /

> FFJ Elite10 Wireless Gaming Mouse User Manual

FFJ Elite10

FFJ Elite10 Wireless Gaming Mouse User Manual

Model: Elite10 | Brand: FFJ

INTRODUCTION

The FFJ Elite10 Wireless Gaming Mouse is designed for precision and versatility, offering multiple connectivity options and customizable features for an enhanced user experience. This manual provides detailed instructions for setup, operation, maintenance, and troubleshooting to ensure optimal performance of your device.

WHAT'S IN THE BOX

- 1 x FFJ Elite10 Wireless Gaming Mouse
- 1 x Power Cable (USB Type-C)
- 1 x User Manual



Image: The FFJ Elite10 Wireless Gaming Mouse shown with its USB receiver.

SETUP

Charging the Mouse

Before first use, fully charge the mouse using the provided USB Type-C cable. Connect the cable to the Type-C charging port on the mouse and to a USB power source. A full charge takes approximately 1.5 hours and provides up to 75 hours of battery life.

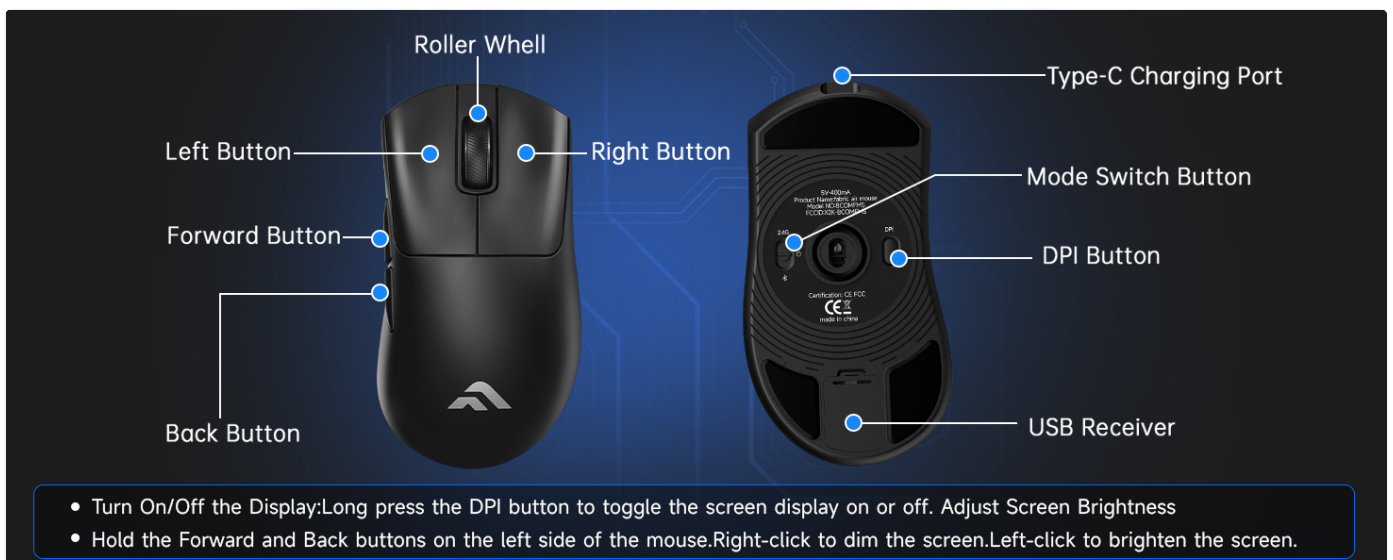

Image: An illustration demonstrating the mouse's 75-hour battery life after a 1.5-hour charge.

Connecting the Mouse

The FFJ Elite10 mouse supports three connection modes: 2.4GHz Wireless, Bluetooth, and Wired.

1. 2.4GHz Wireless Mode:

Locate the USB receiver on the underside of the mouse. Plug the USB receiver into an available USB port on your

computer. Slide the mode switch button on the bottom of the mouse to the "2.4G" position. The mouse should connect automatically.

2. Bluetooth Mode:

Slide the mode switch button on the bottom of the mouse to the "BT" position. On your device (PC, laptop, tablet, etc.), go to Bluetooth settings and search for new devices. Select "FFJ Elite10" from the list to pair. If you need to reset Bluetooth connection, ensure the switch is on BT mode, then press and hold the left click, right click, and middle click buttons simultaneously.

3. Wired Mode:

Connect the USB Type-C cable to the mouse and the other end to a USB port on your computer. The mouse will function as a wired mouse and charge simultaneously. The position of the mode switch does not affect wired operation.



Image: Visual representation of the mouse's triple-mode connectivity options.

OPERATING INSTRUCTIONS

Real-Time Display

The mouse features a real-time display on its side, showing current DPI settings, battery level, and connection type. This allows for quick monitoring and adjustments without interrupting your workflow or game.

- To turn the display on/off: Long press the DPI button.
- To adjust screen brightness: Hold the Forward and Back buttons on the left side of the mouse simultaneously. Then, use the Left-click to brighten the screen or Right-click to dim the screen.

Unique Display for Status & Settings

Say goodbye to the traditional mouse and start a new experience



Connection Method



DPI Display



Current Battery Level

Image: The unique side display of the mouse, indicating connection method, DPI, and battery level.

DPI Adjustment

The mouse offers adjustable DPI levels for precise control. You can adjust DPI from 400 to 10,000 using the mouse buttons, and up to 26,000 via the Elite10 software.

8 Adjustable & Customizable DPL Levels

You can adjust the DPI from 400 to 10,000 with the mouse buttons, and up to 26,000 via our driver.



Image: A visual guide to the 8 adjustable and customizable DPI levels.

Programmable Buttons

The mouse features 6 programmable buttons, allowing you to customize functions via the Elite10 software to suit your specific needs for gaming or productivity.

6 Programmable Buttons

Easily tailor your personal mouse to your needs



Image: The Elite10 software interface for customizing the 6 programmable buttons.

MAINTENANCE

- **Cleaning:** Use a soft, dry cloth to clean the mouse. Avoid using harsh chemicals or abrasive materials.
- **Storage:** Store the mouse in a cool, dry place away from direct sunlight and extreme temperatures.
- **Battery Care:** To prolong battery life, avoid fully discharging the mouse frequently. Recharge when the battery level is low.

TROUBLESHOOTING

Problem	Possible Cause / Solution
---------	---------------------------

Problem	Possible Cause / Solution
Mouse not responding	<p>Ensure the mouse is charged.</p> <p>Check the connection mode switch (2.4G, BT, Wired) is in the correct position.</p> <p>For 2.4GHz: Ensure the USB receiver is securely plugged in.</p> <p>For Bluetooth: Ensure Bluetooth is enabled on your device and the mouse is paired. Try resetting Bluetooth connection (Left click + Right click + Middle click simultaneously in BT mode).</p> <p>For Wired: Ensure the USB-C cable is securely connected.</p>
DPI display not working	<p>Long press the DPI button to toggle the display on/off.</p>
Short battery life	<p>Ensure the mouse is fully charged (1.5 hours for 75 hours of use).</p> <p>Turn off the side display when not needed (long press DPI button).</p> <p>Consider using Bluetooth mode, which may consume less power than 2.4GHz wireless.</p>
Double-click issues	<p>The mouse is designed for 80 million click durability. If issues persist, contact customer support.</p>

SPECIFICATIONS

Feature	Detail
Model Number	Elite10
DPI Range	400 - 26,000 DPI (Adjustable)
Polling Rate	1000Hz
Connectivity	2.4GHz Wireless, Bluetooth 5.1, Wired (USB Type-C)
Buttons	6 Programmable Buttons
Click Durability	80 Million Clicks
Weight	62g (Ultra-Lightweight)
Battery Life	Up to 75 hours (single charge)
Charging Time	Approx. 1.5 hours
Movement Detection	Optical (PAW3395 Sensor)
Dimensions	4.78 x 2.54 x 0.1 inches
Item Weight	2 ounces

COMPATIBILITY

The FFJ Elite10 Wireless Gaming Mouse is widely compatible with various operating systems and devices, including:

- Windows 7/8/10/11/XP98/2000/ME/NT, Vista 7/8/10
- Mac OS, iPadOS
- Android, Linux

- Compatible with PC, desktops, laptops, MacBooks, PS4, PS5, XBOX, and mobile phones.



Image: The mouse is compatible with a wide range of operating systems and devices.

WARRANTY AND SUPPORT

FFJ is committed to providing high-quality products and excellent customer service. While specific warranty details are not provided in this manual, FFJ has a professional technical and service support team available to assist you with any questions or issues regarding your Elite10 Wireless Gaming Mouse.

For support, please refer to the contact information provided on the product packaging or the official FFJ website.

