

KOBANOICA 0d0f80b4-31d8-48fb-a15b-6b9b8c3b7a0e

KOBANOICA Car Stereo Radio User Manual

For Dodge RAM 1500 2500 3500 (2013-2018) with Automatic AC

PRODUCT OVERVIEW

The KOBANOICA Car Stereo Radio is an advanced in-dash navigation system designed specifically for Dodge RAM 1500, 2500, and 3500 models from 2013 to 2018, compatible only with vehicles equipped with Automatic AC. This 9-inch touch screen unit enhances your driving experience with modern connectivity and entertainment features.

Key features include:

- **Wireless Apple CarPlay & Android Auto:** Seamlessly integrate your smartphone for navigation, calls, and music.
- **GPS Navigation & WiFi Connectivity:** Access offline and online maps, and download apps like YouTube and Facebook.
- **Bluetooth Hands-free & FM/AM Radio:** Enjoy safe voice-controlled calls and a wide range of radio stations.
- **Android 13 System:** Powered by 2GB RAM and 32GB ROM for smooth operation and quick responses.
- **EQ Adjust:** Customize audio settings for a superior music listening experience.



Figure 1: KOBANOICA Car Stereo Radio Main Unit

This image shows the front view of the KOBANOICA car stereo unit, featuring its large 9-inch touchscreen display. The screen is active, showing a user interface with various application icons, including Phone, Maps, Messages, Spotify, Music, Settings, Calendar, and Podcasts, indicating its smart functionality. Below the screen, the unit incorporates controls for the vehicle's automatic AC system, designed to integrate seamlessly into the Dodge RAM dashboard.

WHAT'S IN THE BOX

Upon opening the package, verify that all the following components are included:

- Dash Kit
- Car Stereo Radio Unit
- Microphone
- GPS Module
- Reversing Line

- USB Cable (x2)
- USB Adaptor
- Antenna Adapter Cable
- Installation Cables and Tools (Screws, Screwdriver, Crowbar)
- Can Bus
- Power Cable
- RCA Cable



Figure 2: Included Components and Wiring Diagram

This image provides a visual representation of all items included in the product package, laid out neatly around the main car stereo unit. It also features a detailed wiring diagram on the left, illustrating the various connections such as GND, ACC, ILL, BACK, KEY1, KEY2, ANT-12V, FR+, FR-, FL+, FL-, and RCA inputs/outputs, along with numbered labels for each accessory, aiding in identification and installation.

INSTALLATION GUIDE

This car stereo is designed for a plug-and-play installation in compatible Dodge RAM models (2013-2018 with Automatic AC). While the wiring harness is designed for ease of use, professional installation is recommended if you are unfamiliar with car audio systems.

Compatibility Check

Ensure your vehicle is a Dodge Ram 1500, 2500, or 3500 manufactured between 2013 and 2018, and that it has an Automatic AC system. This unit is not compatible with manual AC systems.



Figure 3: Before and After Installation Comparison

This image visually demonstrates the transformation of the Dodge RAM's center console. The left side shows the original factory radio and AC controls, marked with a red 'X' to indicate incompatibility or replacement. The right side, marked with a green checkmark, displays the KOBANOICA car stereo unit perfectly fitted into the dashboard, highlighting its integrated appearance and larger screen after successful installation. It also explicitly states "Compatible with Dodge Ram 2013-2018 (Automatic AC)".

Installation Steps (General)

1. Carefully remove the existing factory radio and bezel from your vehicle's dashboard.
2. Connect the provided wiring harness to the vehicle's existing connectors and to the new KOBANOICA unit. Refer to Figure 2 for the wiring diagram.

3. Install the GPS module and microphone in suitable locations within the vehicle.
4. Mount the new car stereo unit into the dashboard opening.
5. Reassemble the dashboard components.

Important Note on AC Buttons

Some users have reported that the silver trim pieces around the AC buttons on the new unit may cause them to stick. If this occurs, you may carefully remove the silver bevels and swap them with the chrome bevels from your original factory faceplate. Use super glue for secure reattachment if necessary. This step can improve button functionality and aesthetic integration.

OPERATING INSTRUCTIONS

Wireless Apple CarPlay & Android Auto

Connect your smartphone wirelessly via Wi-Fi and Bluetooth to access Apple CarPlay or Android Auto. This allows you to use your phone's navigation, make calls, send messages, and play music directly through the car stereo's display, minimizing distractions while driving.

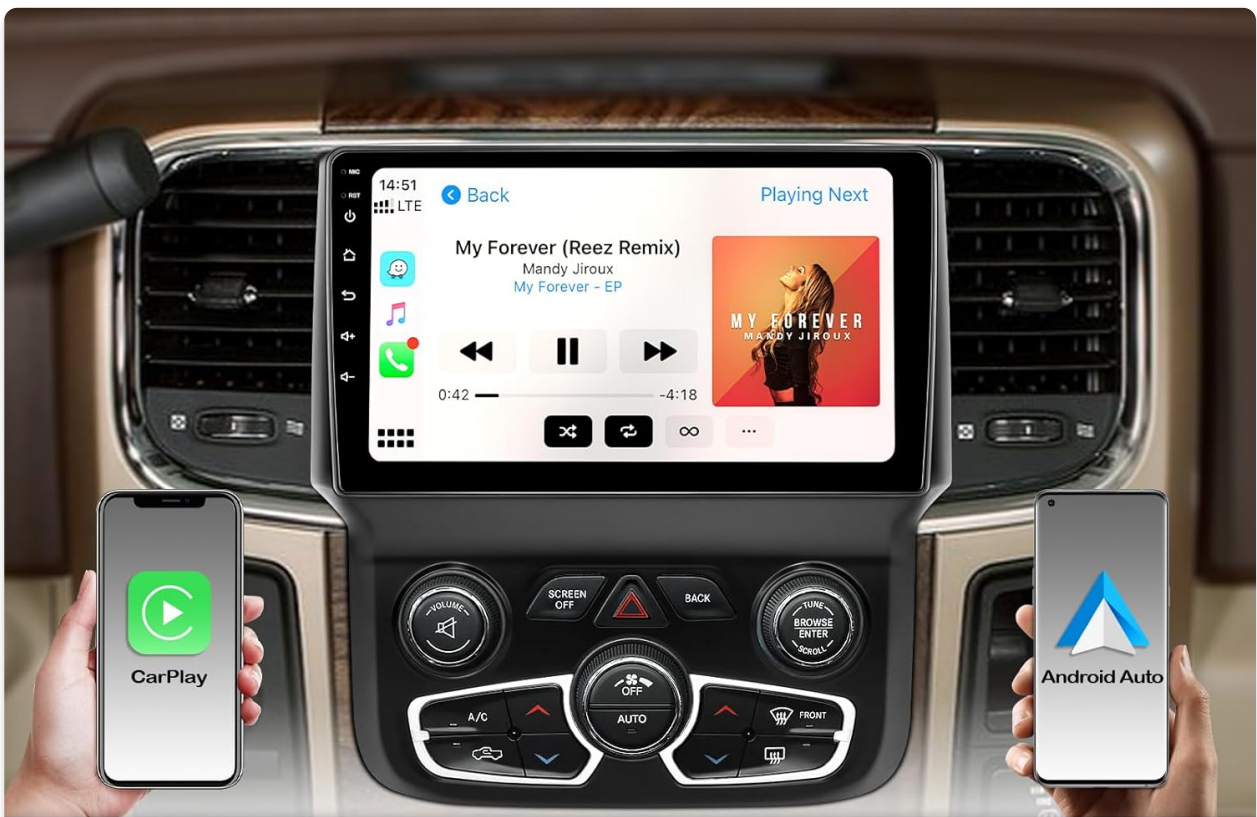

Figure 4: Wireless Apple CarPlay and Android Auto

This image illustrates the seamless integration of smartphones with the car stereo. It shows a phone on the left with the CarPlay logo and a phone on the right with the Android Auto logo, both wirelessly connected to the car's main display. The car's screen simultaneously shows the CarPlay interface on the left and the Android Auto interface on the right, demonstrating the unit's compatibility with both systems for navigation, music, and communication.

GPS Navigation & WiFi Connection

The unit comes with built-in offline maps and supports online GPS navigation when connected to Wi-Fi. You can connect to a mobile hotspot or a Wi-Fi network to download and install various applications from the app store, such as YouTube, Facebook, and additional mapping services.



Figure 5: Online/Offline Navigation and Steering Wheel Controls

This image highlights two key functionalities. The top portion shows the car stereo display with various icons related to steering wheel controls (SWC), indicating the unit's compatibility with existing vehicle controls. The bottom portion displays the car stereo screen running a navigation application, showing a map with route information and estimated arrival time, demonstrating its GPS capabilities for both online and offline use.



Figure 6: Split Screen and WiFi Connection for Apps

This image showcases two advanced features of the car stereo. The top section demonstrates the split-screen functionality, allowing users to view multiple applications simultaneously, such as navigation and media playback. The bottom section illustrates the unit's WiFi connectivity, showing various popular app icons (Instagram, YouTube, Facebook, TikTok, Telegram, Spotify, Snapchat) radiating from a WiFi symbol, indicating the ability to connect to the internet and download applications.

Bluetooth Hands-free & FM/AM Radio

Utilize Bluetooth for hands-free calling and audio streaming. The unit supports voice commands for functions like "play music," "GPS navigation," or "make a call," enhancing driving safety. The FM radio features 18 preset stations, allowing you to quickly access your preferred broadcasts.



Figure 7: FM RDS Radio and Bluetooth Hands-free

This image displays two core communication and entertainment features. The top part shows the car stereo's FM RDS Radio interface, with frequency display and preset buttons (FM1, FM2, FM3) for easy station selection, emphasizing clear audio transmission. The bottom part illustrates the Bluetooth functionality, showing a smartphone making a call and the car stereo displaying the call interface with options to decline, mute, or add a call, highlighting its dual-channel Bluetooth support for contacts, music, and voice control.

Android 13 System & EQ Adjust

Running on Android 13 with 2GB RAM and 32GB ROM, the system ensures smooth performance. The built-in EQ (Equalizer) allows you to fine-tune the audio output to match your preferences, providing a personalized and high-quality sound experience.

AC Controls on Screen

To view and customize AC controls on your screen, follow these steps:

1. Go to **Settings > Factory**. Enter PIN **000000**.
2. Navigate to **CAN related settings > Display air info > Open**.
3. Alternatively, use the **Carinfo app > Air Set > Customizing AC Settings**.

Ensure you select the system protocol "Chrysler/Jeep-JEEP_XP04" for proper AC integration.



Q

Please select the system protocol:
“Chrysler/Jeep-JEEP_XP04”

How can I see AC controls on my screen and choose between the feet, defrost and dash vents?

A

Please adjust the following settings

1: Settings --- Factory --- pin 000000 --- CAN related settings --- Display air info --- open

2: Carinfo app --- air set --- Customizing AC Settings

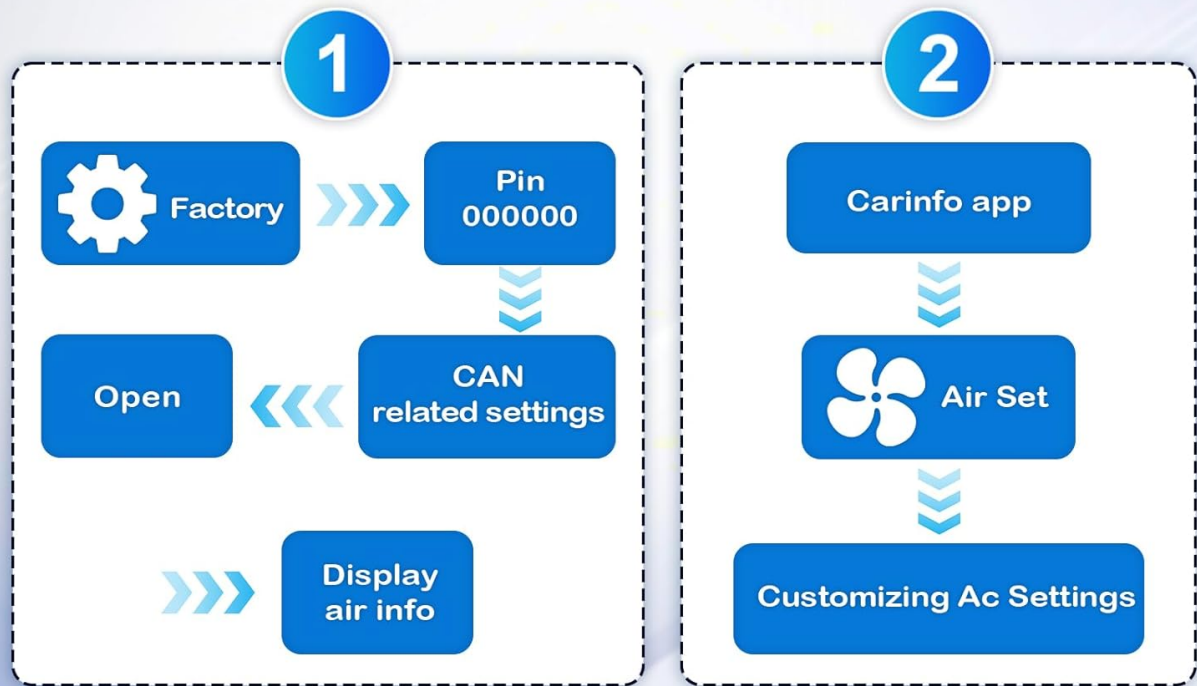

Figure 8: AC Control Settings Access

This image provides a step-by-step guide on how to access and adjust the AC controls directly from the car stereo's touchscreen. It outlines two primary methods: one through the 'Factory' settings using a specific PIN and CAN-related options, and another through the 'Carinfo app' for 'Air Set' and 'Customizing AC Settings'. The image also specifies the required system protocol "Chrysler/Jeep-JEEP_XP04" for correct functionality.

SPECIFICATIONS

Feature	Detail
Brand	KOBANOICA
Model Number	0d0f80b4-31d8-48fb-a15b-6b9b8c3b7a0e
Applicable Models	Dodge RAM 1500 2500 3500 (2013-2018, Automatic AC)
Operating System	Android 13

RAM	2GB
ROM	32GB
Screen Size	9 inches (23 cm diagonal)
Connectivity	Bluetooth, Wi-Fi
Controller Type	Android, iOS
Special Features	Built-In Bluetooth, Touchscreen, GPS Navigation, Wireless CarPlay, Android Auto, EQ Adjust
Compatible Devices	Smartphone
Audio Output Mode	Stereo
Surround Sound Channel	5.1
Output Power	16.4 Watts
Item Weight	3.63 pounds
Package Dimensions	11.73 x 11.1 x 4.84 inches

TROUBLESHOOTING & FAQ

This section addresses common issues and frequently asked questions. For more complex problems, please contact customer support.

- **Q: What is the factory code?**

A: The factory code is **000000**.

- **Q: The unit causes buttons to stop working or audio issues.**

A: Go to Car Setting > Factory > Physical learning, then activate every button.

- **Q: Sound quality is poor.**

A: Tap DSP on the menus to adjust the sound settings.

- **Q: The screen is black.**

A: This could be resolved by a software update. Contact customer support for the device software.

- **Q: Wi-Fi is not working.**

A: This could be resolved by a software update. Contact customer support for the device software.

- **Q: The unit did not work with my truck.**

A: Contact customer support and provide your exact truck model. They will advise on the matched protocol for the Canbus.

- **Q: The product did not work after installation.**

A: Ensure you have selected the exact protocol of the car radio or made the correct connections on the wires.

- **Q: The unit freezes, the microphone quality is poor, or there is too much screen reflection.**

A: These issues could be resolved by a software update. Contact customer support for the device software.

- **Q: The unit does not connect to the phone until several minutes of driving, or Bluetooth shuts off.**

A: Try removing and reinstalling the Zlink application.

- **Q: The product does not work despite troubleshooting.**

A: This problem is often caused by incorrect wiring connections. Refer to the wiring diagram (Figure 2) and ensure all connections are correct, and the right protocol for Canbus is selected.

CUSTOMER SUPPORT

For technical assistance, warranty inquiries, or further support, please contact KOBANOICA customer service. Refer to your purchase documentation for specific contact details or visit the official KOBANOICA store on Amazon:

[Visit the KOBANOICA Store on Amazon](#)

When contacting support, please have your product model number (0d0f80b4-31d8-48fb-a15b-6b9b8c3b7a0e) and purchase date ready.