

[Manuals.plus](#) /

› [SAFEMATE](#) /

› SAFEMATE PJS06-3000A Portable Car Battery Jump Starter User Manual

SAFEMATE PJS06-3000A

SAFEMATE PJS06-3000A Portable Car Battery Jump Starter User Manual

Model: PJS06-3000A

1. PRODUCT OVERVIEW

The SAFEMATE PJS06-3000A is a portable car battery jump starter designed to provide emergency power for vehicles. It features a high peak current, a large battery capacity, voltage detection, built-in safety protections, and a multi-functional LED warning light. This device can also serve as a power bank for charging electronic devices.

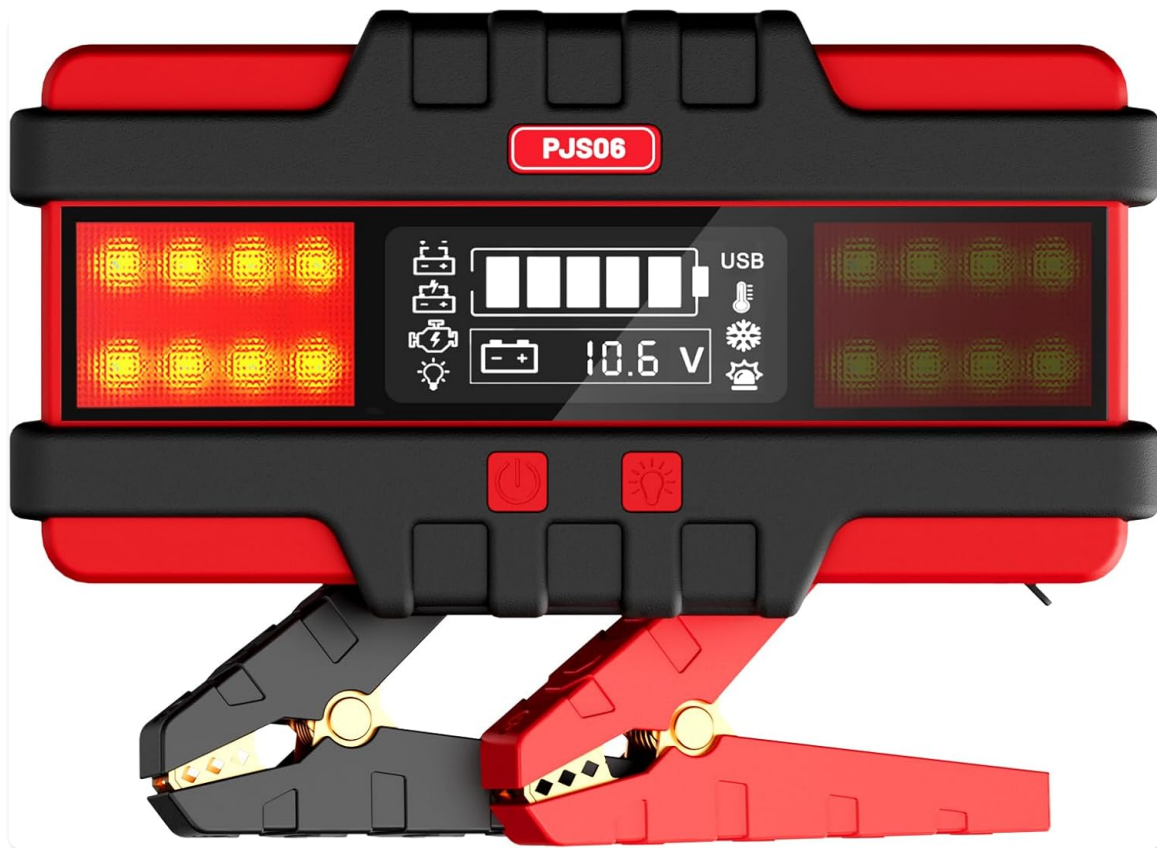

Image 1.1: Front view of the SAFEMATE PJS06-3000A Jump Starter, displaying battery status and voltage.

2. PACKAGE CONTENTS

Verify that all items are present in your package:

- 1x SAFEMATE PJS06-3000 Portable Car Jumper
- 1x Smart Jumper Cables
- 1x USB Type-C Charging Cable
- 1x High-value EVA Protection Case
- 1x User Manual

WHAT YOU GET



PJS06-3000 Jump starter *1



Manual *1



Jump Start Cables *1



Type-C to USB cable *1



EVA bag *1

Image 2.1: Contents of the SAFEMATE PJS06-3000A package.

3. SETUP AND INITIAL CHARGING

3.1 Initial Charging

Before first use, fully charge the SAFEMATE PJS06-3000A. The Type-C port supports 40W bi-directional fast charging, allowing the unit to charge from 0% to 100% in approximately 1.3 hours. Use the provided USB Type-C charging cable and a compatible 40W fast charger (not included) for optimal charging speed.

3.2 Power On/Off

To power on the device, press and hold the power button. The intelligent display will activate, showing the battery level and operational status. To power off, press and hold the power button again.

Video 3.1: Demonstrates unboxing and initial power-on of a similar jump starter, showing the display and ports.

4. OPERATING INSTRUCTIONS: JUMP STARTING A VEHICLE

The PJS06-3000A can jump start up to 10L gasoline engines or 8L diesel engines.

4.1 Safety Precautions

- Ensure the jump starter is sufficiently charged (at least 50% recommended).
- Turn off your vehicle's ignition and all accessories.
- Wear appropriate eye protection and gloves.
- Ensure the area is well-ventilated.

4.2 Connecting the Jumper Cables

1. Insert the smart jumper cable connector into the jump start port on the SAFEMATE unit. Ensure it is fully seated.
2. Connect the **red** positive (+) clamp to the positive (+) terminal of your vehicle's battery.
3. Connect the **black** negative (-) clamp to the negative (-) terminal of your vehicle's battery.
4. The intelligent display on the jump starter will show the battery voltage and indicate a correct connection (green light on the smart cable adapter). If an error occurs (e.g., reverse connection), the screen will flash icons and emit beeping alerts.

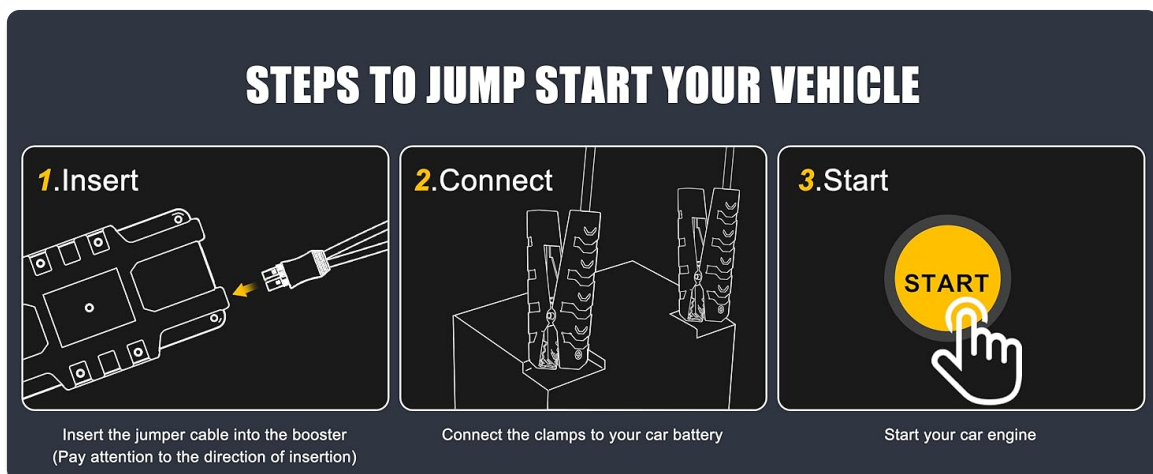

Image 4.1: Visual guide for connecting the jump starter to a vehicle battery.

4.3 Starting the Vehicle

1. Once the clamps are correctly connected and the display indicates readiness, start your vehicle's engine.
2. If the vehicle does not start immediately, wait for 15 seconds before attempting again. Do not crank the engine for more than 3 seconds per attempt.

4.4 Disconnecting the Jumper Cables

1. Once the vehicle has started, immediately disconnect the **black** negative (-) clamp from the vehicle battery.
2. Then, disconnect the **red** positive (+) clamp from the vehicle battery.
3. Finally, disconnect the smart jumper cable connector from the SAFEMATE unit.

Video 4.2: Demonstration of connecting the jump starter to a car battery and initiating a jump start.

5. OPERATING INSTRUCTIONS: POWER BANK FUNCTIONALITY

The PJS06-3000A can charge various electronic devices.

5.1 Charging Devices

The unit features a Type-C (IN/OUT) port with a maximum output of 40W and two USB (OUT) ports with a maximum output of 24W. Simply connect your electronic device (e.g., smartphone, tablet, laptop) to the appropriate port using its charging cable.



Image 5.1: The jump starter functioning as a power bank for electronic devices.

6. OPERATING INSTRUCTIONS: MULTI-FUNCTIONAL LED LIGHT

The integrated LED light offers multiple modes for various situations.

6.1 Light Modes

- **Lighting Mode:** Press the light button once for a steady, bright light to illuminate your work area.
- **Warning Mode:** Press the light button twice for a flashing warning light, useful for alerting others to your presence on the roadside.
- **SOS Mode:** Press the light button three times for an SOS signal, indicating an emergency.

MULTIFUNCTION SAFEMATE PJS06-3000 JUMP STARTER



Image 6.1: The jump starter's warning light in use.

7. MAINTENANCE

7.1 Charging

To maintain optimal battery health and ensure readiness, it is recommended to charge the SAFEMATE PJS06-3000A after each use and at least once every three months, even if not used.

7.2 Storage

Store the unit in its protective EVA case in a cool, dry place. Avoid direct sunlight and prolonged exposure to high temperatures (e.g., inside a hot car during summer) or extreme cold (below -4°F / -20°C) to prevent damage and ensure longevity.



Image 7.1: The jump starter is designed for use in various temperatures, but proper storage is crucial.

8. TROUBLESHOOTING

The intelligent display provides clear operational status, battery level, and potential error messages.

In case of errors such as short circuits or reverse connections, the screen will flash icons and emit beeping alerts.

8.1 Common Issues and Solutions

- **No Power/Display Off:** Ensure the unit is charged. Press the power button to activate the display.
- **Error Indication (Flashing Icons/Beeping):** This typically indicates an incorrect connection (e.g., reverse polarity, short circuit). Disconnect the clamps immediately and re-connect them correctly, ensuring positive to positive and negative to negative.
- **Vehicle Not Starting:** After connecting correctly, if the vehicle doesn't start, wait 15 seconds and try again. If still unsuccessful, the vehicle battery might be severely discharged or there might be another issue with the vehicle.
- **Unit Overheating:** The unit has built-in high-temperature protection. If it feels excessively hot, disconnect it and allow it to cool down before further use.

Video 8.1: Demonstrates the display showing battery status and error indicators for incorrect connections.

9. SPECIFICATIONS

| Feature | Specification |
|------------------------|-------------------------------------------|
| Model | PJS06-3000 |
| Peak Current | 3000 Amps |
| Battery Capacity | 18000mAh |
| Engine Compatibility | Up to 10L Gas, 8L Diesel |
| Charging Time (0-100%) | Approx. 1.3 hours (with 40W fast charger) |
| Standby Time | Up to 24 months |
| USB-C Output | Max 40W (Bi-directional) |
| USB Output | Max 24W (2 ports) |
| LED Light Modes | Lighting, Warning, SOS |

| | |
|--------------------|--------------------------------------------------------------------------------------------------------------------------------------------------------------------------------|
| Safety Protections | 10 advanced technologies (Reverse Polarity, Short Circuit, AI-Software Monitoring, High/Low Temperature, Over-Charging, USB Over-Current, Discharging, Overload, Over-Voltage) |
| Item Weight | 2.33 pounds |
| Package Dimensions | 8.54 x 5 x 3.5 inches |

10. WARRANTY AND CUSTOMER SUPPORT

SAFEMATE offers a 24-month hassle-free return policy and lifetime technical support for the PJS06-3000A. For any inquiries or assistance, please contact SAFEMATE customer service.