

[Manuals.plus](#) /

› [LUXOAK](#) /

› LUXOAK Queen Size Murphy Bed Cabinet Instruction Manual

## LUXOAK BPB008

# LUXOAK Queen Size Murphy Bed Cabinet Instruction Manual

Model: BPB008 | Brand: LUXOAK

## PRODUCT OVERVIEW

The LUXOAK Queen Size Murphy Bed Cabinet is a versatile and space-saving furniture solution designed for modern living. It seamlessly transforms from a stylish cabinet into a comfortable queen-sized bed, making it ideal for home offices, guest rooms, lofts, or small apartments. This unit features a built-in charging station and ample storage drawers for convenience.



Image: The Murphy Bed Cabinet shown in both its compact cabinet form and fully extended bed form, highlighting its dual functionality.

## KEY FEATURES

- **2-in-1 Design:** Transforms from a compact storage cabinet to a queen-sized bed, optimizing space.
- **Built-in Charging Station:** Equipped with 2 standard AC outlets, 1 USB port, and 1 Type-C port for convenient device charging.
- **Ample Storage:** Includes a large capacity storage drawer and cabinet space, suitable for bedding, clothes, or other items.
- **Smooth Operation:** Features quiet and smooth drawer slides and 8 directional wheels for easy movement and transformation.
- **Versatile Placement:** Suitable for various rooms including guest rooms, home offices, kids' rooms, and lofts.

# Built-in Charging Station



**125V/12A**  
[2 AC Outlets]



**5V/2A**  
[1 USB + 1 Type-c]



**6.56-Foot**  
[Power Cord]

Image: A detailed view of the integrated charging station, showing the AC outlets, USB, and Type-C ports.

# Multifunctional & Ample Storage Space

Cabinet Storage  
Foldable Mattress Can Be Placed

Drawer Storage

Foldable Mattress

2 Sections Quiet &  
Smooth Drawer Slides

8 PCS Directional Wheels



Image: The Murphy Bed Cabinet with its large storage drawer pulled out and the top cabinet lid open, demonstrating the available storage space.



Image: A collage of images demonstrating the versatile usage of the Murphy Bed in various settings such as a kid's room, guest room, office, and loft.

## SETUP AND ASSEMBLY

Assembly of the LUXOAK Murphy Bed Cabinet requires two adults and typically takes 2-3 hours. Please ensure all parts are present and follow the numbered instructions carefully. It is crucial to assemble the unit on a flat surface to ensure proper alignment and stability.

### Assembly Requirements:

- Number of packages: 2 boxes
- MDF Boards: 30 pieces
- Number of Hardware: 383 pieces
- Estimated Assembly Time: 2-3 hours for 2 people

# Installation Level

Professional Assembly & Installation Required

Easy

Tough



Number of packages:  
Pack in 2 Boxes



Installation Steps:  
34 Steps



Include Parts:  
MDF Boards: 30PCS  
Number of Hardware: 383 PCS



Assembly Time:  
2 Hours for 2 People



## When installing the slide rail

1. Follow the instructions to separate the TWO sections into TWO parts
2. Pay attention to the direction of the rail holes
3. Make sure to install on a flat surface

Image: An infographic detailing the installation level as 'Tough', along with the number of packages, MDF boards, hardware pieces, and estimated assembly time.

### Important Assembly Notes:

- When installing the slide rail, follow instructions to separate the two sections into two parts.
- Pay attention to the direction of the rail holes.
- Make sure to install on a flat surface.
- When assembling the drawers, ensure they are installed on a flat surface.

### OPERATING INSTRUCTIONS

The Murphy Bed Cabinet is designed for easy transformation. Follow these steps to convert the cabinet into a bed and back:

1. **Step 1: Cabinet Mode.** Ensure the cabinet doors are closed and secured. The unit functions as a compact storage cabinet.

2. **Step 2: Access Storage.** Pull out the large storage drawer located at the bottom of the cabinet to access stored items.
3. **Step 3: Prepare for Bed.** Unlock any safety latches or mechanisms that secure the bed frame within the cabinet.
4. **Step 4: Extend Bed.** Gently pull the bed frame outwards from the cabinet. The frame will unfold and extend to its full length.
5. **Step 5: Finalize Bed Setup.** Ensure the bed frame is fully extended and stable. Place your mattress (if not already integrated) and bedding.
6. **To Convert Back to Cabinet:** Remove bedding, fold the mattress (if foldable), and reverse the steps, carefully pushing the bed frame back into the cabinet until it locks securely.

## 2 Use Ways of Cabinet Bed

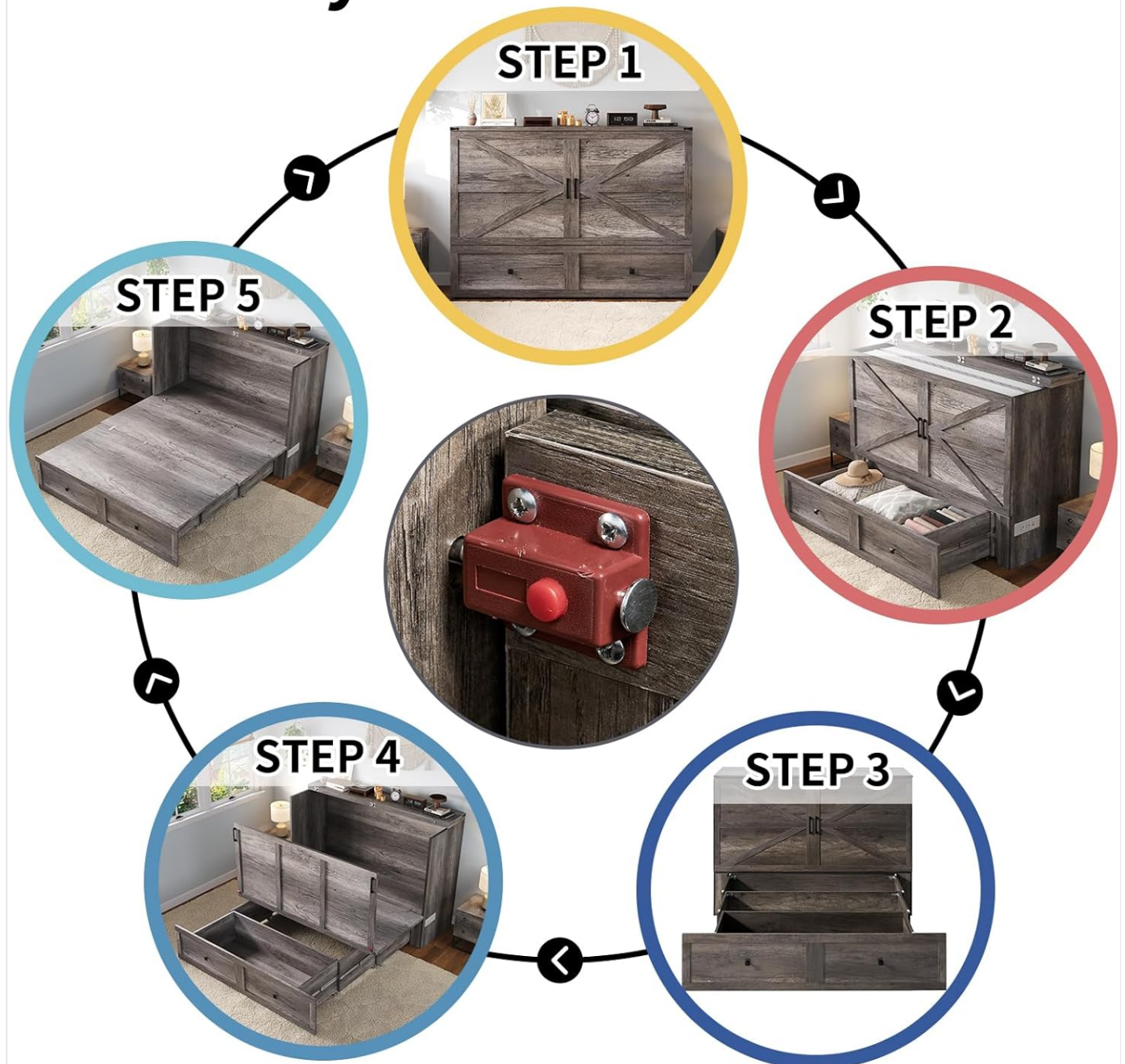

Image: A circular diagram illustrating the five-step process of transforming the Murphy Bed from a cabinet to a bed, and back.

### Using the Charging Station:

The built-in charging station is located on the side of the cabinet. Simply plug the bed's power cord into a wall outlet. You can then use the 2 AC outlets, 1 USB port, and 1 Type-C port to charge your electronic devices.

Your browser does not support the video tag.

Video: This video demonstrates the functionality of the LUXOAK Farmhouse Murphy Bed with Charging Station, including its transformation and charging capabilities.

## MAINTENANCE

To ensure the longevity and proper functioning of your LUXOAK Murphy Bed Cabinet, regular maintenance is recommended:

- **Cleaning:** Wipe down the wood surfaces with a soft, damp cloth. Avoid harsh chemicals or abrasive cleaners that could damage the finish.
- **Hardware Check:** Periodically check all screws, bolts, and fasteners to ensure they are tight. Tighten any loose hardware to maintain stability.
- **Drawer Slides:** Keep the drawer slides clean and free of debris. If they become stiff, a small amount of silicone lubricant can be applied.
- **Wheels:** Ensure the directional wheels are clean and can move freely. Remove any hair or lint that may accumulate.
- **Electrical Components:** Inspect the power cord and charging station for any signs of damage. Do not use if damaged.

## TROUBLESHOOTING

If you encounter any issues with your Murphy Bed Cabinet, please refer to the following common troubleshooting tips:

Problem	Possible Cause	Solution
Bed does not extend/retract smoothly.	Obstruction, loose hardware, or misaligned components.	Check for any objects blocking the mechanism. Ensure all assembly hardware is tightened. Verify that the unit was assembled on a flat, level surface.
Drawers are stiff or difficult to open/close.	Debris in slides, misaligned slides, or damaged bearings.	Clean the drawer slides. Check for proper alignment. If bearings are damaged, contact customer support for replacement parts.
Charging station not working.	Not plugged in, power outlet issue, or internal wiring problem.	Ensure the bed's power cord is securely plugged into a working wall outlet. Test the wall outlet with another device. If the issue persists, contact customer support.
Unit feels unstable or wobbly.	Loose hardware or uneven floor.	Re-tighten all assembly hardware. Ensure the unit is placed on a level floor.

If these steps do not resolve the issue, please contact LUXOAK customer support for further assistance.

## SPECIFICATIONS

Feature	Detail
Size	Queen

Feature	Detail
Product Dimensions (L x W x H)	81"L x 61.5"W x 45"H
Weight Capacity	1000 pounds
Color	Rustic Grey
Finish Type	Wood
Material	MDF Board
Included Components	Bed Frame, Hardware, Instructions
Assembly Required	Yes
Item Weight	217 pounds
Charging Station	2 AC Outlets (125V/12A), 1 USB Port (5V/2A), 1 Type-C Port (5V/2A), 6.56-Foot Power Cord

# Product Dimensions

Queen Size

Weight Capacity: 600 lbs



Image: A diagram illustrating the key dimensions of the Murphy Bed Cabinet in both its cabinet and extended bed configurations.

## SAFETY INFORMATION

Please read and adhere to the following safety guidelines to prevent injury and ensure safe operation of your Murphy Bed Cabinet:

- Always use caution when transforming the bed cabinet to prevent injury.
- Do not exceed the maximum weight recommendation of 1000 pounds.
- Assembly requires two adults and should be done carefully following the instructions to ensure stability and prevent collapse.
- Ensure the unit is placed on a stable, level surface before and after assembly.
- Keep children and pets away from the unit during transformation.
- Do not attempt to modify the product in any way, as this may compromise its safety and void the warranty.

## WARRANTY AND SUPPORT

Your LUXOAK Murphy Bed Cabinet is designed for durability and functionality. For any concerns or support, please refer to the following:

- **Return Policy:** This product is eligible for a 30-day easy return policy. Please refer to the retailer's specific return guidelines for details.
- **Customer Support:** For assembly assistance, missing parts, or any product-related inquiries, please contact the seller, boliyangnet, directly through the platform where the purchase was made.
- **Protection Plans:** Extended protection plans may be available for purchase. Check with your retailer for options such as 2-Year or 3-Year Protection Plans.

For additional information or to explore other products, visit the [LUXOAK Store](#).



© 2025 LUXOAK. All rights reserved.

For assistance, please refer to the contact information provided by your retailer.