

Commercial Electric CE15in

Commercial Electric 15-inch LED High Bay Light User Manual

Model: CE15in

Brand: Commercial Electric

1. SAFETY INFORMATION

Please read and understand all instructions before attempting to install, operate, or maintain this product. Failure to follow these instructions may result in electric shock, fire, or other injuries that could be hazardous or fatal.

- Ensure the main power supply is disconnected before installation or any maintenance.
- This product operates on 120-277V. Incorrect wiring can cause damage or injury.
- Installation should be performed by a qualified electrician or trained personnel.
- Do not modify the fixture. Any modifications may void the warranty and create safety hazards.
- Suitable for damp locations. Do not immerse in water.
- Operating temperature range: -40°F to 113°F (-40°C to 45°C).
- Wear appropriate personal protective equipment (PPE) during installation.

2. PRODUCT OVERVIEW

The Commercial Electric 15-inch LED High Bay Light is designed for commercial and industrial applications with high ceilings. It features integrated LED technology, offering adjustable light output and color temperature, along with flexible beam angle adjustments.



Figure 2.1: Commercial Electric 15-inch LED High Bay Light, showing the product and its packaging.

Key Features:

- **Adjustable Beam Angles:** 0°, 30°, 60°, 85° for precise light direction.
- **Selectable Color Temperatures:** 4000K (Bright White) and 5000K (Daylight).
- **Adjustable Brightness:** 13500 Lumens or 19000 Lumens.
- **Multi-Volt Operation:** Compatible with 120-277V electrical systems.
- **Dimmable:** 0-10V dimming capability (requires separate dimmer switch).
- **Multiple Mounting Options:** Suspended, Surface Mount, and Pedestal Mount.
- **Long Lifespan:** Rated for up to 50,000 hours, maintenance-free.

- 13500 Lumens and 19000 Lumens
- 0° to 85° Adjustable Light Beam Angles
- Ideal Ceiling Height 9-25 ft.
- 120-277V Multi-Volt
- 0-10V Dimmable



Figure 2.2: Overview of the light's adjustable features, including lumen output and beam angles.

3. SETUP AND INSTALLATION

3.1 Pre-Installation

- Turn off power at the circuit breaker before beginning installation.
- Unpack the fixture and inspect for any damage.
- Ensure all necessary tools and mounting hardware (not always included) are available.

3.2 Selecting Color Temperature and Lumens

Before mounting, adjust the desired color temperature (CCT) and lumen output using the switches located on the bottom of the fixture, discreetly hidden between the adjustable light panels. These settings should be chosen based on your lighting requirements.

Lumen and color temperature switches located on bottom of the fixture discreetly hidden between adjustable light panels



Figure 3.1: Location of the lumen and color temperature switches.

- **Color Temperature Switch:** Select between 4000K (Bright White) or 5000K (Daylight).
- **Lumen Switch:** Choose between 13500 Lumens or 19000 Lumens.

3.3 Mounting Options

The fixture supports three mounting methods: suspended, surface mount, and pedestal mount. Choose the method appropriate for your application.

3.3.1 Suspended Mounting

For suspended mounting, use appropriate chains or cables (not included) attached to the fixture's mounting points. Ensure the suspension system can safely support the fixture's weight (approximately 5.43 lbs).



Figure 3.2: Example of suspended mounting using chains.

3.3.2 Surface Mount

For surface mounting, secure the fixture directly to a ceiling or wall using appropriate screws and anchors (not included) that are suitable for the mounting surface and fixture weight.

3.3.3 Pedestal Mount

For pedestal mounting, attach the fixture to a compatible pedestal or pole (not included) using suitable hardware. Ensure the pedestal provides stable support.

3.4 Electrical Wiring

Connect the fixture to the main power supply (120-277V) according to local electrical codes. Ensure all connections are secure and insulated. If using the 0-10V dimming function, a separate low-voltage wiring run is required for the dimmer switch (e.g., LUTRON DVSTV-453PH-WH or DVELV-300PH-WH).

- Connect the black wire from the fixture to the live/hot wire from the power supply.
- Connect the white wire from the fixture to the neutral wire from the power supply.
- Connect the green/ground wire from the fixture to the ground wire from the power supply.
- For dimming, connect the purple wire to the dimmer's positive (+) terminal and the gray wire to the dimmer's negative (-) terminal.

4. OPERATING INSTRUCTIONS

4.1 Powering On

Once installation and wiring are complete, restore power at the circuit breaker. The light fixture should illuminate with the pre-selected color temperature and lumen output.

4.2 Adjusting Beam Angle

The light panels can be adjusted to direct light where needed. The beam angle can be set from 0° to 85° by manually pivoting the side panels. Loosen the screws on the side of the panels slightly, adjust to the desired angle, and then tighten the screws to secure the position.

Adjustable Light Beam Angles ranging from 0° to 85°

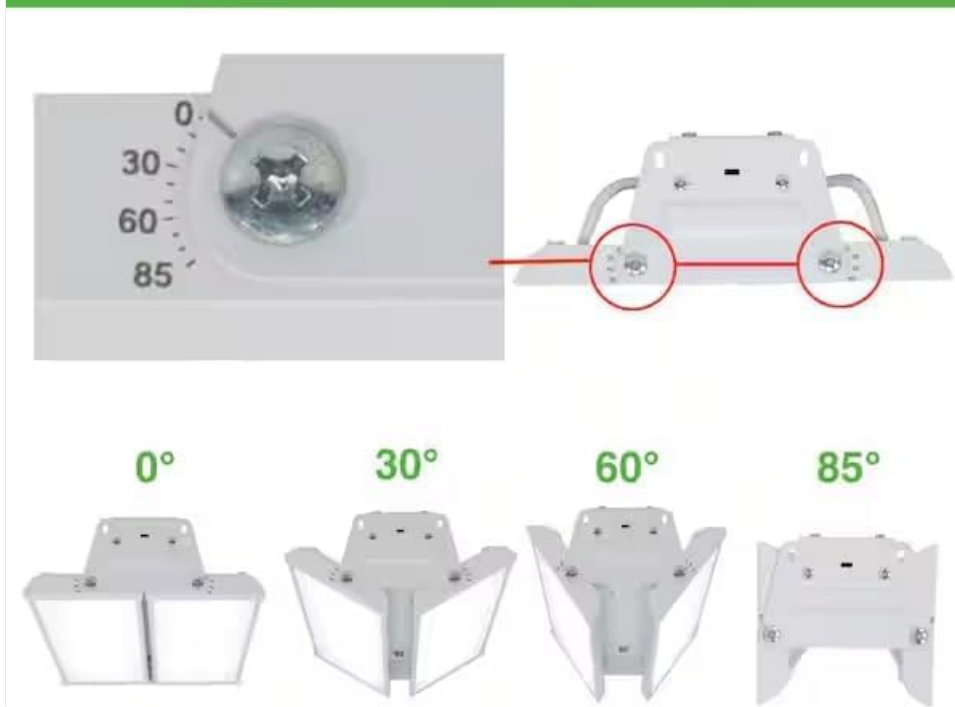

Figure 4.1: Steps for adjusting the light beam angles.

4.3 Dimming Function

If a compatible 0-10V dimmer switch is installed, use the dimmer control to adjust the brightness level of the fixture. Ensure the dimmer is rated for 0-10V LED applications.

5. MAINTENANCE

This LED High Bay Light is designed for long-term, maintenance-free operation with no bulbs to replace.

- **Cleaning:** To clean the fixture, ensure power is off. Use a soft, dry, or slightly damp cloth. Do not use abrasive cleaners or solvents.
- **Inspection:** Periodically inspect the fixture and wiring for any signs of damage or wear.

6. TROUBLESHOOTING

Problem	Possible Cause	Solution
Light does not turn on.	No power to the fixture; incorrect wiring; faulty switch.	Check circuit breaker; verify wiring connections; test switch functionality.
Light flickers or dims unexpectedly.	Loose wiring connection; incompatible dimmer switch; power fluctuations.	Check wiring; ensure 0-10V dimmer compatibility; consult an electrician for power supply issues.

Problem	Possible Cause	Solution
Incorrect color temperature or brightness.	CCT/Lumen switches set incorrectly.	Adjust the CCT and Lumen switches on the fixture (refer to Section 3.2).

7. SPECIFICATIONS



Figure 7.1: Product dimensions.

Feature	Detail
Model Number	CE15in
Brand	Commercial Electric
Input Power	138 Watts
Voltage	120-277V
Lumen Output	Selectable 13500 / 19000 Lumens
Color Temperature (CCT)	Selectable 4000K (Bright White) / 5000K (Daylight)
Beam Angle	Adjustable 0° to 85°
Dimming	0-10V Dimmable (requires separate dimmer)
Mounting Options	Suspended, Surface Mount, Pedestal Mount

Feature	Detail
Suggested Mounting Height	9-25 feet
Operating Temperature	-40°F to 113°F (-40°C to 45°C)
Fixture Dimensions (L x W x H)	15.75 in. x 9.25 in. x 3.23 in.
Item Weight	5.43 lbs (6.24 lbs packaged)
Lifespan	Up to 50,000 hours
Certifications	Suitable for damp location

8. WARRANTY AND SUPPORT

This Commercial Electric LED High Bay Light is backed by a **5-Year Limited Warranty**. This warranty covers defects in materials and workmanship under normal use and service.



For warranty claims, technical assistance, or further support, please contact Commercial Electric customer service. Refer to the product packaging or the manufacturer's official website for the most current contact information.

Note: The rated lifespan of this LED fixture is up to 50,000 hours, ensuring long-term performance without the need for bulb replacement.

© 2024 Commercial Electric. All rights reserved.
Information in this manual is subject to change without notice.

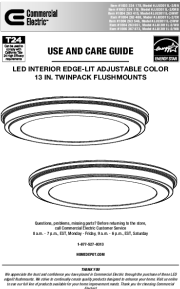
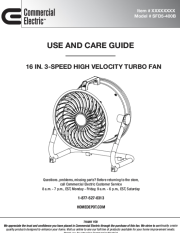
Related Documents - CE15in

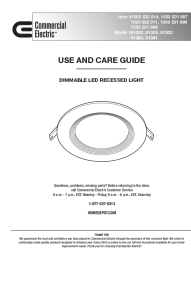
	<p>Commercial Electric 13-inch LED Flush Mount Installation and Care Guide</p> <p>This guide provides instructions for installing and caring for the Commercial Electric 13-inch LED Interior Edge-Lit Adjustable Color Flush Mounts. It includes safety information, warranty details, installation steps, and troubleshooting tips.</p>
	<p>Commercial Electric 16-Inch Turbo Fan Use and Care Guide</p> <p>Comprehensive guide for the Commercial Electric 16-inch 3-Speed High Velocity Turbo Fan, covering safety, assembly, operation, maintenance, and cleaning instructions.</p>

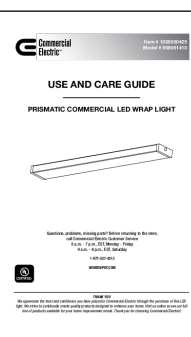
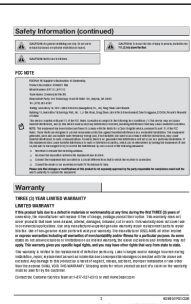
	<p>Commercial Electric Dimmable LED Recessed Light Use and Care Guide</p> <p>This guide provides instructions for the use and care of Commercial Electric dimmable LED recessed lights, including safety information, warranty details, pre-installation steps, installation instructions, and cleaning recommendations.</p>
	<p>Commercial Electric Electrical Testers Use and Care Guide: NCV & GFCI Testers</p> <p>Comprehensive use and care guide for Commercial Electric electrical testers, including the Adjustable Non-Contact Voltage Tester (Model NCV-8908) and the Outlet Tester with GFCI (Model OTG-102). Learn about safety, operation, maintenance, and specifications.</p>
	<p>Commercial Electric Prismatic Commercial LED Wrap Light Use and Care Guide</p> <p>This guide provides detailed instructions for the installation, use, and care of the Commercial Electric Prismatic Commercial LED Wrap Light (Item # 1008000425, Model # 568061410). It includes safety warnings, warranty information, parts lists, step-by-step installation procedures, and troubleshooting tips.</p>
	<p>Commercial Electric Exhaust Fan BF1101 & BF1103: Safety and Warranty Information</p> <p>Safety precautions, FCC compliance, and limited warranty details for Commercial Electric exhaust fans, models BF1101 and BF1103. Includes installation guidelines and customer support contact information.</p>