



[Manuals.plus](#) /

> [FEKOTS](#) /

> FEKOTS HD3 Ceiling Fan Remote Control User Manual

FEKOTS HD3

FEKOTS HD3 Ceiling Fan Remote Control User Manual

Model: HD3 | Brand: FEKOTS

INTRODUCTION

This manual provides instructions for the FEKOTS HD3 Ceiling Fan Remote Control. This remote is designed as a replacement for specific Hampton Bay and Home Decorators Collection 3-speed AC ceiling fans. It offers comprehensive control over fan speed, light functions, timing, and includes a thermostatic control feature.



Image: The FEKOTS HD3 remote control and its accompanying wall mount holder. The remote features an LCD display and multiple buttons for fan and light control.

PACKAGE CONTENTS

Verify that all items are present in the package:

- 1x Thermostatic Remote Control
- 1x Wall Mount Holder
- 1x User Guide (this manual)
- 2x Screws
- 2x Drywall Anchors
- Luminous stickers (for remote visibility in dark)

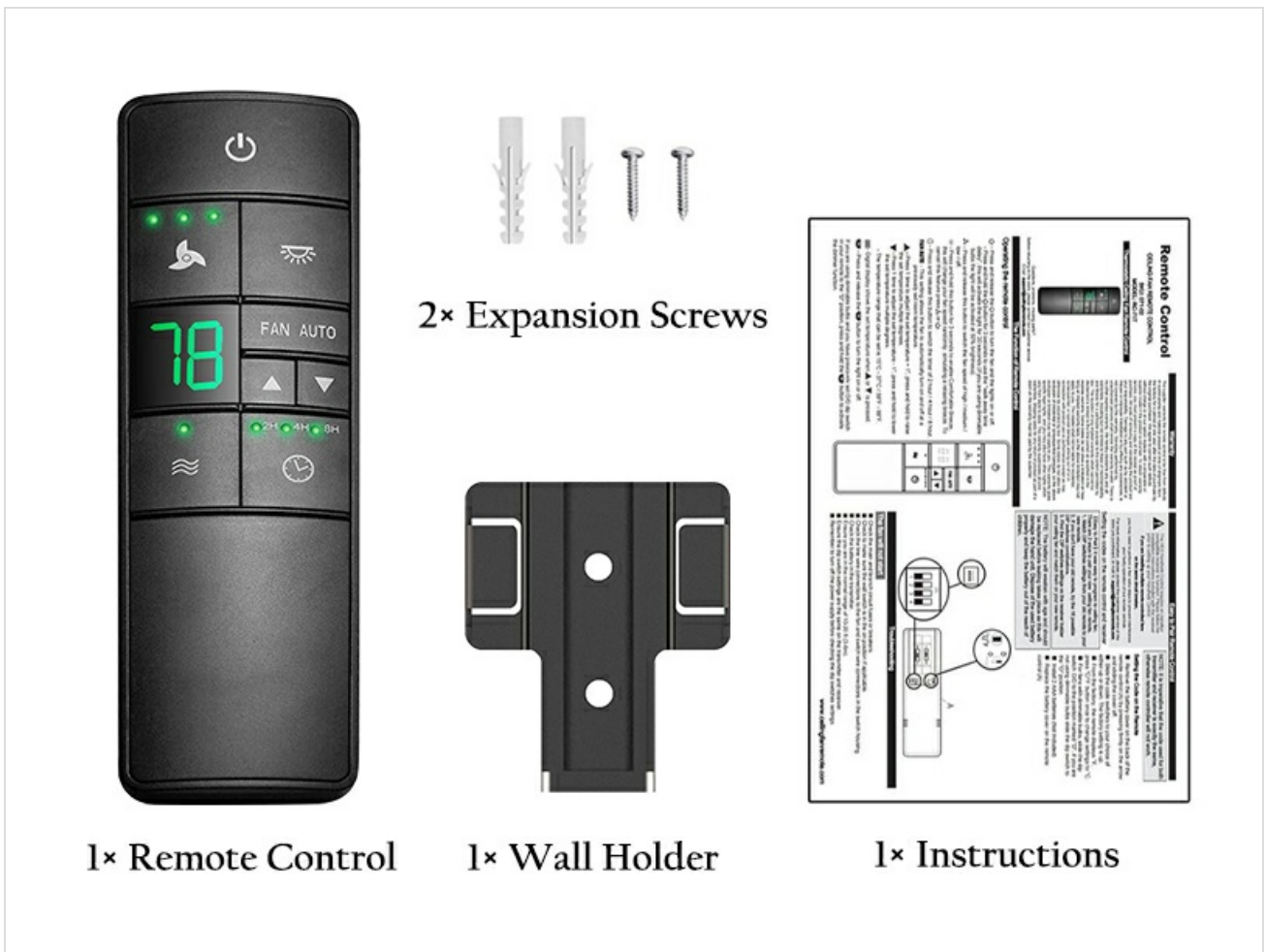

Image: A visual representation of the package contents, including the remote, wall holder, screws, and user guide.

PRODUCT OVERVIEW

The HD3 remote control features an LCD display and clearly labeled buttons for intuitive operation.

Smart Remote Control with LCD Display



To turn On/Off the fan, or use the "walk away time delay" function



Turn the light On/Off or dimmer function



To switch the fan speed of High/Medium/Low/Off



Change the manual state or automatic state



Shows the temperature of the actual or you set



Set the temperature of the automatic state



Enable the Comfort Breeze



Switch the Timer of 2/4/8 hour



Comfortable Breeze

This function will change your fan speed randomly, simulating a relaxing breeze.

Fan Auto

The remote control has a built-in temperature sensor, the fan will turn On/Off in a range of temperature you set.

Image: Diagram illustrating the functions of each button on the HD3 remote control, including power, fan speed, light, temperature display, comfort breeze, fan auto, and timer settings.

Power Button (⏻): Turns the fan On/Off or activates the "walk away time delay" function.

Fan Speed Buttons (🌀): Switches between High, Medium, Low, and Off fan speeds.

Light Button (💡): Turns the light On/Off or activates the dimmer function.

Temperature Display (78): Shows the current or set temperature.

Comfort Breeze Button (🌊): Enables the comfortable breeze mode, which randomly varies the fan speed.

FAN AUTO Button: Changes between manual and automatic fan operation based on temperature.

Temperature Adjustment Buttons (▲/▼): Sets the desired temperature for automatic fan operation.

Timer Button (🕒): Sets a 2, 4, or 8-hour timer for fan and light operation.

SETUP

1. Battery Installation

The remote control requires two 1.5V AAA batteries (not included).

1. Open the battery compartment cover on the back of the remote.
2. Insert two AAA batteries, ensuring correct polarity (+/-).
3. Close the battery compartment cover.

2. DIP Switch Configuration

The remote control uses DIP switches to match the frequency of your ceiling fan receiver. This step is crucial for proper operation.



Image: The back of the FEKOTS HD3 remote control showing the battery compartment, DIP switches, and the wall mount holder.

Simple Pairing Setup

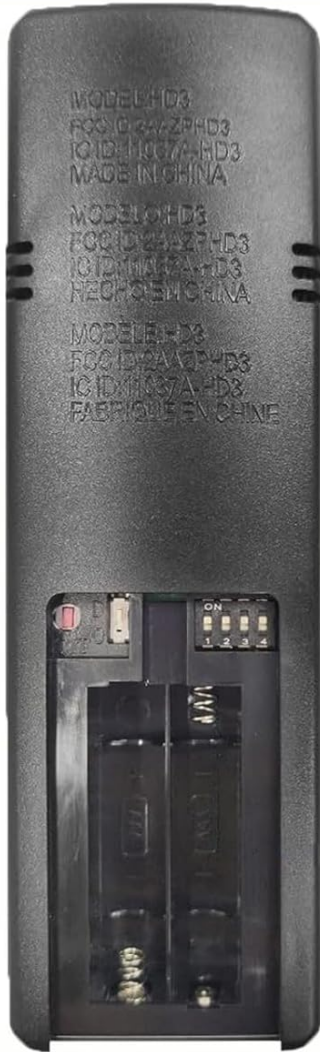

1 Situation 1: The original remote control is not lost



Old Remote



New Remote

Adjust the DIP dialing code of the new remote control to be consistent with the old remote control

2 Situation 2: The original remote control is lost

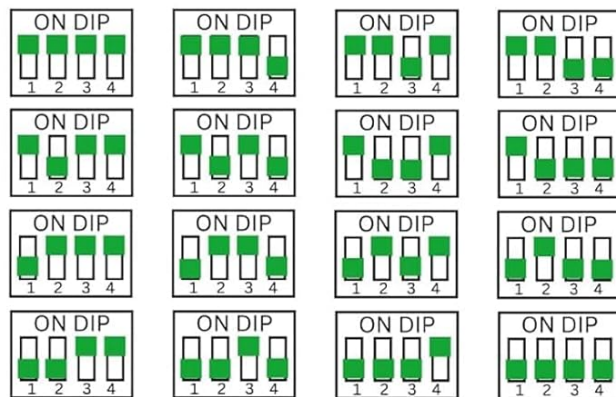

Try the 16 DIP dial combinations in the order of the pictures to see which one can match the ceiling fan.

NOTE 1 The remote control uses 2 AAA batteries. (NOT included)
2 The default settings is 0000, and it is not recommended.

Image: Detailed instructions for setting the DIP switches on the remote control, showing configurations for both when the original remote is available and when it is lost.

Situation 1: Original Remote Control is Available

- Locate the DIP switches on your original remote control (usually inside the battery compartment).
- Adjust the DIP switches on the new FEKOTS HD3 remote control to exactly match the configuration of your original remote.

Situation 2: Original Remote Control is Lost

- The default DIP switch setting is 0000 (all switches OFF), which is generally not recommended as it may not work with your fan.
- There are 16 possible DIP switch combinations. Try each combination one by one until the remote successfully controls your ceiling fan.
- To do this, set a combination, test the remote, and if it doesn't work, try the next combination.

Note:

The remote control uses 2 AAA batteries (not included).

The default settings is 0000, and it is not recommended.

OPERATING INSTRUCTIONS

Fan Speed Control

- Press the fan speed buttons to cycle through High, Medium, Low, and Off settings.
- **Comfortable Breeze:** Press the wave icon button () to activate the comfortable breeze mode. This mode randomly varies the fan speed to simulate a natural breeze.

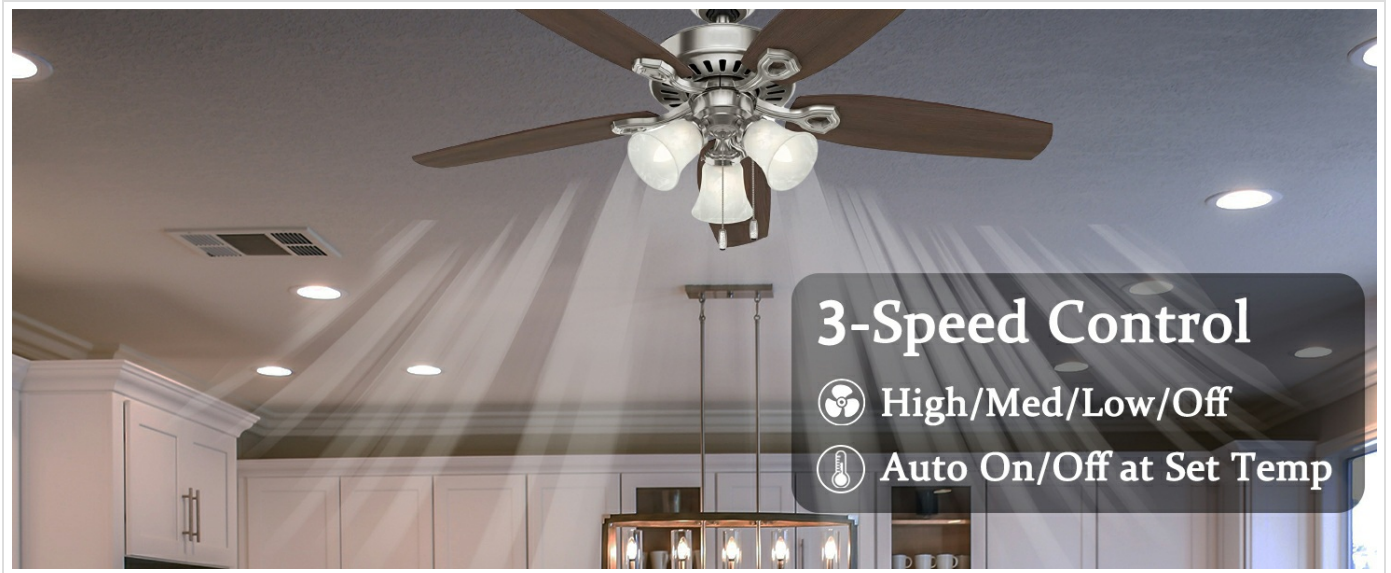

Image: Illustration showing the 3-speed control options (High/Med/Low/Off) and the automatic fan operation based on a set temperature.

Light Control

- **On/Off:** Short press the light button () to turn the light on or off.
- **Dimmer:** Long press the light button () to adjust the light brightness (stepless dimming). This feature is compatible with incandescent bulbs and dimmable LED/CFL lamps. Other LED and CFL lamps only support On/Off functionality.
- **Walk Away Time Delay:** Press the power button () to turn off the light. The light will remain on for an additional 30 seconds before turning off completely, providing time to exit the room.



Image: Visual guide demonstrating the adjustable light feature, including short press for on/off and long press for stepless dimming.

Timing Settings

- While the fan is on, press the timer button () to set a run timer for 2, 4, or 8 hours. The fan and light will automatically turn off after the selected duration.

Thermostatic Control (FAN AUTO)

- The remote has a built-in temperature sensor. Press the "FAN AUTO" button to activate this feature.
- Use the temperature adjustment buttons (▲/▼) to set a desired room temperature range.
- The fan will automatically turn on or off to maintain the set temperature.

COMPATIBILITY

This HD3 ceiling fan remote control is designed for 3-speed AC Hampton Bay and Home Decorators Collection ceiling fans. It is compatible with remotes having the following FCC ID / Model numbers:

- 2AAZPHD3 / HD3
- KUJCE10320 / TR222A
- A25-TX031
- 68108
- 98108
- KUJCE10317
- KUJCE10318
- A25-TX028
- TR220B
- 2AQZU-18011
- TR357A / 2AQZU-18028
- TX045-LR / A25-TX045

To ensure compatibility, check the FCC ID on the back of your original remote. It must match one of the listed models.

Note: This remote is compatible with most downrod style fans. It is not recommended for use with hugger style fans.

Replaceable Model

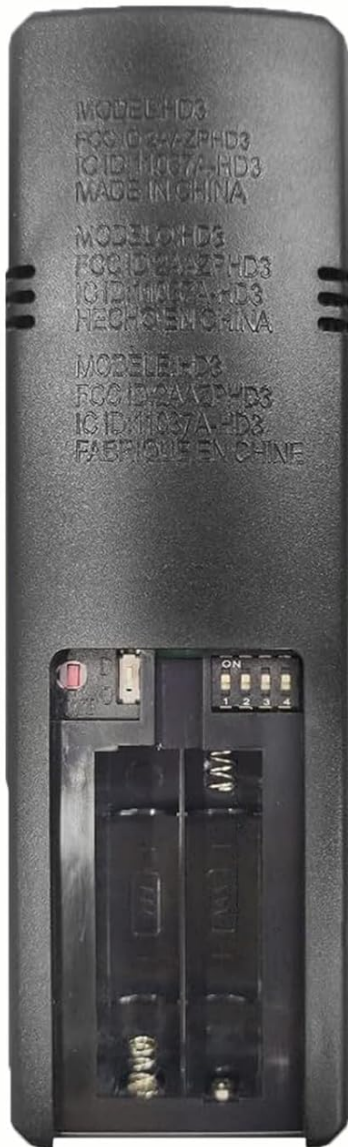

Check the FCC ID on the back of the original remote; it must match one of the listed models below to be compatible

Replaceable Product FCC ID/Model



HD3/ZAAZPHD3

A25-TX031

TR222A/KUJCE10320



KUJCE10317

KUJCE10318

A25-TX028



A25-TX028

TR220B

2AQZU-18011



TR357A/2AQZU-18028

TX045-LR/A25-TX045

Please consult for more compatible models or purchase the receiver set directly

Image: A visual guide showing various compatible remote models and their FCC IDs, emphasizing the need to match the FCC ID on the back of the original remote.

MAINTENANCE

- **Battery Replacement:** Replace batteries when the remote's performance degrades or the display becomes dim. Always use fresh AAA batteries.
- **Cleaning:** Wipe the remote control with a soft, dry cloth. Do not use abrasive cleaners or immerse the remote in water.
- **Storage:** If storing the remote for an extended period, remove the batteries to prevent leakage.

TROUBLESHOOTING

Problem	Possible Cause	Solution
---------	----------------	----------

Problem	Possible Cause	Solution
Remote not controlling fan/light.	Incorrect DIP switch settings. Dead or improperly installed batteries. Remote out of range.	Verify DIP switch settings match the fan receiver. Replace batteries and ensure correct polarity. Move closer to the fan.
Light dimmer not working with LED/CFL bulbs.	Non-dimmable LED/CFL bulbs.	Ensure your LED/CFL bulbs are specifically labeled as dimmable. Non-dimmable bulbs will only support On/Off.
Fan operates intermittently or erratically.	Low battery power. Interference.	Replace batteries. Ensure no other devices are causing signal interference.

SPECIFICATIONS

Model: HD3

Brand: FEKOTS

Compatible Fan Types: 3-speed AC Hampton Bay, Home Decorators Collection ceiling fans

Power Supply: 2 x 1.5V AAA batteries (not included)

Special Features: 3-Speed Control, Light Dimmer, 2/4/8 Hour Timer, Comfortable Breeze Setting, Thermostatic Control, Walk Away Time Delay Function

Dimensions: Approximately 5.9 x 1.77 inches (15cm x 4.5cm)

Item Weight: 3.52 ounces

WARRANTY AND SUPPORT

For warranty information or technical support, please refer to the contact details provided with your purchase or visit the FEKOTS official website. Keep your purchase receipt for warranty claims.