

WUDEMWWFE Bluetooth Arc Travel Mouse

WUDEMWWFE Bluetooth Arc Travel Mouse Instruction Manual

Model: Bluetooth Arc Travel Mouse

1. PRODUCT OVERVIEW

The WUDEMWWFE Bluetooth Arc Travel Mouse is a versatile and portable input device designed for various computing environments. It features dual-mode connectivity (Bluetooth and 2.4G USB wireless), a rechargeable battery, adjustable DPI settings, and a silent click mechanism. Its unique rotatable design allows for easy portability and ergonomic comfort.



Image 1.1: The WUDEMWWFE Bluetooth Arc Travel Mouse in its operational, arched form.

Rotatable Design



Unfolded rotation steps



Image 1.2: The mouse's rotatable design, illustrating its unfolded (arched) and folded (flat) configurations for use and portability.

2. SETUP

2.1 Package Contents

Before proceeding, please ensure all items are present in the package:

- WUDEMWWFE Bluetooth Arc Travel Mouse
- USB Receiver (stored inside the mouse)
- Micro-USB Charging Cable
- User Manual (this document)

2.2 Charging the Mouse

The mouse is equipped with a built-in rechargeable Lithium Polymer battery. Before first use, or when the battery is low, connect the provided Micro-USB charging cable to the charging port on the mouse and to a USB power source (e.g., computer USB port, USB wall adapter). The charging port is located on the front end of the mouse when in its flat state.

Rechargeable Lithium Battery



FAST CHARGING



300 mAh



60 Days

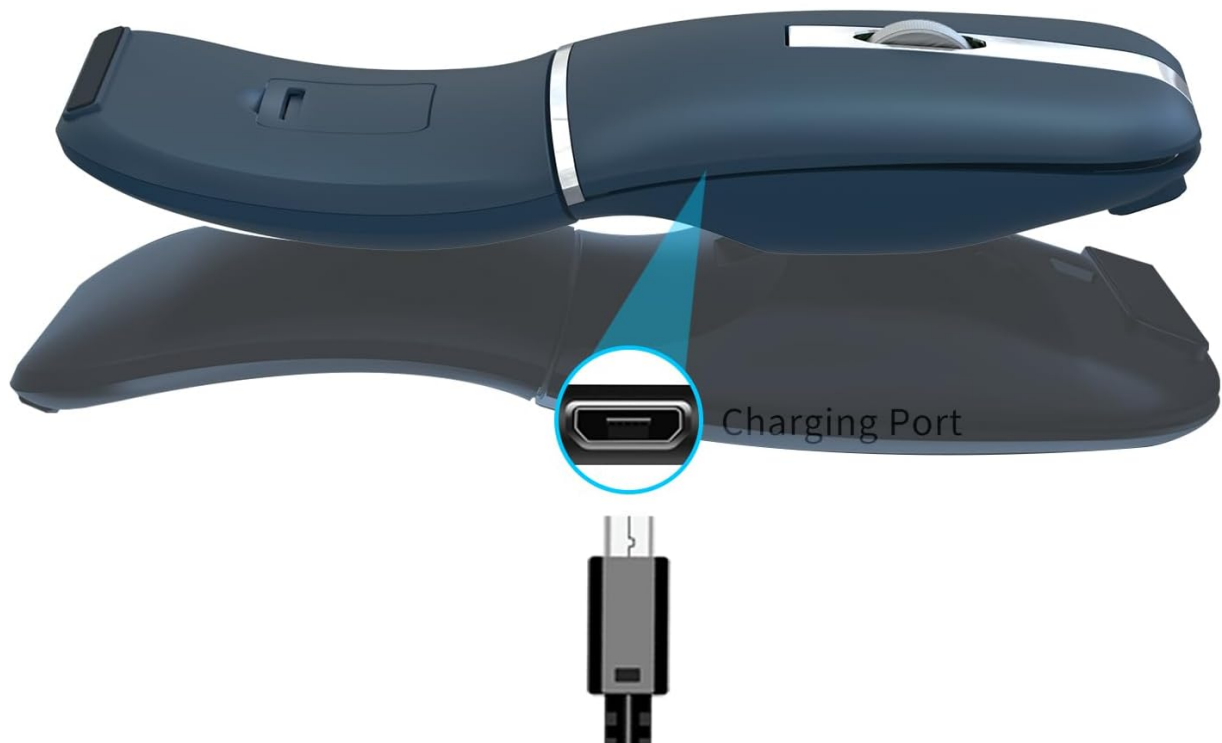

Image 2.1: Location of the Micro-USB charging port on the mouse.

2.3 Connecting the Mouse

The mouse supports dual-mode connectivity: 2.4G Wireless (via USB receiver) and Bluetooth (5.0/3.0). Use the mode switch located on the bottom of the mouse to select your preferred connection method.

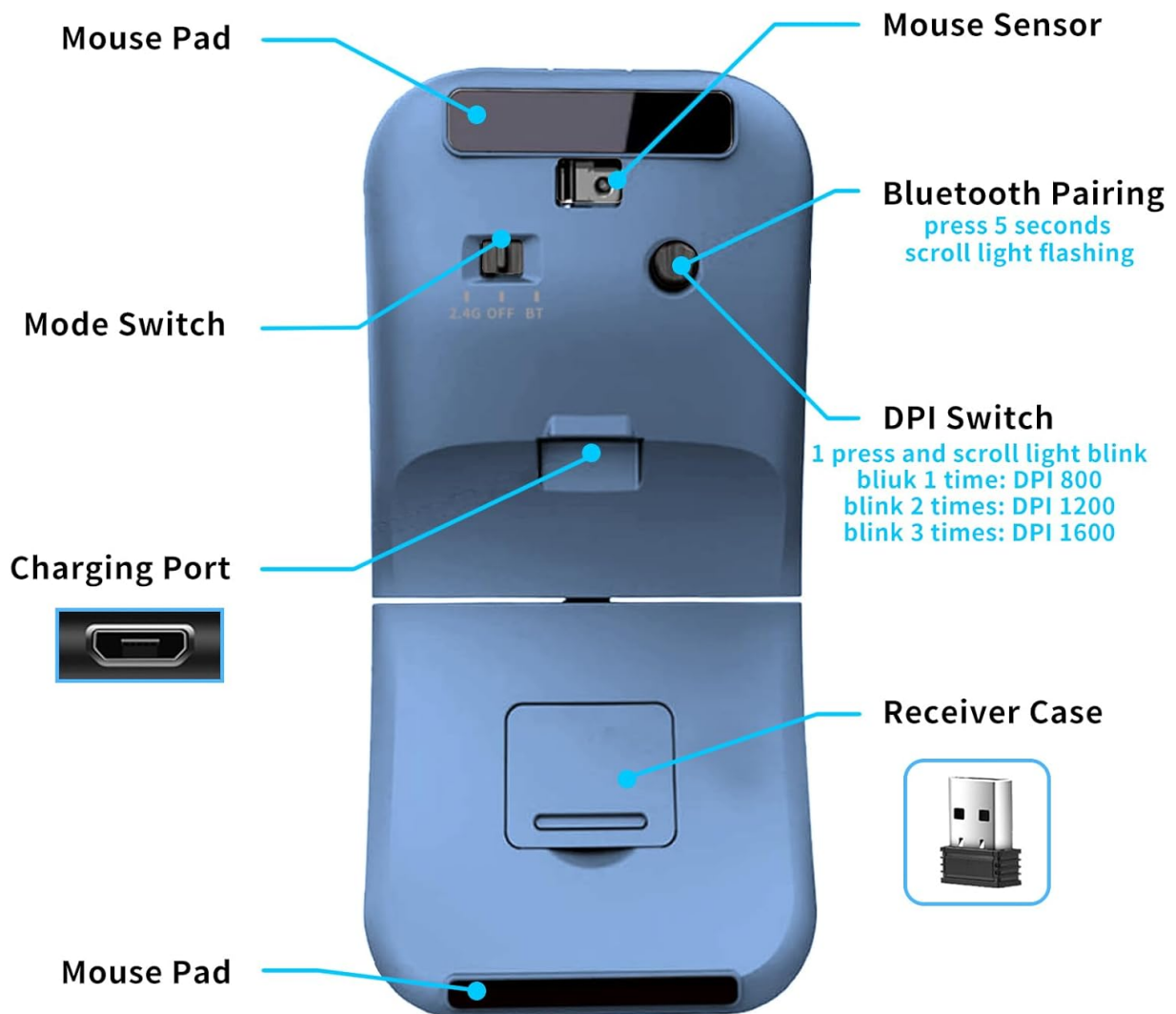

Image 2.2: Underside of the mouse, highlighting the mode switch, Bluetooth pairing button, DPI switch, charging port, and USB receiver compartment.

2.3.1 2.4G Wireless Mode

1. Locate the USB receiver stored in the compartment on the bottom of the mouse and remove it.
2. Insert the USB receiver into an available USB port on your computer.
3. Slide the mode switch on the bottom of the mouse to the '2.4G' position.
4. The mouse should automatically connect to your device.

2.3.2 Bluetooth Mode

1. Slide the mode switch on the bottom of the mouse to the 'BT' position.
2. Press and hold the Bluetooth Pairing button (located near the mode switch) for approximately 5 seconds until the scroll wheel light begins flashing, indicating pairing mode.
3. On your device (computer, tablet, phone), navigate to Bluetooth settings and search for new devices.
4. Select 'WUDEMWWFE Mouse' (or similar) from the list of available devices to complete the pairing process. The scroll wheel light will stop flashing once connected.

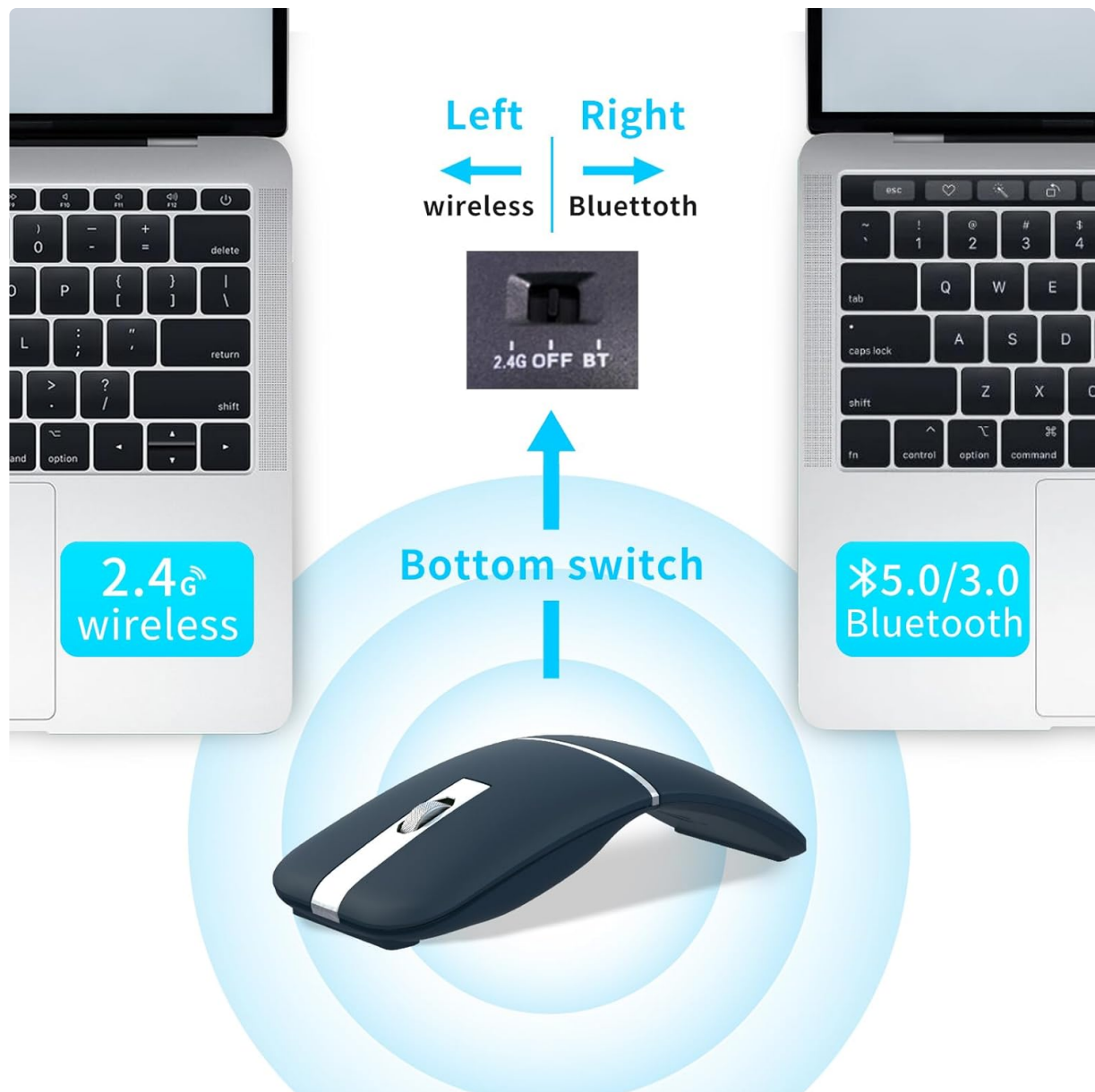

Image 2.3: Illustrates switching between 2.4G wireless and Bluetooth modes using the bottom switch.

3. OPERATING INSTRUCTIONS

3.1 Power On/Off

The mouse automatically powers on when rotated into its arched, ergonomic shape and powers off when flattened for storage. This design helps conserve battery life.

3.2 DPI Adjustment

The mouse features 3 adjustable DPI (Dots Per Inch) settings: 1000, 1600, and 2400. To change the DPI, press the DPI Switch button located on the bottom of the mouse. The scroll wheel light will blink to indicate the current DPI setting:

- **1 blink:** 1000 DPI
- **2 blinks:** 1600 DPI
- **3 blinks:** 2400 DPI

3 DPI Adjustable

meets your different needs



Image 3.1: The DPI adjustment button and its corresponding sensitivity levels.

Note: The product description states 1000-1600-2400 DPI, while the image shows 800-1200-1600 DPI. Please refer to the product packaging or latest specifications for the exact DPI values.

3.3 Silent Click Feature

The mouse is designed with silent click buttons, minimizing noise during use. This feature is ideal for quiet environments such as libraries, offices, or dormitories.



Image 3.2: The silent click feature allows for use in quiet environments without disturbance.

3.4 Wide Compatibility

This mouse is compatible with a broad range of operating systems and devices, including Windows 11/10/8/7/Vista/XP, Chrome OS, Android, iOS, and Mac OS. The 2.4G USB connected mode supports any USB-enabled device, offering plug-and-play functionality.

Wide Compatibility



Image 3.3: The mouse offers wide compatibility across multiple operating systems and device types.

4. MAINTENANCE

4.1 Cleaning

To clean the mouse, gently wipe its surface with a soft, dry, or slightly damp cloth. Avoid using harsh chemicals or abrasive materials, as these can damage the finish. Ensure no liquid enters the charging port or other openings.

4.2 Battery Care

The mouse features an automatic power-saving mode to extend battery life. For optimal battery performance:

- Charge the mouse fully before first use.
- Avoid completely draining the battery frequently.
- Store the mouse in its flat, powered-off state when not in use for extended periods.

4.3 Storage

When traveling or not in use, flatten the mouse to its ultra-slim state. This protects the device and makes it easy to store in a pocket or laptop bag.



Ultra Thin and Lightweight

Image 4.1: The mouse's slim profile allows for easy storage and portability.

5. TROUBLESHOOTING

5.1 Mouse Not Connecting

- **Check Mode Switch:** Ensure the mode switch on the bottom of the mouse is set to the correct position (2.4G or BT) for your desired connection type.
- **Check Battery:** Confirm the mouse has sufficient battery charge. Recharge if necessary.
- **2.4G Wireless:** Ensure the USB receiver is securely plugged into your device's USB port. Try a different USB port.
- **Bluetooth:** Ensure Bluetooth is enabled on your device. Re-enter pairing mode on the mouse (press and hold Bluetooth Pairing button) and re-scan for devices on your computer/tablet.

5.2 Cursor Erratic or Not Moving

- **Surface:** Ensure you are using the mouse on a suitable surface. Optical mice may not track well on glossy, transparent, or highly reflective surfaces.
- **DPI Setting:** The current DPI setting might be too low or too high for your preference. Adjust the DPI using the DPI Switch button.
- **Battery:** A low battery can affect performance. Recharge the mouse.

5.3 Charging Issues

- **Cable Connection:** Ensure the Micro-USB charging cable is securely connected to both the mouse and the power source.
- **Power Source:** Try a different USB power source or charging cable to rule out a faulty component.

6. SPECIFICATIONS

Feature	Specification
Connectivity Technology	Bluetooth 5.0/3.0, 2.4G Wireless
Movement Detection	Optical
DPI Settings	1000 / 1600 / 2400 (Adjustable)
Battery Type	Rechargeable Lithium Polymer (300 mAh)
Item Weight	2.65 ounces
Package Dimensions	5.31 x 2.56 x 1.85 inches
Special Features	Lightweight, Portable, Rechargeable, Ultra Slim, Rotatable Design, Silent Click

7. WARRANTY AND SUPPORT

7.1 Warranty Information

This WUDEMWWFE Bluetooth Arc Travel Mouse is covered by a **30-day money-back guarantee** and a **12-month worry-free warranty** from the date of purchase. This warranty covers manufacturing defects and malfunctions under normal use. It does not cover damage caused by misuse, accidents, unauthorized modifications, or external factors.

7.2 Customer Support

For technical assistance, warranty claims, or any questions regarding your WUDEMWWFE product, please contact our customer support team. Refer to the contact information provided on the product packaging or the official WUDEMWWFE website for the most up-to-date support channels.

© 2025 WUDEMWWFE. All rights reserved.