

LIECTROUX G7

LIECTROUX G7 Robot Vacuum Cleaner and Mop User Manual

Model: G7

1. INTRODUCTION

This manual provides detailed instructions for the operation and maintenance of your LIECTROUX G7 Robot Vacuum Cleaner and Mop. Please read this manual thoroughly before use to ensure proper function and extend the lifespan of your device. The LIECTROUX G7 combines powerful vacuuming with efficient mopping, featuring advanced LiDAR navigation and a convenient self-emptying station.

2. SETUP

2.1 Unboxing and Placement

Carefully remove all components from the packaging. Place the self-emptying station on a hard, flat surface against a wall, ensuring there are no obstacles within 1 meter (3.3 feet) to the front and 0.5 meters (1.6 feet) to the sides. Connect the power cord to the station and plug it into a power outlet.



Image: The LIECTROUX G7 robot vacuum cleaner and its accompanying self-emptying station.

2.2 Initial Charging

Place the robot vacuum onto the charging contacts of the self-emptying station. Ensure the robot is properly docked. The robot will automatically begin charging. A full charge is recommended before the first use to optimize battery performance.

Automatic recharging, continuous cleaning from breakpoint

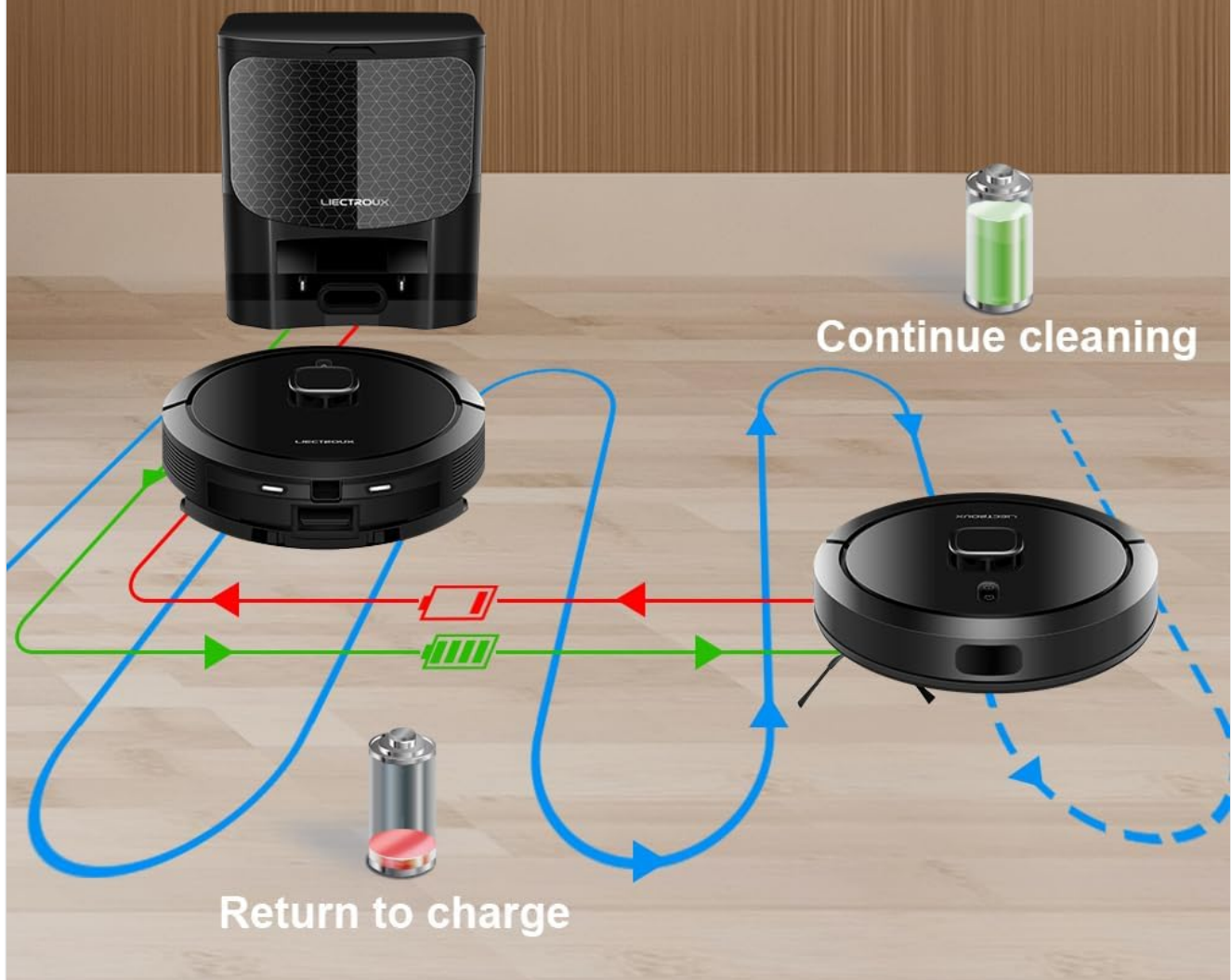

Image: Diagram illustrating the robot's automatic return to the charging station when battery is low and its ability to resume cleaning from the breakpoint.

2.3 App Connection and Initial Mapping

Download the 'Liectroux' app from your mobile app store (available for iOS and Android). Follow the in-app instructions to connect your robot vacuum to your home Wi-Fi network. Once connected, initiate an initial full cleaning cycle to allow the robot to map your home using its LiDAR navigation system. The app will build a real-time map of your cleaning area.

APP remote control

Visual cleaning



Whole house
cleaning



Specify wherever
you want



Area
cleaning



Timing
appointment



Vacuum power
adjustment



Image: A mobile phone screen displaying the Liectroux app interface for remote control and visual cleaning, showing a floor plan and various cleaning options.

3. OPERATING INSTRUCTIONS

3.1 Cleaning Modes

The LIECTROUX G7 offers various cleaning modes accessible via the mobile app:

- **Whole House Cleaning:** The robot cleans the entire mapped area.
- **Area Cleaning:** Select specific rooms or areas on the map for cleaning.
- **Zone Cleaning:** Draw a custom rectangular zone on the map for the robot to clean.
- **Timing Appointment:** Schedule cleaning times for specific days or intervals.

3.2 App Control Features

The app provides comprehensive control over your robot vacuum:

- **Real-time Map:** View the robot's current location and cleaning progress.

- **Virtual Walls & No-Go Zones:** Draw virtual boundaries on the map to restrict the robot from entering certain areas.
- **Vacuum Power Adjustment:** Adjust suction power across 4 levels to suit different floor types and cleaning needs.
- **Water Flow Adjustment:** Control the water output for mopping across 3 levels.

APP remote control Visual cleaning



Whole house
cleaning



Specify wherever
you want



Area
cleaning



Timing
appointment



Vacuum power
adjustment



Image: A mobile phone screen displaying the Liectroux app interface for remote control and visual cleaning, showing a floor plan and various cleaning options.

3.3 Voice Assistant Integration

The robot vacuum is compatible with popular voice assistants such as Amazon Alexa and Google Home. Refer to the 'Liectroux' app for detailed instructions on linking your device to these services for convenient voice control commands.

Compatible with Alexa & Google Home etc. Voice Assistants



Image: The robot vacuum cleaner positioned on a rug, with an Amazon Echo Dot and Google Home Mini speaker on a nearby table, indicating voice assistant compatibility.

3.4 Automatic Recharging and Continuous Cleaning

When the robot's battery level is low, it will automatically return to the self-emptying station to recharge. Once sufficiently charged, it will resume cleaning from where it left off, ensuring complete coverage of your home without interruption.

Automatic recharging, continuous cleaning from breakpoint

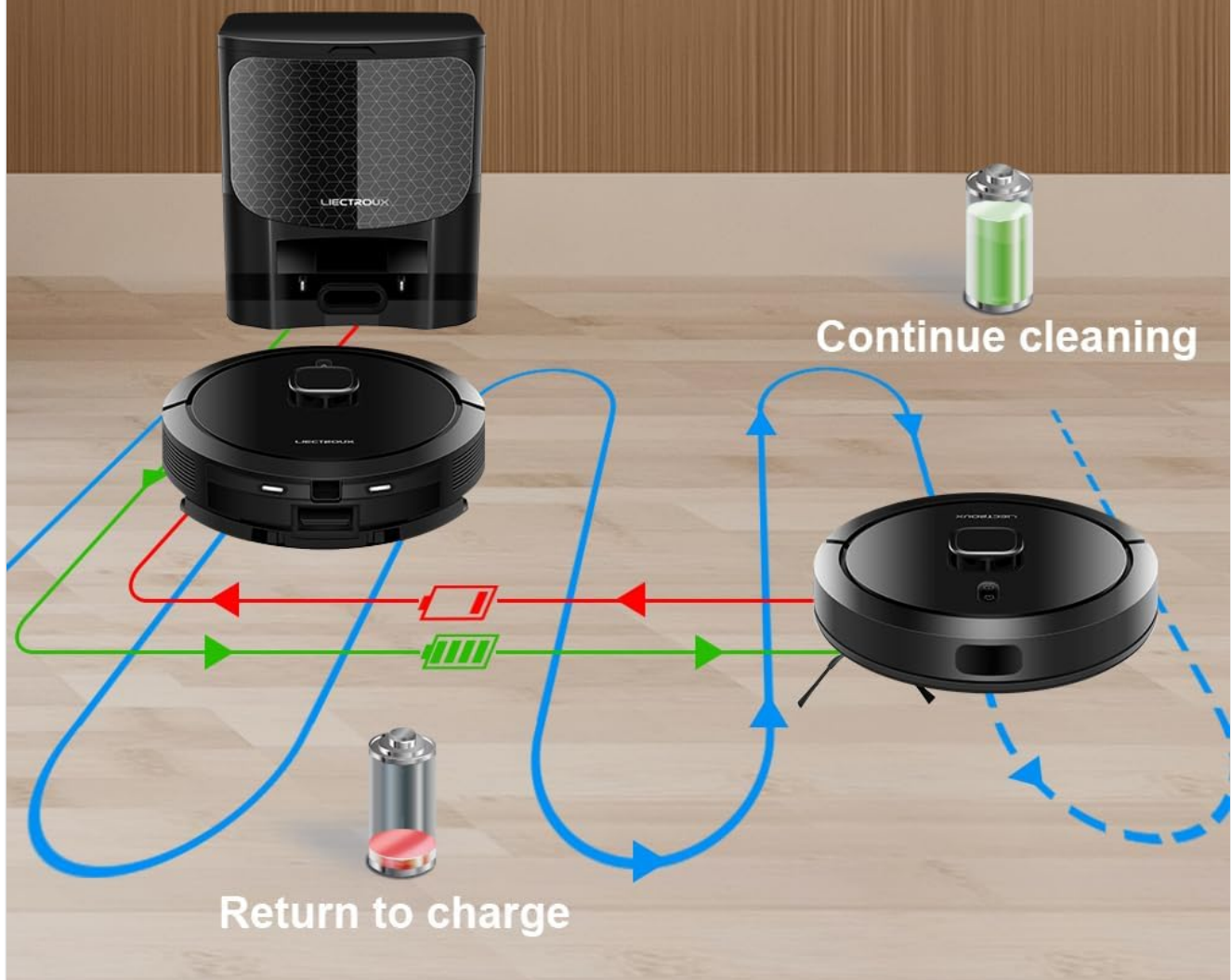

Image: Diagram illustrating the robot's automatic return to the charging station when battery is low and its ability to resume cleaning from the breakpoint.

4. MAINTENANCE

4.1 Dust Collection Station

The self-emptying station is equipped with a 3L large dust bag, designed to hold debris for up to 60 days, providing effortless cleaning. Replace the dust bag when indicated by the app or when it is full.



Equipped with **3L**
large dust bag

Enjoy **60** days of
effortless cleaning



Paper
particles



Soybean



Rice



Flour



Debris



Hair

Image: A hand inserting a large 3L dust bag into the self-emptying station, with icons showing various types of debris it can collect.

Automated docking station for effortless debris collection

It is equipped with a range of powerful features, including cleaning, vacuuming, and mopping and automatic dust collection capabilities



Image: A cutaway diagram of the automated docking station, illustrating the airflow path for effortless debris collection from the robot vacuum.

4.2 Water Tank and Mopping Pad

Regularly empty and refill the integrated water tank with clean water. Clean the mopping pad after each use to prevent odor and maintain optimal mopping efficiency. The app allows adjustment of water flow for different floor types.

4.3 Brushes and Filters

Periodically inspect and clean the main brush and side brushes to remove tangled hair, dust, and debris. The HEPA filter should be cleaned or replaced according to the app's recommendations to maintain optimal suction power and air quality.

4.4 Sensors

Wipe the anti-collision, anti-falling, and LiDAR sensors with a soft, dry cloth to ensure accurate navigation, obstacle detection, and cliff avoidance. Keep the charging contacts on both the robot and station clean.



Image: A collage of four images demonstrating the robot vacuum's advanced features: anti-collision (avoiding toys), anti-falling (detecting stairs), twining-proof (avoiding tangled wires), and easy climbing (overcoming small obstacles).

5. TROUBLESHOOTING

5.1 Robot Not Charging

- Ensure the charging contacts on both the robot and station are clean and free of debris.
- Verify the power cord is securely plugged into the station and a working power outlet.

5.2 Robot Stuck or Lost

- Clear obstacles from the robot's path.
- If the robot frequently gets stuck, consider setting virtual walls or no-go zones in the app.

5.3 Poor Cleaning Performance

- Check and empty the dust bag in the self-emptying station.

- Clean or replace the HEPA filter.
- Clean the main and side brushes to remove tangled hair and debris.
- Ensure the water tank is filled for mopping and the mopping pad is clean.

5.4 App Connectivity Issues

- Ensure your home Wi-Fi network is stable and the robot is within range of the router.
- Restart the robot and your Wi-Fi router.
- Re-pair the device with the app if necessary, following the in-app instructions.

5.5 Robot Not Mapping Correctly

- Ensure the environment is well-lit during the initial mapping run.
- Remove temporary obstacles that might interfere with the LiDAR sensor.



6. SPECIFICATIONS





Feature	Description
Brand	LIECTROUX
Model Name	G7
Color	Black
Material	ABS
Special Feature	Automatic dust collection
Surface Recommendation	Tile
Product Dimensions	45.5L x 58W x 40.5H centimeters
Controller Type	App Control
Filter Type	HEPA
Power Source	Battery Powered
Control Method	Application
Manufacturer	Liectroux

7. WARRANTY AND SUPPORT

For warranty information, technical support, or service inquiries regarding your LIECTROUX G7 Robot Vacuum Cleaner, please contact LIECTROUX customer support directly. Refer to the product packaging or the official LIECTROUX website for the most up-to-date contact details and support resources.

Related Documents - G7

	<p>Liectroux B6009 Robot Vacuum Cleaner User Manual</p> <p>Comprehensive user manual for the Liectroux B6009 robot vacuum cleaner, detailing safety instructions, product features, assembly, operation, and troubleshooting. Includes specifications and guidance for optimal use.</p>
	<p>LIECTROUX Robot Vacuum Cleaner G7: User Manual and Instructions</p> <p>Comprehensive user manual for the LIECTROUX Robot Vacuum Cleaner G7, covering setup, operation, maintenance, troubleshooting, and specifications. Learn how to use your smart robot vacuum.</p>

	<p>LIECTROUX N7S-U Robot Vacuum Safety Regulations and Usage Guidelines</p> <p>Essential safety regulations and operational notes for the LIECTROUX N7S-U robot vacuum cleaner. Learn how to use your smart vacuum safely and effectively, covering warnings, precautions, and handling instructions.</p>
	<p>Hướng Dẫn Sử Dụng Máy Hút Bụi Robot LIECTROUX ZK901</p> <p>Hướng dẫn sử dụng chi tiết cho máy hút bụi robot LIECTROUX ZK901, bao gồm giới thiệu sản phẩm, cách sử dụng, bảo trì, khắc phục sự cố và thông tin an toàn.</p>
	<p>LIECTROUX G7 Robotstofzuiger Handleiding en Gebruiksaanwijzing</p> <p>Gedetailleerde handleiding voor de LIECTROUX G7 robotstofzuiger, inclusief installatie, gebruik, onderhoud en probleemplossing. Leer hoe u uw robotstofzuiger optimaal kunt gebruiken met de Smart Life APP.</p>
	<p>LIECTROUX B6009 Robotic Vacuum Cleaner User Manual</p> <p>Comprehensive user manual for the LIECTROUX B6009 robotic vacuum cleaner. This guide covers setup, operation, features like app control and navigation, maintenance, troubleshooting, and technical specifications. Learn how to maximize your cleaning experience with this smart home device.</p>