

Inwa MZ-630

Inwa Computer Speakers User Manual

MODEL: MZ-630

1. INTRODUCTION

The Inwa Computer Speakers are designed to provide enhanced audio for your desktop PC, laptop, or other compatible devices. Featuring a convenient clip-on design, these USB-powered speakers deliver clear, loud stereo sound while minimizing desktop clutter. This manual provides detailed instructions for setup, operation, maintenance, and troubleshooting to ensure optimal performance of your speaker bar.



Image: The Inwa Computer Speaker Bar, shown clipped to the bottom of a computer monitor, demonstrating its compact and integrated design.

2. PACKAGE CONTENTS

Please verify that all items are present in the package:

- 1 x Inwa Computer Speaker Bar
- 1 x USB-A to USB-C converter (pre-attached to cable)

3. PRODUCT FEATURES

- **Excellent Sound Quality:** Equipped with two large-sized speakers and a passive radiator, delivering 10 watts of power for clear and loud stereo sound.
- **Easy Clip-on Design:** Features a spring clip for easy attachment to the top, sides, or bottom of monitors up to 1.18 inches (30mm) thick. Can also stand alone on a desktop. Silicone pads protect your monitor.
- **USB Powered & Plug and Play:** A single USB cable provides both audio and power. No 3.5mm AUX cables, additional software, or batteries are required. Includes a USB-A to USB-C converter for broad compatibility.
- **Convenient Controls:** Integrated buttons on the top for volume up, volume down, and mute for effortless audio adjustment.

Superior Sound Quality

Features two speakers and a passive radiator for rich, clear audio.

Loud!!

10W



Image: An exploded view diagram of the speaker bar highlighting its two speakers and passive radiator, indicating 10W power output for superior sound quality.

Laptop Screen



Work Screen



Gaming Screen



Firmly Attached to Your Monitor
No Worries About Being Knocked Over

Image: The speaker bar connected to a laptop via a single USB cable, illustrating the 'Say Goodbye to A Messy Desk!' feature with a 5ft cable length.

4. SETUP GUIDE

Follow these steps to set up your Inwa Computer Speakers:

1. **Choose Placement:** Decide whether to clip the speaker to your monitor or place it on your desktop.
2. **Clip-on Installation (Optional):** If clipping, gently open the spring clip at the bottom of the speaker and attach it to the top, side, or bottom edge of your monitor. Ensure the monitor thickness is 1.18 inches (30mm) or less for a secure fit. The silicone pads will protect your monitor surface.
3. **Connect USB Cable:** Plug the USB-A connector of the speaker cable into an available USB port on your computer (PC, laptop, Mac). If your device only has USB-C ports, use the included USB-A to USB-C converter.
4. **System Recognition:** The speaker is plug-and-play. Your operating system (Windows, macOS, Linux, Android) should automatically detect and configure the speaker. No additional drivers are typically required.

5. **Test Audio:** Play some audio from your computer to confirm sound output from the Inwa speakers. Adjust the volume using the controls on the speaker or your computer's system volume.

Plug and Play

No battery needed, just plug in and enjoy



USB A / USB C



PC



Laptop



Android

System



Linux



Windows



Mac OS



Android

Image: The speaker bar connected to a laptop, illustrating its 'Plug and Play' functionality and compatibility with PC, Laptop, Android, Linux, Windows, and Mac OS systems via USB-A or USB-C.



Image: A visual guide demonstrating how the speaker firmly attaches to monitors of varying thicknesses (0.2-inch, 0.7-inch, 1.18-inch), ensuring stability and eliminating concerns about being knocked over.

5. OPERATING INSTRUCTIONS

The Inwa Computer Speakers are designed for simple operation. All controls are conveniently located on the top of the speaker bar.

Controls:

- **Volume Up (Vol+):** Press to increase the audio volume.
- **Mute Key:** Press to mute or unmute the audio output.
- **Volume Down (Vol-):** Press to decrease the audio volume.

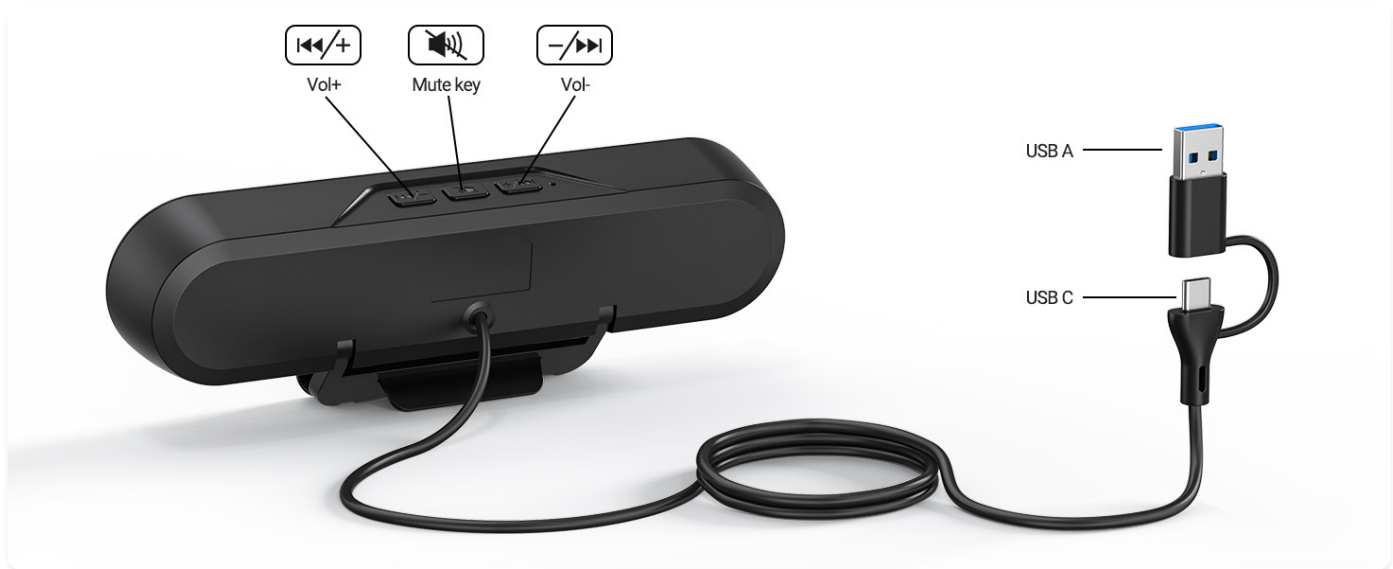

Image: A detailed view of the top of the speaker bar, clearly labeling the Volume Up (Vol+), Mute Key, and Volume Down (Vol-) buttons, along with the USB-A and USB-C cable connection.

6. MAINTENANCE AND CARE

To ensure the longevity and optimal performance of your Inwa Computer Speakers, follow these maintenance guidelines:

- **Cleaning:** Use a soft, dry cloth to wipe the exterior of the speaker. Do not use liquid cleaners, aerosols, or abrasive solvents, as these may damage the surface or internal components.
- **Storage:** When not in use for extended periods, store the speaker in a cool, dry place away from direct sunlight and extreme temperatures.
- **Handling:** Avoid dropping the speaker or subjecting it to strong impacts. Do not attempt to disassemble the speaker, as this will void the warranty.
- **Cable Care:** Handle the USB cable gently. Avoid sharp bends or kinks that could damage the internal wiring.

7. TROUBLESHOOTING

If you encounter any issues with your Inwa Computer Speakers, please refer to the following table for common problems and their solutions:

Problem	Possible Cause	Solution
No sound from speakers	Speaker not powered on / USB not connected properly Volume too low or muted Incorrect audio output device selected on computer	Ensure USB cable is firmly connected to a working USB port. Increase volume using speaker controls and computer's system volume. Check if speaker is muted. In your computer's sound settings, select "Inwa Speaker" or similar as the default audio output device.

Problem	Possible Cause	Solution
Sound is distorted or unclear	Volume set too high Audio source quality is low Interference	Reduce the volume on both the speaker and your computer. Try playing audio from a different source or file to check if the issue persists. Ensure the speaker is not placed too close to other electronic devices that might cause interference.
Speaker not recognized by computer	USB port issue Operating system glitch	Try connecting the speaker to a different USB port on your computer. Restart your computer.

8. TECHNICAL SPECIFICATIONS

Specification	Detail
Model Name	MZ-630
Speaker Type	Multimedia
Connectivity Technology	USB
Audio Output Mode	Stereo
Speaker Maximum Output Power	10 Watts
Input Voltage	5 Volts
Mounting Type	Clamp Installation
Product Dimensions (D x W x H)	1.2" x 7.8" x 2.6" (3cm x 19.9cm x 6.5cm)
Item Weight	11.3 ounces (0.32 Kilograms)
Compatible Devices	Desktop, Laptop, Smartphone, Tablet
Color	Black

9. WARRANTY AND CUSTOMER SUPPORT

Inwa is committed to providing high-quality products and excellent customer service.

Warranty:

This product comes with a full warranty. Please refer to the product packaging or purchase documentation for specific warranty terms and conditions.

Technical Support:

We offer lifetime product technical support. If you encounter any problems or have questions regarding your Inwa Computer Speakers, please do not hesitate to contact our Customer Service team. We are dedicated to resolving any issues you may have within 24 hours.

For support, please visit the Inwa Store on Amazon or use the contact information provided with your purchase.

Related Documents - MZ-630

	<p>Inwa MZ-320B Garden Light Wireless Speaker User Manual</p> <p>User manual for the Inwa MZ-320B Garden Light Wireless Speaker, covering quick start guide, product parameters, operation instructions, safety notices, and technical requirements. Features include wireless connectivity and beat-driven light show.</p>
	<p>Inwa MZ-622 Bluetooth Wall-Mounted Speaker Product Manual</p> <p>This manual provides instructions for the Inwa MZ-622 Bluetooth Wall-Mounted Speaker, covering safety rules, package contents, dimensions, control panel and interface, parameters, operating instructions, connection methods, and installation diagrams. It also includes FCC warnings and support information.</p>
	<p>Inwa MZ-511 Wireless Networking Speaker: User Manual and Setup Guide</p> <p>Comprehensive guide to the Inwa MZ-511 Wireless Networking Speaker, covering setup, operation, installation, and specifications. Learn how to pair multiple speakers and mount your device.</p>
	<p>Inwa MZ-658 Sync Wall Speaker Product Manual</p> <p>This product manual provides detailed instructions for the Inwa MZ-658 Sync Wall Speaker, covering safety instructions, package contents, dimensions, parameters, control panel functions, operation instructions for Bluetooth and network pairing, installation diagram, and FCC compliance information.</p>
	<p>Inwa MZ-508 Riding Speaker PLUS User Manual</p> <p>User manual for the Inwa MZ-508 Riding Speaker PLUS, detailing its features, operation, installation, and specifications. Learn how to connect via Bluetooth, use the TF card mode, and activate the riding mode with app integration for speed display.</p>
	<p>Inwa MZ-610 Garden Light Wireless Speaker User Manual</p> <p>User manual for the Inwa MZ-610 Garden Light Wireless Speaker, detailing setup, features, Bluetooth pairing, TWS synchronization, charging, and light modes.</p>