

Manuals+

[Q & A](#) | [Deep Search](#) | [Upload](#)

manuals.plus /

› [MSI](#) /

› [MSI PRO X870-P WiFi ProSeries Motherboard User Manual](#)

MSI PRO X870-P WiFi ProSeries

MSI PRO X870-P WiFi ProSeries Motherboard User Manual

Model: PRO X870-P WiFi ProSeries

1. INTRODUCTION

The MSI PRO X870-P WiFi ProSeries Motherboard is designed to provide a stable and high-performance foundation for your computing needs. Tailored for professionals and enthusiasts, it supports the latest AMD Ryzen 9000/8000/7000 Series Processors, offering impressive performance and quality for multitasking and efficiency.

2. SAFETY INFORMATION

WARNING:

- Always disconnect power before installing or removing any components.
- Handle the motherboard by its edges to avoid damaging components or circuits.
- Use an anti-static wrist strap or discharge static electricity by touching a grounded metal object before handling components.
- Ensure proper ventilation within your PC case to prevent overheating.

3. PACKAGE CONTENTS

Verify that all items listed below are included in your motherboard package:

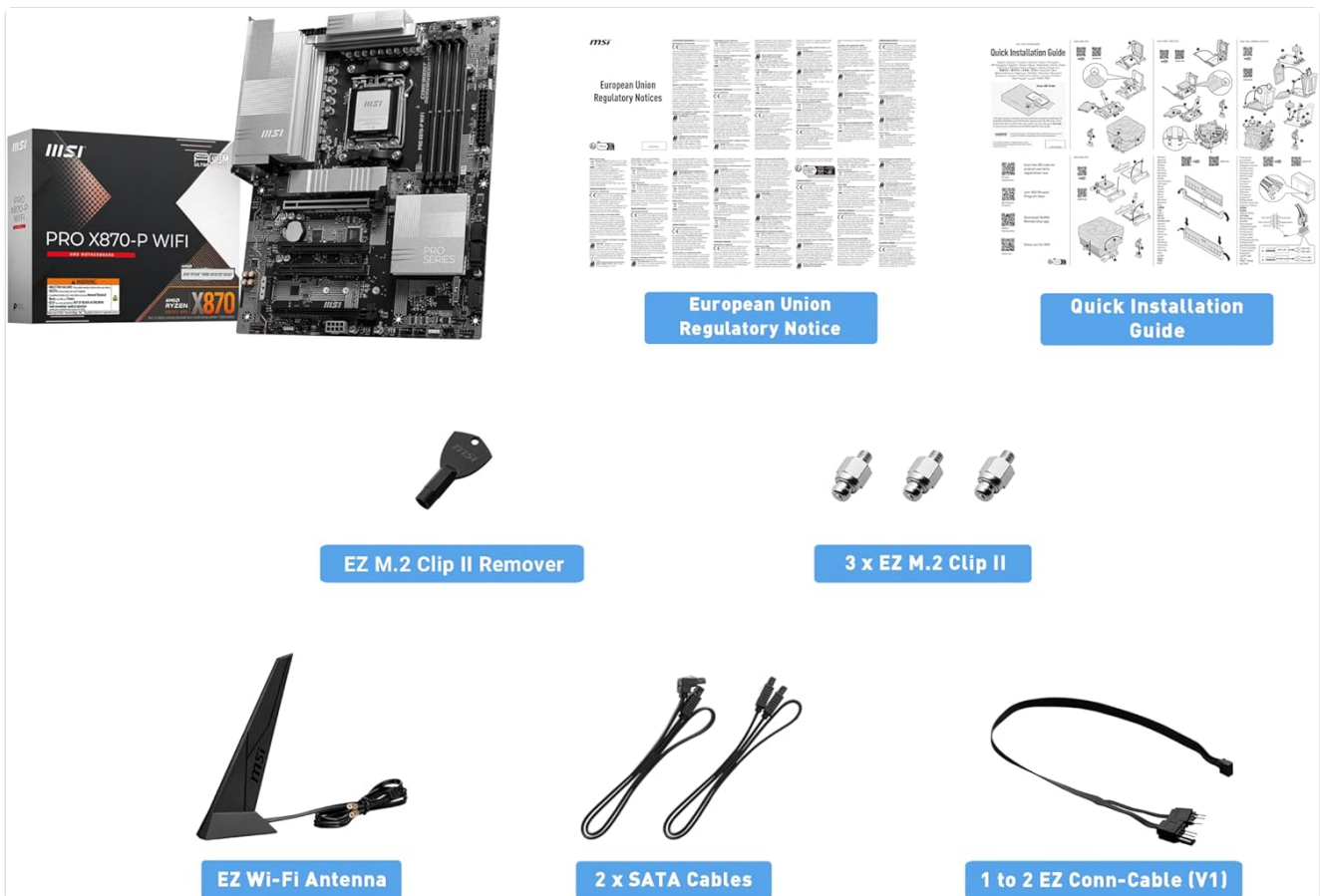

Figure 3.1: Motherboard package contents including accessories and documentation.

- MSI PRO X870-P WiFi ProSeries Motherboard
- European Union Regulatory Notice
- Quick Installation Guide
- EZ M.2 Clip II Remover
- 3 x EZ M.2 Clip II
- EZ Wi-Fi Antenna
- 2 x SATA Cables
- 1 to 2 EZ Conn-Cable (V1)

4. PRODUCT OVERVIEW

The MSI PRO X870-P WiFi ProSeries Motherboard features a robust design with advanced cooling and connectivity options.

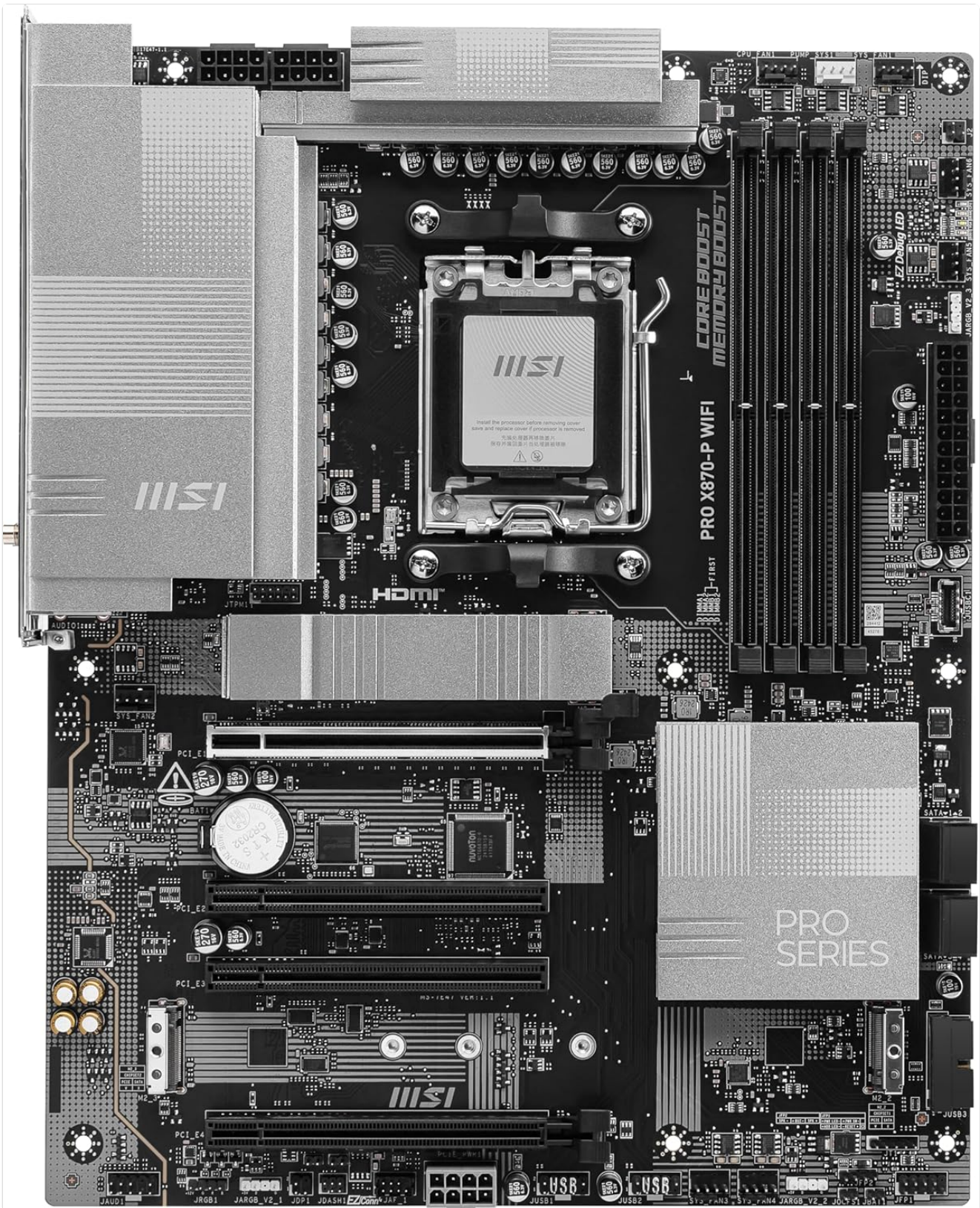

Figure 4.1: Top-down view of the MSI PRO X870-P WiFi ProSeries Motherboard, highlighting the CPU socket, RAM slots, and M.2 slots.



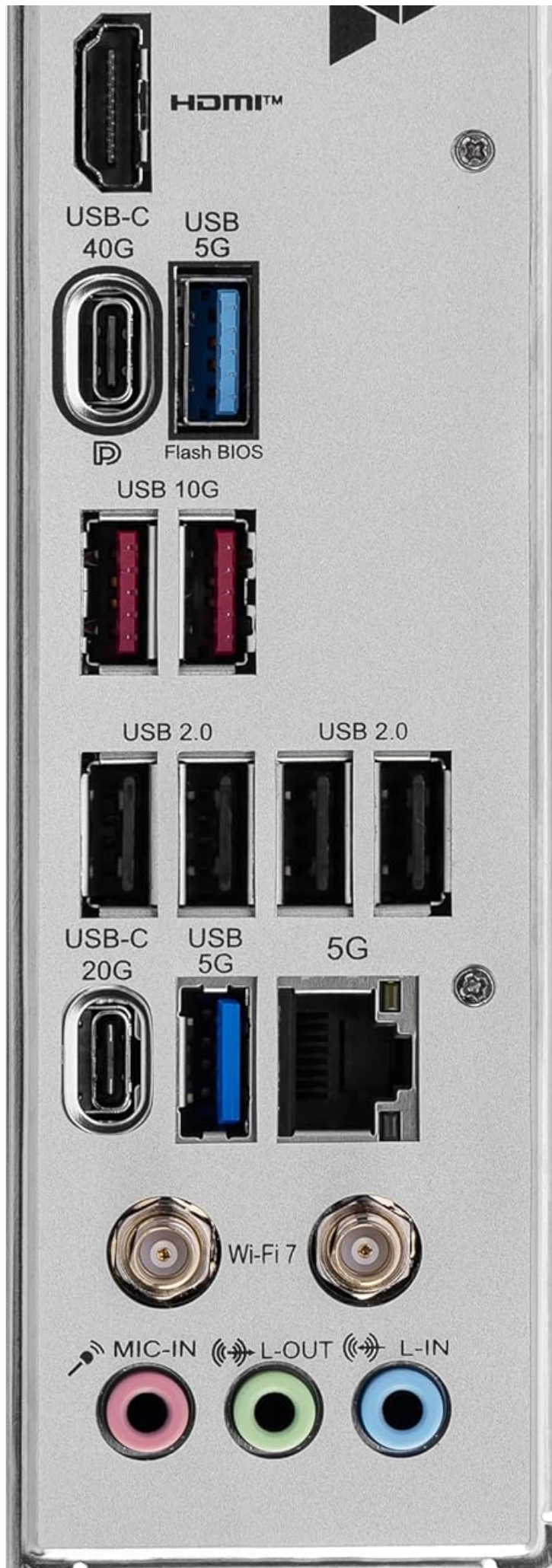

Figure 4.2: Close-up view of the motherboard's rear I/O panel, showing various ports and buttons.

Key features include:

- Supports AMD Ryzen 9000/8000/7000 Series Desktop Processors.
- Wi-Fi 7: The latest wireless solution with a new 320MHz channel.
- Pre-installed I/O Shielding: Better EMI protection and more convenient for installation.
- Frozr AI Cooling: Detects CPU and GPU temperatures and automatically adjusts system fan duty to a proper value.
- Triple M.2 Connectors: Onboard triple M.2 connectors with PCIe 4.0 solution.

5. SETUP

5.1. Component Installation

Follow these general steps for installing core components:

1. **CPU Installation:** Open the CPU socket lever, align the CPU with the triangle marker on the socket, gently place the CPU, and close the lever.
2. **CPU Cooler Installation:** Install your compatible CPU cooler according to its manufacturer's instructions.
3. **Memory (RAM) Installation:** Open the clips on the DDR5 DIMM slots. Align the memory module with the slot key and press firmly until the clips snap into place.
4. **M.2 SSD Installation:** Locate the M.2 slots. Remove the M.2 heatsink cover. Insert the M.2 SSD into the slot at an angle, then gently push it down and secure it with the EZ M.2 Clip II. Reattach the heatsink cover.
5. **Graphics Card (GPU) Installation:** Open the PCIe slot latch. Insert your graphics card firmly into the PCIe 5.0 x16 slot until it clicks into place. Close the latch.
6. **Power Supply Connections:** Connect the 24-pin ATX power connector and the 8-pin CPU power connectors to the motherboard. Connect power to your graphics card if required.
7. **Storage (SATA) Connections:** Connect your SATA drives to the SATA 6Gb/s ports on the motherboard using the provided SATA cables.
8. **Front Panel Connections:** Connect your case's front panel headers (power button, reset button, USB, audio) to the corresponding pins on the motherboard.

5.2. Initial BIOS Configuration

After assembling your system, power it on and press the **DEL** key repeatedly during startup to enter the BIOS/UEFI setup. Here you can configure boot order, enable XMP for memory, and adjust other system settings. It is recommended to update your BIOS to the latest version for optimal performance and compatibility.

6. OPERATING

Once your system is set up and the operating system is installed, you can install MSI's utility software, such as MSI Center, to monitor system performance, update drivers, and customize various features like Frozr AI Cooling.

Video 6.1: Product Overview Video. This video provides a general overview of the MSI PRO X870-P WiFi ProSeries Motherboard.

7. MAINTENANCE

Regular maintenance helps ensure the longevity and optimal performance of your motherboard:

- **Dust Removal:** Periodically clean dust from the motherboard and components using compressed air.
- **Cable Management:** Ensure cables are neatly organized to improve airflow and prevent interference.
- **Driver Updates:** Keep your motherboard drivers and BIOS updated to the latest versions from the MSI official website.

8. TROUBLESHOOTING

If you encounter issues, consider the following common troubleshooting steps:

- **No Power/No Boot:** Double-check all power connections (24-pin ATX, 8-pin CPU, GPU power). Ensure the power supply is switched on.
- **No Display:** Verify that your monitor is connected to the graphics card (or motherboard if using integrated graphics) and is powered on. Reseat the graphics card and RAM modules.
- **POST Code Errors:** If your motherboard has a debug LED display, refer to the motherboard manual for the meaning of specific POST codes.
- **System Instability/Crashes:** This could be due to outdated drivers, unstable overclocking, or faulty hardware. Try updating drivers, resetting BIOS settings to default, or testing components individually.
- **Clear CMOS:** If your system fails to boot after making BIOS changes, use the Clear CMOS button on the rear I/O panel (refer to Figure 4.2) or remove the CMOS battery for a few minutes to reset BIOS settings.

9. SPECIFICATIONS

| Feature | Specification |
|-----------------------|--|
| Brand | MSI |
| Series | PRO X870-P WiFi ProSeries |
| Item Model Number | PRO X870-P WiFi ProSeries |
| CPU Socket | Socket AM5 |
| Compatible Processors | AMD Ryzen 9000/8000/7000 Series Processors |
| RAM Memory Technology | DDR5 |
| Memory Speed | 7800 MHz |
| Chipset Type | AMD B650 |
| Product Dimensions | 13.46 x 10.55 x 2.76 inches |
| Item Weight | 4 pounds |

| | |
|---------------------------|------------|
| Platform | Windows 11 |
| Main Power Connector Type | 24-Pin |

10. WARRANTY

For detailed warranty information regarding your MSI PRO X870-P WiFi ProSeries Motherboard, please refer to the warranty card included in your product packaging or visit the official MSI website.

11. SUPPORT

If you require further assistance or have questions about your MSI PRO X870-P WiFi ProSeries Motherboard, please visit the official MSI support website or contact their customer service. You can find contact information and FAQs on their website.