



Manuals.plus /

› KSUN TFSI /

› KSUN ZL8668 Dual-Mode Walkie Talkie User Manual

## KSUN TFSI ZL8668

# KSUN ZL8668 Dual-Mode Walkie Talkie User Manual

Model: ZL8668 | Brand: KSUN TFSI

## 1. INTRODUCTION

---

The KSUN ZL8668 is an advanced dual-mode radio designed for seamless communication. It combines the capabilities of a 4G LTE network radio with traditional UHF analog radio functionality, allowing for versatile use in various environments. This device features dual PTT buttons, dual antennas, and supports both public network and analog intercom. With built-in Bluetooth, GPS positioning, and Type-C fast charging, the ZL8668 offers reliable and convenient communication for professional and recreational use.



Figure 1.1: KSUN ZL8668 Dual-Mode Walkie Talkie. This image shows the front view of the ZL8668 radio, highlighting its compact design and display screen.

## 2. PACKAGE CONTENTS

---

Please verify that all items listed below are included in your package. If any items are missing or damaged, please contact customer support.

- 1 x KSUN ZL8668 Mobile Radio
- 1 x 7.4V 3000mAh Rechargeable Li-ion Battery
- 1 x Type-C Fast Charging Cable
- 1 x Earpieces with Mic
- 1 x USB Power Adapter
- 1 x Belt Clip
- 1 x Hand Strap
- 1 x User's Manual
- 2 x Antennas (one for public network, one for analog)



Figure 2.1: Included Accessories. This image displays all the components that come with the KSUN ZL8668 radio, including the radio unit, battery, antennas, charging cable, power adapter, earpieces, belt clip, hand strap, and user manual.

Your browser does not support the video tag.

Video 2.1: ZL8668 Dual Mode UHF Band Radio Overview. This video provides a visual unboxing and brief demonstration of the KSUN ZL8668 radio and its included accessories, highlighting key features like the dual antenna and Type-C charging port.

### 3. PRODUCT OVERVIEW

---

Familiarize yourself with the various components and controls of your KSUN ZL8668 radio.



Figure 3.1: Labeled Diagram of Radio Components. This diagram points out key features such as the detachable antennas, On/Off/Volume button, LCD display screen, Public PTT, Simulate PTT, custom keys, headphone jack, fast charging port, hanging rope installation point, and back clip installation area.

- **Dual Antennas:** One for public network (4G/WiFi) and one for UHF analog communication.
- **LCD Display Screen:** Provides visual feedback for channels, settings, and status.
- **Dual PTT Buttons:** Separate Push-to-Talk buttons for public network and analog modes.
- **On/Off/Volume Button:** Rotary knob for power and volume control.
- **Custom Keys:** Programmable buttons for quick access to frequently used functions.
- **Type-C Charging Port:** For fast and convenient charging.
- **Headphone Jack:** 2-pin jack for connecting external earpieces or microphones.

## 4. SETUP

### 4.1 Battery Installation

1. Ensure the radio is powered off.
2. Align the 7.4V 3000mAh Li-ion battery with the battery compartment on the back of the radio.
3. Gently push the battery into place until it clicks securely.

### 4.2 Antenna Installation

1. Identify the two antennas provided: one for public network (longer) and one for analog (shorter).
2. Screw the appropriate antenna clockwise onto its designated port on top of the radio until finger-tight. Do not overtighten.

### 4.3 Charging the Battery

The ZL8668 supports Type-C fast charging.

1. Connect the Type-C charging cable to the charging port on the side of the radio.
2. Connect the other end of the cable to the USB power adapter, and then plug the adapter into a standard wall outlet.
3. The charging indicator on the radio will show the charging status. Ensure the radio is fully charged before first use.



Figure 4.1: High Battery and Fast Charging. This image illustrates the 3000mAh battery and the Type-C fast charging capability of the radio.

### 4.4 SIM Card Installation (Optional)

The radio features dual card slots for SIM cards (SIM cards are not included). This is required for 4G LTE network communication.

1. Locate the SIM card slots, typically under the battery compartment or on the side.
2. Insert your 4G compatible SIM card(s) into the designated slots, ensuring correct orientation.

## 5. OPERATING INSTRUCTIONS

### 5.1 Power On/Off

Rotate the On/Off/Volume knob clockwise to power on the radio. Rotate counter-clockwise until it clicks to power off.

### 5.2 Network & Analog Intercom

The ZL8668 supports both public network (4G/WiFi) and UHF analog communication. You can switch between modes or use both simultaneously.

- **Public Network Mode:** Connect to 4G, WiFi, or a mobile hotspot for communication over the network. This mode is ideal for long-range communication.
- **Analog Mode:** Communicate via UHF bands (450-470 MHz) without requiring a network connection. This is suitable for local, direct radio-to-radio communication.



Figure 5.1: Dual Mode Walkie Talkie. This image highlights the radio's ability to simultaneously support intercom on the public network (4G/WiFi) and UHF band (440MHz) for seamless communication.

### 5.3 Dual PTT Functionality

The radio is equipped with two PTT buttons to easily switch between communication modes without changing settings or antennas.

# Dual mode dual PTT

Public network PTT and analog PTT



Figure 5.2: Dual Mode Dual PTT. This image shows the two distinct PTT buttons on the side of the radio, one for public network PTT and one for analog PTT.

## 5.4 Bluetooth Functions

The built-in Bluetooth allows connection to wireless earpieces and microphones for hands-free operation.

1. Navigate to the Bluetooth settings on the radio's display.
2. Enable Bluetooth and search for available devices.
3. Select your Bluetooth earpiece or microphone to pair.

# Intelligent interconnection

Wi-Fi、Blue-tooth  
brings users multiple conveniences and uses

The Blue-tooth microphone shown in the picture is not standard and can be purchased by contacting customer service!



Major function	 <b>WiFi</b> Access the Internet via WiFi Implement remote communication and software updates Equal functions	 <b>Blue-tooth</b> Can link various Blue-tooth devices Implement communication and data transmission between devices
----------------	--	--

Figure 5.3: Intelligent Interconnection. This image illustrates the radio's WiFi and Bluetooth capabilities, showing a Bluetooth microphone accessory (not included) that can be paired with the device.

## 5.5 One-Key Frequency Copy

This feature allows for quick replication of channels between compatible walkie-talkies.

1. Place the ZL8668 radio near another compatible walkie-talkie.
2. Activate the One-Key Frequency Copy function (refer to the on-screen menu or custom key assignment).
3. The radio will automatically detect and copy the frequency settings.

# One-Key Pairing

One click frequency matching is simple and safe, making it easy to replicate channels between different factories and models of walkie talkies



Figure 5.4: One-Key Pairing. This image demonstrates the one-click frequency matching feature, simplifying channel replication between different radios.

## 5.6 Zello and Chat Platform Support

The ZL8668 runs on an Android system and supports various instant chat software, with the ZL APP installed by default for Push-to-Talk communication.

- **Accessing ZL APP:** Locate the ZL APP icon on the radio's display and tap to open.
- **Login/Account Creation:** Follow the on-screen prompts to sign in to an existing account or create a new one.
- **Using the Keyboard:** The radio's physical keypad can be used for text input. Press the appropriate key to switch between letter and numeric input modes.



Figure 5.5: Letter Keyboard Mode. This image shows the radio's display in letter input mode, indicating how to switch between different keyboard types.



Figure 5.6: Numeric Keyboard Mode. This image shows the radio's display in numeric input mode, useful for entering numbers or special characters.

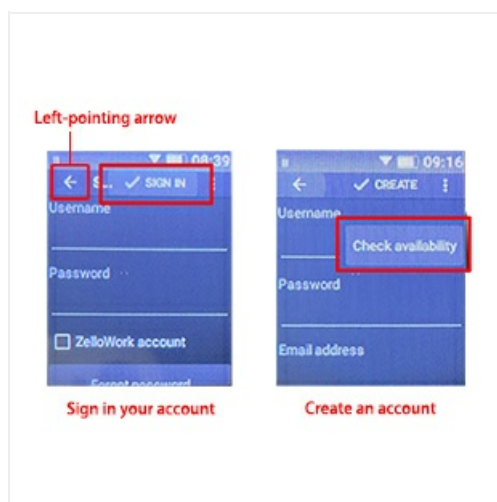

Figure 5.7: Sign In or Create Account Interface. This image displays the login screen for the Zello application, showing options to sign in or create a new account.

## 5.7 GPS Positioning

The integrated GPS function allows for location tracking and sharing. Ensure GPS is enabled in the radio's settings for accurate positioning.

## 5.8 Group Call / Single Call / Friend

Utilize the radio's menu to initiate group calls, single calls to specific contacts, or communicate with friends within your network.

## 5.9 Software Updates

The radio supports both over-the-air (Air Upgrade) and manual software updates to ensure optimal performance and access to new features.

## 6. MAINTENANCE

---

### 6.1 Battery Care

- Charge the battery fully before first use.
- Avoid overcharging or completely draining the battery to prolong its lifespan.
- Store the battery in a cool, dry place when not in use for extended periods.

### 6.2 Cleaning

- Wipe the radio's surface with a soft, damp cloth.
- Do not use harsh chemicals or abrasive cleaners.

### 6.3 Storage

When storing the radio for a long time, remove the battery and store it separately. Keep the radio in a dry, dust-free environment away from direct sunlight and extreme temperatures.

### 6.4 Water Resistance

Please note that this product is **Not Water Resistant**. Avoid exposing the radio to water or high humidity to prevent damage.

## 7. TROUBLESHOOTING

---

Problem	Possible Cause	Solution
Radio does not power on.	Battery is low or not installed correctly.	Charge the battery fully. Ensure the battery is securely installed.
Cannot log into Zello/chat platform.	Incorrect username/password; difficulty with text input.	<p>Double-check your username and password for accuracy.</p> <p>Ensure you are using the correct keyboard mode (letter/numeric) for input. Refer to Figures 5.5 and 5.6.</p> <p>If the input field clears, try entering characters slowly and confirming each input.</p> <p>Consider connecting a Bluetooth keyboard (if supported by the Android OS version) for easier input if persistent issues occur.</p> <p>Contact KSUN TFSI customer support for software-related assistance if the issue persists.</p>
Poor communication range/clarity.	Incorrect antenna used; weak signal; obstacles.	Ensure the correct antenna is attached for the mode (network/analog). Move to an area with better signal reception. Reduce obstacles between radios.
Bluetooth device not pairing.	Bluetooth not enabled; device out of range; device already paired elsewhere.	Ensure Bluetooth is enabled on both devices. Bring devices closer. Unpair from other devices if necessary.

If the problem persists after trying the above solutions, please contact KSUN TFSI customer support for further assistance. You may need to provide the program software if advanced configuration is required.



Figure 7.1: Program Port. This image shows the location of the program port on the side of the radio, which may be used for manual software updates or advanced configuration.

## 8. SPECIFICATIONS

---

Feature	Detail
Model Number	ZL8668
Brand	KSUN TFSI
Item Weight	10.6 ounces (approx. 300g)
Product Dimensions	1.37 x 2.86 x 4.8 inches (approx. 3.5 x 7.3 x 12.2 cm)
Battery	1 Lithium Polymer battery (7.4V 3000mAh, included)
Number of Channels	999
Frequency Range	450-470 MHz (UHF)
Talking Range Maximum	50 Kilometer (approx. 31 miles)
Tuner Technology	UHF
Voltage	7.4 Volts
Water Resistance Level	Not Water Resistant
Operating System	Android System
Special Features	Dual Mode Network & UHF, Long Range, One-Key Frequency Pairing, Push-to-Talk Walkie Talkie App, Type-C Charging, Dual PTT, Dual Antenna, Dual Card Slot, Dual Display, GPS position, Auto Squelch Function, PTT Voice Right Application/Preemption, Group Call/Single Call/Friend, Air Upgrade/Manual Upgrade.

## 9. WARRANTY AND SUPPORT

---

### 9.1 Warranty Information

The KSUN ZL8668 Mobile Radio comes with a **One Year Warranty** from the date of purchase. This warranty covers manufacturing defects and malfunctions under normal use. Please retain your proof of purchase for warranty claims.

### 9.2 Customer Support

For any questions, technical assistance, or warranty claims, please contact KSUN TFSI customer support. You can typically find contact information on the product packaging, the official brand website, or through the retailer where you purchased the product. If you require the program software for advanced configuration, please reach out to customer support.

