

manuals.plus /

› [GeekTale](#) /

› [GeekTale Fingerprint Deadbolt with App \(Model RD02\) - User Manual](#)

GeekTale RD02

GeekTale Fingerprint Deadbolt with App (Model RD02) - User Manual

Your guide to installation, operation, and maintenance.

1. PRODUCT OVERVIEW

The GeekTale Fingerprint Deadbolt (Model RD02) is a smart lock designed for keyless entry, offering multiple unlock methods including fingerprint, Bluetooth app, and traditional backup keys. It features quick fingerprint recognition and app-based user management.



Image: Overview of the GeekTale Fingerprint Deadbolt, showing the exterior unit with fingerprint sensor, the interior unit, and a smartphone displaying the control app.

Key Features:

- **3-in-1 Unlock Ways:** Fingerprint, Bluetooth App, and Backup Keys.
- **Fast Fingerprint Recognition:** 360° Fingerprint ID for 0.3-second unlock.
- **Smart App Control:** Manage up to 50 users, set auto-lock times (5-60s), view unlock records, and monitor battery level.
- **Remote Control (with Gateway):** Requires separate purchase of a gateway for remote unlock and notifications.
- **Durable Construction:** Outdoor lock made of aluminum alloy.

2. PACKAGE CONTENTS

Verify that all components are present before beginning installation.

- Exterior Fingerprint Unit
- Interior Deadbolt Unit

- Mounting Plate
- Deadbolt Latch
- Strike Plate
- Screws (various sizes)
- Backup Keys
- Installation Template

3. INSTALLATION GUIDE

This section provides step-by-step instructions for installing your GeekTale Fingerprint Deadbolt. A screwdriver is the primary tool required. The lock is designed to fit most standard US doors.

3.1 Door Compatibility Check

Ensure your door meets the following specifications:

- **Backset:** 2-3/4" (70mm) or 2-3/8" (60mm)
- **Door Hole Diameter:** 2-1/8" (54mm)
- **Door Thickness:** 1-3/8" to 2-1/8" (35mm to 54mm)



Image: Diagram illustrating door measurements for backset, door hole diameter, and door thickness, crucial for proper installation.

3.2 Installation Steps

1. **Prepare the Door:** If replacing an existing deadbolt, remove it. Use the provided template to mark and drill holes if installing on a new door.
2. **Install the Latch:** Insert the deadbolt latch into the door edge. Ensure the "UP" arrow on the latch is facing upwards. Secure with screws.
3. **Install Exterior Unit:** Route the cable from the exterior unit through the door hole. Align the spindle with the latch mechanism.
4. **Install Interior Mounting Plate:** Secure the mounting plate to the door using screws, ensuring the cable passes through the plate.
5. **Connect Cables:** Connect the cable from the exterior unit to the interior unit.
6. **Install Interior Unit:** Attach the interior unit to the mounting plate. Ensure the thumb turn operates smoothly.
7. **Insert Batteries:** Open the battery cover on the interior unit and insert 4 AA batteries (not included).

8. **Test Operation:** Manually test the deadbolt with the thumb turn.



Image: Exploded view of the deadbolt components, illustrating how the exterior and interior units connect through the door.

3.3 Spindle Orientation for Right/Left Opened Doors

The spindle on the exterior knob should be in the horizontal position for both right-opened and left-opened doors. When installing the interior lock, ensure the knob is oriented correctly:

- For right-opened doors, the interior knob should be in a vertical state.
- For left-opened doors, the interior knob should be in a horizontal state.



Image: Visual guide for correctly orienting the spindle and interior knob based on door opening direction.

4. OPERATING INSTRUCTIONS

Learn how to use your smart deadbolt effectively.

4.1 Initial Setup and App Pairing

1. **Download the App:** Search for "GeekTale" in your smartphone's app store and download the official application.
2. **Create Account:** Register for a new account or log in if you already have one.
3. **Add Device:** Follow the in-app instructions to add your new deadbolt. Ensure Bluetooth is enabled on your phone and you are within range of the lock.
4. **Administrator Fingerprint:** The first fingerprint registered will typically be the administrator.

Three Unlock Ways



Image: Illustration of the three primary unlock methods: fingerprint, Bluetooth app, and physical key.

4.2 Unlocking and Locking

- **Fingerprint Unlock:** Place a registered finger on the fingerprint sensor. The lock will unlock in approximately 0.3 seconds.
- **App Unlock:** Open the GeekTale app, ensure Bluetooth connection, and tap the unlock icon.
- **Key Unlock:** Use the provided backup keys in the emergency keyhole.
- **Auto-Lock:** Configure auto-lock duration (5-60 seconds) via the app. The lock will automatically engage after the set time.
- **One-Touch Locking:** Touch the fingerprint sensor with any finger to instantly lock the deadbolt.



Image: A woman carrying groceries, demonstrating the convenience of the auto-lock feature after entering her home.

4.3 App Features

- **User Management:** Add or delete up to 50 users (fingerprints).
- **Access Log:** Review a history of unlock events, including method and user.
- **Auto-Lock Settings:** Adjust the automatic locking delay.
- **Mute Mode:** Silence lock sounds for quiet operation.
- **Share E-Key:** Grant temporary or permanent access to others via the app.
- **Battery Status:** Monitor the current battery level of the lock.



Image: Screenshot of the GeekTale app interface, highlighting options for member management, access logs, and settings.

4.4 Remote Access (Gateway Required)

For remote control and notifications, a GeekTale Gateway (sold separately) is required. This allows you to:

- Unlock/lock the door from anywhere.
- Receive instant notifications when the lock is opened.

- Integrate with voice assistants like Alexa and Google Assistant.



Image: Depiction of the smart deadbolt, a gateway device, and a smartphone, illustrating remote unlock capabilities.

5. MAINTENANCE

Proper maintenance ensures the longevity and optimal performance of your deadbolt.

- **Battery Replacement:** The lock requires 4 AA batteries. Replace them when the low battery alert is issued by the app or the lock itself.
- **Emergency Power:** In case of complete battery depletion, the lock features a USB-C port for emergency power using a power bank.
- **Cleaning:** Wipe the exterior unit and fingerprint sensor with a soft, dry cloth. Avoid abrasive cleaners or solvents.
- **Keyhole Maintenance:** Periodically check the keyhole for obstructions. Do not lubricate with oil-based products; use graphite powder if lubrication is needed.



Image: Illustration of the deadbolt's battery compartment and the USB-C port for emergency power, along with icons for low battery alert and emergency charge.

6. TROUBLESHOOTING

Common issues and their solutions.

Problem	Possible Cause	Solution
Lock does not respond.	Dead batteries.	Replace batteries. Use emergency USB-C power if needed.
Fingerprint not recognized.	Fingerprint not registered, dirty sensor, or incorrect placement.	Ensure finger is clean and dry. Re-register fingerprint if necessary. Place finger flat on sensor.
App cannot connect to lock.	Bluetooth off, out of range, or app issue.	Ensure Bluetooth is on. Move closer to the lock. Restart the app or your phone.
Auto-lock not working.	Auto-lock feature disabled or incorrect setting.	Check auto-lock settings in the app and ensure it is enabled with a desired delay.
Lock is loose after installation.	Screws not tightened sufficiently.	Re-tighten all mounting screws. Ensure the mounting plate is flush against the door.

7. SPECIFICATIONS

Feature	Detail
Model Name	RD02
Brand	GeekTale
Unlock Methods	Fingerprint, Bluetooth App, Backup Key
Fingerprint Capacity	Up to 50
Recognition Speed	0.3 seconds
Connectivity	Bluetooth
Material	Aluminum (exterior)
Power Source	4 x AA Batteries (not included)
Emergency Power	USB-C Port
Door Thickness	1-3/8" to 2-1/8" (35mm to 54mm)
Backset	Adjustable 2-3/8" (60mm) or 2-3/4" (70mm)
Dimensions (L x W x H)	2.76 x 1.18 x 3.93 inches (Exterior unit)
Weight	1.63 pounds (0.74 kg)

8. WARRANTY AND SUPPORT

GeekTale provides localized after-sales customer service. For any product-related issues or inquiries, please contact customer support through the designated after-sales channels. Refer to your purchase documentation for specific warranty terms and contact information.



Contact Support: Please refer to the contact information provided with your product packaging or visit the official GeekTale website for support options.

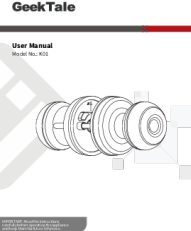

Related Documents - RD02

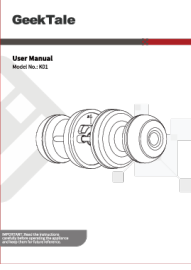
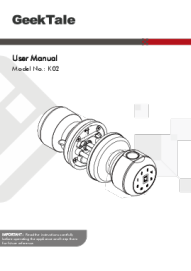
	<p>GeekTale K01 Smart Door Lock User Manual and Installation Guide</p> <p>Detailed user manual for the GeekTale K01 smart door lock. Covers features, technical specifications, packing list, installation guide, app integration (GeekSmart), fingerprint management, key unlock, and indicator lights. Learn how to set up and use your smart lock.</p>
---	---

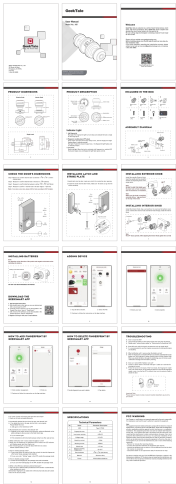
	<p>GeekTale K11 Smart Lock User Manual and Installation Guide</p> <p>Comprehensive user manual for the GeekTale K11 smart lock, covering installation, product description, features, troubleshooting, and specifications. Learn how to set up and use your smart lock with fingerprint and app control.</p>
 The image shows the cover of the 'GeekTale User Manual' for Model No. K01. It features a technical line drawing of a cylindrical smart lock assembly with a fingerprint sensor. The text 'GeekTale' is at the top, followed by 'User Manual' and 'Model No. K01'.	<p>GeekTale K01 Smart Fingerprint Doorknob Lock User Manual</p> <p>Comprehensive user manual for the GeekTale K01 Smart Fingerprint Doorknob Lock, detailing features, specifications, installation steps, app integration, security modes, and troubleshooting.</p>
 The image shows the cover of the 'GeekTale User Manual' for Model No. K02. It features a technical line drawing of a smart lock assembly. The text 'GeekTale' is at the top, followed by 'User Manual' and 'Model No. K02'.	<p>GeekTale K02 Smart Lock User Manual</p> <p>Comprehensive user manual for the GeekTale K02 Smart Lock, covering installation, features, app integration, and troubleshooting. Learn how to set up your smart lock for enhanced home security.</p>

	<p>GeekTale K01 Smart Door Lock User Manual - Installation, Features, and Troubleshooting</p> <p>Comprehensive user manual for the GeekTale K01 smart door lock. Includes installation instructions, product features, app integration, troubleshooting guide, and technical specifications.</p>
	<p>GeekTale L-B01/B02 Smart Fingerprint Door Lock User Manual</p> <p>User manual for the GeekTale L-B01/B02 Smart Fingerprint Door Lock, covering product description, packaging, installation, usage, troubleshooting, and specifications.</p>

Documents - GeekTale – RD02

[\[pdf\]](#) User Manual Installation Guide Instructions Dimension Guide Catalog

RD02 96x135mm 2023 4 11 ANDY A Remove then reinstall the batteries press and hold Set Button until fingerprint indicator flash red light enter reader for 817d6601 2b0c 4e11 9113 9ad64dfdcf0eimages thdstatic catalog Images 81 817d6601 9ad64dfdcf0e for 6f1e0704 cc51 4330 b460 0e4270a3b5db817d6601 6f 6f1e0704 0e4270a3b5dbimages for ② Select smart lock 1 Adding new door by app Note Keep your phone close during this process6f1e0704 9ad64dfdcf0e29c2edb1 3cfa 46ce 8286 3cf63e72d622images 29 29c2edb1 3cf63e72d622 ||| ||| User Manual Model No.: RD02 GEEK TECHNOLOGY CO., LTD 120 Route 46 West, Parsippany, NJ 07054, Toll Free 1-844-801-8880 IMPORTANTRead the instructions carefully before operating the appliance and keep them for future reference. CHECK THE DOO ||| User Manual Model No.: RD02 GEEK TECHNOLOGY CO., LTD 120 Route 46 West, Parsippany, NJ 07054, Toll Free 1-844-801-8880 IMPORTANTRead the instructions carefully before operating the appliance and keep them for future reference. CHECK THE DOO User Manual Model No.: **RD02** GEEK TECHNOLOGY CO., LTD 120 Route 46 West, Parsippany, NJ 07054, Toll Free 1-844-801-8880 IMPORTANTRead the instructions carefully before operating the appliance and keep them for future reference. CHECK THE DOOR S DIMENSIONS Step 1: Measure to confirm that the door i...

lang:en score:39 filesize: 1.23 M page_count: 1 document date: 2023-05-29

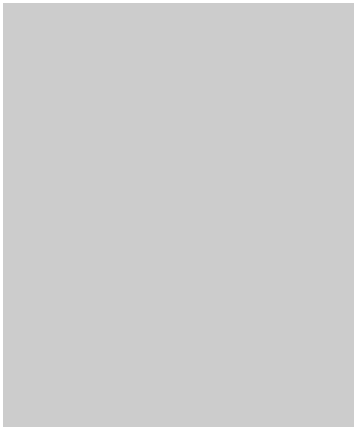

[\[pdf\]](#) User Manual Installation Guide Instructions Dimension Guide Catalog

RD02 96x135mm 2023 4 11 ANDY Note Turn the interior panel knob to check if deadbolt protrudes Q
My smart lock manually locks but doesn't connect phone A Go 79cf94f7 72e9 445c a57c 006449eb06dc
images thdstatic catalog Images 79 |||

User Manual Model No.: **RD02** GEEK TECHNOLOGY CO., LTD 120 Route 46 West,
Parsippany, NJ 07054, Toll Free 1-844-801-8880 IMPORTANTRead the instructions
carefully before operating the appliance and keep them for future reference. CHECK
THE DOOR S DIMENSIONS Step 1: Measure to confirm that the door i...

lang:en score:33 filesize: 1.23 M page_count: 1 document date: 2023-05-29

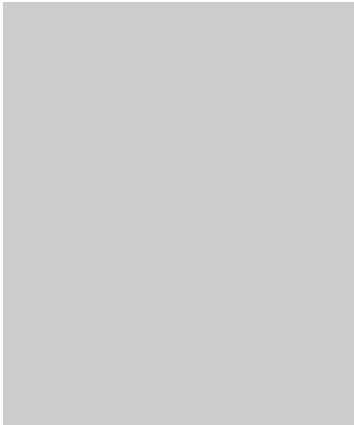

[\[pdf\]](#) User Manual Instructions

F02 96x135mm 20230210 1 Users Manual GEEK TECHNOLOGY CO LTD RD02 Deadbolt lock
2A5ZQ 2A5ZQRD02 rd02

User Manual Model No.: RD01 GEEK TECHNOLOGY CO., LTD 120 Route 46 West,
Parsippany, NJ 07054, Toll Free 1-844-801-8880 IMPORTANTRead the instructions
carefully before operating the appliance and keep them for future reference.

WELCOME GeekTale bids you welcome to a world of smart home devices, sm...

lang:en score:27 filesize: 902.44 K page_count: 1 document date: 2023-06-27

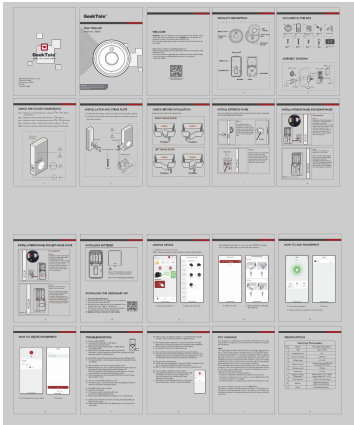

[\[pdf\]](#) User Manual Installation Guide Instructions Dimension Guide Catalog

User ManualQ Speaker does not make noise when unlocking and locking although Smart lock has power
A1 Please check the GEEK APP in setting to see if you have 5e02358e d60b 4e4f be24
945c93c945caimages thdstatic catalog Images 5e 5e02358e 945c93c945ca |||

User Manual Model No.: **RD02** GEEK TECHNOLOGY CO., LTD 120 Route 46 West,
Parsippany, NJ 07054, Toll Free 1-844-801-8880 IMPORTANTRead the instructions
carefully before operating the appliance and keep them for future reference. CHECK
THE DOOR S DIMENSIONS Step 1: Measure to confirm that the door i...

lang:en score:21 filesize: 1.18 M page_count: 1 document date: 2023-05-29