

KINDEEP BT001

KINDEEP Smart Key Finder (Model BT001) User Manual

Your guide to setting up and using your KINDEEP Smart Key Finder.

1. INTRODUCTION

The KINDEEP Smart Key Finder (Model BT001) is a compact Bluetooth tracking device designed to help you locate your valuable items. It integrates seamlessly with the Apple Find My network, allowing you to track items such as keys, wallets, bags, and even pets using your iOS devices. This manual provides detailed instructions for setup, operation, maintenance, and troubleshooting.

Note: This product is compatible with iOS devices only and does not support Android.



Image 1.1: KINDEEP Smart Key Finder (Model BT001) devices.

2. SETUP AND PAIRING

Follow these steps to pair your KINDEEP Smart Key Finder with your iOS device:

1. **Prepare your iOS Device:** Ensure Bluetooth and Location Services are enabled on your iPhone or iPad. Open the 'Find My' app.
2. **Add New Item:** In the 'Find My' app, navigate to the 'Items' tab. Tap the '+' icon (Add Item) and then select 'Other Supported Item'.
3. **Activate Tracker:** Press and hold the button on your KINDEEP Smart Key Finder for approximately 10 seconds until you hear a beep sound.
4. **Connect:** Your iOS device should detect the tracker. Tap 'Connect' when prompted.
5. **Name and Identify:** Assign a name and an emoji to your tracker for easy identification within the 'Find My' app.

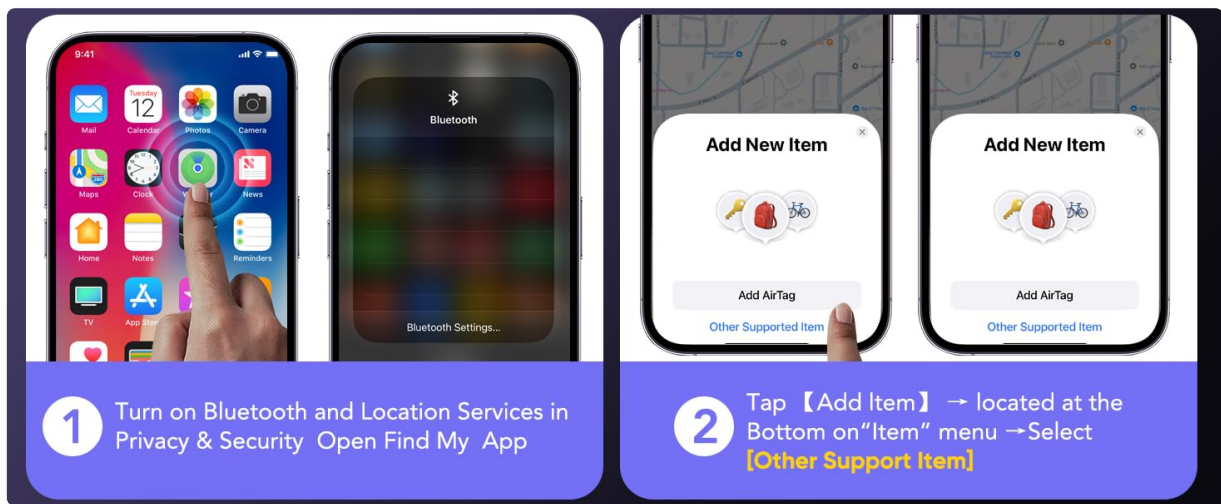

Image 2.1: Steps 1 and 2 for pairing the KINDEEP Smart Key Finder with the Find My app.

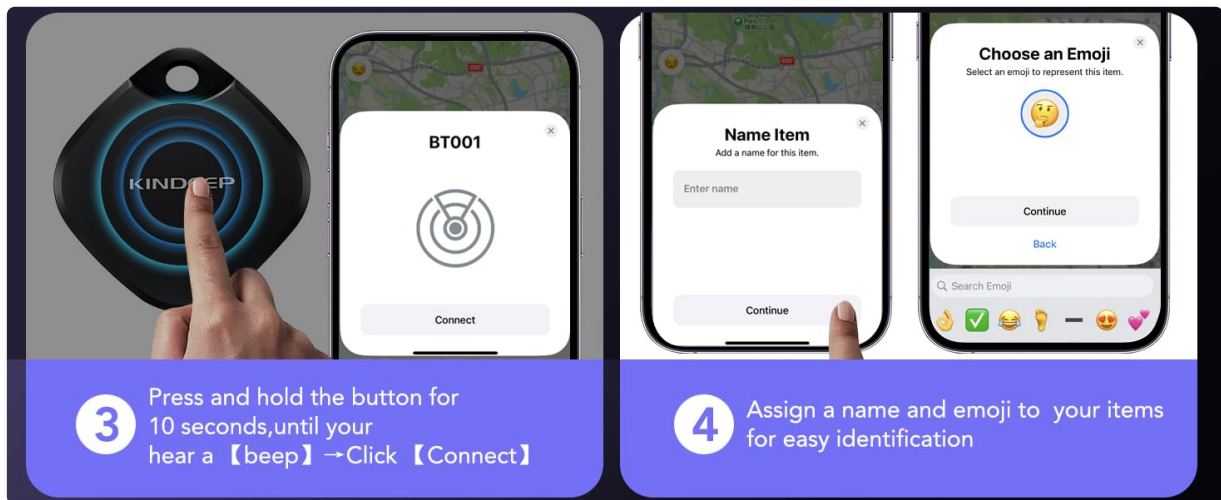

Image 2.2: Steps 3 and 4 for activating and connecting the KINDEEP Smart Key Finder.

3. OPERATING INSTRUCTIONS

3.1 Finding Nearby Items

When your KINDEEP Smart Key Finder is within Bluetooth range (up to 200ft/60m), you can use the 'Find My' app to locate it. Tap 'Play Sound' in the app, and the tracker will emit a loud beep (80-100 dB) to help you pinpoint its location. You can also ask Siri for assistance.

Find Nearby

Simply ring with 'Play Sound' to instantly locate your item



Image 3.1: Using the 'Play Sound' feature to locate a nearby item.

3.2 Finding Far Away Items

If your item is out of Bluetooth range, the 'Find My' app will display its last known location on a map. The Find My network, composed of millions of Apple devices, can anonymously and securely detect your tracker's location and relay it to you. You can then use the map navigation feature in the app to guide you to the item's location.

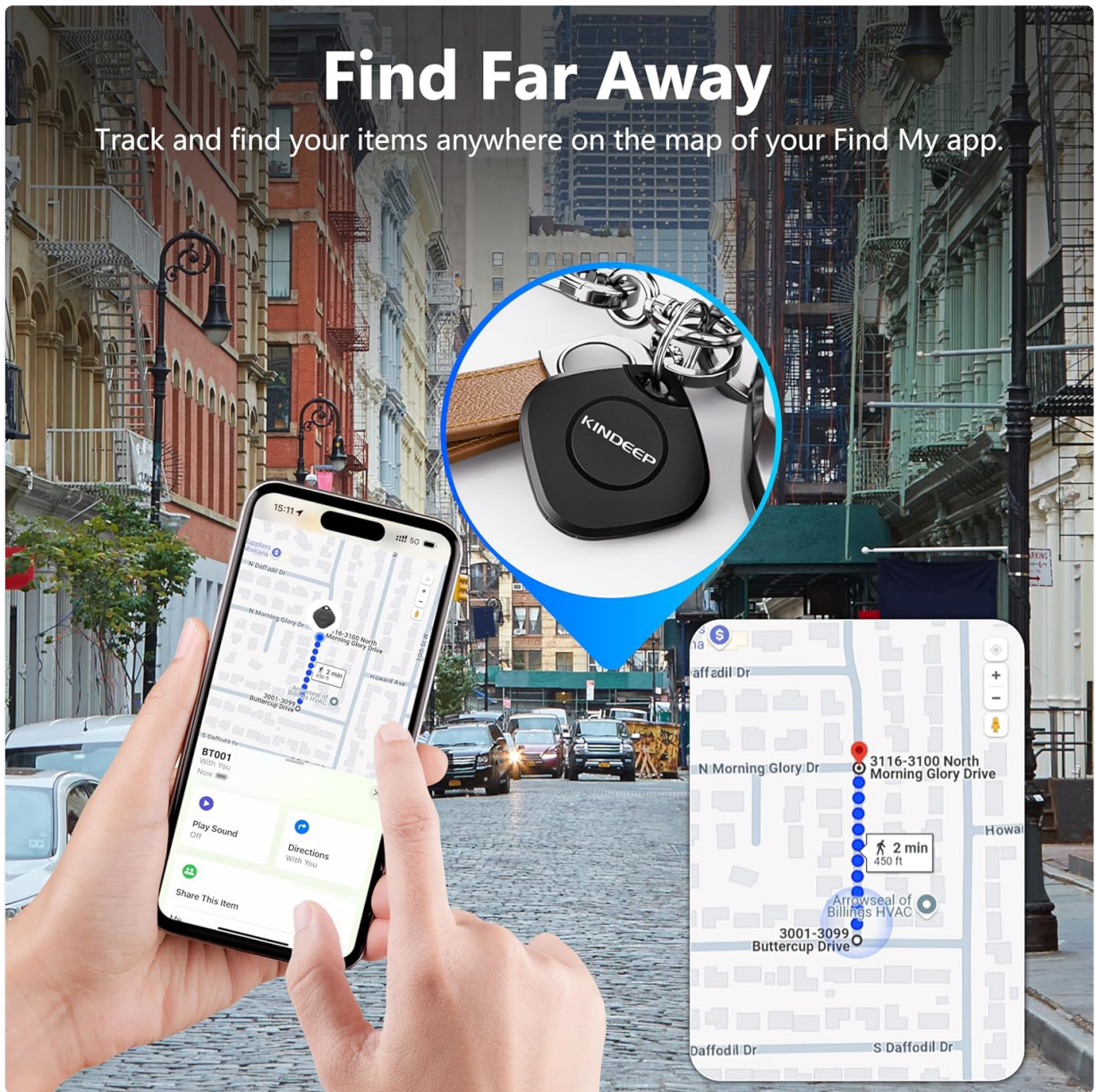

Image 3.2: Tracking a KINDEEP Smart Key Finder on a map when out of Bluetooth range.

3.3 Left-Behind Remind & Lost Mode

- **Left-Behind Remind:** If your item with the tracker is left behind and disconnects from your iOS device's Bluetooth, the 'Find My' app will send an instant notification to alert you.
- **Lost Mode:** If an item is truly lost, you can activate 'Lost Mode' in the 'Find My' app. You can enter your contact information, and if another Apple device user finds your item, they can access your contact details to help return it. All communication within the Find My network is anonymous and encrypted to protect your privacy.

Left-Behind Remind



"Keys" left behind

This item is no longer detected near you. It was last seen near gregory meola*****



Image 3.3: Example of a 'Left-Behind Remind' notification.

3.4 Location Sharing Feature

The KINDEEP Smart Key Finder supports location sharing through the Find My app. You can invite up to 5 additional people to view the item's real-time location on a map, facilitating collaborative recovery. No tracking notifications will be sent when the shared item approaches others' devices, ensuring user privacy.

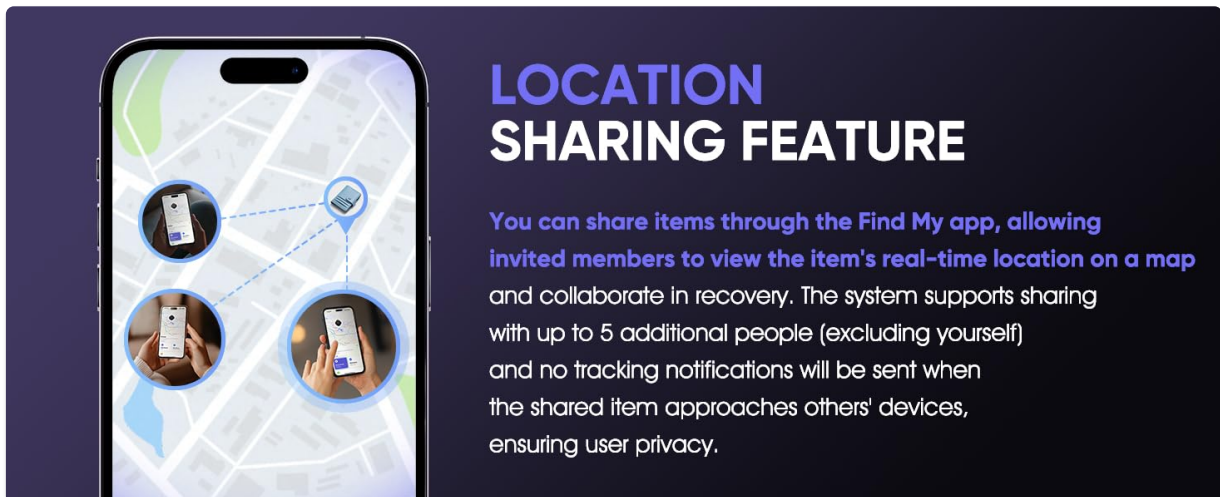

Image 3.4: Visual representation of the location sharing feature.

3.5 Privacy Protection

All communication within the Find My network is anonymous and encrypted. Location data and history are never stored directly on the KINDEEP Smart Key Finder, ensuring your privacy and security.



Image 3.5: The KINDEEP Smart Key Finder offers robust privacy protection.

4. MAINTENANCE

4.1 Battery Replacement

The KINDEEP Smart Key Finder uses a replaceable CR2032 coin cell battery. The battery can last up to one year. When the battery is low, the 'Find My' app will notify you to replace it. To replace the battery:

1. Carefully open the tracker casing using a small tool or your fingernail at the designated notch.
2. Remove the old CR2032 battery.
3. Insert a new CR2032 battery with the positive (+) side facing up.
4. Close the casing securely, ensuring a tight seal.



Image 4.1: The KINDEEP Smart Key Finder features a replaceable CR2032 battery.

4.2 Water Resistance

The KINDEEP Smart Key Finder has an IP67 waterproof rating, meaning it is protected from dust and can withstand immersion in water up to 1 meter for 30 minutes. This makes it suitable for outdoor use and protects against accidental splashes. However, it is not recommended for prolonged submersion or use

during swimming.



Image 4.2: The KINDEEP Smart Key Finder is IP67 water resistant.

5. TROUBLESHOOTING

- **Tracker not connecting:**

- Ensure Bluetooth and Location Services are enabled on your iOS device.
- Make sure the tracker's battery is not depleted. Replace if necessary.
- Try restarting your iOS device and the 'Find My' app.
- Ensure the tracker is within Bluetooth range during initial pairing.

- **No sound from tracker:**

- Check if the tracker's battery is low.
- Ensure the tracker is within Bluetooth range of your iOS device.
- Verify that the volume on your iOS device is not muted or too low.

- **Inaccurate location:**

- Location accuracy can be affected by environmental factors (e.g., dense urban areas, indoors).
- Ensure your iOS device has a stable internet connection for updated location data.

- **Battery drains quickly:**

- Frequent use of the 'Play Sound' feature can consume more battery.
- Ensure you are using a fresh, high-quality CR2032 battery.

6. SPECIFICATIONS

Feature	Specification
Model Number	BT001
Product Dimensions	4.25 x 3.15 x 0.5 inches (10.8 x 8 x 1.27 cm)
Item Weight	1.76 ounces (50 grams)

Battery Type	1 x CR2032 (included, replaceable)
Battery Life	Up to 1 year
Connectivity	Bluetooth
Bluetooth Range	Up to 200ft / 60m
Sound Level	80-100 dB
Water Resistance	IP67
Compatible Devices	iOS devices (iPhone, iPad) with Find My App, Siri
Color	Black
Material	Plastic



Image 6.1: Key specifications and features of the KINDEEP Smart Key Finder.

7. WARRANTY AND SUPPORT

For warranty information, please refer to the documentation included with your product packaging or contact KINDEEP customer support directly. If you encounter any issues not covered in this manual or require further assistance, please reach out to KINDEEP customer service. Contact information for support is typically available on the product packaging or the official KINDEEP website.