



[Manuals.plus](#) /

› [ComfyStyle](#) /

› ComfyStyle Triple Sliding Shower Door 44-48"W x 70"H Instruction Manual

ComfyStyle Triple Sliding Shower Door 44-48"W x 70"H

ComfyStyle Triple Sliding Shower Door 44-48"W x 70"H Instruction Manual

Model: Triple Sliding Shower Door 44-48"W x 70"H

1. INTRODUCTION

This manual provides essential information for the installation, operation, and maintenance of your ComfyStyle Triple Sliding Shower Door. Please read these instructions thoroughly before beginning installation or use to ensure proper function and safety.

The ComfyStyle Triple Sliding Shower Door features a versatile design with 1/4" (6mm) clear SGCC tempered glass and a matte black finish. It is designed for shower openings between 44 and 48 inches in width and 70 inches in height, offering a walk-through width of up to 24 1/4 inches.



Image 1.1: ComfyStyle Triple Sliding Shower Door, Matte Black finish.

2. SAFETY INFORMATION

Always adhere to the following safety guidelines during installation and use:

- **Glass Handling:** Tempered glass is strong but can shatter if struck at the edges. Handle all glass panels with care.
- **Personal Protective Equipment:** Wear safety glasses, gloves, and appropriate footwear during installation.
- **Two-Person Installation:** Due to the weight and size of the glass panels, a minimum of two people is required for safe installation.
- **Structural Integrity:** Ensure the shower enclosure walls are structurally sound and capable of supporting the weight of the shower door.
- **Proper Sealing:** Apply silicone sealant as instructed to prevent water leakage and ensure a secure installation.
- **Children and Pets:** Keep children and pets away from the installation area.

3. PACKAGE CONTENTS

Verify that all components are present and undamaged before beginning installation. Refer to the separate detailed parts list included with your product for specific quantities and identification.

- Tempered Glass Panels (3)
- Top Guide Bar (Stainless Steel/Aluminum Alloy)
- Wall Jamb
- Door Handles (304 Stainless Steel)
- Roller Assemblies / Pulleys
- Bottom and Side Seal Strips
- Mounting Hardware (screws, anchors, etc.)

CONFIGURATION DIMENSIONS

A SHOWER DOOR HEIGHT	B Min/Max width	C WALK-THROUGH WIDTH
70"	44"-48"	24 1/4"
	50"-54"	28 1/8"
	56"-60"	32 1/8"



Image 3.1: Exploded view of shower door components.

4. INSTALLATION GUIDE

This section provides an overview of the installation process. For detailed, step-by-step instructions, including specific measurements and drilling requirements, please refer to the dedicated installation manual provided with your product.

4.1. Pre-Installation Checks

- **Measure Opening:** Confirm your shower opening width is between 44 and 48 inches and height is 70 inches.
- **Level Surface:** Ensure the shower base or curb is level.
- **Wall Preparation:** Walls should be finished and capable of supporting the door's weight.
- **Tools Required:** Gather all necessary tools as listed in the detailed installation manual (e.g., drill, level, tape measure, screwdriver, silicone sealant).



Image 4.1: Configuration dimensions for the shower door.

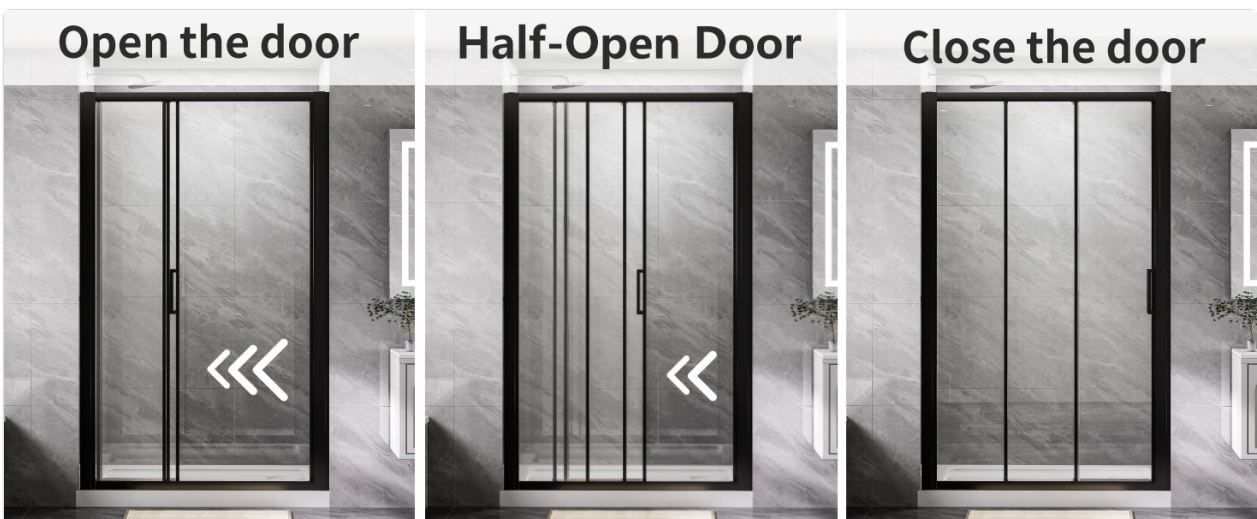

Image 4.2: Detailed configuration dimensions table.

4.2. Key Installation Steps (Overview)

1. Install the top guide bar and wall jambs, ensuring they are level and plumb. The top guide bar can be

trimmed up to 4 inches for width customization.

2. Attach roller assemblies to the glass panels.
3. Carefully hang the glass panels onto the top guide bar.
4. Install the door handles onto the glass panels.
5. Apply bottom and side seal strips to prevent water leakage.
6. Apply silicone sealant to all exterior seams as per the detailed instructions.

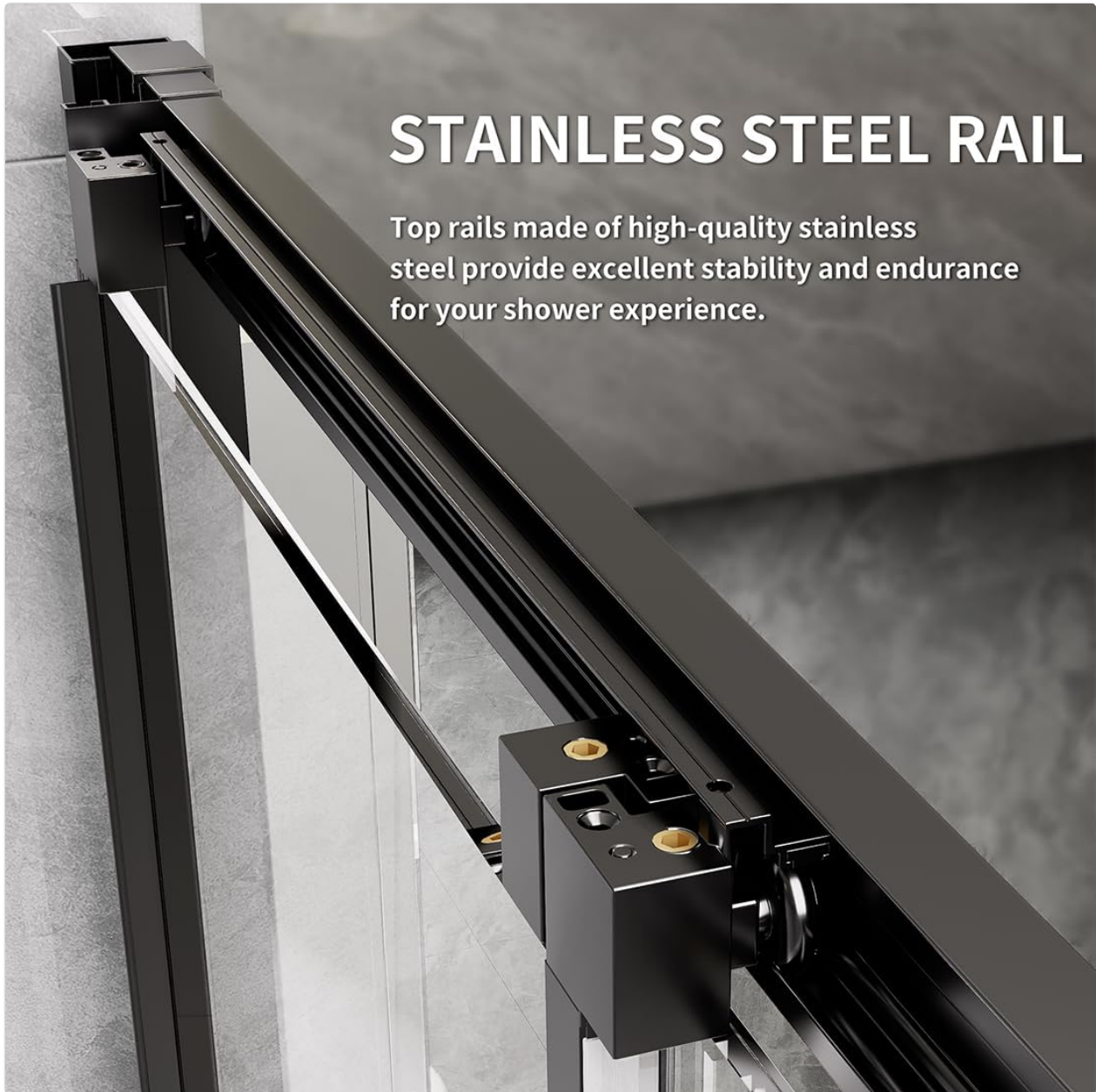

Image 4.3: Stainless steel top rail system.



ALUMINIUM ALLOY HIGH-QUALITY STURDY TOP RAIL

Image 4.4: Aluminum alloy top rail and pulley system.



304 Stainless Steels Handle Matte Black

Image 4.5: Matte black 304 stainless steel handle.

4.3. Reversible Installation

The shower door features a reversible design, allowing the panels to slide either to the right or left based on your preference and bathroom layout. This flexibility is determined during the initial assembly of the top guide bar and wall jamba.

 A central image shows a complete shower door installation in a modern bathroom with grey wall tiles and a white vanity. Surrounding this central image are five callout boxes with white borders and lines pointing to specific features:

- ALUMINIUM ALLOY HIGH-QUALITY STURDY TOP RAIL**: A close-up of the top rail assembly.
- PULLEY**: A close-up of the pulley mechanism.
- Excellent Water Leakage Performance**: A close-up of the bottom edge of the door with the text: "Equipped with a special T-shaped and full cover water seal strips to prevent water from leaking out to the floor." Below this is the label **WATERPROOF ADHESIVE STRIPS**.
- THE SHOWER DOOR CAN BE ADJUSTED TO BETTER FIT YOUR BATHROOM.**: A close-up of the adjustable wall jamb with the word "adjustable" written above it. Below this is the label **WALL JAMB**.
- 304 Stainless Steels Handle Matte Black**: A close-up of the handle. Below this is the label **HANDLE**.

5. OPERATING INSTRUCTIONS

The ComfyStyle Triple Sliding Shower Door is designed for smooth and easy operation, providing a wide entry access.

- To open the door, gently slide the desired glass panel along the top guide bar.
- The triple-fold design allows for multiple configurations, including fully open, partially open, or closed.
- When closing, ensure the magnetic seals engage fully to prevent water from escaping the shower area.



Image 5.1: Door opening directions.



Image 5.2: Door positions: Open, Half-Open, and Closed.

6. MAINTENANCE AND CLEANING

Regular cleaning and maintenance will ensure the longevity and appearance of your shower door.

6.1. Glass Cleaning

The shower door features easy-clean glass, which helps repel water spots and soap scum, reducing cleaning effort.

- For daily cleaning, wipe down the glass with a soft cloth or squeegee after each use.
- For deeper cleaning, use a non-abrasive glass cleaner or a solution of mild soap and water.
- Avoid using abrasive cleaners, scouring pads, or harsh chemicals, as these can damage the glass coating and finish.

EASY CLEAN



Without Easy-Clean Coating

Vs



With Easy-Clean Coating



Z97.1 certified
2406.1.1-CPSC 16 CFR 1201

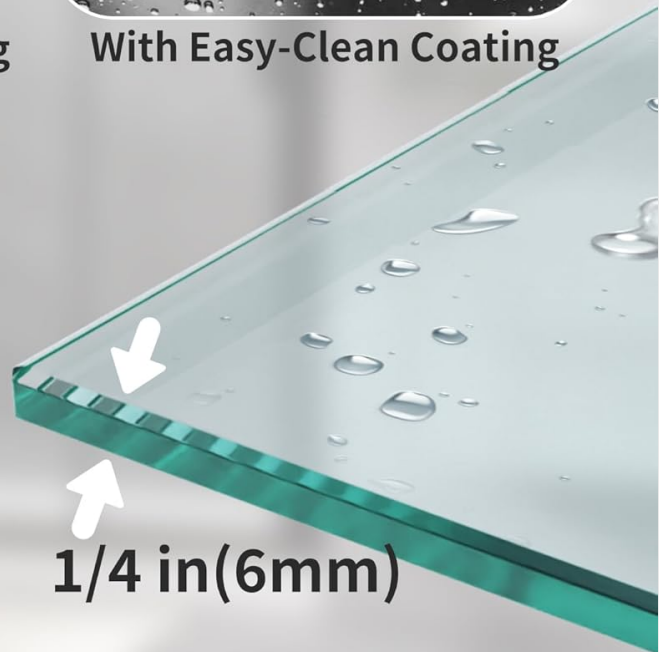

Image 6.1: Easy-clean glass coating demonstration.

6.2. Frame and Hardware Cleaning

- Wipe the matte black frame and stainless steel hardware with a soft, damp cloth.
- Avoid using abrasive cleaners or solvents that could damage the finish.
- Periodically check all screws and fasteners to ensure they are tight. Do not overtighten.

7. TROUBLESHOOTING

This section addresses common issues you might encounter with your shower door.

7.1. Water Leakage

- **Issue:** Water leaks from the bottom or sides of the door.
- **Solution:**
 - a. Ensure all seal strips (bottom and side) are properly installed and in good condition. Replace if damaged.
 - b. Verify that silicone sealant was applied correctly and completely to all exterior seams during

installation. Reapply sealant if necessary.

- c. Check if the shower base or curb is level. An unlevel surface can cause gaps.



Image 7.1: Anti-splash threshold and seal strips.

7.2. Door Not Sliding Smoothly

- **Issue:** Doors are stiff or difficult to slide.
- **Solution:**
 - a. Clean the top guide bar and roller assemblies to remove any debris or soap scum buildup.
 - b. Inspect the roller wheels for damage or wear.
 - c. Ensure the top guide bar is level and properly secured.

7.3. Gaps Between Panels or Wall

- **Issue:** Visible gaps exist between glass panels or between the panels and the wall jambs.
- **Solution:**
 - a. Verify that the wall jambs are installed plumb and the top guide bar is level. Adjust if necessary.
 - b. Ensure all glass panels are correctly seated in their roller assemblies and aligned.

c. Check the condition and placement of the magnetic and vinyl seal strips.

8. PRODUCT SPECIFICATIONS

Feature	Specification
Brand	ComfyStyle
Model	Triple Sliding Shower Door
Size (Adjustable Width)	44"-48" W x 70" H
Glass Thickness	1/4" (6mm)
Glass Type	Clear SGCC Tempered Glass with Explosion-Proof Film
Finish	Matte Black
Walk-Through Width	Up to 24 1/4"
Handle Material	304 Stainless Steel
Rail Material	Stainless Steel / Aluminum Alloy
Item Weight	80.4 pounds
UPC	658215401640
ASIN	B0DFWRK1B2

9. WARRANTY AND SUPPORT

ComfyStyle products are manufactured to high-quality standards. For information regarding product warranty, please refer to the warranty documentation included with your purchase or contact ComfyStyle customer support.

If you require assistance with installation, troubleshooting, or have any questions about your ComfyStyle Triple Sliding Shower Door, please contact our customer support team. Contact details can typically be found on our official website or on the product packaging.