

Manuals+

[Q & A](#) | [Deep Search](#) | [Upload](#)

[manuals.plus](#) /

› [DeLonghi](#) /

› [DeLonghi Coffee Maker Boiler Filter 6013213181 Instruction Manual](#)

DeLonghi 6013213181

DeLonghi Coffee Maker Boiler Filter 6013213181 Instruction Manual

Brand: DeLonghi | Part Number: 6013213181

1. INTRODUCTION AND PRODUCT OVERVIEW

This document provides essential information for the DeLonghi Coffee Maker Boiler Filter, part number 6013213181. This component is a crucial replacement part designed to maintain the optimal performance and longevity of compatible DeLonghi coffee machines. It functions as a shower screen, ensuring proper water distribution during the brewing process.

2. PRODUCT IDENTIFICATION AND COMPATIBILITY

The DeLonghi Coffee Maker Boiler Filter, part number 6013213181, is a 40.0 mm shower screen (NO 100). It is compatible with a wide range of DeLonghi coffee maker models. Please verify your machine's model number against the list below to ensure proper fitment.



Figure 1: A close-up view of the metallic DeLonghi Coffee Maker Boiler Filter, part number 6013213181, showing its circular shape and central opening.

Compatible Models:

- ESAM02.110.SB, ESAM04.110.B, ESAM3000.B EX:1, ESAM5400
- ECAM20.110.B-S11-0132213119, ECAM21.110.B-S11-0132213069, ECAM21.110.SB-S11-0132213108, ECAM21.116.B-S11-0132213097, ECAM21.117.B-0132213056, ECAM21.117.B-S11-0132213085, ECAM21.117.W-S11-0132213093, ECAM21.210.B-0132213019, ECAM21.210.B-0132213021, ECAM21.210.W-0132213022, ECAM22.110.B-0132213027, ECAM22.110.B-S11-0132213067, ECAM22.110.SB-0132213029, ECAM22.110.SB-S11-0132213068, ECAM22.113.B-S11-0132213116, ECAM22.320.B-0132213065, ECAM22.320.B-S11-0132213088, ECAM22.320.SB-0132213051, ECAM22.323.B-S11-0132213117, ECAM22.360.B-S11-0132215249, ECAM22.360.S-S11-0132215245
- ECAM23.120.B-0132213054, ECAM23.120.B-S11-0132213084, ECAM23.120.SB-0132213053, ECAM23.120.SB-S11-0132213083, ECAM23.123.B-S11-0132213118, ECAM23.125.B-S11-0132213128, ECAM23.210.B-NN1-0132213024, ECAM23.210.B-NN1-S11-0132213096, ECAM23.210.W-0132210004, ECAM23.210.W-0132213023, ECAM23.210.W-NN1-S11-0132213095, ECAM23.420.SB-0132214033, ECAM23.420.SB-0132214041, ECAM23.420.SB-0132214060, ECAM23.420.SB-S11-0132214068, ECAM23.420.SR-0132214034, ECAM23.420.SR-0132214061, ECAM23.420.SR-S11-0132214071, ECAM23.420.SW-0132214032, ECAM23.420.SW-0132214059, ECAM23.427.R-0132214062, ECAM23.450.B-EX3-0132215119, ECAM23.450.B-EX3-0132215122, ECAM23.450.S-0132215094, ECAM23.450.S-0132215095, ECAM23.450.S-EX3-0132215115, ECAM23.460.B-0132215181, ECAM23.460.B-S11-0132215250, ECAM23.460.S-0132215182, ECAM23.460.S-S11-0132215246, ECAM23.463.B-0132215209
- ECAM24.210.SB-0132213047, ECAM24.450.S-0132215139, ECAM25.120.B-0132213061, ECAM25.452.B-0132215154, ECAM25.452.S-0132215153, ECAM25.462.B-0132215186, ECAM25.462.S-0132215187, ECAM26.455.BLB-0132215146, ECAM26.455.C-0132215135, ECAM26.455.M-0132215118, ECAM26.455.MB-0132215130, ECAM28.465.AZ-0132215196, ECAM28.465.BG-0132215197, ECAM28.465.M-0132215194, ECAM28.465.MB-0132215195, ECAM28.467.B-0132215198
- ECAM350.55.B-0132215297, ECAM350.75.S-0132215298, ECAM44.620.S-0132220003, ECAM44.660.B-

0132215212, ECAM44.666.B-0132215216, ECAM45.366.B-0132215191, ECAM45.366.W-0132215201, ECAM45.760.W-0132215211, ECAM45.766.B-0132215247, ECAM650.55.MS-0132217026, ECAM650.55.MS-0132217029, ECAM650.75.MS-0132219005, ECAM650.75.MS-0132219008

3. INSTALLATION (SETUP)

Replacing the boiler filter/shower screen requires careful handling. Always ensure the coffee machine is unplugged and completely cooled down before beginning any maintenance.

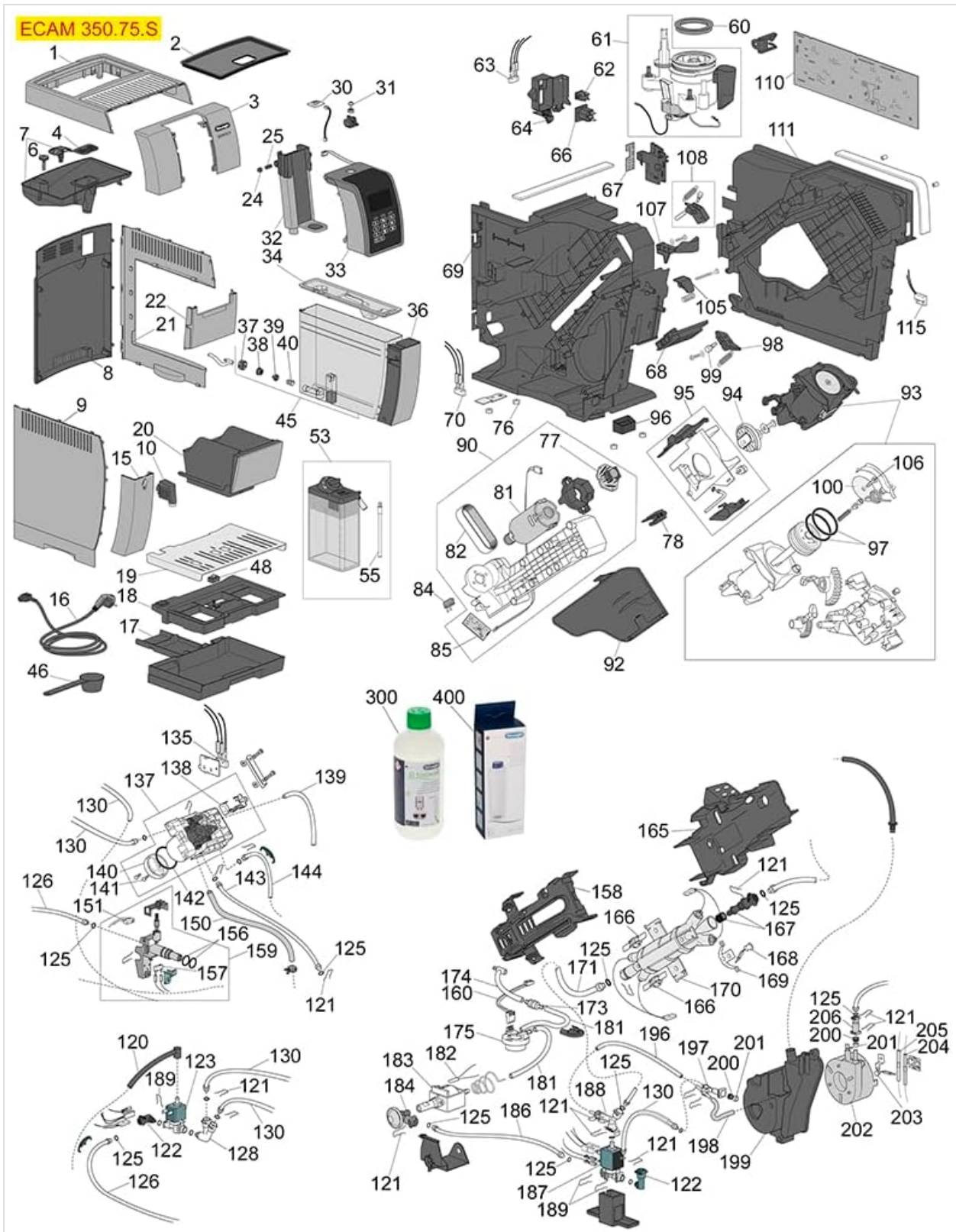

Figure 2: An exploded diagram illustrating various internal components of a DeLonghi coffee maker, including the boiler and filter assembly, with numbered parts for identification. Refer to your specific machine's service manual for exact part locations.

Installation Steps:

1. **Safety First:** Unplug the coffee machine from the power outlet and allow it to cool down completely.
2. **Access the Boiler/Brew Group:** Depending on your specific DeLonghi model, you may need to remove certain external panels or open the brew group access door to reach the boiler filter. Refer to your coffee machine's user manual for instructions on accessing internal components.
3. **Locate the Old Filter:** Identify the existing boiler filter or shower screen. It is typically a circular, perforated metal disc located at the bottom of the brew group where water dispenses into the coffee grounds.
4. **Remove the Old Filter:** Carefully unscrew or unclip the old filter. Some models may require a small screwdriver or a specialized tool. Note the orientation of the old filter for correct installation of the new one.
5. **Clean the Area:** Before installing the new filter, clean any coffee residue or scale from the brew group area.
6. **Install the New Filter:** Place the new DeLonghi Boiler Filter (part number 6013213181) into position, ensuring it sits flush and is correctly oriented. Secure it by screwing or clipping it back into place. Do not overtighten.
7. **Reassemble:** Reattach any panels or close access doors that were removed.
8. **Test:** Plug the machine back in and perform a test cycle with water only to ensure proper water flow and no leaks.

4. MAINTENANCE

Regular maintenance of your boiler filter is essential for consistent coffee quality and machine performance.

Cleaning:

- Periodically remove the filter (following the installation steps in reverse) and rinse it under running water to remove loose coffee grounds.
- For stubborn residue, soak the filter in a solution of coffee machine descaler or a mild detergent, then scrub gently with a soft brush. Rinse thoroughly before reinstallation.

Replacement:

The boiler filter should be replaced if it becomes damaged, heavily clogged beyond cleaning, or if you notice a significant decrease in water flow or uneven coffee extraction. The frequency of replacement depends on usage and water hardness, but generally, it is recommended to inspect and consider replacement every 6-12 months.

5. TROUBLESHOOTING

If you encounter issues after installing the new boiler filter, consider the following:

- **Restricted Water Flow:** Ensure the filter is installed correctly and not obstructed. Check for any remaining debris in the brew group.
- **Leaking:** Verify that the filter is seated properly and securely tightened. If applicable, check the condition of any associated gaskets or O-rings.
- **Incorrect Fit:** Double-check that the part number 6013213181 is indeed the correct filter for your specific DeLonghi coffee machine model.

6. SPECIFICATIONS

Part Number	6013213181
-------------	------------

Item Model Number	1081109
Type	Boiler Filter / Shower Screen
Diameter	40.0 mm (NO 100)
Item Weight (approx.)	3.68 ounces (packaging weight)
Date First Available	September 2, 2024

7. WARRANTY AND SUPPORT

For warranty information or technical support regarding the DeLonghi Coffee Maker Boiler Filter 6013213181, please refer to the original product packaging or contact the seller or authorized DeLonghi service center. Keep your purchase receipt as proof of purchase.