

Manuals+

[Q & A](#) | [Deep Search](#) | [Upload](#)

manuals.plus /

> [AKEEYO](#) /

> [AKEEYO EYES 3-Channel Dash Cam User Manual \(Model AKEEYO-EYES-01\)](#)

AKEEYO AKEEYO-EYES-01

AKEEYO EYES 3-Channel Dash Cam User Manual

Model: AKEEYO-EYES-01

1. INTRODUCTION

This manual provides comprehensive instructions for the installation, operation, and maintenance of your AKEEYO EYES 3-Channel Dash Cam. This device is designed to enhance driving safety and provide reliable video evidence with its advanced features, including AI driver assistance, multi-lens recording, and 24/7 parking surveillance.



Image 1.1: The AKEEYO EYES 3-Channel Dash Cam, showing the main unit with its 4-inch IPS touchscreen and the

separate rear camera.

2. PRODUCT FEATURES

- **3-Channel Recording:** Simultaneous recording from front (telephoto and wide-angle) and rear cameras.
- **2K Resolution:** High-definition video capture for clear details.
- **4-inch IPS Touchscreen:** Intuitive interface for live view and settings adjustment.
- **AI Driver Assistance (ADAS & BSD):** Real-time alerts for collision, lane departure, blind spot detection, pedestrian detection, and front vehicle start reminders.
- **WDR Night Vision:** Enhanced clarity in low-light conditions.
- **Voice Control:** Hands-free operation for key functions.
- **Built-in GPS:** Records speed and location data.
- **5G Wi-Fi Connectivity:** Fast data transfer to mobile devices via app.
- **G-Sensor:** Automatic emergency recording upon impact.
- **Loop Recording:** Continuous recording, overwriting oldest files when storage is full (emergency videos are protected).
- **24/7 Parking Mode:** Monitors vehicle activity when parked (requires separate hardware kit).
- **Super Capacitor:** Provides durability and resistance to extreme temperatures.



Image 2.1: Overview of AI Driver Assistance features, including ADAS and BSD.



Image 2.2: Detailed view of the dash cam's main unit and rear camera, highlighting the 3.99-inch display, wide-angle and telephoto lenses, and 360-degree rotating rear camera.

3. PACKAGE CONTENTS

Verify that all items are present in the package:

- AKEEYO EYES Dash Cam (Main Unit)
- Rear Camera
- Car Charger
- Rear Camera Cable

- PC Data Transmission Wire
- Crowbar (for cable routing)
- Static Electricity Sticker
- Body Mount
- 3M Adhesive Pads

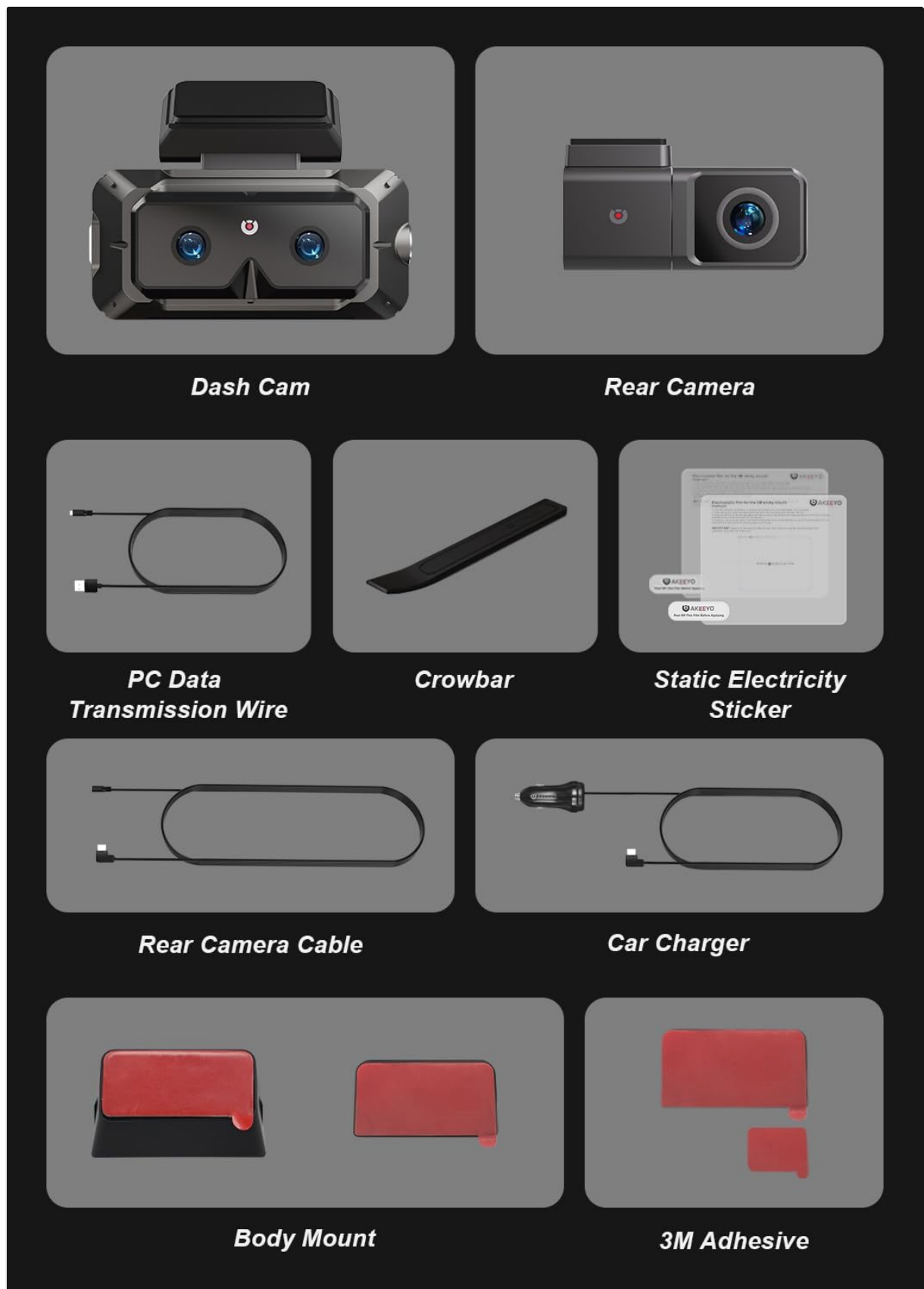

Image 3.1: All components included in the AKEEYO EYES Dash Cam package.

4. SETUP AND INSTALLATION

4.1 MicroSD Card Installation

1. Ensure the dash cam is powered off.
2. Insert a compatible MicroSD card (Class 10 or higher, U3 V30 A2 recommended, up to 256GB) into the designated slot on the main unit until it clicks.
3. To remove, gently push the card until it springs out.

4.2 Front Dash Cam Installation

1. Clean the windshield area where the dash cam will be mounted.
2. Attach the static electricity sticker to the chosen area on the windshield.
3. Affix the body mount with 3M adhesive to the static electricity sticker.
4. Slide the main dash cam unit onto the body mount.
5. Adjust the angle of the dash cam to ensure a clear view of the road ahead.

4.3 Rear Camera Installation

1. Choose a mounting location for the rear camera, either inside the rear window or outside near the license plate (IP67 rated for outdoor use).
2. Clean the mounting surface thoroughly.
3. Attach the rear camera using the provided 3M adhesive.
4. Route the rear camera cable to the main dash cam unit, ensuring it does not interfere with airbags or vehicle operation. Use the crowbar to tuck cables neatly.
5. Connect the rear camera cable to the AV-IN port on the main unit.
6. If the rear camera is installed upside down, detach it from its quick-release mount and reattach it in the correct orientation. No software adjustment is needed.

4.4 Power Connection

1. Connect the car charger to the Type-C port on the main dash cam unit.
2. Plug the car charger into your vehicle's cigarette lighter socket.
3. Route the power cable neatly to avoid obstruction.

Easy *Installation*



Image 4.1: Visual guide for the installation of the dash cam system.

5. OPERATING INSTRUCTIONS

5.1 Power On/Off

- The dash cam will automatically power on and begin recording when the vehicle's ignition is turned on.
- It will power off automatically when the ignition is turned off.
- To manually power on/off, press and hold the power button.

5.2 Using the 4-inch IPS Touchscreen

The touchscreen allows for easy navigation and viewing:

- **Live View:** Displays real-time footage from the cameras. You can view all three channels simultaneously or focus on a single camera.
- **Settings:** Access various settings such as resolution, loop recording duration, G-sensor sensitivity, and Wi-Fi.
- **Playback:** Review recorded videos directly on the screen.



Image 5.1: The dash cam's 4-inch IPS touchscreen interface.

5.3 Voice Control

Operate key functions hands-free using voice commands. Examples include:

- "Open ADAS" / "Close ADAS"
- "Open BSD" / "Close BSD"
- "Open Screen" / "Close Screen"

- "Open WiFi" / "Close WiFi"
- "Lock Video" (to protect current recording)
- "Open Sound Recording"



Image 5.2: Voice control commands for hands-free operation.

5.4 Recording Modes

- **Loop Recording:** The dash cam records continuously in segments. When the memory card is full, it automatically overwrites the oldest unlocked files.
- **G-Sensor:** In the event of a sudden impact or collision, the built-in G-sensor automatically detects the event and locks the current video segment to prevent it from being overwritten.



Image 5.3: Loop Recording mechanism.

5.5 24/7 Parking Mode

When properly configured with the optional AKEEYO hardware kit (ASIN B0DZHPR4XW, sold separately), the dash cam can monitor your vehicle 24/7. It detects vibrations and records abnormal events, providing security against theft or collisions while parked. Low framerate recording can conserve storage during parking surveillance.

24/7 Parking Monitor

Requires Hardware Kit **Search AKEEYO**



Image 5.4: 24/7 Parking Monitor functionality.

5.6 GPS and Wi-Fi Connectivity

- **GPS:** The built-in GPS module records your vehicle's speed and location data, which can be reviewed via the mobile app or PC player.
- **5G Wi-Fi:** Connect your smartphone to the dash cam via the AKEEYO app (available on App Store and Google Play) using 5G Wi-Fi for fast video download, playback, editing, and sharing.



Image 5.5: 5G Wi-Fi and Global GPS connectivity.

5.7 AI Driver Assistance (ADAS & BSD)

The dash cam provides real-time alerts to enhance driving safety:

- **Collision Warning:** Alerts you if your vehicle is too close to the vehicle ahead or if a car slows down abruptly.
- **Lane Departure Warning:** Notifies you if your vehicle drifts out of its lane without signaling.
- **Blind Spot Detection (BSD):** Monitors vehicles in your blind spots and provides alerts when changing lanes.
- **Pedestrian Detection:** Identifies pedestrians in front of you at low speeds and issues an alarm.
- **Front Vehicle Start Reminder:** Reminds you when the vehicle ahead starts to move.



Image 5.6: Collision Warning system in action.



Image 5.7: Blind Spot Detection system.

6. MAINTENANCE

6.1 Cleaning the Device

- Use a soft, dry cloth to clean the dash cam body and screen.
- For lenses, use a specialized lens cleaning cloth to avoid scratches.
- Do not use abrasive cleaners or solvents.

6.2 MicroSD Card Management

- Regularly format the MicroSD card (at least once a month) through the dash cam's settings to ensure optimal performance and prevent data corruption.
- Replace the MicroSD card periodically, as continuous overwriting can degrade its lifespan.

6.3 Temperature Considerations

The dash cam is designed to withstand temperatures up to 176°F (80°C). However, prolonged exposure to extreme heat can affect performance. If the device becomes excessively hot, allow it to cool down before handling or removing the SD card.

7. TROUBLESHOOTING

- **Dash Cam not powering on:** Check the power connection to the car charger and ensure the vehicle's cigarette lighter socket is functional.

- **Recording issues:** Ensure a compatible MicroSD card is inserted and formatted. Check if the card is full or corrupted. Try formatting the card or using a new one.
- **Camera shutting down randomly:** This could be due to a faulty SD card or extreme temperatures. Try replacing the SD card. If the issue persists, contact customer support.
- **Rear camera fogging/malfunctioning:** Ensure the rear camera is properly sealed if mounted externally. If mounted internally, check for condensation.
- **AI features (ADAS/BSD) providing false alerts or not working:** Ensure the camera lenses are clean and unobstructed. Calibrate the system if an option is available in settings. Adjust sensitivity if alerts are too frequent.
- **Wi-Fi connection issues:** Ensure Wi-Fi is enabled on the dash cam and your smartphone. Restart both devices and try connecting again.
- **GPS not tracking:** Ensure the dash cam has a clear view of the sky.

For further assistance, please contact AKEEYO customer support.

8. SPECIFICATIONS

Feature	Specification
Product Dimensions	10.24 x 7.48 x 2.76 inches
Item Weight	2.34 pounds
Model Number	AKEEYO-EYES-01
Video Capture Resolution	1440p (2K)
Display	4-inch IPS Touchscreen
Connectivity Technology	Powerline, USB, Voice, Wi-Fi (5G)
Special Features	3-Channel 2K+2K+2K, GPS, Night Vision, Voice Control, Touch Control, AI ADAS & BSD Assistance, Wide-Angle, Loop Recording, G-Sensor, Telephoto Lens, 24H Parking Mode
Mounting Type	Windshield Mount
Color	Black
Field Of View	160 Feet (Front Telephoto) / 135° (Front Wide-Angle) / 154° (Rear)
Storage Support	Up to 256GB MicroSD (Class 10, U3 V30 A2 recommended)
Operating Temperature	Up to 176°F (80°C)

9. WARRANTY AND SUPPORT

- **Warranty:** The AKEEYO EYES Dash Cam comes with an 18-month warranty.
- **Returns:** You are eligible for returns within 30 days of purchase.
- **Customer Service:** AKEEYO provides 24-hour customer service. For support, please visit the official AKEEYO website or contact their customer service team directly.